

DATE TIME
1/2/2024 10:59 AM

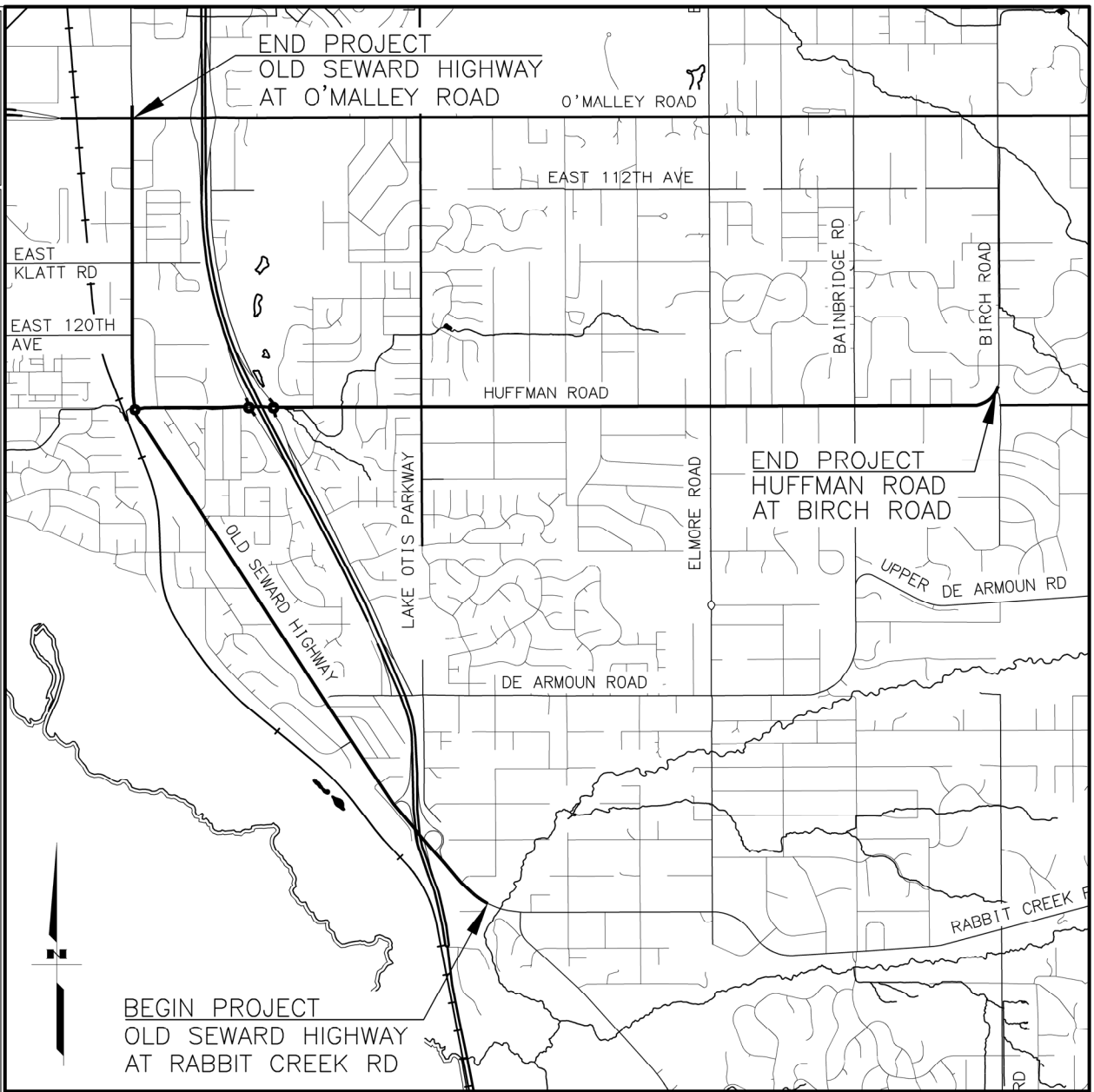

DRAWING LOCATION
C:\USERS\ZICALL\DESKTOP\XXXXX_DSR_V&E_MAP_ZJC.DWG

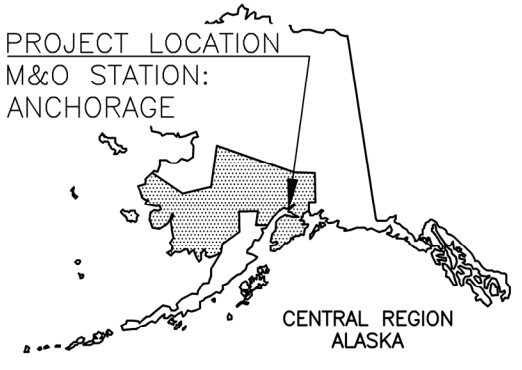

**OLD SEWARD HWY & HUFFMAN RD:
RABBIT CREEK TO HUFFMAN TO BIRCH
PAVEMENT PRESERVATION**

**PROJECT # 0537010/CFHWY00886
FIGURE 1**

**PROJECT LOCATION
AND VICINITY MAP**