

Date Plotted: 15/08/2017 3:13 PM
 Layout Name: 4A-NI-LAYOUT
 File Name: W:\Projects\Adak\ALP\ALP_2015\ALP_2015\ALP_2015\ALP-ADK-LAYOUT_PLANS.dwg
 Drawn By:
 Checked By:

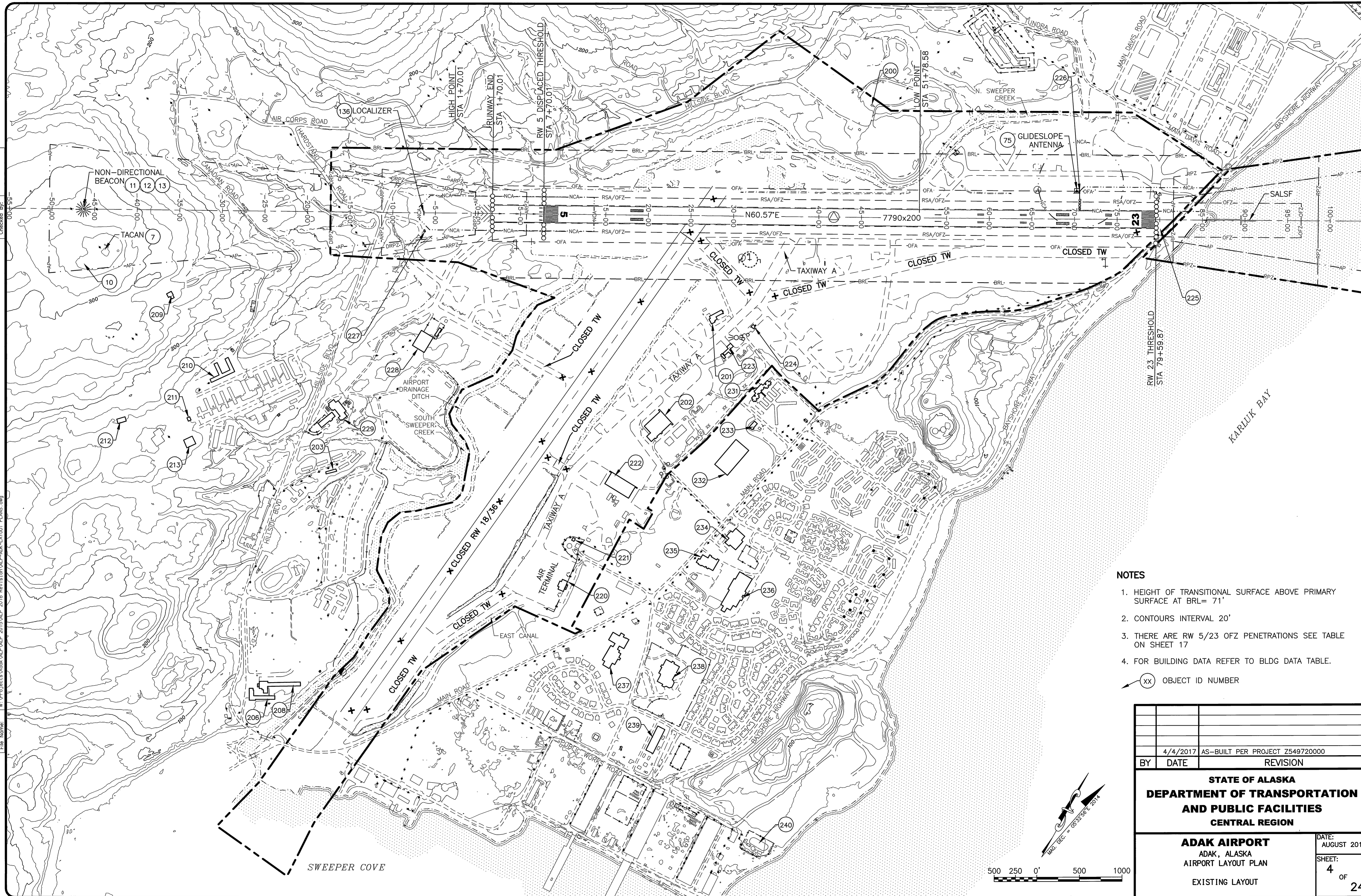

NOTES

1. HEIGHT OF TRANSITIONAL SURFACE ABOVE PRIMARY SURFACE AT BRL= 71'
 2. CONTOURS INTERVAL 20'
 3. THERE ARE RW 5/23 OFZ PENETRATIONS SEE TABLE ON SHEET 17
 4. FOR BUILDING DATA REFER TO BLDG DATA TABLE.
- ⊗ OBJECT ID NUMBER

	4/4/2017	AS-BUILT PER PROJECT Z549720000
BY	DATE	REVISION
STATE OF ALASKA DEPARTMENT OF TRANSPORTATION AND PUBLIC FACILITIES CENTRAL REGION		
ADAK AIRPORT ADAK, ALASKA AIRPORT LAYOUT PLAN		DATE: AUGUST 2015 SHEET: 4 OF 24
EXISTING LAYOUT		

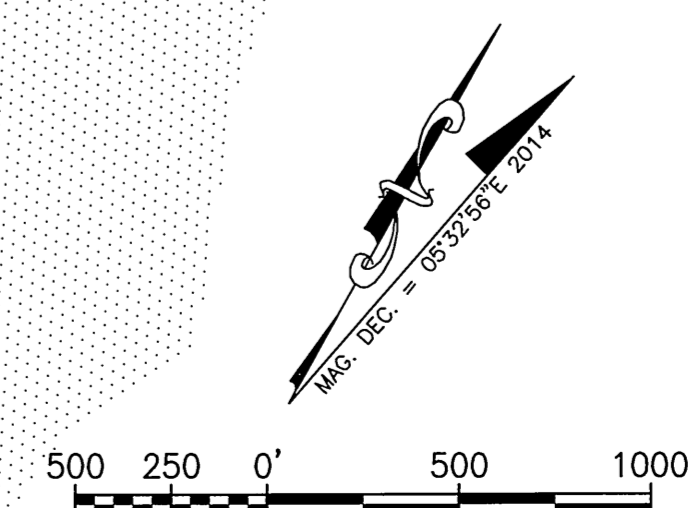

Date Plotted: 5/08/2017 3:14 PM
 Layout Name: 5-L1-LAYOUT
 File Name: W:\Projects\ADAK\ALP\ALP_2015\ALP_2015_VLP_2016_Revision\VALP-ADK-LAYOUT_PLANS.dwg

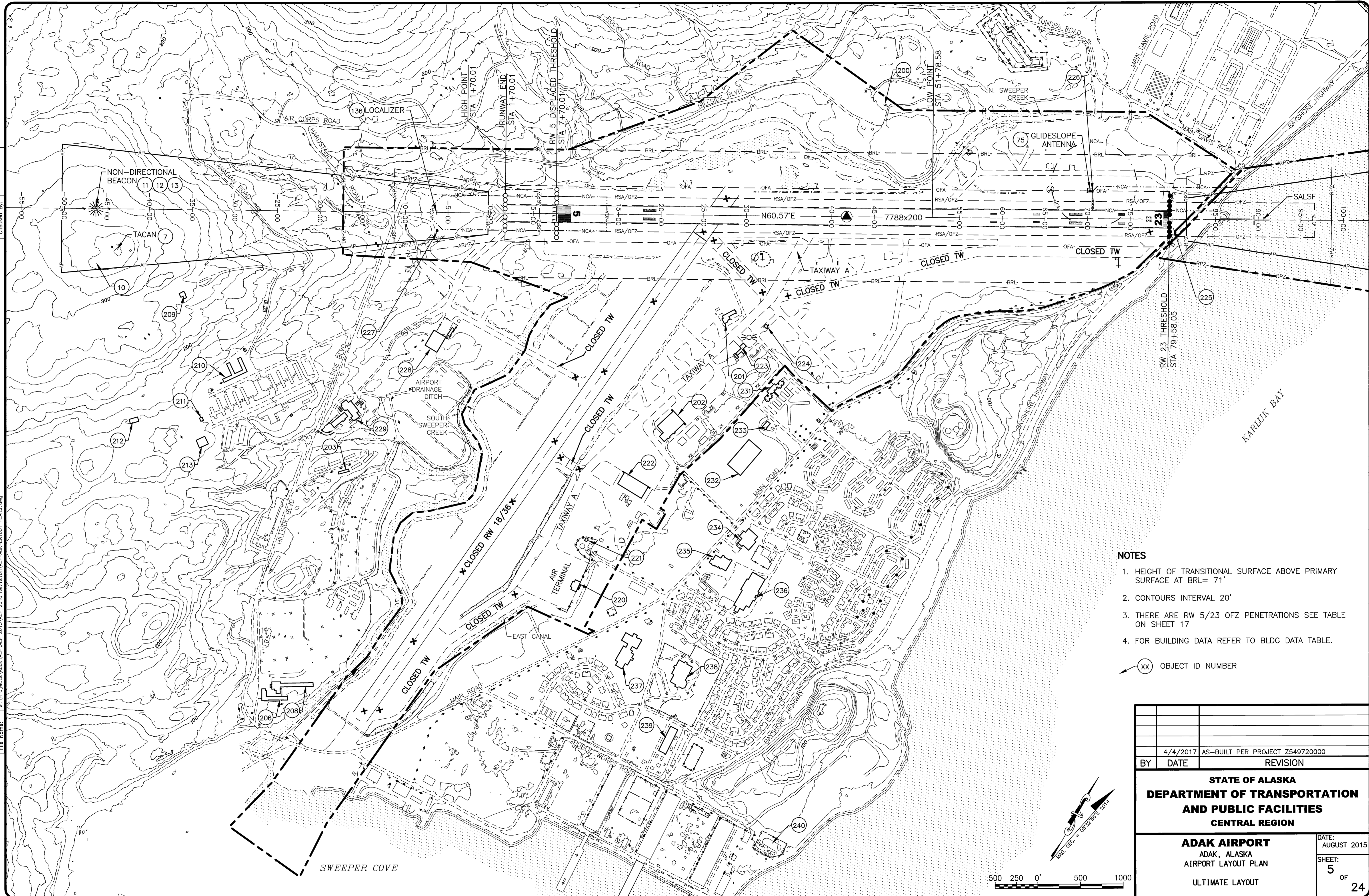

- NOTES**
1. HEIGHT OF TRANSITIONAL SURFACE ABOVE PRIMARY SURFACE AT BRL = 71'
 2. CONTOURS INTERVAL 20'
 3. THERE ARE RW 5/23 OFZ PENETRATIONS SEE TABLE ON SHEET 17
 4. FOR BUILDING DATA REFER TO BLDG DATA TABLE.
- XX OBJECT ID NUMBER

	4/4/2017	AS-BUILT PER PROJECT Z549720000
BY	DATE	REVISION
STATE OF ALASKA DEPARTMENT OF TRANSPORTATION AND PUBLIC FACILITIES CENTRAL REGION		
ADAK AIRPORT		DATE: AUGUST 2015
ADAK, ALASKA		SHEET: 5
AIRPORT LAYOUT PLAN		OF 24
ULTIMATE LAYOUT		

Date Plotted: 4/03/2017, 4:45 PM
 Layout Name: W:\Projects\Adak\ALP\2015\ALP_2016_Revision\ALP-ADK-NI-PAP.dwg
 File Name:
 Designed By:
 Drawn By:
 Checked By:

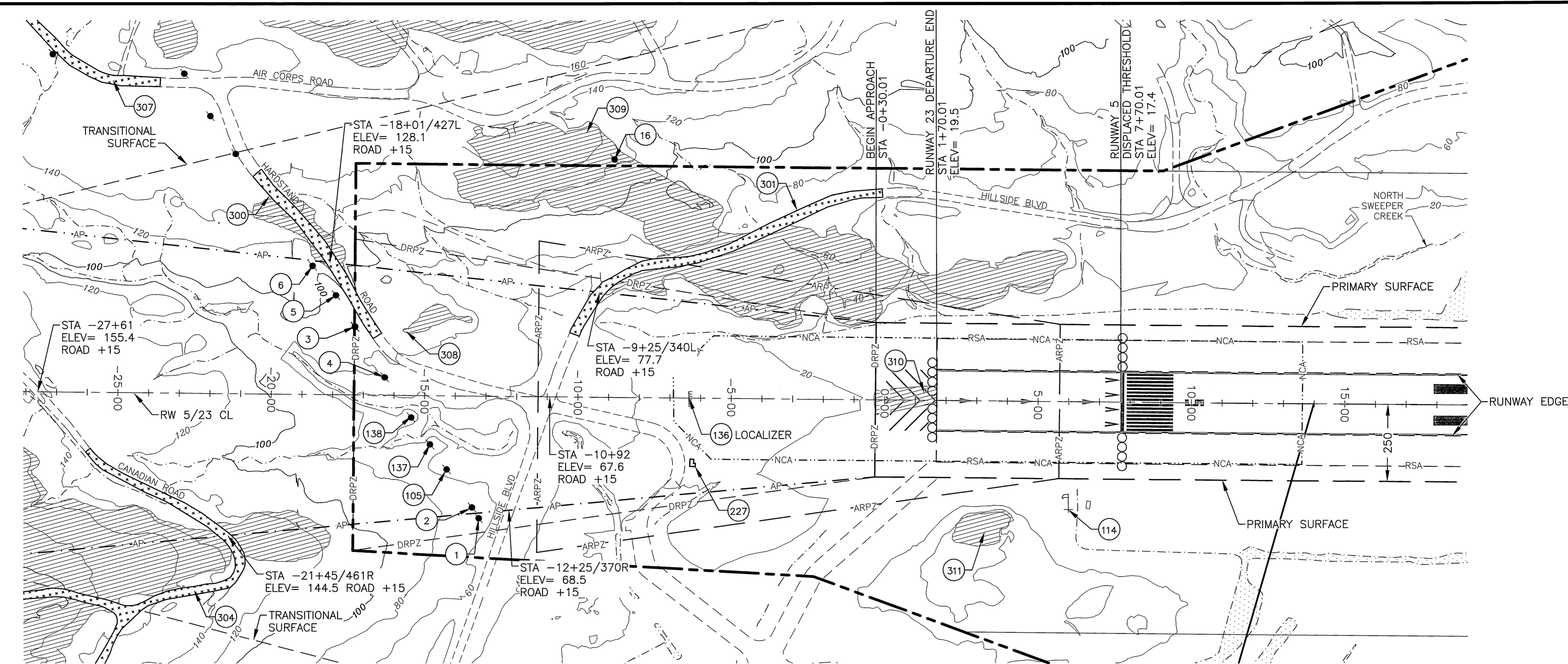

INNER APPROACH LEGEND

- OBJECT ID NUMBER
- PART 77 SURFACE TERRAIN PENETRATION AREA
- PART 77 SURFACE ROAD PENETRATION
- ROAD PENETRATION CONTINUES BEYOND APPROACH SURFACE

- NOTE:**
1. CONTOUR INTERVAL 20'
 2. REFER TO DEPARTURES & APPROACH SITING SURFACE DRAWING RW 5
 3. REFER TO AIRPORT AIRSPACE, 14 CFR, PART 77 DATA TABLES.
 4. SEE AIRPORT AIRSPACE, 14 CFR, PART 77 FOR OBSTRUCTIONS BEYOND THIS DRAWING EXTENTS
 5. CONTROLLING OBSTRUCTION = TOWER @ STA-13+61/396R ELEV= 413, SLOPE 11:1

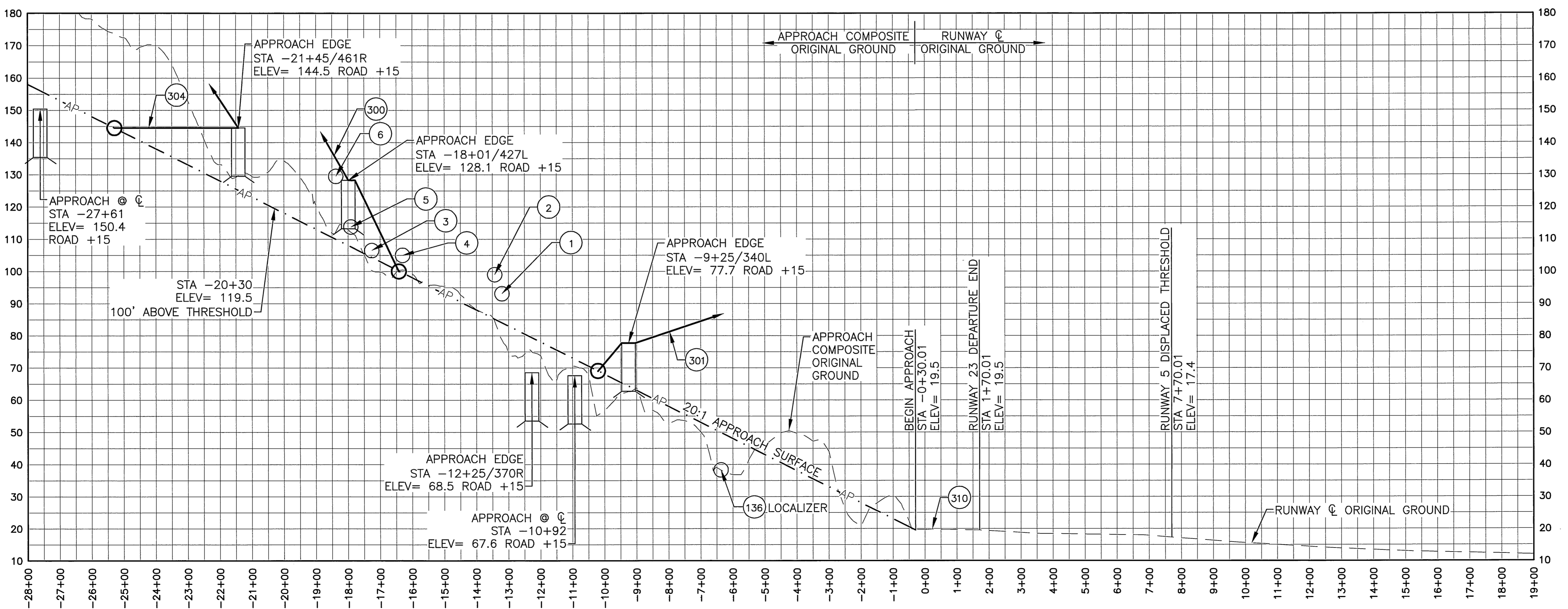
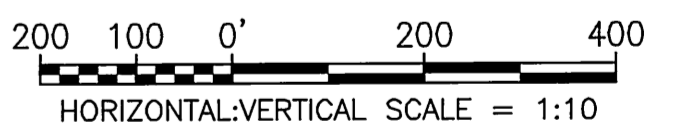
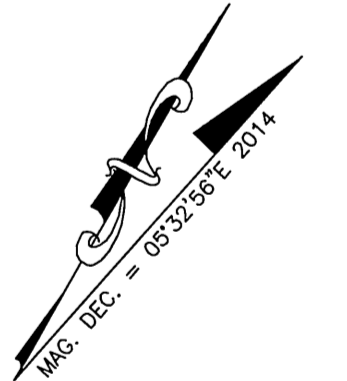

4/4/2017	AS-BUILT PER PROJECT Z549720000			
BY	DATE	REVISION		
STATE OF ALASKA				
DEPARTMENT OF TRANSPORTATION				
AND PUBLIC FACILITIES				
CENTRAL REGION				
ADAK AIRPORT				DATE:
ADAK, ALASKA				AUGUST 2015
AIRPORT LAYOUT PLAN				SHEET:
EXISTING INNER PORTION OF THE				6
APPROACH SURFACE - RUNWAY 5				OF
				24

Date Plotted: 14/03/2017, 4:46 PM
 Layout Name: 7A-RW23
 File Name: W:\Projects\Adak\ALP_2015\ALP_2015\ALP-ADK-INT-RPZ.dwg
 Designed By:
 Drawn By:
 Checked By:

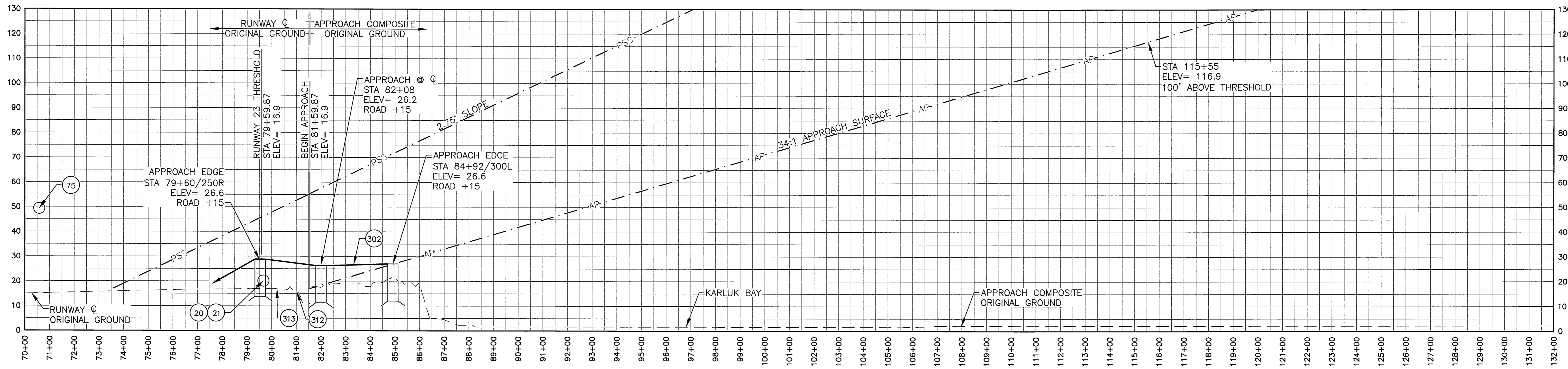
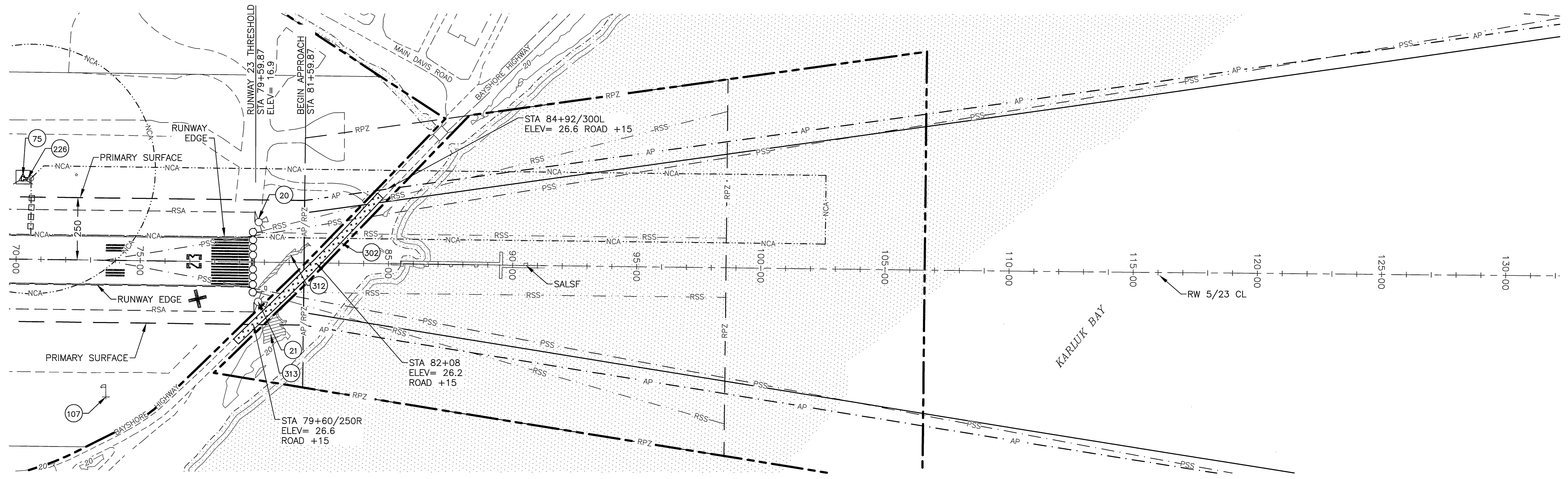

INNER APPROACH LEGEND

- OBJECT ID NUMBER
- PART 77 SURFACE TERRAIN PENETRATION AREA
- PART 77 SURFACE ROAD PENETRATION
- ROAD PENETRATION CONTINUES BEYOND APPROACH SURFACE
- RSS- REIL SITING SURFACE

NOTE:

1. CONTOUR INTERVAL 20'
2. REFER TO DEPARTURES & APPROACH SITING SURFACE DRAWING RW 23
3. REFER TO AIRPORT AIRSPACE, 14 CFR, PART 77 DATA TABLES.
4. SEE AIRPORT AIRSPACE, 14 CFR, PART 77 FOR OBSTRUCTIONS BEYOND THIS DRAWING EXTENTS
5. CONTROLLING OBSTRUCTION = ROAD +15 @ STA 81+58/44R ELEV= 26.0 SLOPE 1:1

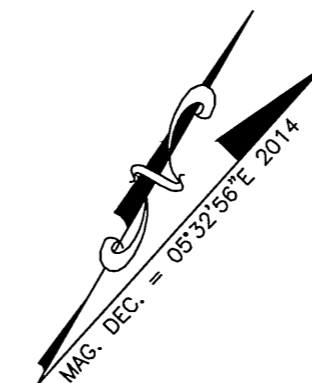

BY	DATE	REVISION
4/4/2017	AS-BUILT PER PROJECT Z549720000	

STATE OF ALASKA
DEPARTMENT OF TRANSPORTATION
AND PUBLIC FACILITIES
CENTRAL REGION

ADAK AIRPORT
 ADAK, ALASKA
 AIRPORT LAYOUT PLAN

EXISTING INNER PORTION OF THE
 APPROACH SURFACE - RUNWAY 23

DATE:
 AUGUST 2015
 SHEET:
 7
 OF
 24

Date Plotted: 4/03/2017, 4:50 PM
 Layout Name: 11-RWS
 File Name: W:\Projects\Adak\ALP\ALP_2015\ALP_2016_Revision\ALP-ADK-LP-RP.dwg

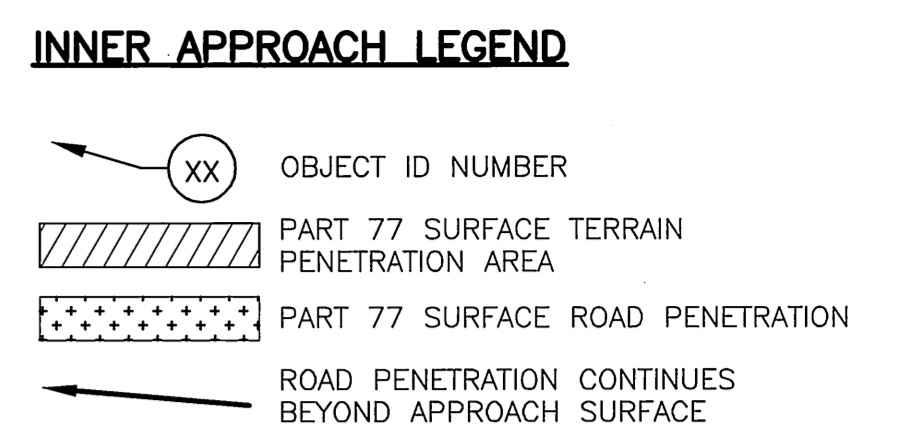
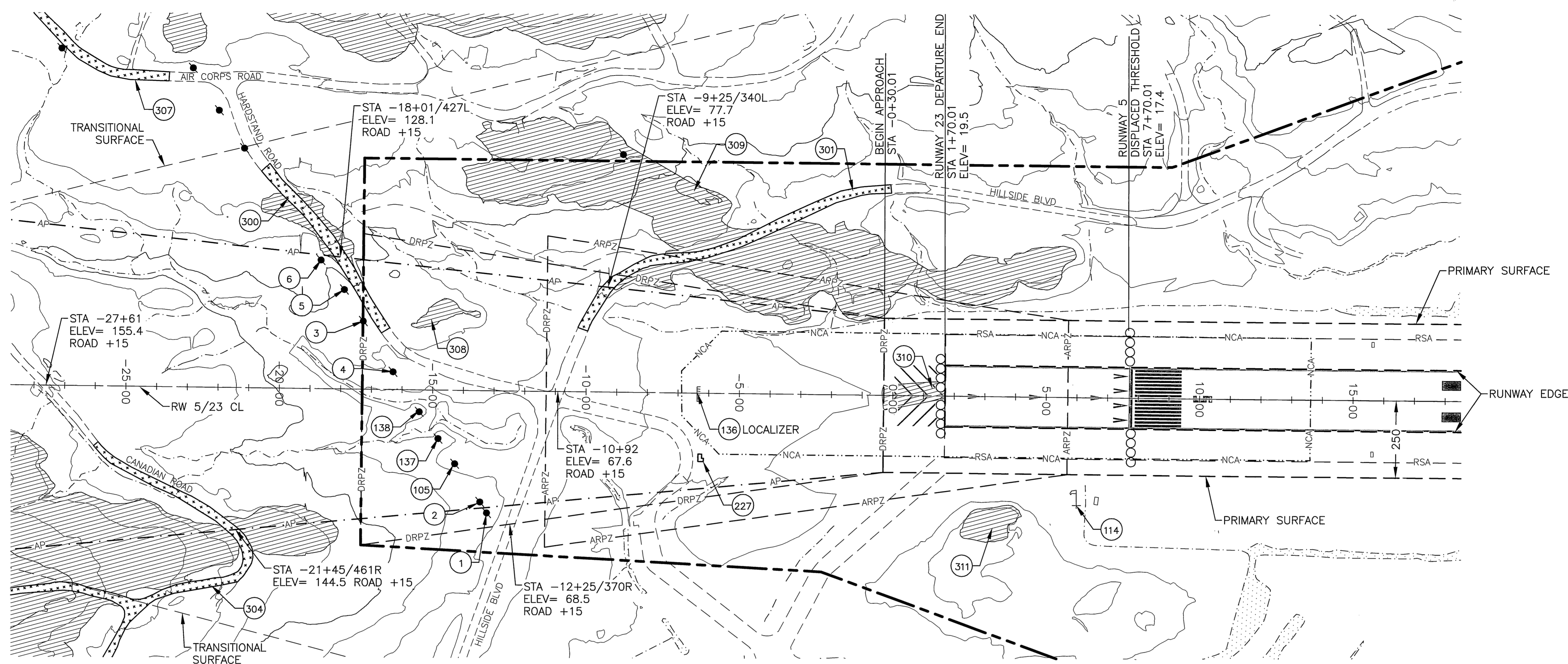

- NOTE:**
1. CONTOUR INTERVAL 20'
 2. REFER TO DEPARTURE, APPROACH SITING SURFACE DRAWING RW 5
 3. REFER TO PART 77 OBSTRUCTION DATA TABLES ON SHEETS 22-23
 4. SEE AIRPORT AIRSPACE DRAWING FOR PART 77 OBSTRUCTIONS BEYOND THIS DRAWING EXTENTS
 5. CONTROLLING OBSTRUCTION = TOWER @ STA -13+61/396R, ELEV = 413, SLOPE = 11:1

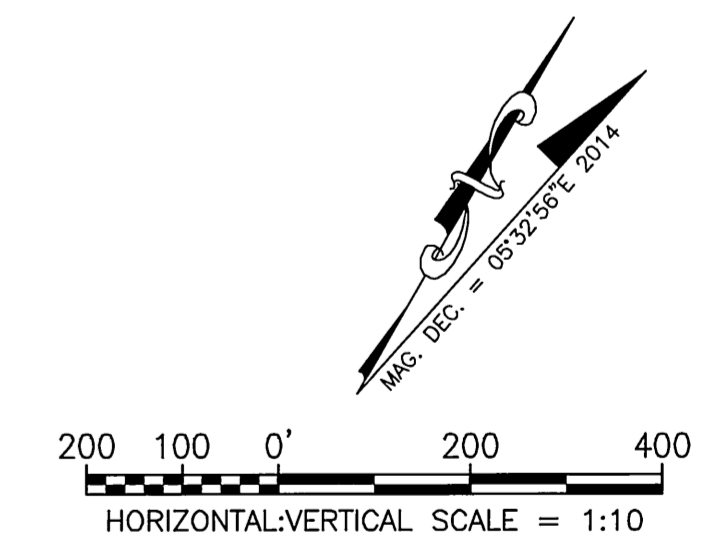
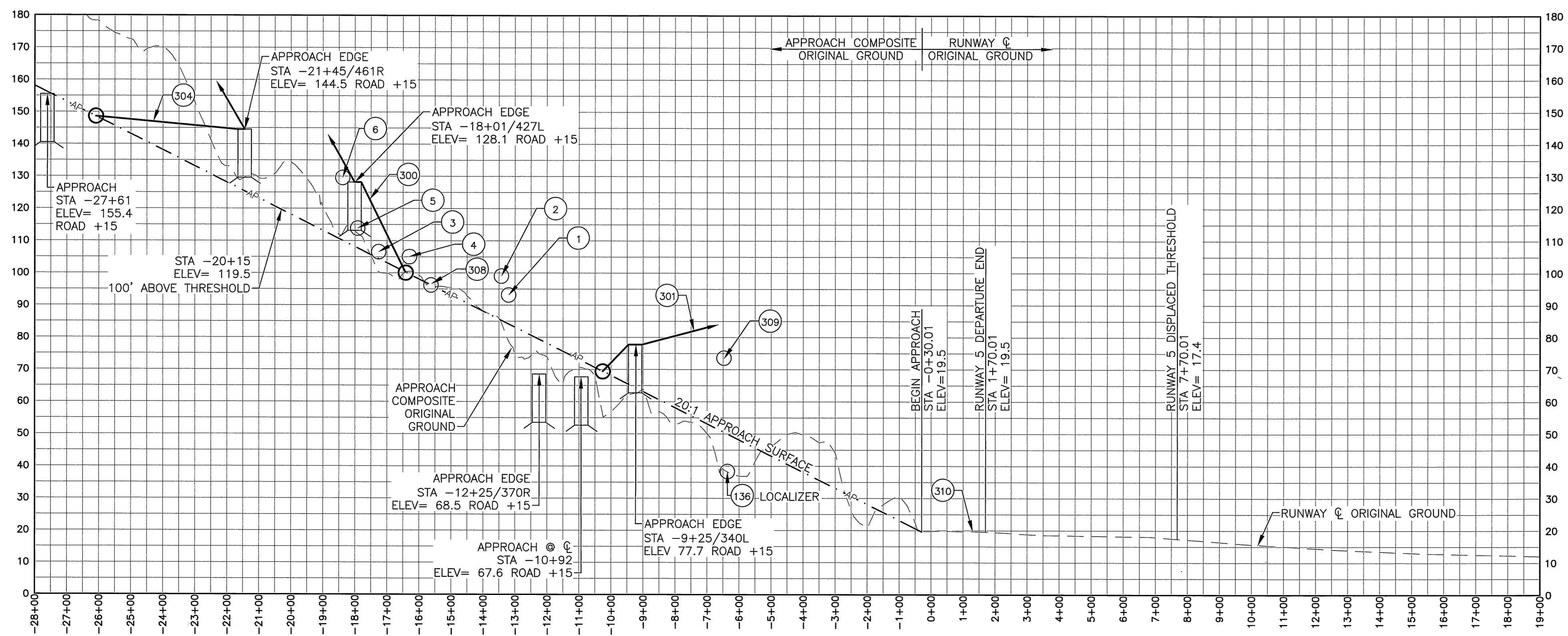

4/4/2017		AS-BUILT PER PROJECT Z549720000	
BY	DATE	REVISION	
STATE OF ALASKA DEPARTMENT OF TRANSPORTATION AND PUBLIC FACILITIES CENTRAL REGION			
ADAK AIRPORT		DATE: AUGUST 2015	
ADAK, ALASKA		SHEET:	
AIRPORT LAYOUT PLAN		9 OF 24	
ULTIMATE INNER PORTION OF THE APPROACH SURFACE - RUNWAY 5			

Date Plotted: 1/03/2017, 4:51 PM
 Layout Name: 12_23
 File Name: W:\Projects\Adak VLP\ALP 2015 VLP 2016 Rev\ALP\ALP-03-11-RP.dwg

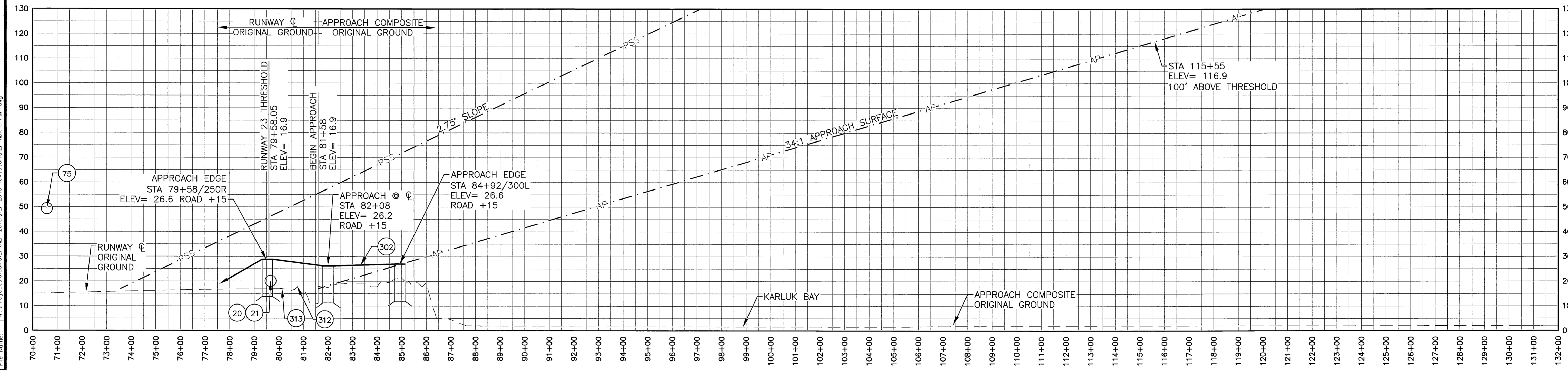
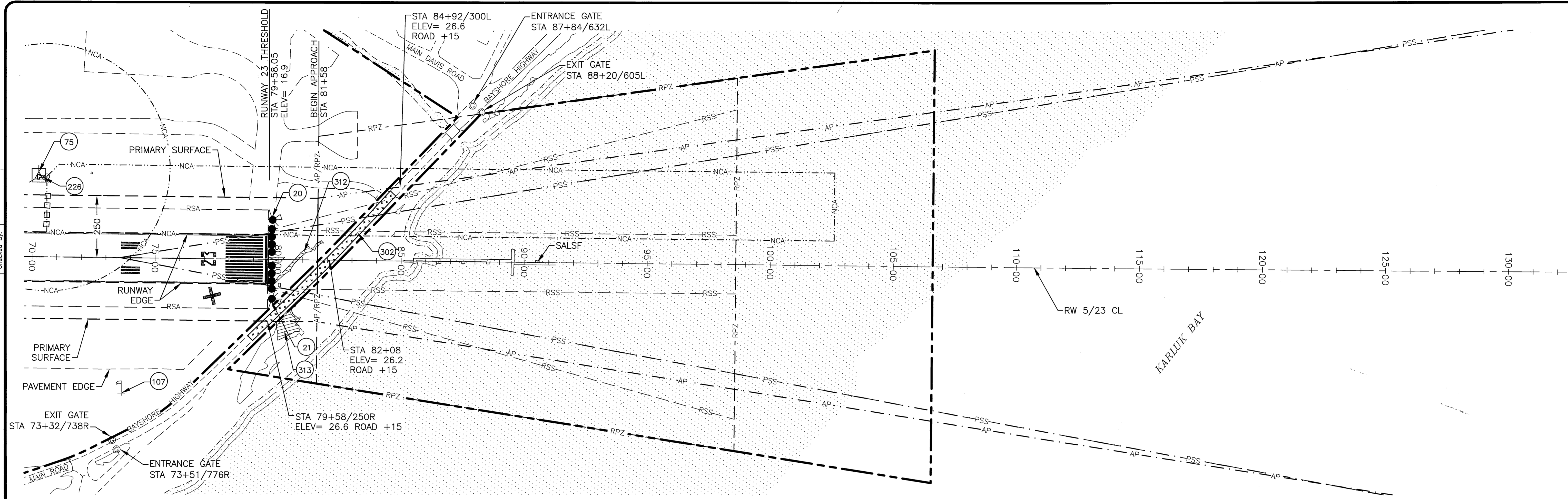

INNER APPROACH LEGEND

- OBJECT ID NUMBER
- PART 77 SURFACE TERRAIN PENETRATION AREA
- PART 77 SURFACE ROAD PENETRATION
- ROAD PENETRATION CONTINUES BEYOND APPROACH SURFACE
- - RSS - - REIL SITING SURFACE

NOTES:

1. CONTOUR INTERVAL 20'
2. REFER TO DEPARTURE, APPROACH SITING SURFACE DRAWING
3. REFER TO PART 77 OBSTRUCTION DATA TABLES ON SHEETS 22-23
4. SEE AIRPORT AIRSPACE DRAWING FOR PART 77 OBSTRUCTIONS BEYOND THIS DRAWING EXTENTS
5. CONTROLLING OBSTRUCTION = ROAD+15@ STA 81+58/44R, ELEV= 26.0, SLOPE = 1:1

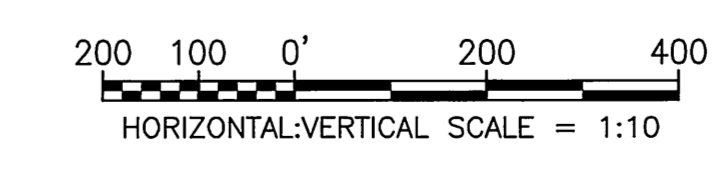

BY	DATE	REVISION

STATE OF ALASKA
DEPARTMENT OF TRANSPORTATION
AND PUBLIC FACILITIES
CENTRAL REGION

ADAK AIRPORT
 ADAK, ALASKA
 AIRPORT LAYOUT PLAN

ULTIMATE INNER PORTION OF THE
 APPROACH SURFACE - RUNWAY 23

DATE: AUGUST 2015	SHEET: 10 OF 24
4/4/2017, AS-BUILT PER PROJECT Z549720000	

Date Plotted: 4/04/2017, 7:47 AM
 Layout Name: 16-RW5
 File Name: W:\Projects\Adak\ALP\ALP_2015\ALP_2015_Revision\ALP-ADK-11-16P1-RP8.cwg

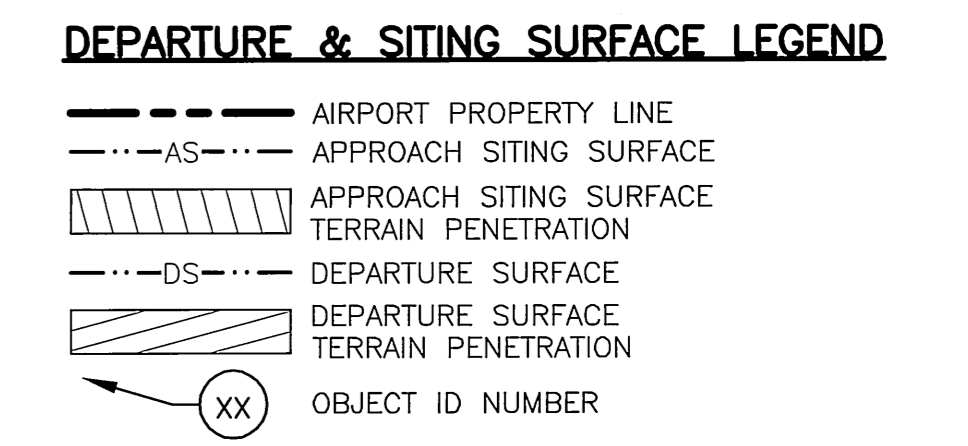
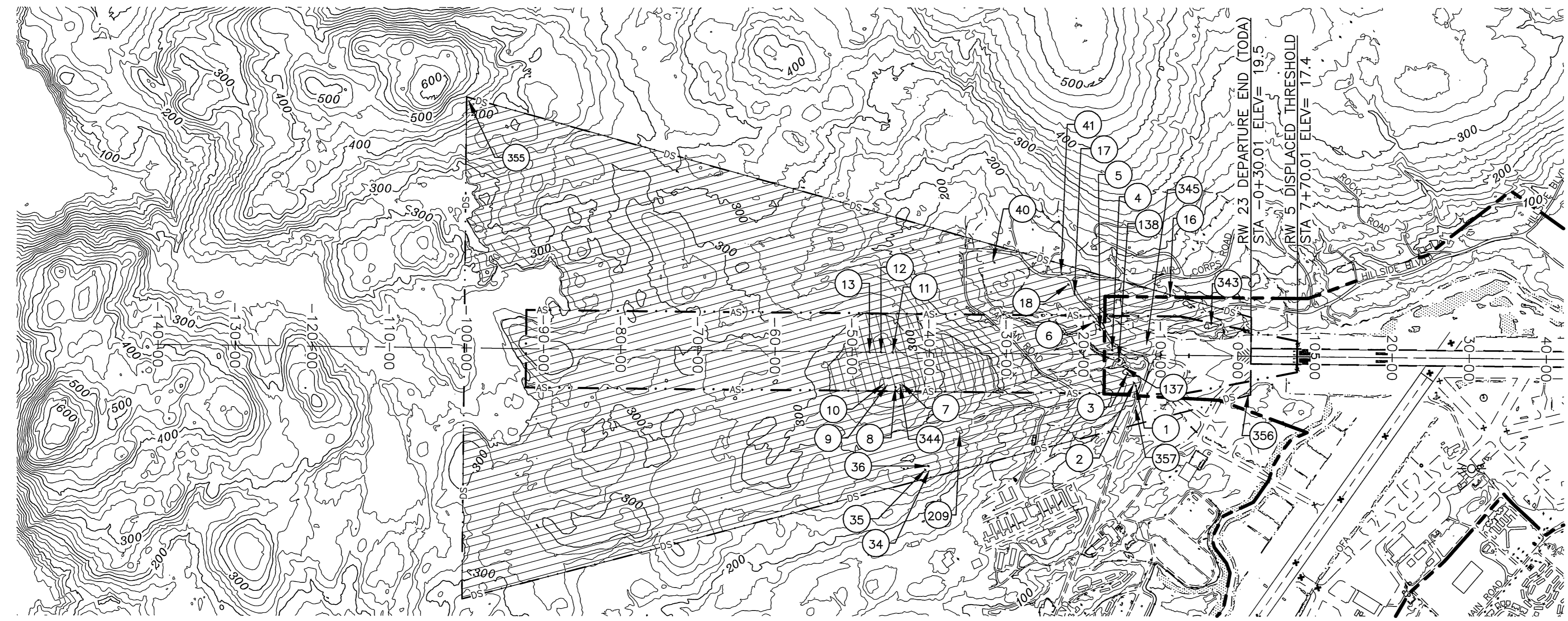

NOTE:

1. CONTOUR INTERVAL 20'
2. APPROACH END OF RUNWAY 5 EXPECTED TO SERVE LARGE AIRPLANES (VISUAL DAY/NIGHT) APPROACH SITING SURFACE BEGINS @ DISPLACED THRESHOLD 400 X 1,000 X 1,500 X 8,500 X 20:1
3. DEPARTURE SURFACE FOR RW 23 BEGINS @ RUNWAY END (TODA) 1,000 X 6,466 X 10,200 X 40:1
4. REFER TO APPROACH SITING AND DEPARTURE OBSTACLE TABLES ON SHEET 14

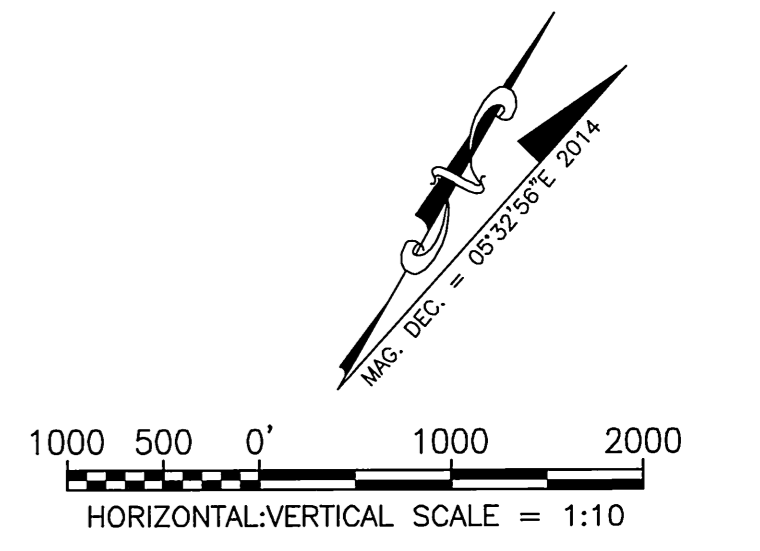
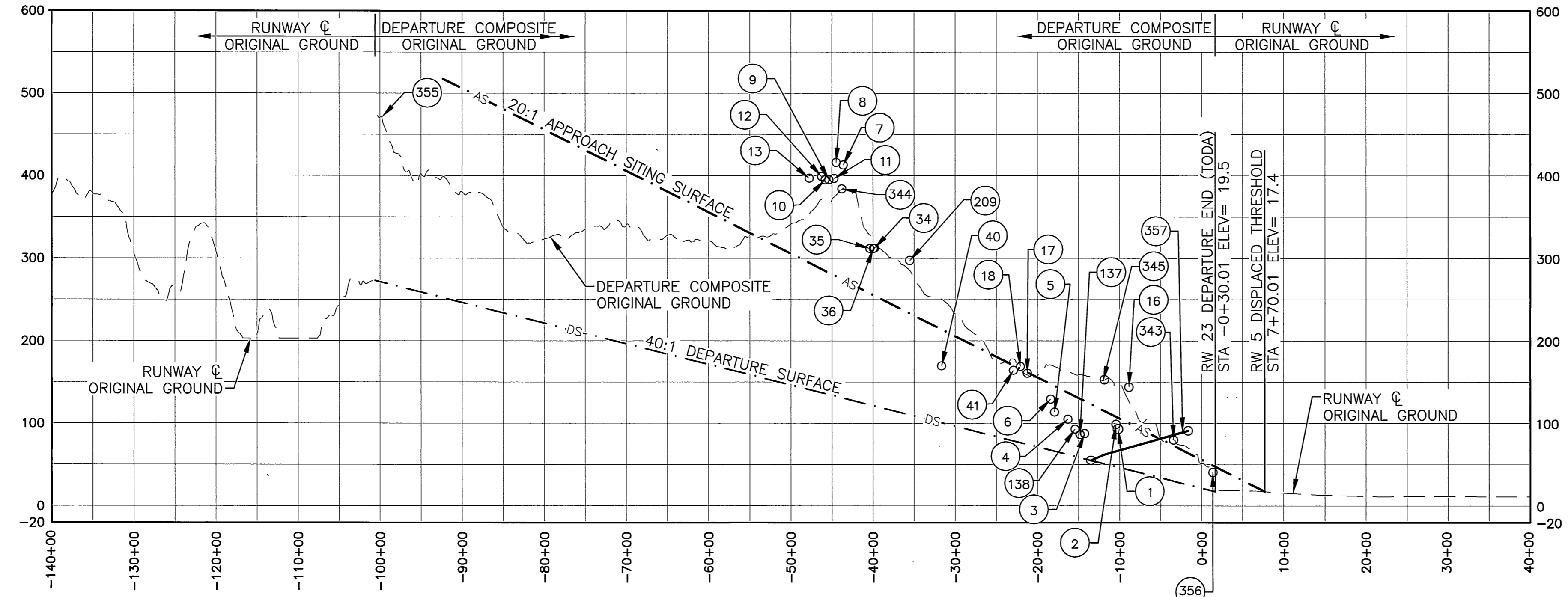

4/4/2017		AS-BUILT PER PROJECT Z549720000
BY	DATE	REVISION
STATE OF ALASKA		
DEPARTMENT OF TRANSPORTATION		
AND PUBLIC FACILITIES		
CENTRAL REGION		
ADAK AIRPORT		DATE: AUGUST 2015
ADAK, ALASKA		SHEET: 12
AIRPORT LAYOUT PLAN		OF 24
EXISTING DEPARTURES & APPROACH SITING SURFACES - RUNWAY 5		

Date Plotted: 5/05/2017, 1:35 PM
 Layout Name: H:\Projects\Adak\ALP\2015\ALP 2015 Rev 8.100\ALP-ADK-1-0601-FRIP.dwg
 File Name:
 Designed By:
 Drawn By:
 Checked By:

APPROACH SITING SURFACE OBSTACLES (RUNWAY 5)

ID #	DESCRIPTION	STATION/OFFSET	GRD ELEV	AGL	TOP ELEV	SURFACE PENETRATED	SURFACE ELEV	AMOUNT PENETRATION	TRIGGER EVENT	DISPOSITION	STAGE TO CORRECT
7	TOWER	-43+61/396R	378.7	34.2	412.9	APPROACH SITING	273.9	139.0	EXISTING	TO REMAIN	
8	POLE	-44+35/444R	377.5	38.6	416.1	APPROACH SITING	277.6	138.5	EXISTING	TO REMAIN	
9	RADAR DOME	-45+37/413R	366.7	28.4	395.1	APPROACH SITING	282.7	112.4	EXISTING	TO REMAIN	
10	DME ANTENNA	-45+82/402R	366.3	28.8	395.1	APPROACH SITING	285.0	110.1	EXISTING	TO REMAIN	
11	NDB TOWER	-44+75/0	327.0	70.0	397.0	APPROACH SITING	279.6	117.4	EXISTING	TO REMAIN	
12	NDB SHELTER	-46+25/0	327.0	70.0	397.0	APPROACH SITING	287.1	109.9	EXISTING	TO REMAIN	
13	NDB TOWER	-47+75/0	327.0	70.0	397.0	APPROACH SITING	294.6	102.4	EXISTING	TO REMAIN	
343	TERRAIN	-3+48/392L	79.0	0	79.0	APPROACH SITING	73.0	6.0	EXISTING	TO REMAIN	
344	TERRAIN	-30+43/500L -53+12/500R	*384.0	0	*384.0	APPROACH SITING	274.0	110.0	EXISTING	TO REMAIN	
345	ROAD +15	-6+56/446L -5+66/467L	76.0	15.0	91.0	APPROACH SITING	84.0	7.0	EXISTING	TO REMAIN	

APPROACH SITING SURFACE OBSTACLES (RUNWAY 23)

ID #	DESCRIPTION	STATION/OFFSET	GRD ELEV	AGL	TOP ELEV	SURFACE PENETRATED	SURFACE ELEV	AMOUNT PENETRATION	TRIGGER EVENT	DISPOSITION	STAGE TO CORRECT
346	ROAD +15	81+58/57R 83+50/130L	11.0	15.0	26.0	APPROACH SITING	20.0	6.0	EXISTING	TO REMAIN	

OFZ PENETRATIONS (RUNWAY 5/23)

ID #	DESCRIPTION	STATION/OFFSET	GRD ELEV	AGL	TOP ELEV	SURFACE PENETRATED	SURFACE ELEV	AMOUNT PENETRATION	TRIGGER EVENT	DISPOSITION	STAGE TO CORRECT
347	TERRAIN (RUNWAY SURFACE)	-0+30/45L 1+70/40R	19.8	0	19.8	OFZ	19.5	0.3	EXISTING	TO REMAIN	
348	TERRAIN (RUNWAY SURFACE)	9+50/0 12+50/85R	16.0	0	16.0	OFZ	14.9	1.1	EXISTING	TO REMAIN	
349	TERRAIN (RUNWAY SURFACE)	14+25/0 16+00/55L	13.2	0	13.2	OFZ	12.9	0.3	EXISTING	TO REMAIN	
350	TERRAIN	79+58/68L 81+58/200R	*19.4	0	*19.4	OFZ	16.9	2.5	EXISTING	TO REMAIN	
351	ROAD+15	80+06/200R 89+37/762L	11.5	15.0	26.5	OFZ	16.9	9.6	EXISTING	TO REMAIN	

DEPARTURE SURFACE OBSTACLES (RUNWAY 5)

ID #	DESCRIPTION	STATION/OFFSET	GRD ELEV	AGL	TOP ELEV	SURFACE PENETRATED	SURFACE ELEV	AMOUNT PENETRATION	TRIGGER EVENT	DISPOSITION	STAGE TO CORRECT
20	REIL LIGHT	79+67/119R	15.4	4.7	20.1	DEPARTURE	16.9	3.2	EXISTING	TO REMAIN	
21	REIL LIGHT	79+66/119L	15.6	4.5	20.1	DEPARTURE	16.9	3.2	EXISTING	TO REMAIN	
352	ROAD +15	79+58/252R 83+31/110L	11.0	15.0	26.0	DEPARTURE	23.0	3.0	EXISTING	TO REMAIN	
353	TERRAIN	79+58/201R 81+08/482R	*31.0	0	*31.0	DEPARTURE	18.0	13.0	EXISTING	TO REMAIN	
354	TERRAIN	178+50/2918L	276.0	0	276.0	DEPARTURE	265.0	11.0	EXISTING	TO REMAIN	

DEPARTURE SURFACE OBSTACLES (RUNWAY 23)

ID #	DESCRIPTION	STATION/OFFSET	GRD ELEV	AGL	TOP ELEV	SURFACE PENETRATED	SURFACE ELEV	AMOUNT PENETRATION	TRIGGER EVENT	DISPOSITION	STAGE TO CORRECT
1	POLE	-13+20/396R	65.2	27.9	93.1	DEPARTURE	56.7	36.4	EXISTING	TO REMAIN	
2	POLE	-13+43/361R	69.9	29.1	99.0	DEPARTURE	57.3	41.7	EXISTING	TO REMAIN	
3	POLE	-17+05/187L	81.5	25	106.5	DEPARTURE	66.7	39.8	EXISTING	TO REMAIN	
4	POLE	-16+30/58L	76.7	28.3	105.0	DEPARTURE	64.5	40.5	EXISTING	TO REMAIN	
5	POLE	-17+92/322L	92.4	21.4	113.8	DEPARTURE	68.6	45.2	EXISTING	TO REMAIN	
6	POLE	-18+39/417L	105.4	24.1	129.5	DEPARTURE	70.5	59.0	EXISTING	TO REMAIN	
7	TACAN TOWER	-43+61/396R	378.7	34.2	412.9	DEPARTURE	132.8	280.1	EXISTING	TO REMAIN	
8	POLE	-44+49/469R	377.5	38.6	416.1	DEPARTURE	134.6	281.5	EXISTING	TO REMAIN	
9	RADAR DOME	-45+37/413R	366.7	28.4	395.1	DEPARTURE	137.2	257.9	EXISTING	TO REMAIN	
10	DME ANTENNA	-45+82/402R	366.3	28.8	395.1	DEPARTURE	138.3	256.8	EXISTING	TO REMAIN	
11	NDB TOWER	-44+75/0	327.0	70.0	397.0	DEPARTURE	135.6	261.4	EXISTING	TO REMAIN	
12	NDB SHELTER	-46+25/0	327.0	70.0	397.0	DEPARTURE	139.4	257.6	EXISTING	TO REMAIN	
13	NDB TOWER	-47+75/0	327.0	70.0	397.0	DEPARTURE	143.1	253.9	EXISTING	TO REMAIN	
16	POLE	-8+87/771L	125.9	18.2	144.1	DEPARTURE	45.9	98.2	EXISTING	TO REMAIN	
18	POLE	-22+06/898L	150.5	18.5	169.0	DEPARTURE	78.9	90.1	EXISTING	TO REMAIN	
34	TANK	-39+84/1512R	277.0	35.4	312.4	DEPARTURE	123.3	189.1	EXISTING	TO REMAIN	
35	TANK	-40+37/1509R	277.0	35.0	312.0	DEPARTURE	124.7	187.3	EXISTING	TO REMAIN	
36	TANK	-39+96/1460R	277.0	35.0	312.0	DEPARTURE	123.7	208.3	EXISTING	TO REMAIN	
40	POLE	-31+67/1174L	150.7	18.9	169.6	DEPARTURE	102.9	66.7	EXISTING	TO REMAIN	
41	POLE	-22+92/1034L	154.5	15.1	169.6	DEPARTURE	81.1	88.5	EXISTING	TO REMAIN	
105	POLE	-14+26/239R	57.7	26.0	83.7	DEPARTURE	59.4	24.3	EXISTING	TO REMAIN	
106	POLE	-21+22/777L	144.1	16.7	160.8	DEPARTURE	76.8	84.0	EXISTING	TO REMAIN	
137	POLE	-14+81/157R	62.0	24.6	86.6	DEPARTURE	60.8	25.8	EXISTING	TO REMAIN	
138	POLE	-15+43/71R	63.4	29.6	93.0	DEPARTURE	62.3	30.7	EXISTING	TO REMAIN	
209	BUILDING	-35+54/1024R	273.9	23.1	297.0	DEPARTURE	112.6	184.4	EXISTING	TO REMAIN	
355	TERRAIN	1+70/3233L -100+23/3233R	*471.0	0	*471.0	DEPARTURE	273.0	198.0	EXISTING	TO REMAIN	
356	TERRAIN	1+36/485R	41.0	0	41.0	DEPARTURE	19.0	22.0	EXISTING	TO REMAIN	
357	ROAD+15	-14+62/927R -2+89/613L	53.0	15	68.0	DEPARTURE	51.0	17.0	EXISTING	TO REMAIN	

* DATA ESTIMATED

* HIGHEST FEATURE IN A LARGE AREA OF TERRAIN PENETRATION. REFER TO HATCHED AREAS ON MAP.

Date Plotted: 15/08/2017 1:36 PM
 Layout Name: 19-DATA
 File Name: W:\Projects\Adak\ALP\ALP_2015\ALP_2016_Revision\ALP-ADK-U-DEPT-PAP.dwg
 Designed By: [Blank]
 Drawn By: [Blank]
 Checked By: [Blank]

SIGNIFICANT OBJECTS											
ID #	DESCRIPTION	STATION/OFFSET	GRD ELEV	AGL	TOP ELEV	SURFACE PENETRATED	SURFACE ELEV	AMOUNT PENETRATION	TRIGGER EVENT	DISPOSITION	STAGE TO CORRECT
100	POLE	86+71/1091L	13.6	55.4	69.0	NONE	N/A	N/A	EXISTING	TO REMAIN	
101	POLE	86+60/1130L	13.7	55.4	69.1				EXISTING	TO REMAIN	
102	POLE	86+49/1170L	13.7	55.5	69.2				EXISTING	TO REMAIN	
103	POLE	82+89/1039L	14.3	36.6	50.9				EXISTING	TO REMAIN	
104	POLE	86+71/1082L	13.5	57.6	71.1				EXISTING	TO REMAIN	
105	POLE	-14+26/239R	57.7	26.0	83.7				EXISTING	TO REMAIN	
106	POLE	-21+22/777L	144.1	16.7	160.8				EXISTING	TO REMAIN	
* 107	WIND CONE	73+59/556R	12	8	20				EXISTING	TO REMAIN	
108	NOT USED										
109	POLE	55+85/807L	10.6	12.1	22.7				EXISTING	TO REMAIN	
110	POLE	51+09/1616L	60.8	37.1	97.9				EXISTING	TO REMAIN	
111	POLE	49+81/1391L	69.6	28.1	97.7				EXISTING	TO REMAIN	
112	POLE	48+77/1300L	72.7	4.7	77.4				EXISTING	TO REMAIN	
113	LIGHTED WIND CONE	31+93/506R	14.5	19.3	33.8				EXISTING	LIGHTED	
114	WIND CONE	6+01/350R	14.2	17.8	32.0				EXISTING	TO REMAIN	
* 115	ROTATING BEACON	30+45/1425R	15.3	30	45.3						
116	NOT USED										
117	NOT USED										
118	POLE	-27+21/1093L	149.1	15.2	164.3				EXISTING	TO REMAIN	
119	NOT USED										
120	SIGN	9+92/3139R	7.6	4.4	12.0				EXISTING	TO REMAIN	
121	POLE	-21+23/4086R	52.0	24.9	76.9				EXISTING	TO REMAIN	
122	POLE	-17+44/5508R	5.5	17.1	22.6				EXISTING	TO REMAIN	
123	POLE	-23+90/5763R	44.0	23.6	67.6				EXISTING	TO REMAIN	
124	POLE	-18+21/5391R	25.6	21.3	46.9				EXISTING	TO REMAIN	
125	POLE	-7+63/6390R	16.1	48.1	64.2				EXISTING	TO REMAIN	
126	POLE	-7+99/6508R	15.7	38.0	53.7				EXISTING	TO REMAIN	
127	POLE	-8+32/6618R	11.8	38.4	50.2				EXISTING	TO REMAIN	
128	POLE	-8+65/6721R	8.8	39.7	48.5				EXISTING	TO REMAIN	
129	POLE	-9+53/6681R	10.0	39.2	49.2				EXISTING	TO REMAIN	
130	POLE	-83+04/10015R	263.2	28.4	291.6				EXISTING	TO REMAIN	
131	POLE	-81+35/10143R	250.0	25.0	275.0				EXISTING	TO REMAIN	
132	POLE	-79+70/10262R	228.2	24.3	252.5				EXISTING	TO REMAIN	
133	POLE	-77+48/10429R	202.9	26.1	229.0				EXISTING	TO REMAIN	
134	NOT USED										
135	POLE	45+75/1108L	56.7	37.0	93.7				EXISTING	TO REMAIN	
136	LOCALIZER	-6+34/2L	31.8	6.5	38.3				EXISTING	TO REMAIN	
137	POLE	-14+81/157R	62.0	24.6	86.6				EXISTING	TO REMAIN	
138	POLE	-15+43/71R	63.4	29.6	93.0				EXISTING	TO REMAIN	
139	POLE	-84+31/9923R	278.7	28.0	306.7				EXISTING	TO REMAIN	
140	ELECTRICAL EQUIPMENT	39+50/479R	11.4	7.1	18.5	NONE	N/A	N/A	EXISTING	TO REMAIN	

* DATA ESTIMATED

NOTE:

- STATION AND OFFSET BASED ON RUNWAY 5-23
- ITEMS IN THIS TABLE WERE IDENTIFIED IN THE AERONAUTICAL SURVEY AS SAFETY CRITICAL OBJECTS BUT DO NOT PENETRATE ANY PART 77, AC 50/5300-13A DESIGN OR SITING SURFACES. ONLY OBJECTS WITHIN THE APPROACH SURFACE FOOTPRINTS ARE LABELED ON THE PLANS

BUILDINGS					
NO.	DESCRIPTION	STA & OFFSET	ELEV	STATUS	OBSTRUCTION LIGHT
200	BUILDING	46+13/1316L	79.0	UNKNOWN	NOT REQUIRED
201	CONTROL TOWER & OPERATIONS	27+47/1163R	75.4	NON-OP	LIGHTED
202	OMD HANGER	20+49/2396R	71.2	IN SERVICE	LIGHTED
203	HOUSING	-13+58/2844R	75.0 (EST)	IN SERVICE	NOT REQUIRED
204	NOT USED				
205	NOT USED				
206	DORMITORY	-23+30/5665R	63.3	UNKNOWN	NOT REQUIRED
207	NOT USED				
208	DORMITORY	-20+31/5545R	54.6	UNKNOWN	NOT REQUIRED
209	BUILDING	-35+54/1024R	297.0	UNKNOWN	
210	BERING BARRACKS COMPLEX	-29+91/1919L	170.2	NON-OP	
211	CHURCH	-33+88/2296R	183.5	UNKNOWN	
212	BUILDING	-41+44/2457R	181.6	UNKNOWN	
213	BUILDING	-37+37/2752R	224.9	UNKNOWN	
214	BUILDING	25+85/7328L	452.9	UNKNOWN	
215	BUILDING	37+82/6985L	410.2	UNKNOWN	
216	BUILDING	39+62/6799L	441.1	UNKNOWN	
217	BUILDING	41+60/7005L	431.2	UNKNOWN	
218	BUILDING	42+52/6864L	424.9	UNKNOWN	
219	BUILDING	42+83/6697L	431.9	UNKNOWN	
220	AIR TERMINAL	9+79/4305R	UNKNOWN	IN SERVICE	LIGHTED
221	FUEL STORAGE	11+87/3765R	UNKNOWN	NON-OP	
222	VP HANGER	17+24/3110R	UNKNOWN	IN SERVICE	LIGHTED
223	ARFF STATION	29+94/1505R	UNKNOWN	IN SERVICE	NOT REQUIRED
224	BALLOON LAUNCH BUILDING	32+42/1265R	UNKNOWN	NON-OP	NOT REQUIRED
* 225	APPROACH LIGHTING CONTROL BLDG	80+06/103R	UNKNOWN	IN SERVICE	NOT REQUIRED
* 226	GLIDE SLOPE & AWOS SHELTER	70+37/315L	21.0	IN SERVICE	LIGHTED
* 227	LOCALIZER SHELTER	-6+14/218R	34.6	IN SERVICE	NOT REQUIRED
228	YAKATAT HANGER	-5+83/1420R	UNKNOWN	UNKNOWN	
229	POWER PLANT #3	-15+64/2295R	UNKNOWN	IN SERVICE	
230	NOT USED				
231	BIRCHWOOD BARRACKS COMPLEX	32+97/2009R	UNKNOWN	NON-OP	
232	HOSPITAL	29+08/2687R	UNKNOWN	NON-OP	
233	STEAM PLANT	32+32/2430R	UNKNOWN	IN SERVICE	
234	MEDICAL CLINIC	29+78/3714R	UNKNOWN	UNKNOWN	
235	RECREATION CENTER	26+72/3970R	UNKNOWN	UNKNOWN	
236	PERSONNEL SUPPORT CENTER	29+97/4357R	UNKNOWN	UNKNOWN	
237	HIGH SCHOOL & CITY ADMIN	16+85/4967R	UNKNOWN	UNKNOWN	
238	ELEMENTARY SCHOOL	22+05/5265R	UNKNOWN	IN SERVICE	
239	PUBLIC WORKS	20+93/6103R	UNKNOWN	INSERVICE	
240	SEWAGE TREATMENT FACILITY	33+58/7333R	UNKNOWN	INSERVICE	

NOTES:

- SOME BUILDINGS ARE NOT LOCATED WITHIN THE TERMINAL AREA.
- REFER TO SIGNIFICANT OBJECT TABLE FOR OBJECTS THAT ARE NOT PENETRATIONS.
- REFER TO SURFACE PENETRATION TABLES FOR BUILDING PENETRATION DATA.
- STATIONS/OFFSETS IN THIS TABLE ARE BASED ON RUNWAY 5/23.

BY	DATE	REVISION
	4/4/2017	AS-BUILT PER PROJECT Z549720000

STATE OF ALASKA
DEPARTMENT OF TRANSPORTATION
AND PUBLIC FACILITIES
CENTRAL REGION

ADAK AIRPORT
 ADAK, ALASKA
 AIRPORT LAYOUT PLAN
 SIGNIFICANT OBJECTS &
 BUILDING TABLES

DATE:
 AUGUST 2015
 SHEET:
 18
 OF
 24

Date Plotted: 15/08/2017 1:44 PM
 User Name: 20-TECH
 File Name: W:\Projects\Adak\AIP\AIP-ADK-TERMINAL_LAYOUT.dwg
 Design By: 18
 Drawn By:
 Checked By:

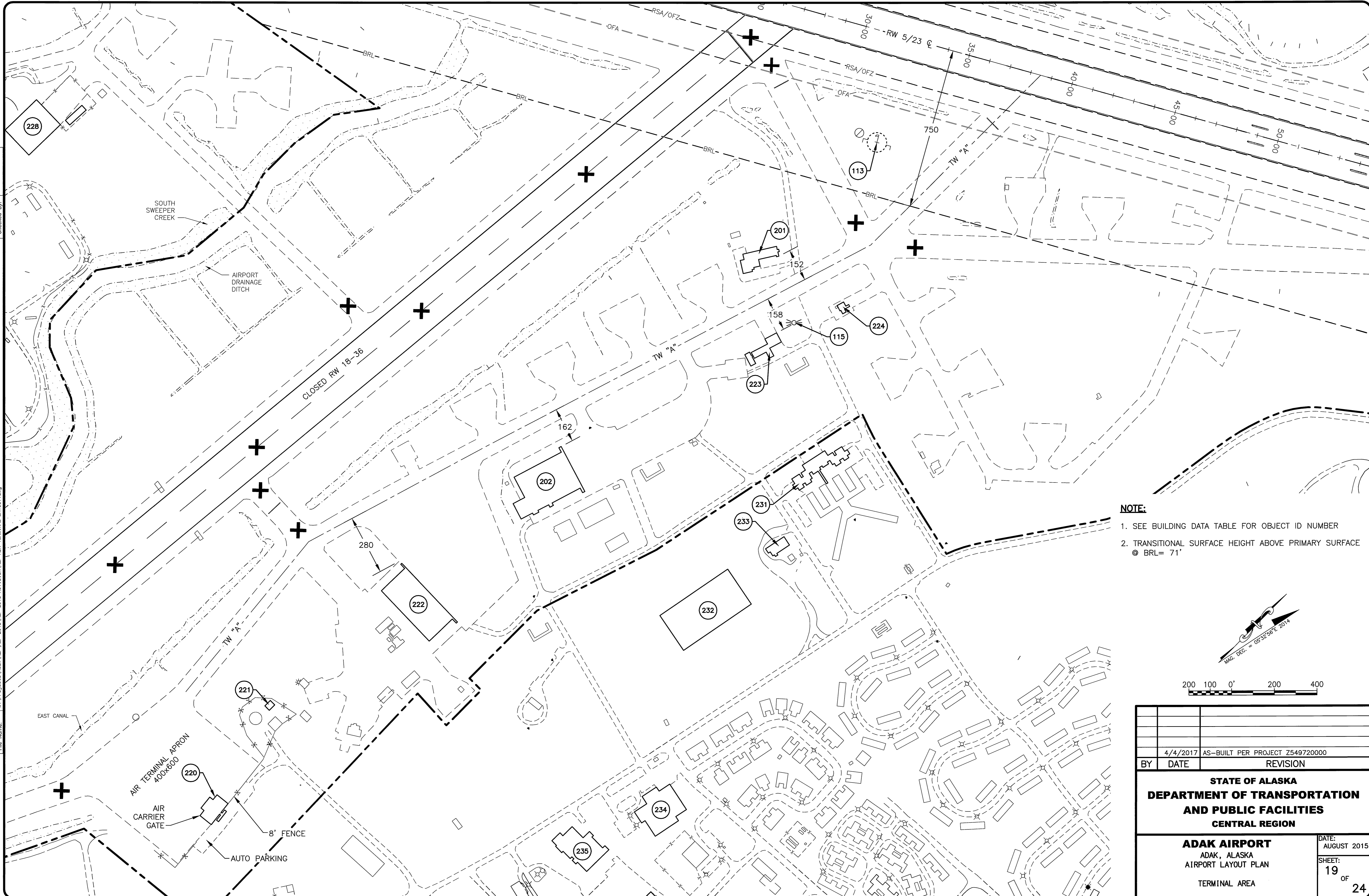

NOTE:

- SEE BUILDING DATA TABLE FOR OBJECT ID NUMBER
- TRANSITIONAL SURFACE HEIGHT ABOVE PRIMARY SURFACE
 © BRL= 71'

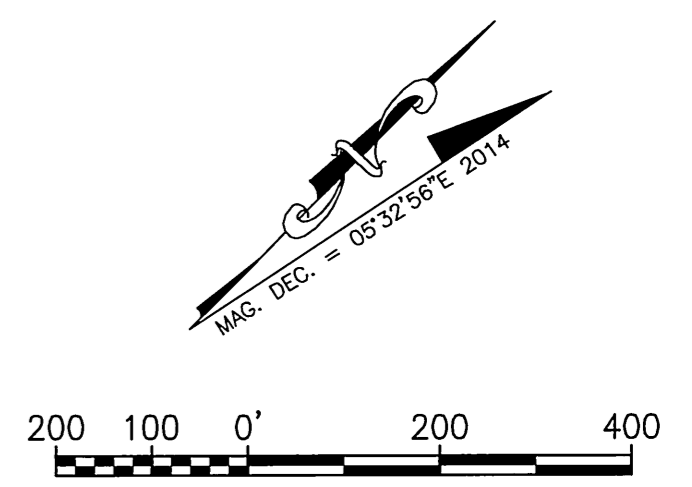

BY	DATE	AS-BUILT PER PROJECT Z549720000	REVISION
STATE OF ALASKA DEPARTMENT OF TRANSPORTATION AND PUBLIC FACILITIES CENTRAL REGION			
ADAK AIRPORT ADAK, ALASKA AIRPORT LAYOUT PLAN TERMINAL AREA		DATE: AUGUST 2015	SHEET: 19 OF 24

PART 77 SURFACE OBSTRUCTIONS

ID #	DESCRIPTION	STATION/OFFSET	GRD ELEV	AGL	TOP ELEV	SURFACE PENETRATED	SURFACE ELEV	AMOUNT PENETRATION	TRIGGER EVENT	DISPOSITION	STAGE TO CORRECT
1	POLE	-13+20/396R	65.2	27.9	93.1	TRANSITIONAL	86.5	6.6	EXISTING	TO REMAIN	
2	POLE	-13+43/361R	69.9	29.1	99.0	RW 5 APPROACH	85.1	13.9	EXISTING	TO REMAIN	
3	POLE	-17+05/187L	81.5	25	106.5	RW 5 APPROACH	103.3	3.2	EXISTING	TO REMAIN	
4	POLE	-16+30/58L	76.7	28.3	105.0	RW 5 APPROACH	99.5	5.5	EXISTING	TO REMAIN	
5	POLE	-17+92/322L	92.4	21.4	113.8	RW 5 APPROACH	107.6	6.2	EXISTING	TO REMAIN	
6	POLE	-18+39/417L	105.4	24.1	129.5	RW 5 APPROACH	111.4	18.1	EXISTING	TO REMAIN	
7	TACAN TOWER	-43+61/396R	378.7	34.2	412.9	HORIZONTAL	170.0	242.9	EXISTING	TO REMAIN	
8	POLE	-44+35/444R	377.5	38.6	416.1	HORIZONTAL	170.0	246.1	EXISTING	TO REMAIN	
9	RADAR DOME	-45+37/413R	366.7	28.4	395.1	HORIZONTAL	170.0	225.1	EXISTING	TO REMAIN	
10	DME ANTENNA	-45+82/402R	366.3	28.8	395.1	HORIZONTAL	170.0	225.1	EXISTING	TO REMAIN	
11	NDB TOWER	-44+75/0	327.0	70.0	397.0	HORIZONTAL	170.0	227.0	EXISTING	TO REMAIN	
12	NDB SHELTER	-46+25/0	327.0	70.0	397.0	HORIZONTAL	170.0	327.0	EXISTING	TO REMAIN	
13	NDB TOWER	-47+75/0	327.0	70.0	397.0	HORIZONTAL	170.0	327.0	EXISTING	TO REMAIN	
14	POLE	-5+93/1369L	163.4	9.4	172.8	HORIZONTAL	170.0	2.8	EXISTING	TO REMAIN	
15	POLE	-6+79/1247L	160.2	16.9	177.1	HORIZONTAL	170.0	7.1	EXISTING	TO REMAIN	
16	POLE	-8+87/771L	125.9	18.2	144.1	TRANSITIONAL	124.5	19.6	EXISTING	TO REMAIN	
17	NOT USED										
18	POLE	-22+06/898L	150.5	18.5	169.0	HORIZONTAL	170.0	1 ^	EXISTING	TO REMAIN	
19	NOT USED										
20	REIL	79+67/119L	15.4	4.7	20.1	PRIMARY	16.9	3.2	EXISTING	FRANGIBLE	
21	REIL	79+66/119R	15.6	4.5	20.1	PRIMARY	16.9	3.2	EXISTING	FRANGIBLE	
22	NOT USED										
23	POLE	42+19/3604L	270.2	24.5	294.7	HORIZONTAL	170.0	124.7	EXISTING	TO REMAIN	
24	POLE	43+56/3476L	250.9	25.0	275.9	HORIZONTAL	170.0	105.9	EXISTING	TO REMAIN	
25	POLE	44+92/3347L	227.9	23.4	251.3	HORIZONTAL	170.0	81.3	EXISTING	TO REMAIN	
26	POLE	46+29/3223L	186.2	27.5	213.7	HORIZONTAL	170.0	43.7	EXISTING	TO REMAIN	
27	TANK	54+85/2472R	213.8	39.0	252.8	HORIZONTAL	170.0	82.8	EXISTING	TO REMAIN	
28	TANK	53+89/2489R	214.4	38.4	252.8	HORIZONTAL	170.0	82.8	EXISTING	TO REMAIN	
29	POLE	-86+11/9793R	309.1	27.4	336.5	CONICAL	321.0	15.5	EXISTING	TO REMAIN	
30	BUNKER	-92+69/3967R	304.8	10.6	315.4	CONICAL	172.8	142.6	EXISTING	TO REMAIN	
31	BUNKER	-91+86/3278R	294.8	15.3	310.1	HORIZONTAL	170.0	140.1	EXISTING	TO REMAIN	
32	POLE	-36+01/2653R	154.6	26.2	180.8	HORIZONTAL	170.0	10.8	EXISTING	TO REMAIN	
33	POLE	-29+67/2073R	128.2	44.4	172.6	HORIZONTAL	170.0	2.6	EXISTING	TO REMAIN	
34	TANK	-39+84/1512R	277.0	35.4	312.4	HORIZONTAL	170.0	142.4	EXISTING	TO REMAIN	
35	TANK	-40+37/1509R	277.0	35.0	312.0	HORIZONTAL	170.0	142.0	EXISTING	TO REMAIN	
36	TANK	-39+96/1460R	277.0	35.0	312.0	HORIZONTAL	170.0	142.0	EXISTING	TO REMAIN	
37	POLE	-42+26/1334L	176.6	27.3	203.9	HORIZONTAL	170.0	33.9	EXISTING	TO REMAIN	
38	POLE	-38+91/1299L	166.5	11.1	177.6	HORIZONTAL	170.0	7.6	EXISTING	TO REMAIN	
39	POLE	-36+13/1253L	161.7	18.2	179.9	HORIZONTAL	170.0	9.9	EXISTING	TO REMAIN	
40	POLE	-31+67/1174L	150.7	18.9	169.6	HORIZONTAL	170.0	1 ^	EXISTING	TO REMAIN	
41	POLE	-22+92/1034L	154.5	15.1	169.6	HORIZONTAL	170.0	1 ^	EXISTING	TO REMAIN	
42	POLE	-5+35/1451L	166.6	21.6	188.2	HORIZONTAL	170.0	18.2	EXISTING	TO REMAIN	
43	POLE	-4+55/1561L	172.4	22.7	195.1	HORIZONTAL	170.0	25.1	EXISTING	TO REMAIN	
44	POLE	-3+74/1676L	176.8	22.2	199.0	HORIZONTAL	170.0	29.0	EXISTING	TO REMAIN	
45	POLE	-3+04/1775L	177.0	19.4	196.4	HORIZONTAL	170.0	26.4	EXISTING	TO REMAIN	
46	POLE	-2+32/1880L	182.9	23.7	206.6	HORIZONTAL	170.0	36.6	EXISTING	TO REMAIN	
47	POLE	-1+61/1978L	180.4	25.9	206.3	HORIZONTAL	170.0	36.3	EXISTING	TO REMAIN	
48	POLE	0+41/2489L	212.9	28.6	241.5	HORIZONTAL	170.0	71.5	EXISTING	TO REMAIN	
49	POLE	2+26/2797L	251.8	16.7	268.5	HORIZONTAL	170.0	98.5	EXISTING	TO REMAIN	
50	POLE	3+21/2911L	267.5	24.7	292.2	HORIZONTAL	170.0	122.2	EXISTING	TO REMAIN	

PART 77 SURFACE OBSTRUCTIONS CONTINUED

ID #	DESCRIPTION	STATION/OFFSET	GRD ELEV	AGL	TOP ELEV	SURFACE PENETRATED	SURFACE ELEV	AMOUNT PENETRATION	TRIGGER EVENT	DISPOSITION	STAGE TO CORRECT
51	POLE	5+04/3129L	297.6	22.9	320.5	HORIZONTAL	170.0	150.5	EXISTING	TO REMAIN	
52	POLE	7+05/3366L	323.8	21.9	345.7	HORIZONTAL	170.0	175.7	EXISTING	TO REMAIN	
53	POLE	10+64/3818L	349.4	13.8	363.2	HORIZONTAL	170.0	193.2	EXISTING	TO REMAIN	
54	POLE	12+89/4126L	344.4	29.5	373.9	HORIZONTAL	170.0	203.9	EXISTING	TO REMAIN	
55	POLE	14+29/4319L	379.4	27.0	376.4	HORIZONTAL	170.0	206.4	EXISTING	TO REMAIN	
56	POLE	15+67/4507L	371.4	26.6	398.0	HORIZONTAL	170.0	228.0	EXISTING	TO REMAIN	
57	POLE	17+12/4701L	383.1	27.0	410.1	HORIZONTAL	170.0	240.1	EXISTING	TO REMAIN	
58	POLE	18+54/4900L	380.7	29.4	410.1	HORIZONTAL	170.0	240.1	EXISTING	TO REMAIN	
59	POLE	19+82/5038L	370.4	30.9	401.3	HORIZONTAL	170.0	231.3	EXISTING	TO REMAIN	
60	POLE	21+38/5217L	362.9	26.3	389.2	HORIZONTAL	170.0	219.2	EXISTING	TO REMAIN	
61	POLE	22+83/6314L	419.9	70.5	490.4	HORIZONTAL	170.0	320.4	EXISTING	TO REMAIN	
62	POLE	10+99/5940L	405.3	32.3	437.6	HORIZONTAL	170.0	267.6	EXISTING	TO REMAIN	
63	POLE	-11+94/6930L	580.4	23.1	603.5	HORIZONTAL	170.0	433.5	EXISTING	TO REMAIN	
64	POLE	-18+20/10326L	804.4	24.7	829.1	CONICAL	194.0	635.1	EXISTING	TO REMAIN	
65	TANK	26+67/11100L	626.8	15.1	641.9	CONICAL	225.0	416.9	EXISTING	TO REMAIN	
66	POLE	25+60/10092L	539.4	10.8	550.2	CONICAL	174.6	375.6	EXISTING	TO REMAIN	
67	POLE	39+86/7003L	405.2	60.6	465.8	HORIZONTAL	170.0	295.8	EXISTING	TO REMAIN	
68	POLE	41+29/7206L	401.5	51.9	453.4	HORIZONTAL	170.0	283.4	EXISTING	TO REMAIN	
69	TANK	66+07/7928L	222.0	23.0	245.0	HORIZONTAL	170.0	75.0	EXISTING	TO REMAIN	
70	TANK	65+58/7879L	214.9	23.2	238.1	HORIZONTAL	170.0	68.1	EXISTING	TO REMAIN	
71	SIGN	35+60/180L	8.4	4.5	12.9	PRIMARY	11.1	1.8	EXISTING	FRANGIBLE	
72	SIGN	35+79/133R	9.0	4.0	13.0	PRIMARY	11.1	1.9	EXISTING	FRANGIBLE	
73	SIGN	31+45/487R	14.2	4.5	18.7	PRIMARY	11.1	7.6	EXISTING	FRANGIBLE	
74	SIGN	15+60/178L	10.8	4.7	15.5	PRIMARY	13.2	2.3	EXISTING	FRANGIBLE	
75	ANTENNA, GUIDE SLOPE	70+58/324L	11.1	38.2	49.3	TRANSITIONAL	25.1	24.2	EXISTING	TO REMAIN	
76	CELL TOWER	-105+81/3297L	602.5	66.2	668.7	CONICAL	222.7	446.0	EXISTING	TO REMAIN	

⊕ DATA ESTIMATED
 ^ ELEVATION DIFFERENCE BELOW DATA CONFIDENCE THRESHOLD
 NOTE: STATION AND OFFSET BASED ON RUNWAY 5-23

Date Plotted: 15/08/2017 - 2:07 PM
 Layout Name: 24-P77-TABLES
 File Name: W:\Projects\Adak\ALP\2015\ALP_2016_Revision\ALP-ADK-PART 77.dwg
 Designed By:
 Drawn By:
 Checked By:

BY	DATE	REVISION
	4/4/2017	AS-BUILT PER PROJECT Z549720000

STATE OF ALASKA
 DEPARTMENT OF TRANSPORTATION
 AND PUBLIC FACILITIES
 CENTRAL REGION

ADAK AIRPORT
 ADAK, ALASKA
 AIRPORT LAYOUT PLAN
 AIRPORT AIRSPACE, 14 CFR, PART 77
 DATA TABLES

DATE:
 AUGUST 2015
 SHEET:
 22 OF
 24

PART 77 SURFACE OBSTRUCTIONS CONTINUED											
ID #	DESCRIPTION	STATION/OFFSET	GRD ELEV	AGL	TOP ELEV	SURFACE PENETRATED	SURFACE ELEV	AMOUNT PENETRATION	TRIGGER EVENT	DISPOSITION	STAGE TO CORRECT
209	BUILDING	-35+54/1024L	273.9	23.1	297.0	HORIZONTAL	170.0	127.0	EXISTING	TO REMAIN	
210	BARRACKS COMPLEX	-29+91/1919L	127.3	42.9	170.2	HORIZONTAL	170.0	0.2	EXISTING	TO REMAIN	
211	CHURCH	-33+88/2296L	134.4	47.1	183.5	HORIZONTAL	170.0	13.5	EXISTING	TO REMAIN	
212	BUILDING	-41+44/2457L	161.4	20.2	181.6	HORIZONTAL	170.0	11.6	EXISTING	TO REMAIN	
213	BUILDING	-37+37/2752L	156.5	68.4	224.9	HORIZONTAL	170.0	54.9	EXISTING	TO REMAIN	
214	BUILDING	25+85/7328R	428.9	24.0	452.9	HORIZONTAL	170.0	282.9	EXISTING	TO REMAIN	
215	BUILDING	37+82/6985R	398.6	11.6	410.2	HORIZONTAL	170.0	240.2	EXISTING	TO REMAIN	
216	BUILDING	39+62/6799R	409.0	32.1	441.1	HORIZONTAL	170.0	271.1	EXISTING	TO REMAIN	
217	BUILDING	41+60/7005R	409.4	21.8	431.2	HORIZONTAL	170.0	261.2	EXISTING	TO REMAIN	
218	BUILDING	42+52/6864R	408.7	16.2	424.9	HORIZONTAL	170.0	254.9	EXISTING	TO REMAIN	
219	BUILDING	42+83/6697R	405.4	26.5	431.9	HORIZONTAL	170.0	261.9	EXISTING	TO REMAIN	

PART 77 SURFACE OBSTRUCTIONS CONTINUED											
ID #	DESCRIPTION	STATION/OFFSET	GRD ELEV	AGL	TOP ELEV	SURFACE PENETRATED	SURFACE ELEV	AMOUNT PENETRATION	TRIGGER EVENT	DISPOSITION	STAGE TO CORRECT
300	ROAD+15	-20+49/720L	140.2	15.0	155.2	RW 5 APPROACH/TRANSITIONAL	114.3	40.9	EXISTING	TO REMAIN	
		-16+56/191L									
301	ROAD+15	-10+16/204L	74.8	15.0	89.8	RW 5 APPROACH/TRANSITIONAL	41.6	48.2	EXISTING	TO REMAIN	
		0+13/675I									
302	ROAD+15	78+88/322R	11.6	15.0	26.6	RW 23 APPROACH/PRIMARY/TRANSITIONAL	16.9	9.7	EXISTING	TO REMAIN	
		84+88/295L									
303	NOT USED										
304	ROAD+15	-30+40/704R	238.0	15.0	253.0	RW 5 APPROACH/TRANSITIONAL	170.0	83.0	EXISTING	TO REMAIN	
		-25+96/188R									
305	ROAD+10	1+67/1870L	170.0	10.0	180.0	HORIZONTAL	170.0	10.0	EXISTING	TO REMAIN	
306	ROAD+15	-33+18/516L	170.0	15.0	185.0	HORIZONTAL	170.0	15.0	EXISTING	TO REMAIN	
		-35+59/1310L									
307	ROAD+15	-23+70/1006L	170.0	15.0	185.0	HORIZONTAL	170.0	15.0	EXISTING	TO REMAIN	
		-43+38/1434L									
308	TERRAIN	-15+62/208L	97.0	0	97.0	RW 5 APPROACH	96.0	1.0	EXISTING	TO REMAIN	
309	TERRAIN	-14+12/222L	*80.0	0	*80.0	RW 5 APPROACH/TRANSITIONAL	55.2	24.8	EXISTING	TO REMAIN	
		6+00/900L									
310	TERRAIN	0+00/0	19.8	0	19.8	PRIMARY	19.5	0.3	EXISTING	TO REMAIN	
311	TERRAIN	3+29/426R	59.0	0	59.0	TRANSITIONAL	44.1	14.9	EXISTING	TO REMAIN	
312	TERRAIN	81+04/32L	19.4	0	19.4	PRIMARY	16.9	2.5	EXISTING	TO REMAIN	
313	TERRAIN	80+28/288R	31.6	0	31.6	PRIMARY	16.9	14.7	EXISTING	TO REMAIN	
314	TERRAIN	-140+36/218L	*474.0	0	*474.0	CONICAL	321.0	153.0	EXISTING	TO REMAIN	
		-112+37/1843R									
315	TERRAIN	-128+12/2655R	353.0	0	353.0	CONICAL	324.0	31.0	EXISTING	TO REMAIN	
316	TERRAIN	-127+22/5862L	*433.0	0	*433.0	CONICAL	363.0	70.0	EXISTING	TO REMAIN	
		-104+10/7560L									
317	TERRAIN	-111+67/10432R	*639.0	0	*639.0	CONICAL	327.0	312.0	EXISTING	TO REMAIN	
		-56+06/6440R									
318	TERRAIN	-51+33/10227R	*426.0	0	*426.0	HORIZONTAL/CONICAL	254.0	172.0	EXISTING	TO REMAIN	
		-30+23/11923R									
319	TERRAIN	-35+81/5514L	198.0	0	198.0	HORIZONTAL	170.0	28	EXISTING	TO REMAIN	
320	TERRAIN	-30+40/105L	*230.0	0	*230.0	RW 5 APPROACH/TRANSITIONAL	170.0	60.0	EXISTING	TO REMAIN	
		-15+98/770R									
321	TERRAIN	-131+71/13998L	*777.0	0	*777.0	HORIZONTAL/CONICAL	170.0	607.0	EXISTING	TO REMAIN	
		79+16/7592R									
322	TERRAIN	-8+35/10227R	*522.0	0	*522.0	CONICAL	365.0	157.0	EXISTING	TO REMAIN	
		53+80/14000R									
323	TERRAIN	39+25/5744R	205.0	0	205.0	HORIZONTAL	170.0	35.0	EXISTING	TO REMAIN	
324	TERRAIN	46+35/412L	*82.0	0	*82.0	TRANSITIONAL	44.6	37.4	EXISTING	EXISTING	
		51+78/710L									
325	TERRAIN	52+36/2066R	*227.0	0	*227.0	HORIZONTAL	170.0	57.0	EXISTING	TO REMAIN	
		56+99/2766R									
326	TERRAIN	84+99/8003L	*193.0	0	*193.0	HORIZONTAL	170.0	23.0	EXISTING	TO REMAIN	
		90+26/8637L									
327	TERRAIN	89+05/8856L	*268.0	0	*268.0	HORIZONTAL	170.0	98.0	EXISTING	TO REMAIN	
		100+55/10527L									
328	TERRAIN	96+36/5643L	*214.0	0	*214.0	HORIZONTAL	170.0	44.0	EXISTING	TO REMAIN	
		110+58/6636L									
329	TERRAIN	112+86/11614L	*234.0	0	*234.0	HORIZONTAL/CONICAL	183.0	51.0	EXISTING	TO REMAIN	
		192+12/3323L									
330	TERRAIN	170+15/2745L	*276.0	0	*276.0	HORIZONTAL/CONICAL	176.0	100.0	EXISTING	TO REMAIN	
		181+58/3376L									

Date Plotted: 5/09/2017, 2:08 PM
 Layout Name: Z5-P77-TABLES
 File Name: H:\Projects\Adak\ALP\2015\ALP_2015\ALP_2015\Revision\ALP-ADK-PART_77.dwg
 Designed By:
 Drawn By:
 Checked By:

* HIGHEST FEATURE IN A LARGE AREA OF TERRAIN PENETRATION. REFER TO HATCHED AREAS ON MAP.
 (⊛) DATA ESTIMATED
 ^ ELEVATION DIFFERENCE BELOW DATA CONFIDENCE THRESHOLD
 NOTE: STATION AND OFFSET BASED ON RUNWAY 5-23

		STATE OF ALASKA		ADAK AIRPORT		DATE: AUGUST 2015	
		DEPARTMENT OF TRANSPORTATION		ADAK, ALASKA		SHEET: 23 OF 24	
		AND PUBLIC FACILITIES		AIRPORT AIRSPACE, 14 CFR, PART 77			
		CENTRAL REGION		DATA TABLES			
BY	DATE	REVISION					
	4/4/2017	AS-BUILT PER PROJECT Z549720000					

