

LOCATION MAP
NO SCALE

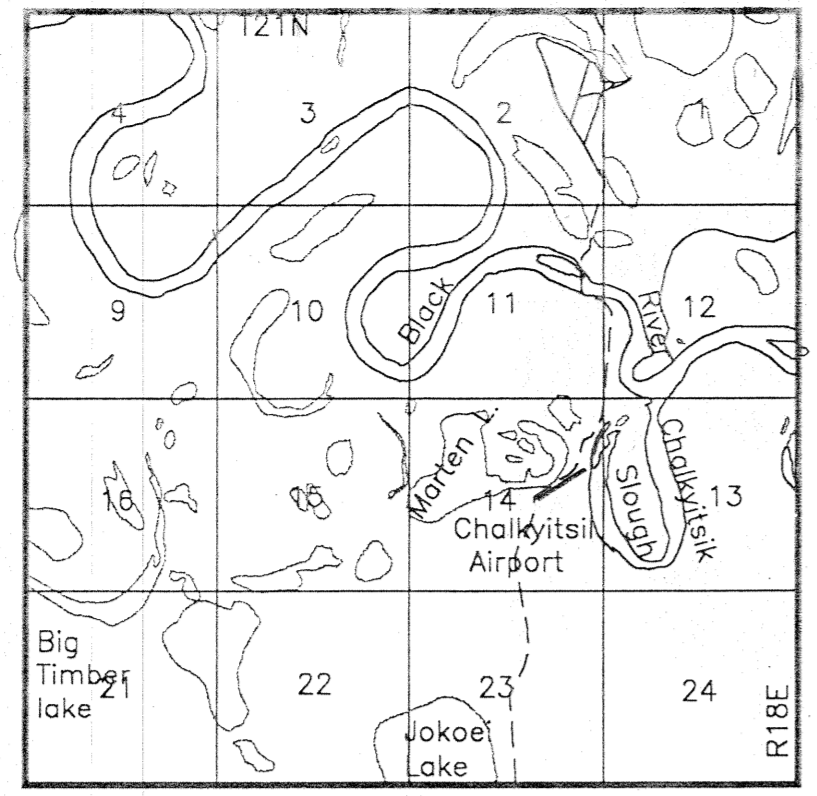

VICINITY MAP
T21N, R18E
FAIRBANKS MERIDIAN
USGS BLACK RIVER (C-6)

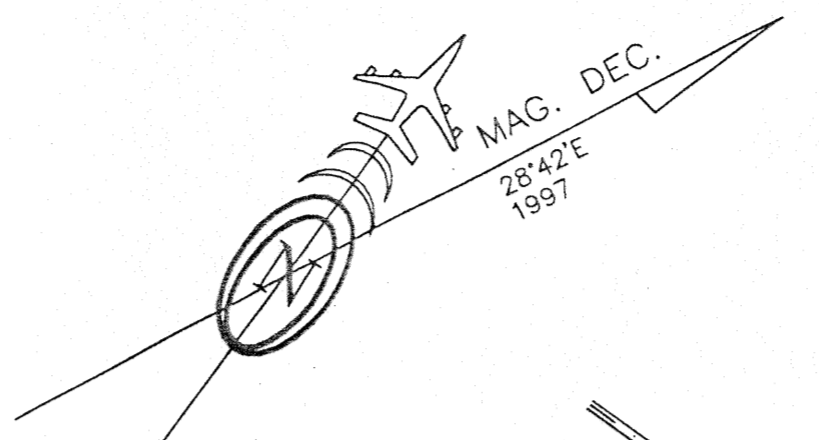

NO WIND DATA AVAILABLE

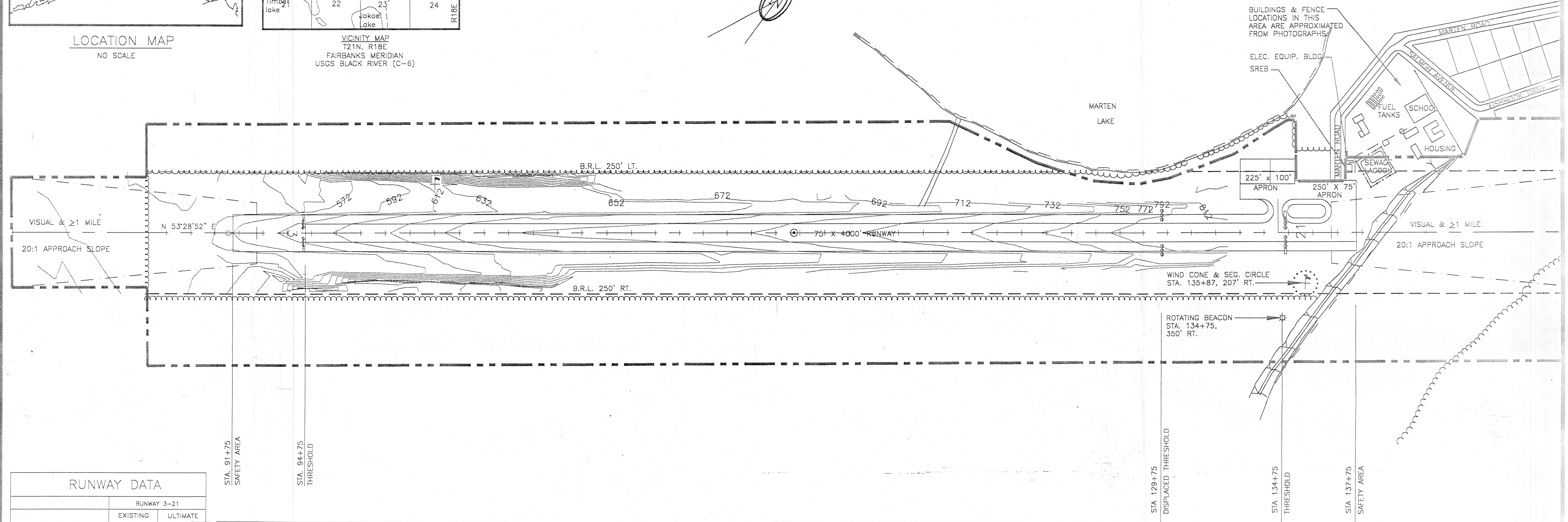

RUNWAY DATA		
	RUNWAY 3-21	
	EXISTING	ULTIMATE
EFFECTIVE GRADIENT	.49%	SAME
% WIND COVERAGE	NO DATA	SAME
INSTRUMENT RUNWAY	NONE	SAME
RUNWAY SURFACE TYPE	GRAVEL	SAME
APPROACH SURFACES	VISUAL	SAME
RUNWAY LIGHTING	MIRL	SAME
NAVIGATION AIDS	NONE	SAME
COMMUNICATION AIDS	NONE	SAME
R/W DIMENSIONS	4000' X 75'	SAME
R/W SAFETY AREA	4600' X 150'	SAME
ROFA	4600' X 500'	SAME
ROFZ	4400' X 250'	SAME
T/W WIDTH	35'	SAME
T/W SAFETY AREA WIDTH	80'	SAME

AIRPORT DATA			
	EXISTING	ULTIMATE	
AIRPORT ELEVATION (GPS)	569'	SAME	
AIRPORT REFERENCE CODE	B-II	SAME	
MEAN HIGH TEMP. HOTTEST MONTH (JULY)	74.8°F	SAME	
TAXIWAY LIGHTING	MITL	SAME	
RAMP LIGHTING	NONE	SAME	
AIRPORT AND TERMINAL NAVAIDS	ROT. BEACON	SAME	
AIRPORT REFERENCE POINT (ARP)	LONG. 143°44'23.68"W	SAME	
	LAT. 66°38'42.10"N	SAME	
THRESHOLD 2	LONG. 143°45'03.52"W	SAME	
(STA. 94+75)	LAT. 66°38'30.39"N	SAME	
THRESHOLD 20	LONG. 143°43'43.82"W	SAME	
(STA. 134+75)	LAT. 66°38'53.81"N	SAME	
DISPLACED THRESHOLD	LONG. 143°43'53.78"W	SAME	
(STA. 129+75)	LAT. 66°38'50.89"N	SAME	

LEGEND			
	EXISTING	ULTIMATE	
PROPERTY LINE	---	---	SAME
BUILDING RESTRICTION LINE (B.R.L.)	B.R.L.	B.R.L.	
DEVELOPMENT	[Symbol]	[Symbol]	
LIGHTED WIND CONE & SEGMENTED CIRCLE	[Symbol]	[Symbol]	
UNLIGHTED WIND CONE ONLY	[Symbol]	[Symbol]	SAME
BUILDINGS	[Symbol]	[Symbol]	
ROADWAYS	[Symbol]	[Symbol]	
THRESHOLD LIGHTS	[Symbol]	[Symbol]	
FENCING	x---x	x---x	
AIRPORT REFERENCE POINT	[Symbol]	[Symbol]	SHORELINE/WATERLINE
ROTATING BEACON	[Symbol]	[Symbol]	TREELINE

MODIFICATIONS TO STANDARD			
ITEM	STANDARD	EXISTING	ULTIMATE
R/W C/L TO APRON & PARKING	250'	137.5'	SAME
STRUCTURES WITHIN BRL	NONE	BLDG,FENCE	BLDG,FENCE



NOTES
NO OFZ OBJECT PENETRATIONS.
NO THRESHOLD SITING SURFACE OBJECT PENETRATIONS.
THE ALASKA STATE PLANE GRID BEARING FOR THE R/W CENTERLINE IS N 55°04'43" E.
THE GEODETIC COORDINATES WERE COMPUTED FROM SURVEY CONTROL TIES TO GPS CONTROL POINTS NEAR THE RUNWAY.

DESIGN_RGS	DATE	REVISIONS
CAT	9/23/97	CORRECTED COORDINATES & MARTEN RD ALIGNMENT
CAT	9/10/97	ADDED DISPLACED THRESH & SHEET 3
CAT	8/25/97	AS-BUILT & UPDATED
CHECKED_ELE	10/13/93	FAA APPROVED

STATE OF ALASKA
DEPARTMENT OF TRANSPORTATION AND PUBLIC FACILITIES
NORTHERN REGION-DESIGN AND CONSTRUCTION-AVIATION
APPROVED *Daniel D. Urbach* DATE 9-24-93
S/ DANIEL D. URBACH, P.E. AIRPORT DESIGN ENGINEER

CONDITIONALLY APPROVED
AIRPORT LAYOUT PLAN APPROVED
MATT FREEMAN
By: MATT FREEMAN
FAA, AIRPORTS DIVISION
ALASKAN REGION, AAL-600
DATE: 1/4/98

CHALKYITSIK AIRPORT
AIRPORT LAYOUT PLAN

1000' X 250' X 450' RPZ
20:1 APPROACH SURFACE
VISUAL & ≥1 MILE

N 53°31' E

R/W STA. 91+75
SAFETY AREA
R/W STA. 94+75
THRESHOLD

RPZ 3

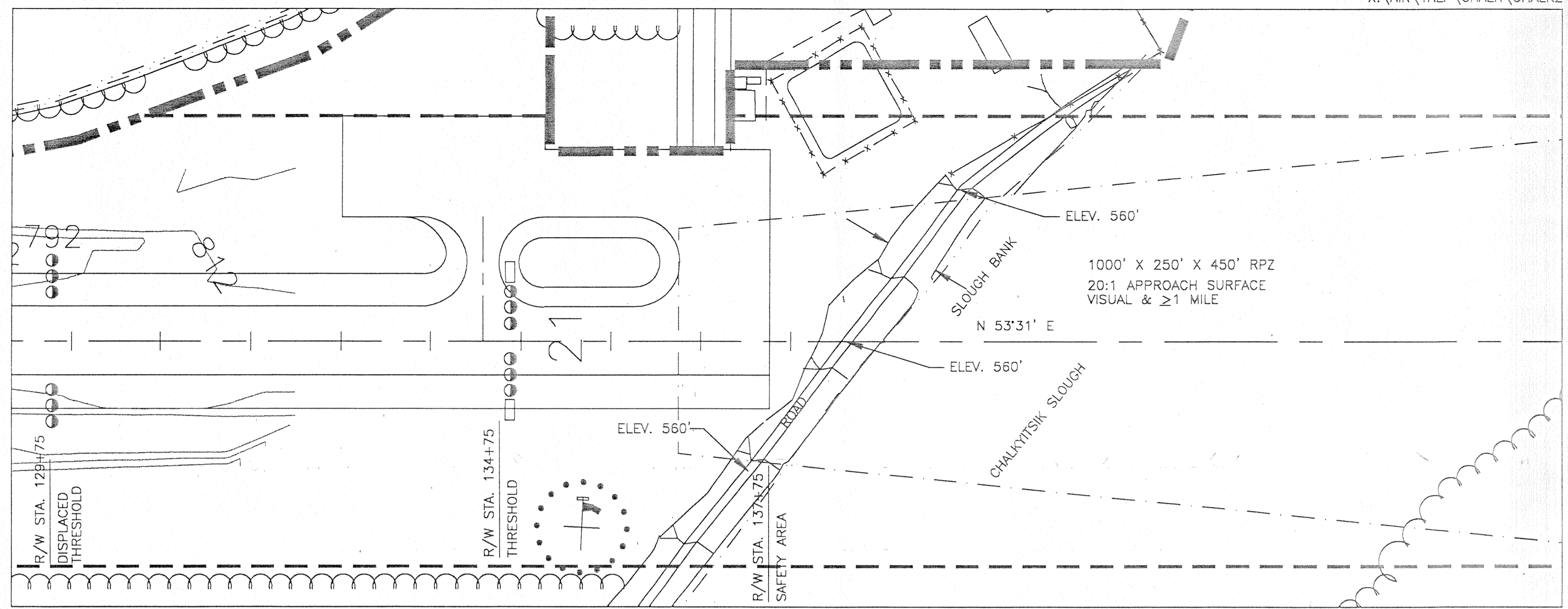

1000' X 250' X 450' RPZ
20:1 APPROACH SURFACE
VISUAL & ≥1 MILE

N 53°31' E

ELEV. 560'

R/W STA. 129+75
DISPLACED THRESHOLD
R/W STA. 134+75
THRESHOLD
R/W STA. 137+75
SAFETY AREA

RPZ 21

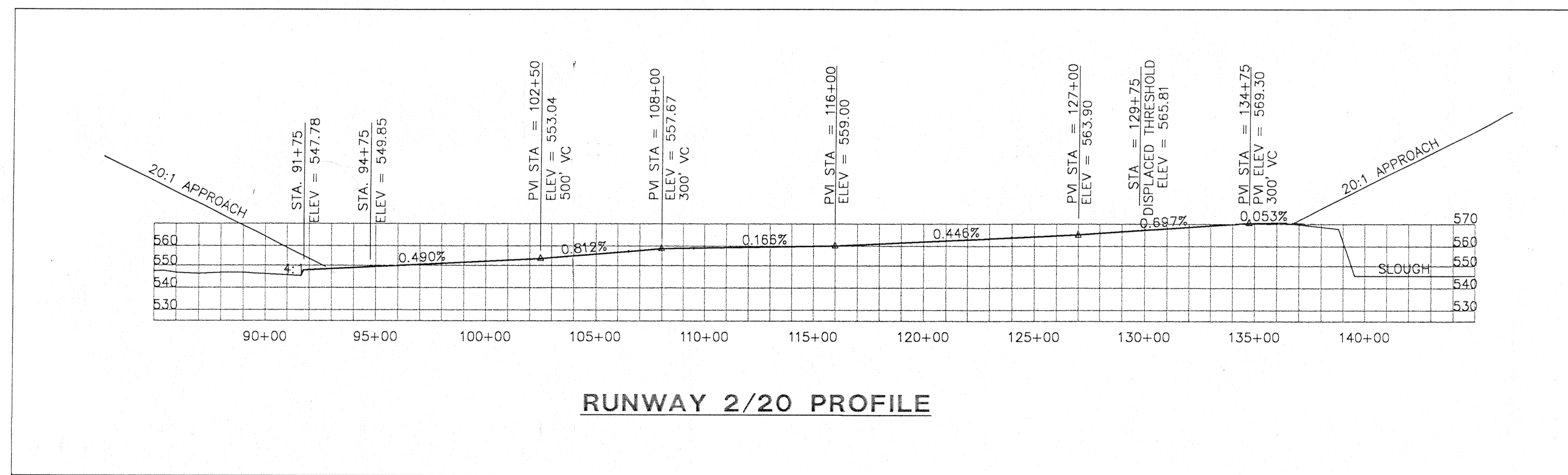
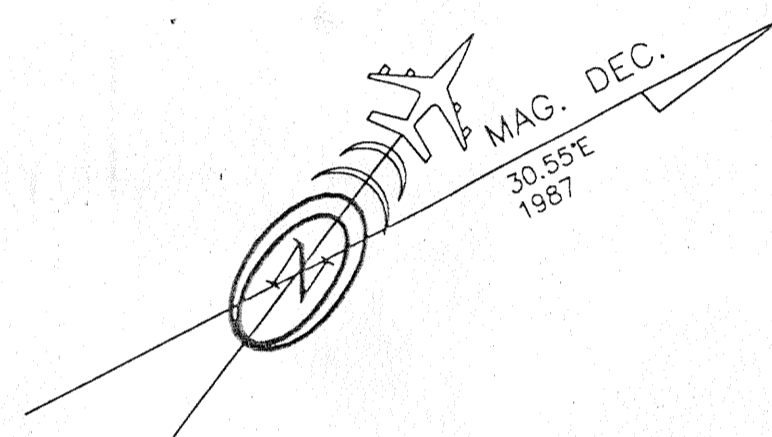

DESIGN_RGS		
DRAWN_CAT		
CHECKED_ELE		
CAT	9/10/97	ADDED SHEET 3 & DISPLACED THRESHOLD
CAT	8/25/97	AS-BUILT & UPDATED
BY	10/13/97	FAA APPROVED
DATE		REVISIONS

STATE OF ALASKA
DEPARTMENT OF TRANSPORTATION AND PUBLIC FACILITIES
NORTHERN REGION-DESIGN AND CONSTRUCTION-AVIATION
APPROVED *Daniel D. Urbach* DATE *9-24-93*
S/ DANIEL D. URBACH, P.E. AIRPORT DESIGN ENGINEER

CONTRACTOR
AIRPORT LAYOUT PLAN APPROVED
By: *MAT FREEMAN*
FAA, AIRPORTS DIVISION
ALASKAN REGION, AAL-600
DATE: *1/6/98*

CHALKYITSIK AIRPORT
PROFILES AND RPZ'S

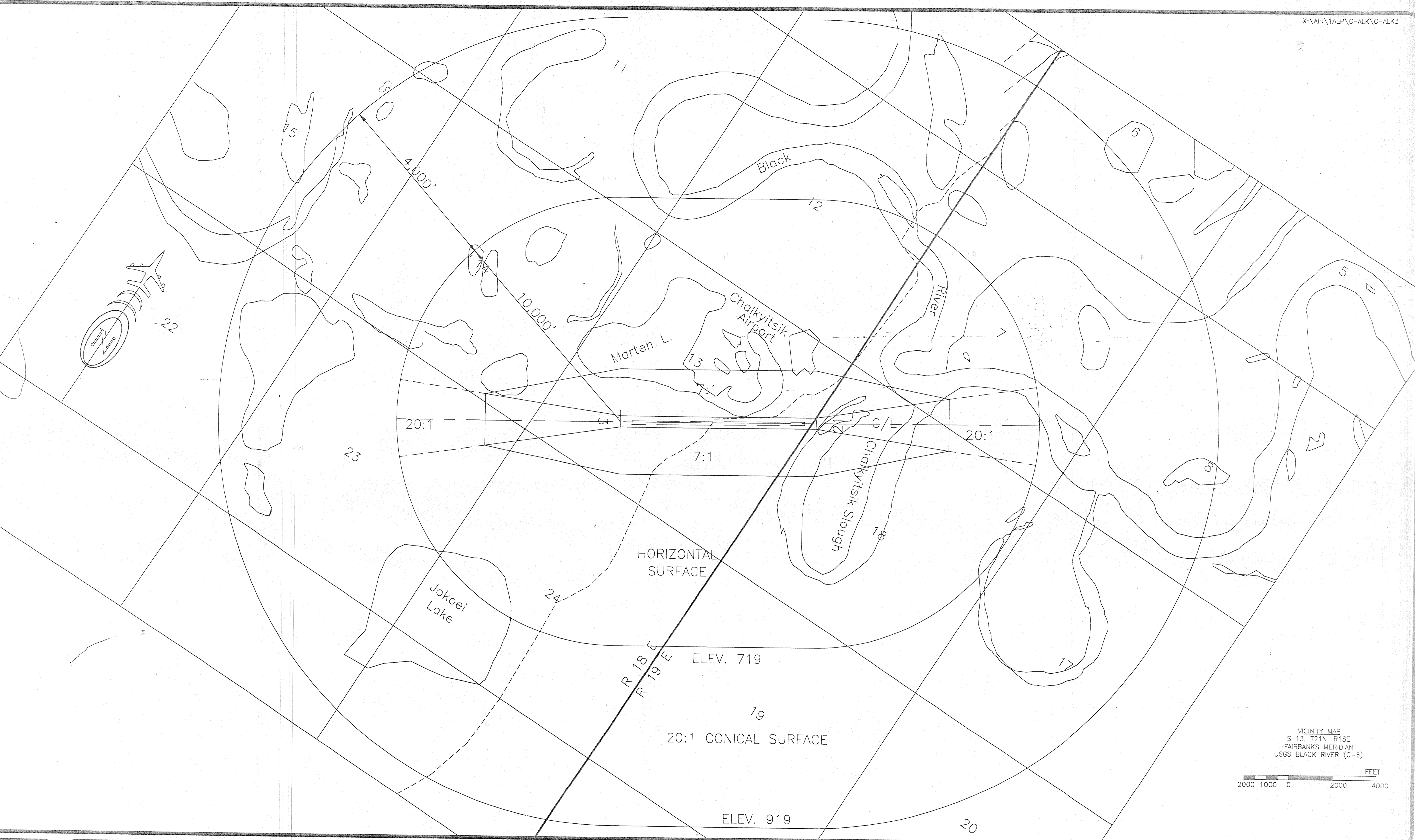

VICINITY MAP
 S 13, T21N, R18E
 FAIRBANKS MERIDIAN
 USGS BLACK RIVER (C-6)

FEET
 2000 1000 0 2000 4000

GN_RGS		
DATE		
BY		
DATE		
REVISIONS		
CAT	9/9/97	ADDED SHEET 3.
CAT	8/25/97	AS-BUILT & UPDATED
CAT	10/13/97	FAA APPROVED

STATE OF ALASKA
 DEPARTMENT OF TRANSPORTATION AND PUBLIC FACILITIES
 NORTHERN REGION-DESIGN AND CONSTRUCTION-AVIATION

APPROVED *Daniel D. Urbach* DATE 9-24-93
 s/ DANIEL D. URBACH, P.E. AIRPORT DESIGN ENGINEER

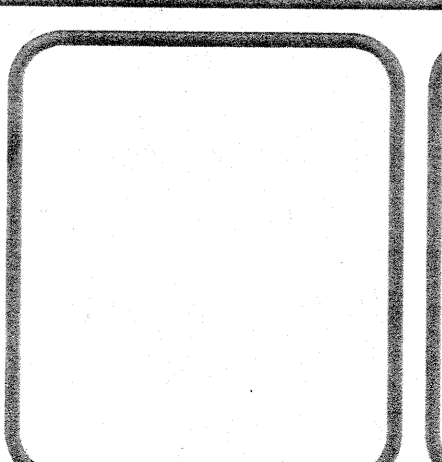

AIRPORT LAYOUT PLAN APPROVED
 BY: *MATT FREEMAN*
 FAA, AIRPORTS DIVISION
 ALASKAN REGION, AAL-600
 DATE: 1/6/98

CHALKYITSIK AIRPORT
 AIRSPACE DRAWING

SHEET
 3
 OF
 3