



U.S. Department  
of Transportation  
**Federal Aviation  
Administration**

Alaskan Region Airports Division

222 W. 7<sup>th</sup> Avenue, #14  
Anchorage, Alaska 99513-7587  
Tel. (907) 271-5438 / Fax (907) 271-2851

31 December, 2019

Michael Lukshin  
ADOT&PF Southcoast Region  
P.O. Box 112506  
Juneau, AK 99811-2506

Dear Mr. Lukshin:

**Cold Bay Airport  
Cold Bay, Alaska  
As-Built Airport Layout Plan  
(Original ALP Airspace – 2011-AAL-20-NRA)**

We have completed our review of the Cold Bay Airport As-Built Airport Layout Plan (ALP) dated 9 September 2019 (cover sheet dated 2 October 2019), and find it acceptable for documenting the existing conditions of the airport.

Please attach this letter to the enclosed As-Built ALP sheet 7 of 10 and retain it in your files for future use.

Sincerely,

Pat Zettler, R.E., Lead Civil Engineer  
Airports Division



FILE No.:  
 Date Plotted: 10/02/2019, 3:01 PM  
 Layout Name: (1) DATA  
 File Name: Z:\project\2316-01 DOT-C Cold Bay Crossing Design Services\Civil\A040\ALP Update\CB-ALP.dwg  
 Designed By: CCW  
 Drawn By: BFO  
 Checked By: BRH

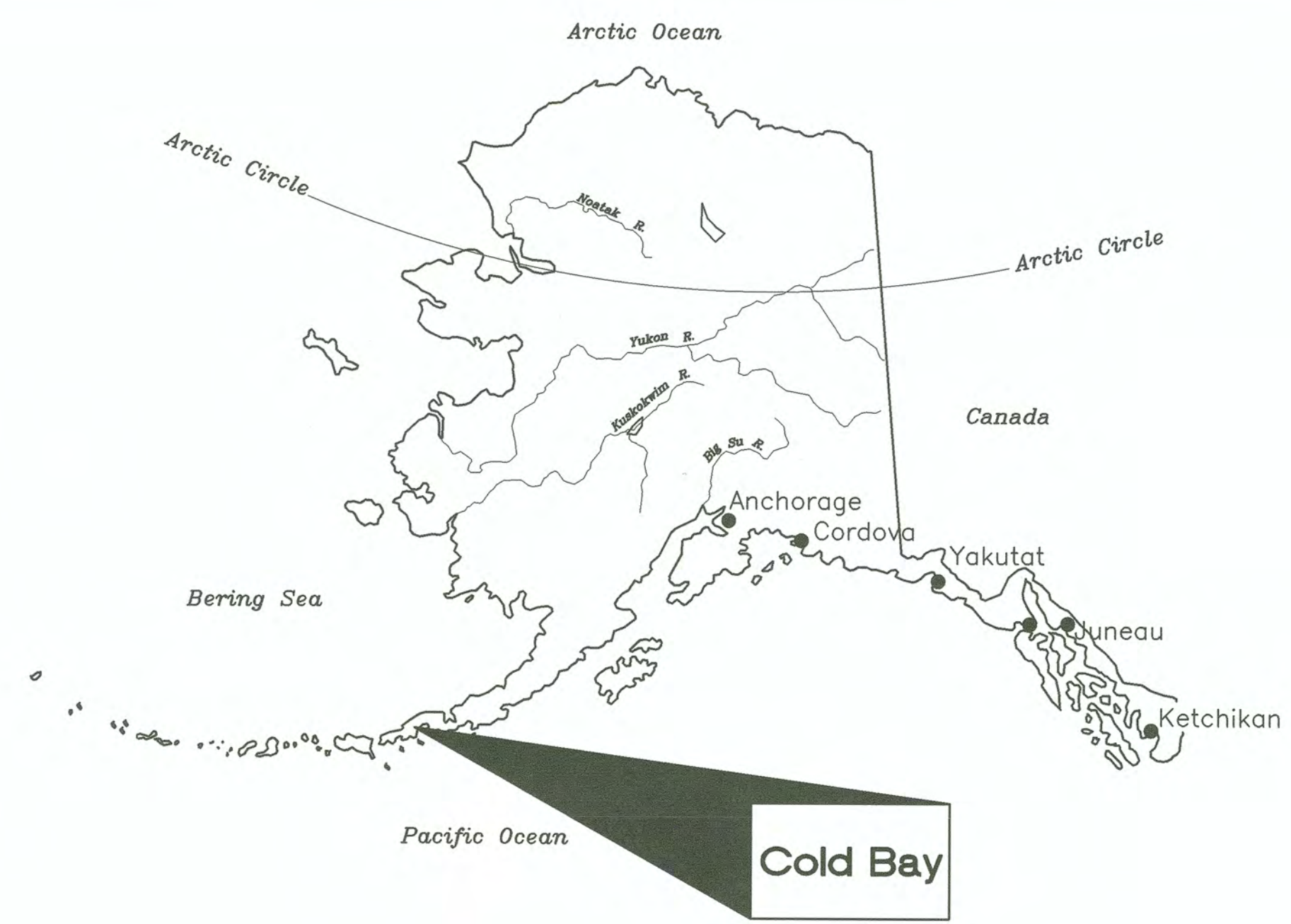

LEGEND		
ITEM	EXISTING	ULTIMATE
AIRPORT REFERENCE POINT (ARP)		
ANTENNA		
BLUFF		
BUILDINGS		
BUILDING RESTRICTION LINE (BRL)		
FENCE		
PAPI		
PROPERTY LINE		
REIL		
ROADWAYS		
ROTATING BEACON		
SHORELINE		
SURVEY MONUMENT		
THRESHOLD MARKERS/LIGHTS		
TOPOGRAPHIC CONTOURS		
TREE (LARGE SINGLE)		
TREELINE		
VASI		
WIND CONE		
WIND CONE AND SEGMENTED CIRCLE		

AIRPORT DATA		
ITEM	EXISTING	ULTIMATE
ICAO IDENTIFIER	PACD	PACD
NATIONAL AIRPORT IDENTIFIER	CDB	CDB
FAA SITE NUMBER	50114.*A	50114.*A
AIRPORT ELEVATION NAVD88	99.5	99.5
AIRPORT REFERENCE CODE	B-II	B-II
MEAN MAX. TEMPERATURE, HOTTEST MONTH	55°F, JULY	55°F, JULY
AIRPORT AND TERMINAL NAVIGATION AIDS	ILS, GPS, NDB, VOR/DME, LOC/DME, ROTATING BEACON	ILS, GPS, NDB, VOR/DME, LOC/DME, ROTATING BEACON
TAXIWAY LIGHTING/MARKING	MITL	MITL
OBSTRUCTION SURVEY SOURCE & TYPE	ANP 2005	ANP 2005
MAGNETIC DECLINATION, YEAR, RATE OF CHANGE	10°44'E / 2017	-0°24'(W) / YEAR

GEOGRAPHIC COORDINATES TABLE				
ITEM	EXISTING LATITUDE	EXISTING LONGITUDE	ULTIMATE LATITUDE	ULTIMATE LONGITUDE
ARP	55°12'21.29"N	162°43'34.51"W	55°12'21.29"N	162°43'34.51"W
THRESHOLD RW 15	55°13'20.50"N	162°44'16.42"W	55°13'20.50"N	162°44'16.42"W
THRESHOLD RW 33	55°11'47.24"N	162°43'11.71"W	55°11'47.24"N	162°43'11.70"W
THRESHOLD RW 8	55°11'57.16"N	162°43'56.73"W	55°11'57.16"N	162°43'56.73"W
THRESHOLD RW 26	55°11'53.14"N	162°42'32.59"W	55°11'53.14"N	162°42'32.59"W

RUNWAY 15/33 DATA			
ITEM	EXISTING	ULTIMATE	
RUNWAY TYPE	UTILITY OR OTHER THAN UTILITY	OTHER THAN UTILITY	OTHER THAN UTILITY
FAR PART 77 APPROACH CATEGORY (V, NPI, P)	P, NPI	P, NPI	P, NPI
APPROACH SURFACES	50:1/34:1	50:1/34:1	50:1/34:1
VISIBILITY MINIMUM	<3/4 SM/1 SM	<3/4 SM/1 SM	<3/4 SM/1 SM
RUNWAY SURFACE	ASPHALT	ASPHALT	ASPHALT
PAVEMENT STRENGTH SW,DW,DTW,DDTW lbs	345,000	345,000	345,000
AIRCRAFT APPROACH CATEGORY	B	B	B
AIRPLANE DESIGN GROUP	II	III	III
TRUE BEARING	N21°38'40.19"W	N21°38'40.19"W	N21°38'40.19"W
EFFECTIVE GRADE	0.20%	0.20%	0.20%
TOUCHDOWN ELEVATION NAVD88	75.0 / 93.4	75.0 / 93.4	75.0 / 93.4
RUNWAY DIMENSIONS	150' x 10,180'	150' x 10,180'	150' x 10,180'
RUNWAY SAFETY AREA (RSA) DIMENSIONS	300' x 11,380'	400' x 11,380'	400' x 11,380'
LENGTH BEYOND R/W END	600' / 600'	* 800' / 800'	* 800' / 800'
RUNWAY PROTECTION ZONE (RPZ) DIMENSIONS-RW 15	2,500' x 1,000' x 1,750'	2,500' x 1,000' x 1,750'	2,500' x 1,000' x 1,750'
RUNWAY PROTECTION ZONE (RPZ) DIMENSIONS-RW 33	1,700' x 1,000' x 1,510'	1,700' x 1,000' x 1,510'	1,700' x 1,000' x 1,510'
RUNWAY OBJECT FREE AREA (ROFA) DIMENSIONS	800' x 11,380'	800' x 11,380'	800' x 11,380'
LENGTH BEYOND R/W END OR STOPWAY	600' / 600'	800' / 800'	800' / 800'
RUNWAY OBSTACLE FREE ZONE (ROFZ) DIMENSIONS	400' x 10,580'	400' x 10,580'	400' x 10,580'
PRECISION OBSTACLE FREE ZONE (POFZ) DIMENSIONS-RW15	800' x 200'	800' x 200'	800' x 200'
RUNWAY LIGHTING	HIRL	HIRL	HIRL
RUNWAY MARKING TYPE	PRECISION/NON-PRECISION	PRECISION/NON-PRECISION	PRECISION/NON-PRECISION
RUNWAY VISUAL APPROACH AIDS	PAPI, MALSR	PAPI, MALSR	PAPI, MALSR

TAXIWAY DATA TABLE				
ITEM	WIDTH	LENGTH	TAXIWAY SAFETY AREA (TSA)	TAXIWAY OBJECT FREE AREA (TOFA)
TAXIWAY A	75'	330'	118'	186'
TAXIWAY B	75'	350'	118'	186'
TAXIWAY C	75'	400'	118'	186'
TAXIWAY D	50'	400'	118'	186'
TAXIWAY E	75'	10,636'	118'	186'

RUNWAY 8/26 DATA			
ITEM	EXISTING	ULTIMATE	
RUNWAY TYPE	UTILITY OR OTHER THAN UTILITY	OTHER THAN UTILITY	OTHER THAN UTILITY
FAR PART 77 APPROACH CATEGORY (V, NPI, P)	NPI/NPI	NPI/NPI	NPI/NPI
APPROACH SURFACES	34:1/34:1	34:1/34:1	34:1/34:1
VISIBILITY MINIMUM	1 SM	1 SM	1 SM
RUNWAY SURFACE	ASPHALT	ASPHALT	ASPHALT
PAVEMENT STRENGTH SW,DW,DTW,DDTW lbs	345,000	345,000	345,000
AIRCRAFT APPROACH CATEGORY	B	B	B
AIRPLANE DESIGN GROUP	II	II	II
TRUE BEARING	S85°13'46.56"E	S85°13'46.56"E	S85°13'46.56"E
EFFECTIVE GRADE	0.20%	0.20%	0.20%
TOUCHDOWN ELEVATION NAVD88	95.2 / 99.5	95.2 / 99.5	95.2 / 99.5
RUNWAY DIMENSIONS	150' x 4,900'	150' x 4,900'	150' x 4,900'
RUNWAY SAFETY AREA (RSA) DIMENSIONS	300' x 5,500'	300' x 5,500'	300' x 5,500'
LENGTH BEYOND R/W END	300' / 300'	300' / 300'	300' / 300'
RUNWAY PROTECTION ZONE (RPZ) DIMENSIONS	1,000' x 500' x 700'	1,000' x 500' x 700'	1,000' x 500' x 700'
RUNWAY OBJECT FREE AREA (ROFA) DIMENSIONS	500' x 5,500'	500' x 5,500'	500' x 5,500'
LENGTH BEYOND R/W END OR STOPWAY	300' / 300'	300' / 300'	300' / 300'
RUNWAY OBSTACLE FREE ZONE (ROFZ) DIMENSIONS	400' x 5,300'	400' x 5,300'	400' x 5,300'
RUNWAY LIGHTING	HIRL	HIRL	HIRL
RUNWAY MARKING TYPE	NON-PRECISION	NON-PRECISION	NON-PRECISION
RUNWAY VISUAL APPROACH AIDS	PAPI	REIL, PAPI	REIL, PAPI

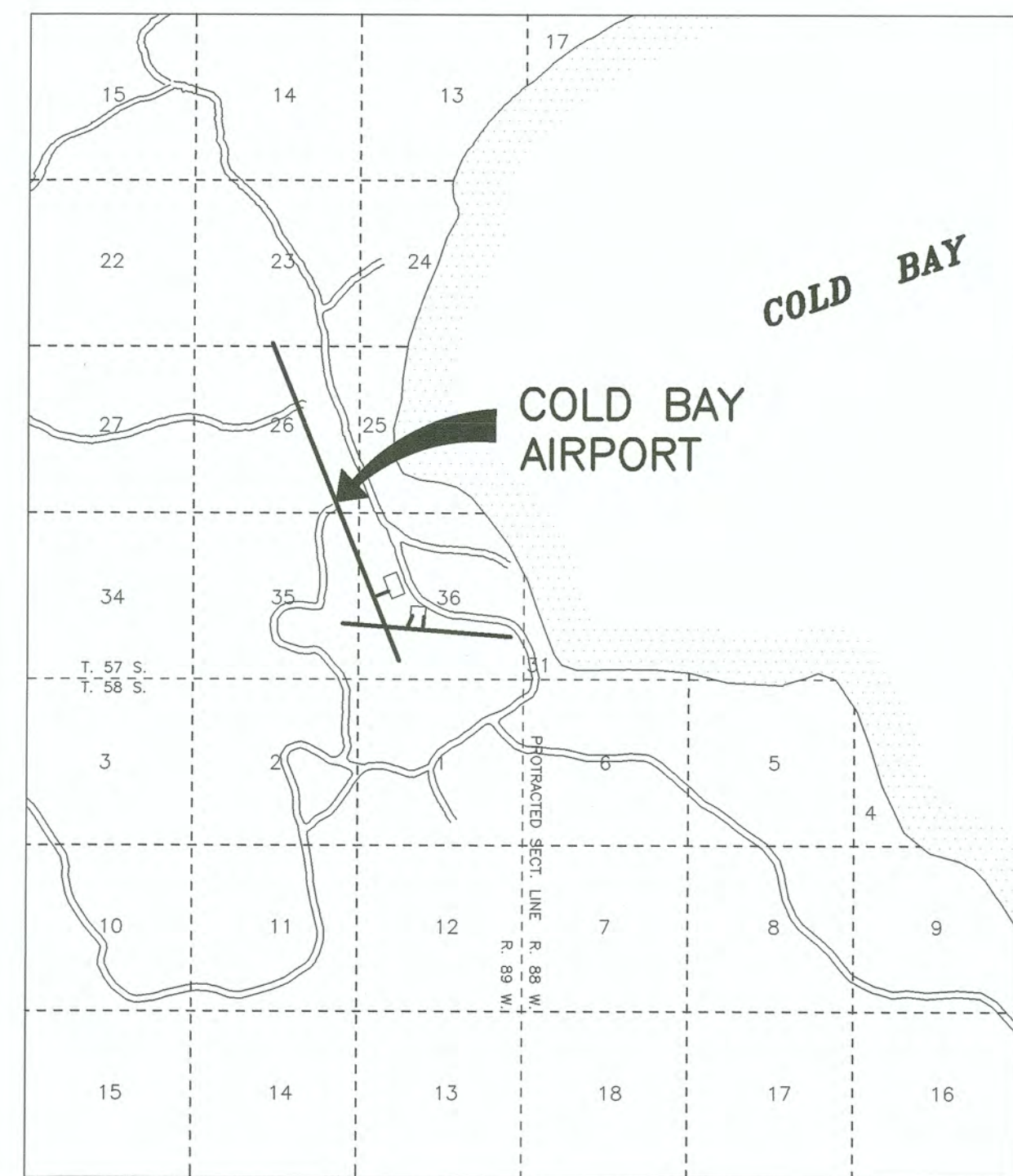

VICINITY MAP  
 SEC. 22, 23, 24, 25, 26, 27, 35, 36 T 57 S, R 89 W  
 SEC. 30, 31 T 57 S, R 89 W  
 SEC. 1, 2 T 58 S, R 89 W  
 SEC. 6 T 58 S, R 88 W  
 SEWARD MERIDIAN  
 U.S.G.S. COLD BAY (A-3), ALASKA

SCALE IN STATUTE MILES  
 1 SM .5 SM 0 1 SM 2 SM

ALL WEATHER WIND DATA TABLE				
RUNWAY	10.5 kt	13 kt	16 kt	20 kt
15/33	76.94	84.39	91.17	96.37
8/26	64.05	74.08	84.45	
COMBINED	93.87	97.38	99.09	

SOURCE:  
 COLD BAY WIND DATA  
 FAA GIS NATIONAL CLIMATE DATA CENTER  
 OCTOBER 2, 2019  
 REPORT PERIOD: 2009 - 2018

- NOTES
- THE HORIZONTAL DATUM IS NAD 83 (NSRS 2007.0000). THE BASIS OF COORDINATES IS THE POSITION OF NATIONAL GEODETIC SURVEY (NGS) SECONDARY AIRPORT CONTROL STATION (SACS) "CDB T4A," HAVING LOCAL COORDINATES OF 30,000.0000N, 60,000.0000E. U.S. SURVEY FEET.
  - THE VERTICAL DATUM IS NAVD88 ORTHOMETRIC HEIGHTS. THE BASIS OF ELEVATIONS IS THE NGS PUBLISHED ELLIPSOID HEIGHT AND GEOID-09 HEIGHT OF THE PACS "CDB S1," (PID AD9764), HAVING AN ELEVATION OF 72.45 FEET.

DRAWING INDEX		
SHT #	TITLE	REV.
1	AIRPORT DATA SHEET	10/02/19
2	EXISTING LAYOUT	02/09/18
3	ULTIMATE LAYOUT	02/09/18
4	DECLARED DISTANCES RUNWAY 15/33	02/09/18
5	TERMINAL AREA	02/09/18
6	INNER PORTION OF RW 15/33 APPROACH SURFACE	02/09/18
7	INNER PORTION OF RW 08/26 APPROACH SURFACE	02/09/18
8	AIRPORT AIRSPACE, 14 CFR, PART 77	02/09/18
9	AIRPORT PROPERTY MAP	02/09/18
10	LAND USE PLAN	02/09/18

R&M 09/07/18 AS-BUILT UPDATE  
 DOWL 08/28/15 AS-BUILT UPDATE

BY	DATE	REVISION

APPROVED:   
 VERNE SKAGERBERG CHIEF OF PLANNING

AIRPORT LAYOUT PLAN CONDITIONAL APPROVAL SUBJECT TO ALP APPROVAL LETTER DATED 6/6/2011  
 FAA AIRSPACE REVIEW NUMBER: 2011- AAL-20-NRA  
 AS-BUILT ACCEPTED   
 DATE: 12/31/19  
 FAA, AIRPORTS DIVISION, ALASKAN REGION, AAL-

STATE OF ALASKA  
 DEPARTMENT OF TRANSPORTATION  
 AND PUBLIC FACILITIES  
 SOUTHCOAST REGION

COLD BAY AIRPORT  
 COLD BAY, ALASKA  
 AIRPORT LAYOUT PLAN  
 AIRPORT DATA SHEET

DATE: 10/02/2019  
 SHEET: 1 OF 10



FILE No.:

Date Plotted: 9/07/2018, 2:48 PM  
 Layout Name: 2\_ELAY  
 File Name: 2:\Project\2316.01\_DOT\_C Cold Bay Crosswind Design Services\Civil\CAD\VALP Update\CB-ALP.dwg  
 Designed By: CCW  
 Drawn By: BFO  
 Checked By: BRH

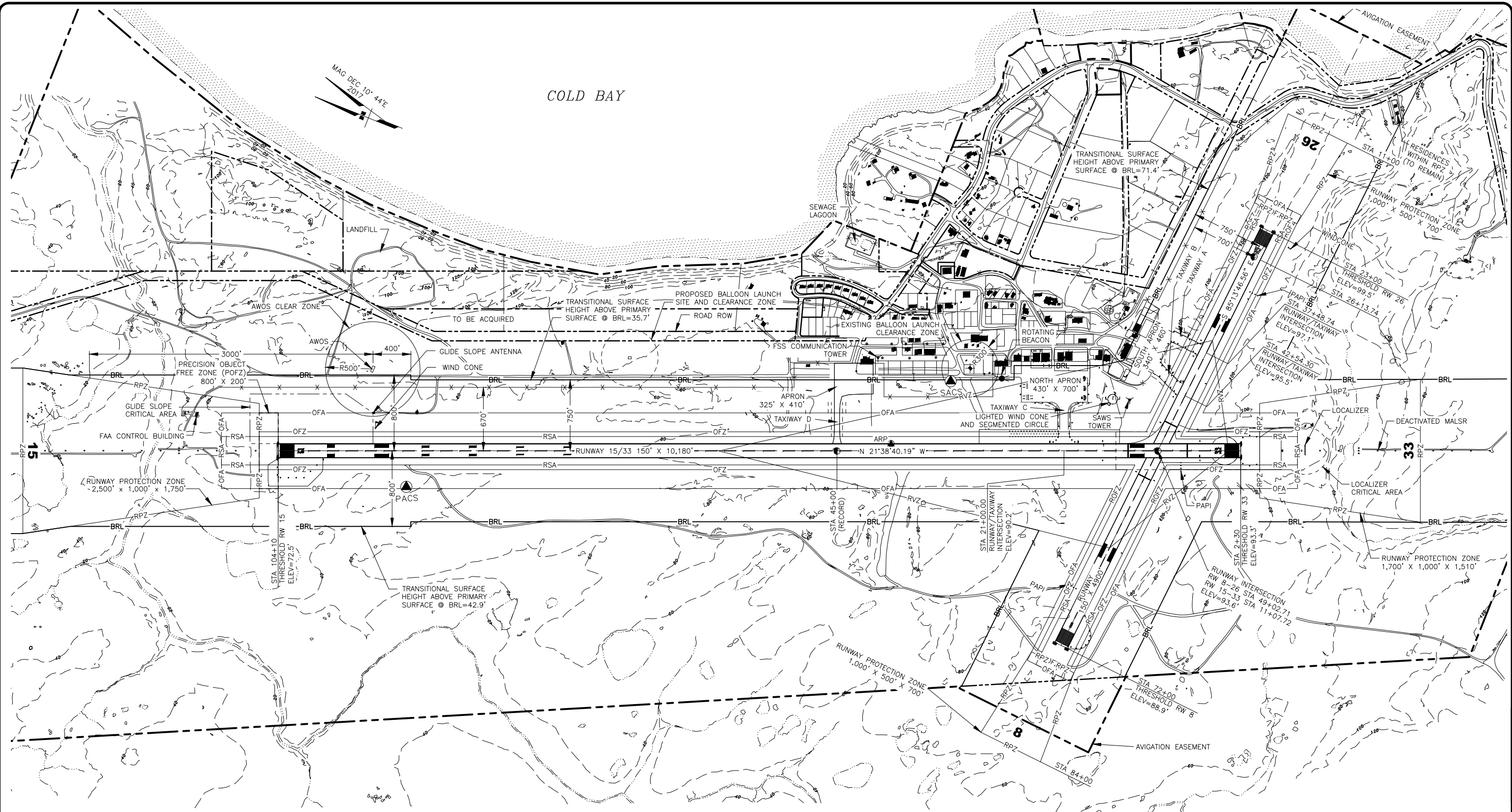

COLD BAY

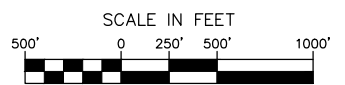

- NOTES:
1. NO RVZ PENETRATIONS.
  2. NO OFZ OBJECT PENETRATIONS.
  3. NO THRESHOLD SITING SURFACE OBJECT PENETRATIONS.

BY	DATE	REVISION
R&M	09/07/18	AS-BUILT UPDATE
DOWL	05/23/16	PROPERTY BNDY, PAVEMENT AND NAVAID UPDATE
DOWL	08/28/15	AS-BUILT UPDATE

**STATE OF ALASKA**  
**DEPARTMENT OF TRANSPORTATION**  
**AND PUBLIC FACILITIES**  
**SOUTHCOST REGION**

**COLD BAY AIRPORT**  
 COLD BAY, ALASKA  
 AIRPORT LAYOUT PLAN

EXISTING LAYOUT

DATE:	09/07/2018
SHEET:	2 OF 10

FILE No.:  
 CCW  
 BFO  
 BRH  
 Designed By:  
 Drawn By:  
 Checked By:  
 Date Plotted: 9/07/2018, 2:48 PM  
 Layout Name: 3 ULAJ  
 File Name: Z:\Project\2316.01 DOT\_C Cold Bay Crosswind Design Services\Civil\CAD\VALP Update\VB-ALP.dwg

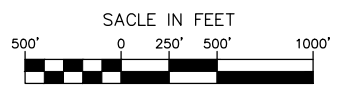
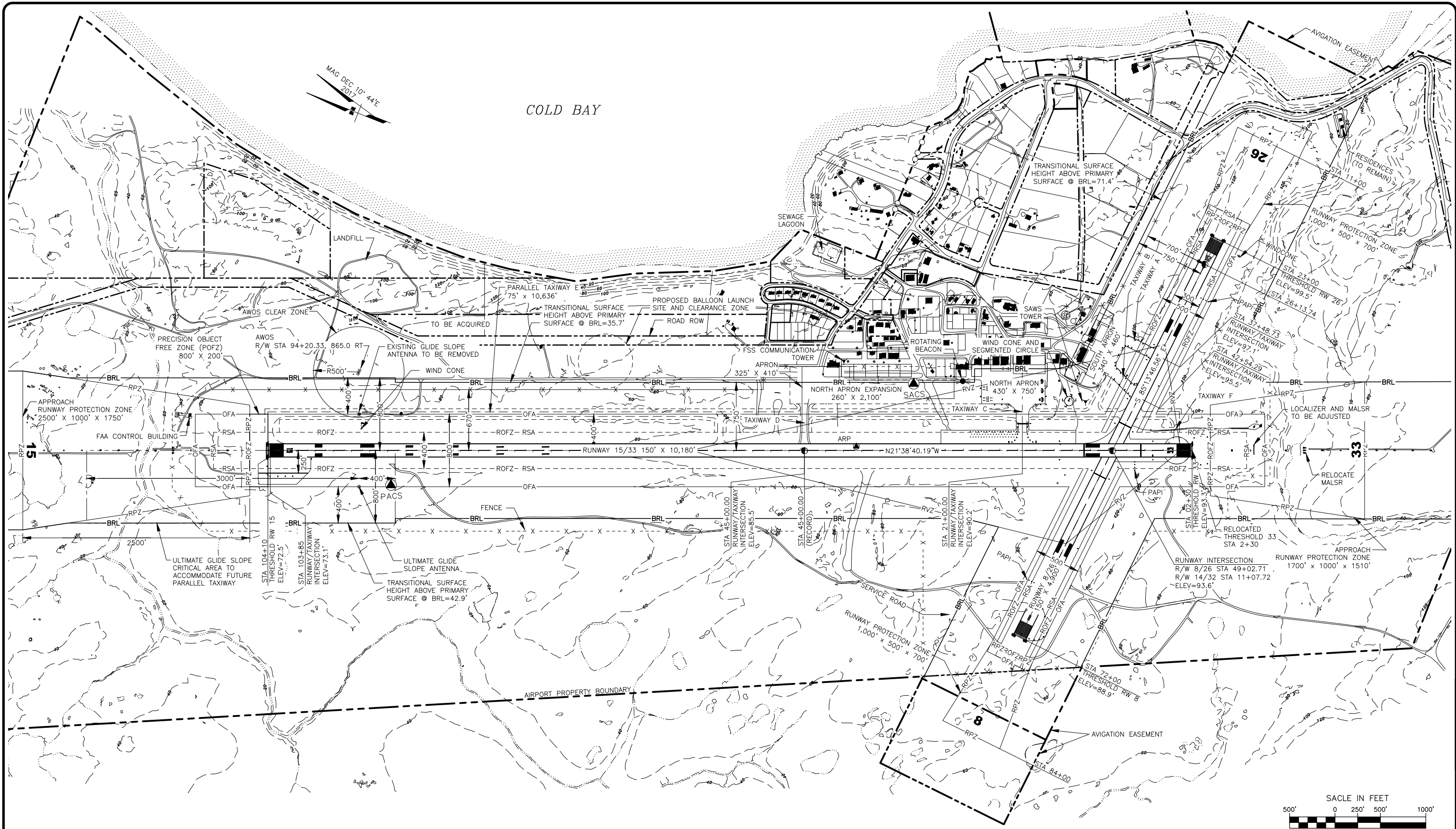

- NOTES:
1. NO RVZ PENETRATIONS.
  2. NO OFZ OBJECT PENETRATIONS.
  3. NO THRESHOLD SITING SURFACE OBJECT PENETRATIONS.

R&M	DATE	REVISION
R&M	09/07/18	AS-BUILT UPDATE
DOWL	05/23/16	PROPERTY BNDY, PAVEMENT AND NAVAID UPDATE
DOWL	09/18/15	AS-BUILT UPDATE
BY	DATE	REVISION

**STATE OF ALASKA  
 DEPARTMENT OF TRANSPORTATION  
 AND PUBLIC FACILITIES  
 SOUTHCOST REGION**

**COLD BAY AIRPORT  
 COLD BAY, ALASKA  
 AIRPORT LAYOUT PLAN**

ULTIMATE LAYOUT

DATE: 09/07/2018  
 SHEET: 3 OF 10



Date Plotted: 9/07/2018, 2:49 PM  
 Layout Name: (6) TERMINAL  
 File Name: Z:\Project\2316.01 DOT\_C Cold Bay Crosswind Design Services\Civil\CAD\VALP Update\VB-ALP.dwg  
 Designed By: CCW  
 Drawn By: BFO  
 Checked By: BRH

**TERMINAL AREA BUILDING DATA**

ID #	DESCRIPTION	STATION/OFFSET	TOP ELEV (MSL)	OBSTRUCT MARKING
1	ALEUTIANS EAST BOROUGH TERMINAL	41+80/945'	117.63	-
2*	US WEATHER SERVICE BALLOON BUILDING	30+84/863'	123.08	-
3	DOT&PF AIR RESCUE FIRE FIGHTING BUILDING AND AIRPORT MANAGERS OFFICE	27+90/923'	115.25	-
4	ALEUTIAN SERVICES INC.	25+77/980'	116.79	-
5	DEPARTMENT OF INTERIOR FISH AND WILDLIFE HANGAR	24+94/975'	114.42	-
6	PENINSULA AIRWAYS INC. HANGAR	23+92/991'	113.71	-
7	PENINSULA AIRWAYS INC. HANGAR/TERMINAL	23+07/992'	115.30	-
8	EVERGREEN AVIATION INC. HANGAR	21+34/954'	115.92	-
9	DOT&PF OLD FIRE STATION	17+63/1009'	122.51	TOWER
		17+16/1011'	104.13	HIGH BLDG PT
		17+50/985'	98.86	MAIN BLDG
10	CITY OF COLD BAY CLINIC	16+55/982'	102.34	-
11	ALEUT ENTERPRISE CORP. DBA FROSTY FUELS	14+43/1058'	117.25	-
12	ALEUT ENTERPRISE CORP. DBA FROSTY FUELS	13+57/1214'	106.48	-
13	ALEUT ENTERPRISE CORP. DBA FROSTY FUELS	13+25/1298'	117.86	-

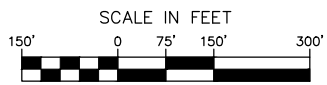
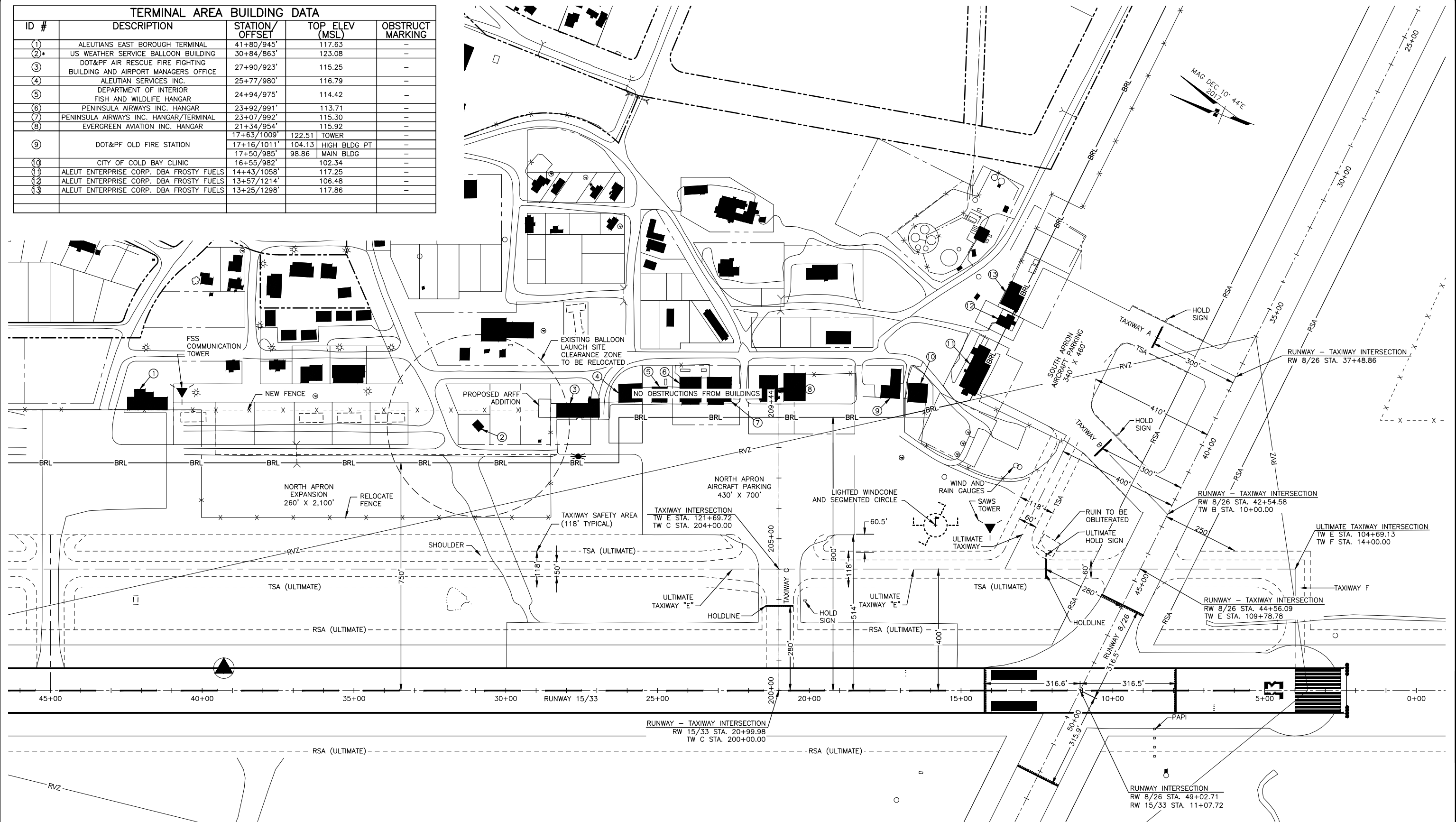

BY	DATE	REVISION
R&M	09/07/18	AS-BUILT UPDATE
DOWL	08/28/15	AS-BUILT UPDATE

**STATE OF ALASKA**  
**DEPARTMENT OF TRANSPORTATION**  
**AND PUBLIC FACILITIES**  
**SOUTHCOST REGION**

**COLD BAY AIRPORT**  
 COLD BAY, ALASKA  
 AIRPORT LAYOUT PLAN

TERMINAL AREA

DATE:	09/07/2018
SHEET:	5 OF 10

FILE No.:

CCW  
 BFO  
 BRH  
 Designed By:  
 Drawn By:  
 Checked By:  
 Date Plotted: 9/07/2018, 2:49 PM  
 Layout Name: (7) UAPF\_14-32  
 File Name: Z:\Project\2316.01 DOT\_C Cold Bay Crosswind Design Services\Civil\ACAD\VALP Update\CB-ALP.dwg

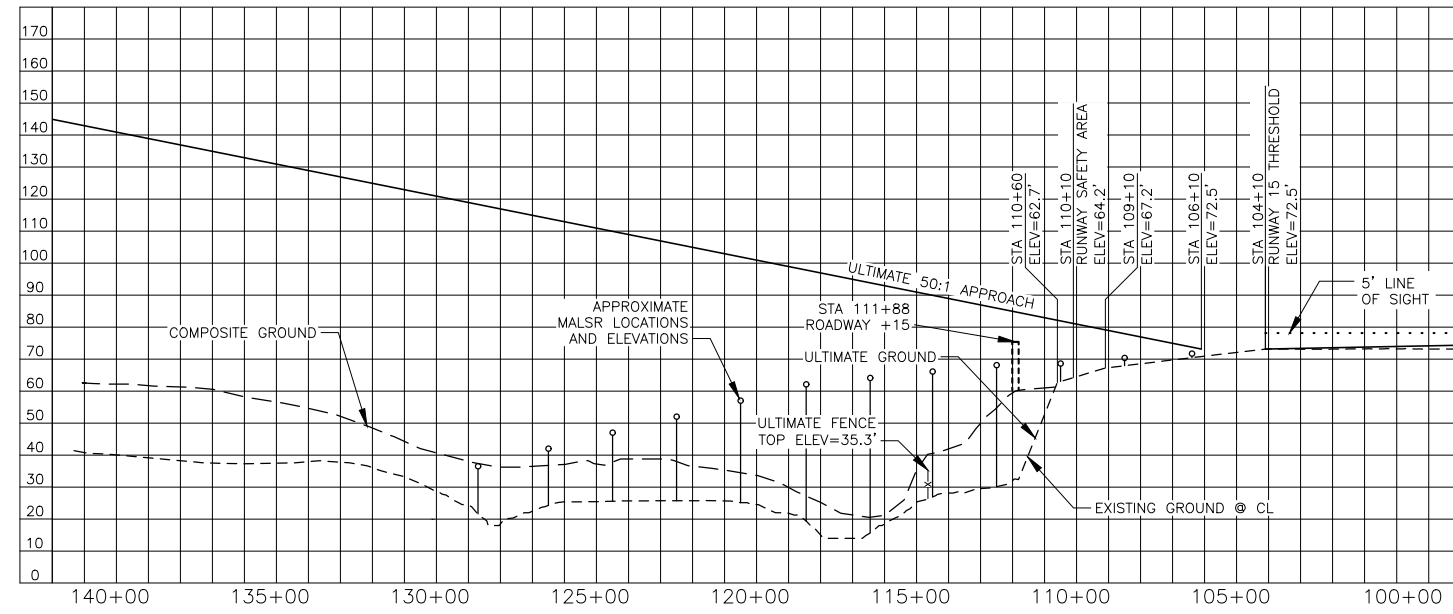
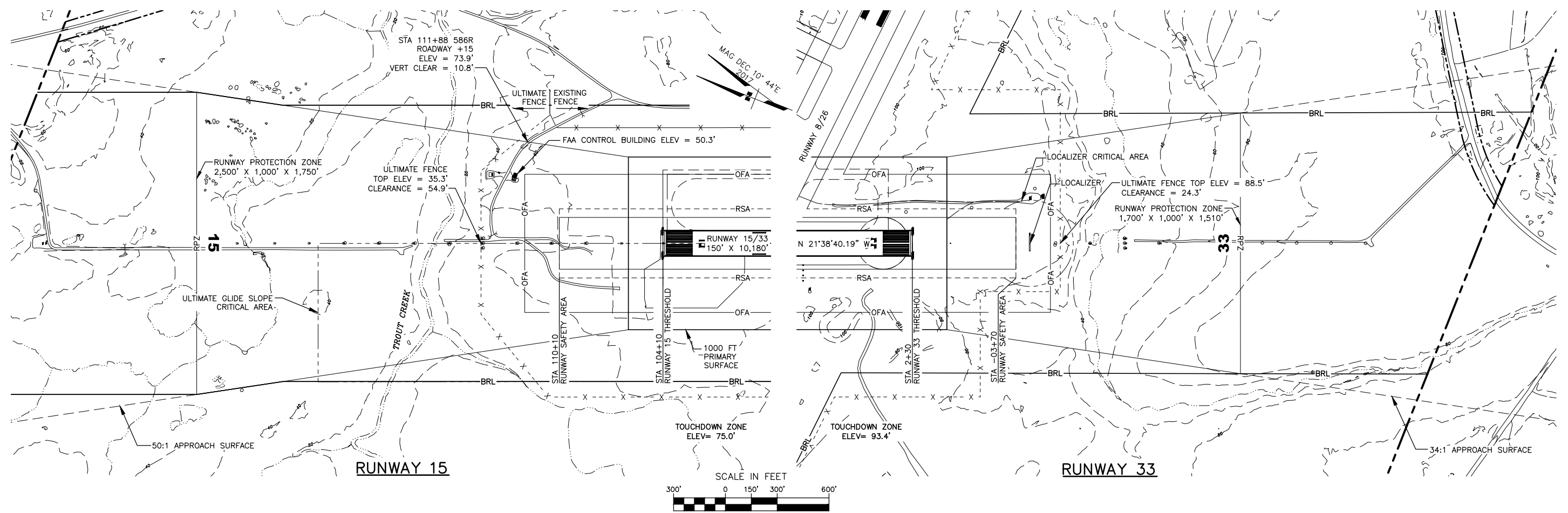

**RUNWAY 15**

PART 77 SURFACE OBSTRUCTION TABLE (INNER PORTION RW 15)								
ID #	DESCRIPTION	STATION/OFFSET	ELEVATION	SURFACE PENETRATED	SURFACE ELEVATION	AMOUNT PENETRATION	DISPOSITION	STAGE TO CORRECT
	NONE							

- NOTE: REFER TO THE AIRPORT AIRSPACE DRAWING FOR PENETRATIONS OF THE OUTER APPROACH SURFACES.
- THERE ARE NO OBSTRUCTIONS IN THE APPROACH TO RUNWAY 15, THEREFORE THE OBSTRUCTION CLEARANCE SLOPE IS ESTABLISHED AS 50:1 PER FAA AC 150/5200-35A, SECTION 4, DATA ELEMENT NUMBER 57.
  - THERE ARE NO OBJECT PENETRATIONS IN THE RUNWAY APPROACH END SITING SURFACE OF RUNWAY 15, AS DEFINED IN FAA AC 150/5300-13A, SECTION 3, TABLE 3-2, LINE 8.
  - THERE ARE NO OBJECT PENETRATIONS IN THE RUNWAY DEPARTURE END SITING SURFACE OF RUNWAY 15, AS DEFINED IN FAA AC 150/5300-13A, SECTION 3, TABLE 3-2, LINE 9.

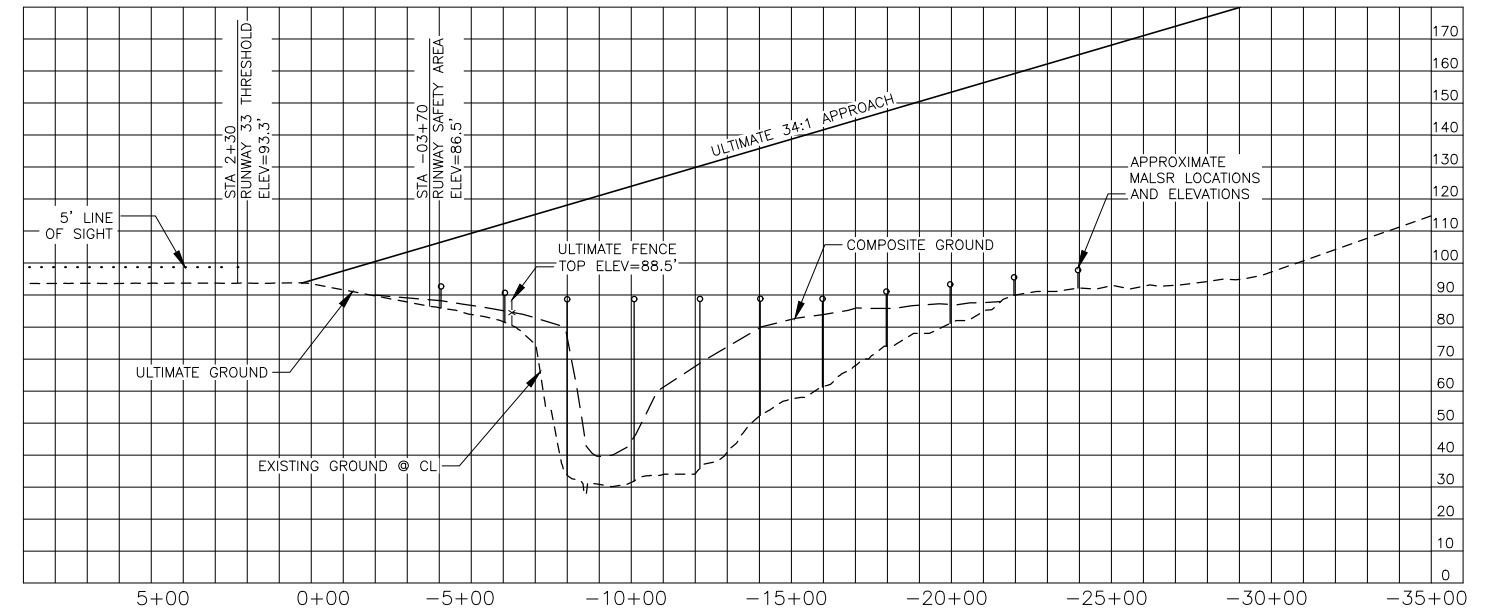

**RUNWAY 33**

PART 77 SURFACE OBSTRUCTION TABLE (INNER PORTION RW 33)								
ID #	DESCRIPTION	STATION/OFFSET	ELEVATION	SURFACE PENETRATED	SURFACE ELEVATION	AMOUNT PENETRATION	DISPOSITION	STAGE TO CORRECT
	NONE							

- NOTE: REFER TO THE AIRPORT AIRSPACE DRAWING FOR PENETRATIONS OF THE OUTER APPROACH SURFACES.
- THERE ARE NO OBSTRUCTIONS IN THE APPROACH TO RUNWAY 33, THEREFORE THE OBSTRUCTION CLEARANCE SLOPE IS ESTABLISHED AS 34:1 PER FAA AC 150/5200-35A, SECTION 4, DATA ELEMENT NUMBER 57.
  - THERE ARE NO OBJECT PENETRATIONS IN THE RUNWAY APPROACH END SITING SURFACE OF RUNWAY 33, AS DEFINED IN FAA AC 150/5300-13A, SECTION 3, TABLE 3-2, LINE 4.
  - THERE ARE NO OBJECT PENETRATIONS IN THE RUNWAY DEPARTURE END SITING SURFACE OF RUNWAY 33, AS DEFINED IN FAA AC 150/5300-13A, SECTION 3, TABLE 3-2, LINE 9.

R&M	09/07/18	AS-BUILT UPDATE
DOWL	09/18/15	AS-BUILT UPDATE
BY	DATE	REVISION
<b>STATE OF ALASKA DEPARTMENT OF TRANSPORTATION AND PUBLIC FACILITIES SOUTHCOST REGION</b>		
<b>COLD BAY AIRPORT COLD BAY, ALASKA AIRPORT LAYOUT PLAN</b>		DATE: 09/07/2018
INNER PORTION OF RUNWAY 15/33 APPROACH SURFACE		SHEET: 6 OF 10

FILE No.:

Designed By: CCW  
 Drawn By: BFO  
 Checked By: BRH

Date Plotted: 9/07/2018, 2:50 PM  
 Layout Name: (8) UAPF 8-26  
 File Name: Z:\Project\2316.01 DOT\_C Cold Bay Crosswind Design Services\Civil\CAD\VALP Update\CB-ALP.dwg

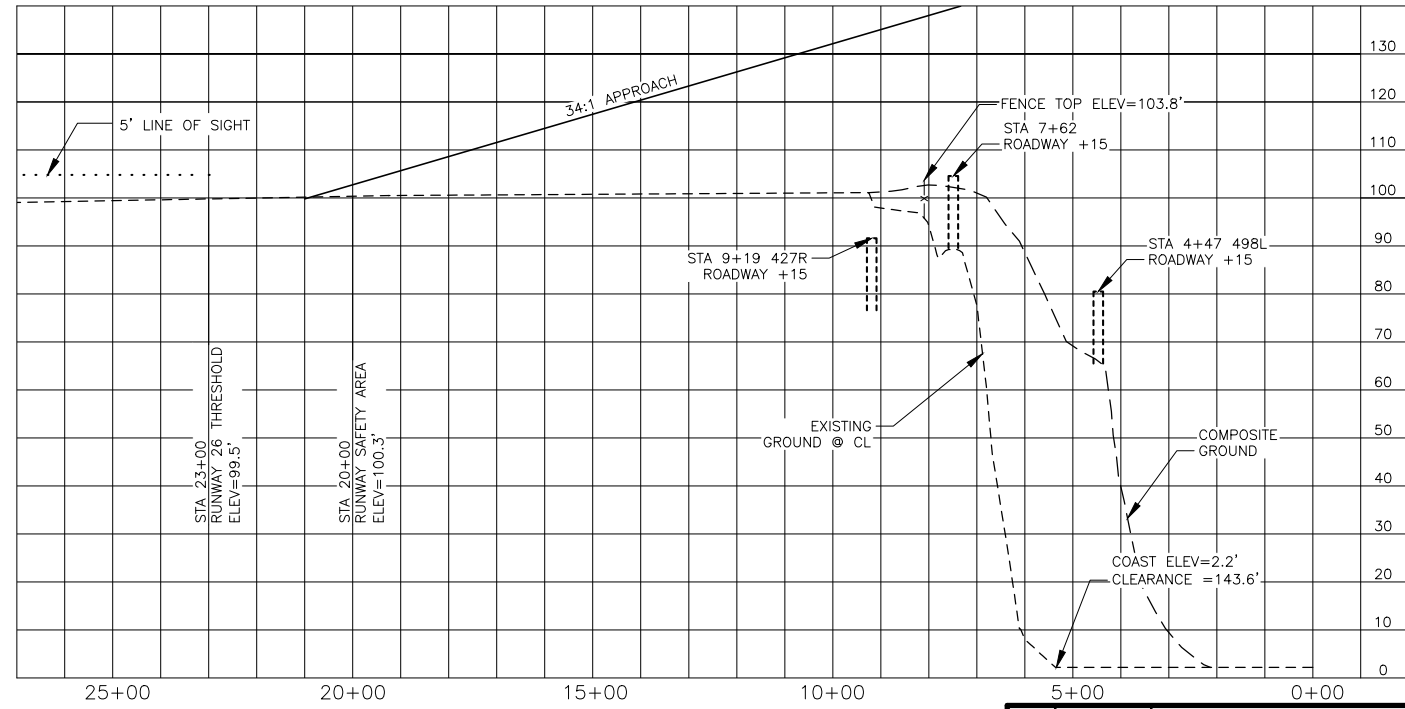
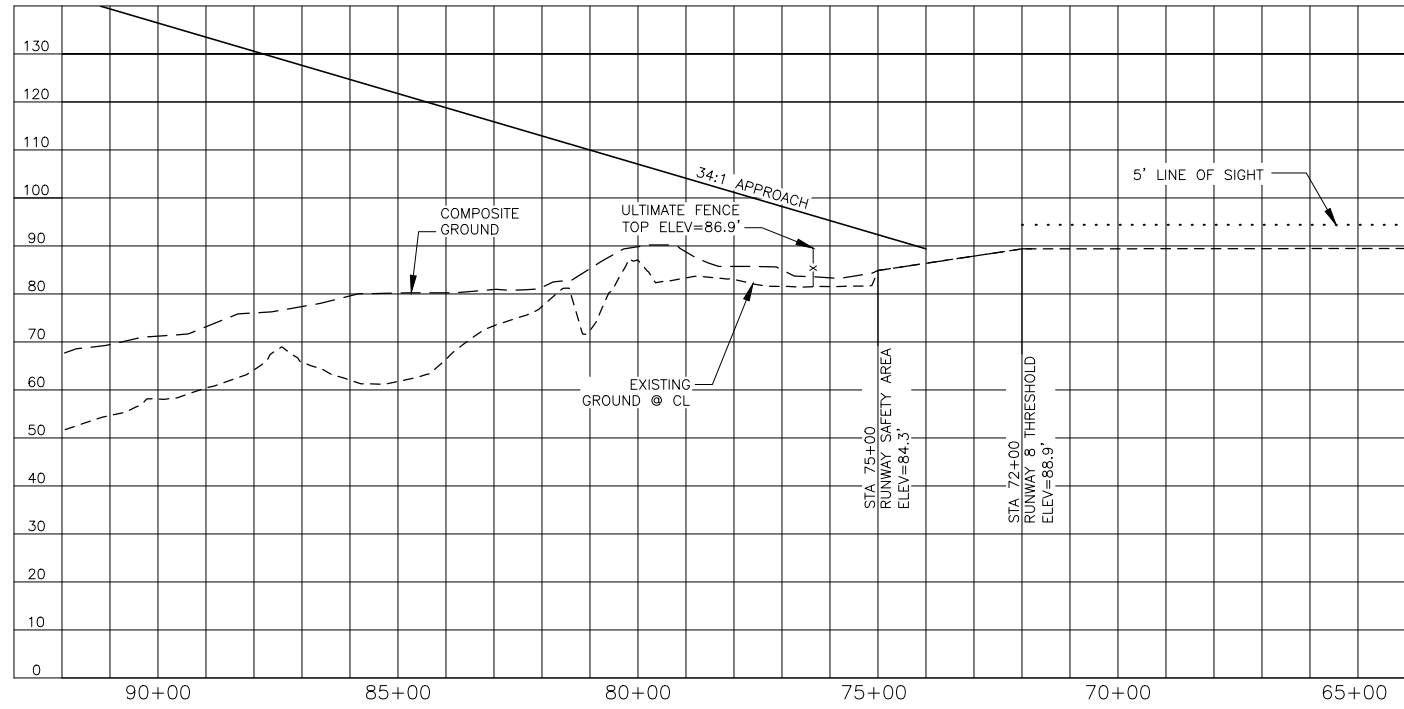
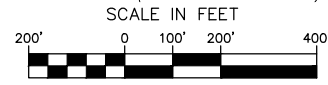
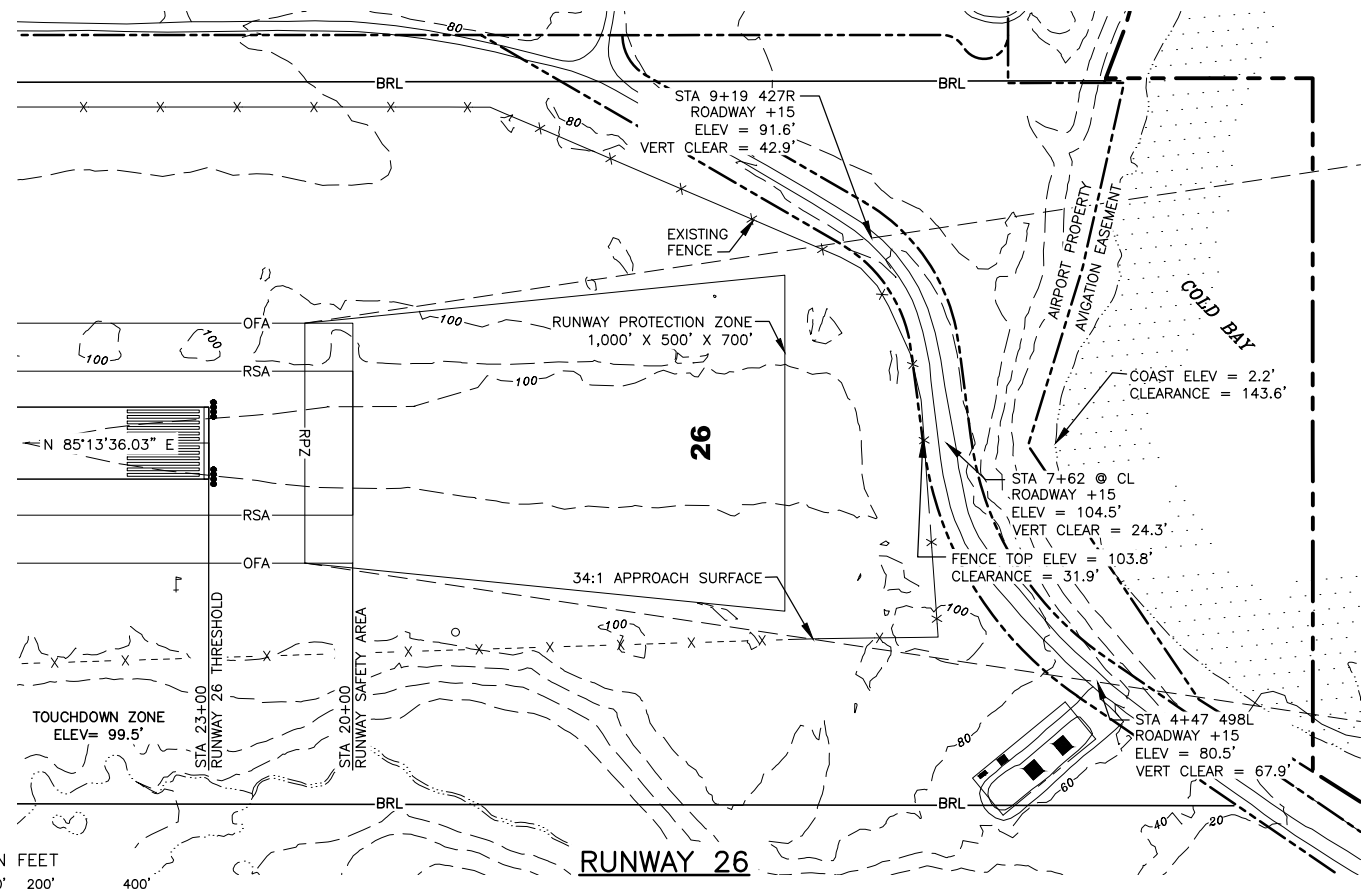
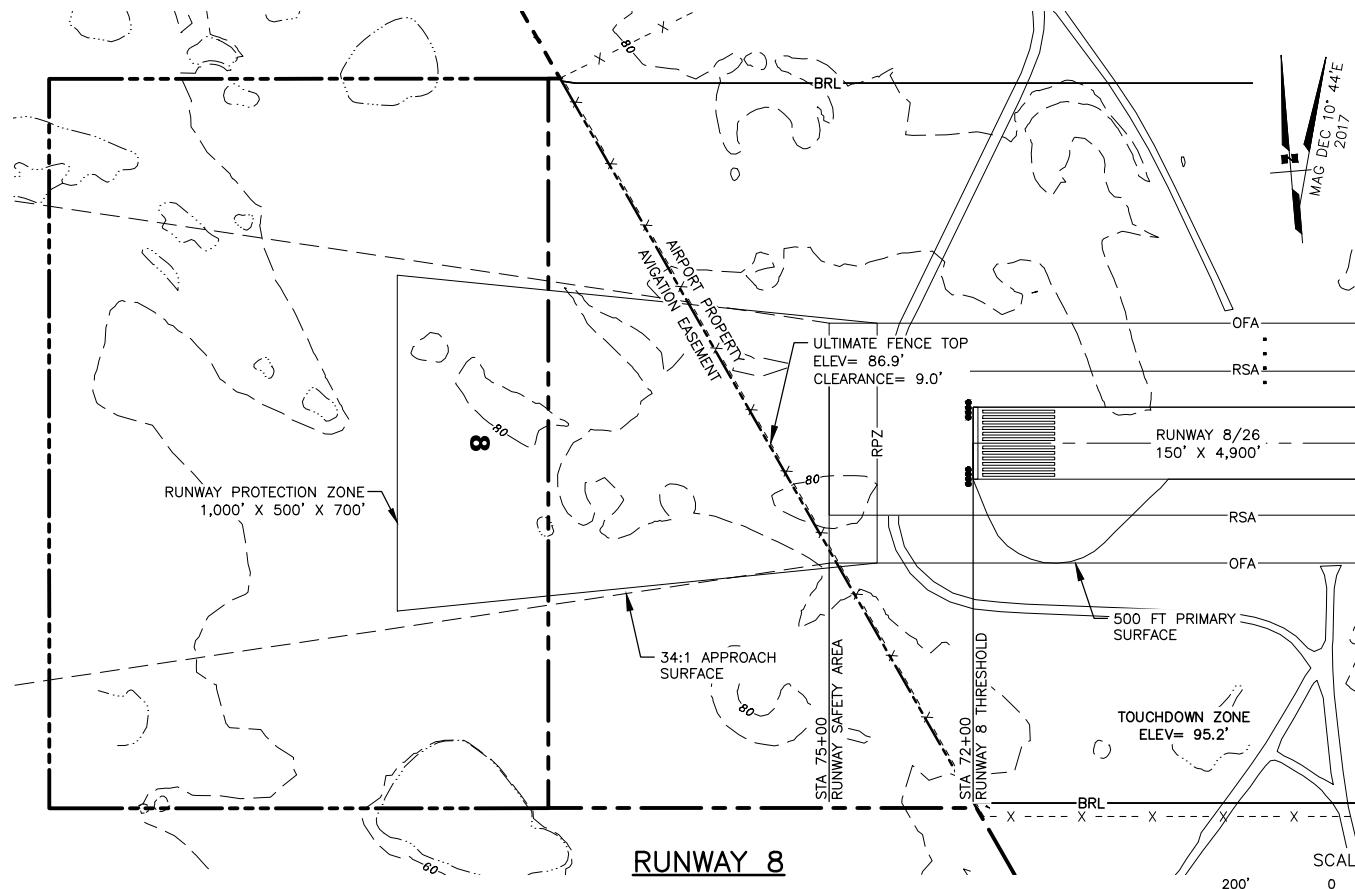

**RUNWAY 8**

**RUNWAY 26**

PART 77 SURFACE OBSTRUCTION TABLE (INNER PORTION RW 8)								
ID #	DESCRIPTION	STATION/OFFSET	ELEVATION	SURFACE PENETRATED	SURFACE ELEVATION	AMOUNT PENETRATION	DISPOSITION	STAGE TO CORRECT
	NONE							

PART 77 SURFACE OBSTRUCTION TABLE (INNER PORTION RW 26)								
ID #	DESCRIPTION	STATION/OFFSET	ELEVATION	SURFACE PENETRATED	SURFACE ELEVATION	AMOUNT PENETRATION	DISPOSITION	STAGE TO CORRECT
	NONE							

- NOTE: REFER TO THE AIRPORT AIRSPACE DRAWING FOR PENETRATIONS OF THE OUTER APPROACH SURFACES.
- THERE ARE NO OBSTRUCTIONS IN THE APPROACH TO RUNWAY 8, THEREFORE THE OBSTRUCTION CLEARANCE SLOPE IS ESTABLISHED AS 34:1 PER FAA AC 150/5200-35A, SECTION 4, DATA ELEMENT NUMBER 57.
  - THERE ARE NO OBJECT PENETRATIONS IN THE RUNWAY APPROACH END SITING SURFACE OF RUNWAY 8, AS DEFINED IN FAA AC 150/5300-13A, SECTION 3, TABLE 3-2, LINE 4.
  - THERE ARE NO OBJECT PENETRATIONS IN THE RUNWAY DEPARTURE END SITING SURFACE OF RUNWAY 8, AS DEFINED IN FAA AC 150/5300-13A, SECTION 3, TABLE 3-2, LINE 9.

- NOTE: REFER TO THE AIRPORT AIRSPACE DRAWING FOR PENETRATIONS OF THE OUTER APPROACH SURFACES.
- THERE ARE NO OBSTRUCTIONS IN THE APPROACH TO RUNWAY 26, THEREFORE THE OBSTRUCTION CLEARANCE SLOPE IS ESTABLISHED AS 34:1 PER FAA AC 150/5200-35A, SECTION 4, DATA ELEMENT NUMBER 57.
  - THERE ARE NO OBJECT PENETRATIONS IN THE RUNWAY APPROACH END SITING SURFACE OF RUNWAY 26, AS DEFINED IN FAA AC 150/5300-13A, SECTION 3, TABLE 3-2, LINE 4.
  - THERE ARE NO OBJECT PENETRATIONS IN THE RUNWAY DEPARTURE END SITING SURFACE OF RUNWAY 26, AS DEFINED IN FAA AC 150/5300-13A, SECTION 3, TABLE 3-2, LINE 9.

R&M	09/07/18	AS-BUILT UPDATE
DOWL	08/28/15	AS-BUILT UPDATE
BY	DATE	REVISION
STATE OF ALASKA DEPARTMENT OF TRANSPORTATION AND PUBLIC FACILITIES SOUTHCOST REGION		
COLD BAY AIRPORT COLD BAY, ALASKA AIRPORT LAYOUT PLAN		DATE: 09/07/2018
INNER PORTION OF RUNWAY 8/26 APPROACH SURFACE		SHEET: 7 OF 10



FILE No.:  
 Date Plotted: 9/07/2018, 2:50 PM  
 Layout Name: 9 PART 77  
 File Name: Z:\Project\2316.01 DOT\_C Cold Bay Crosswind Design Services\Civil\ACAD\ALP Update\CB-ALP.dwg  
 Designed By: CCW  
 Drawn By: BFO  
 Checked By: BRH

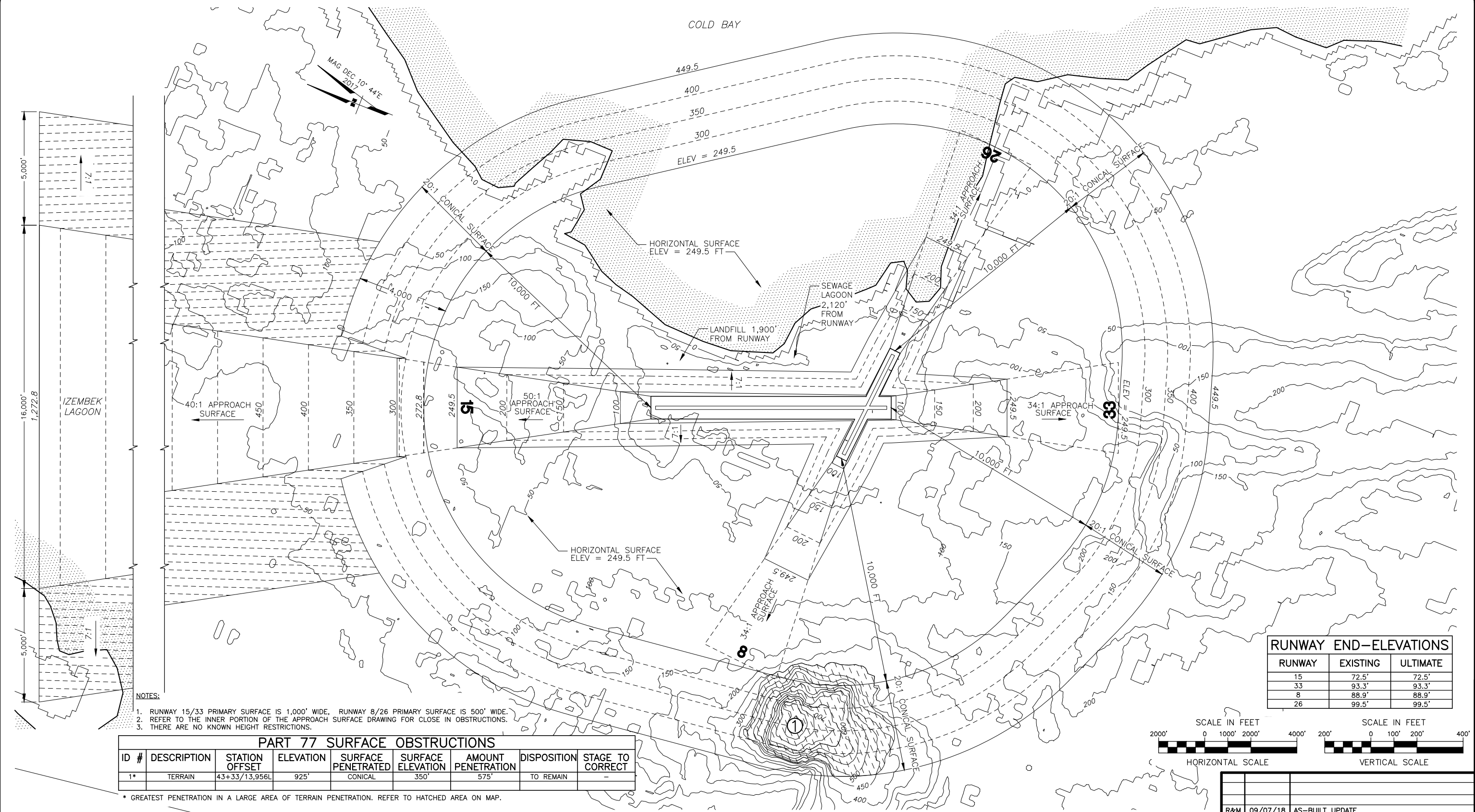

- NOTES:
1. RUNWAY 15/33 PRIMARY SURFACE IS 1,000' WIDE, RUNWAY 8/26 PRIMARY SURFACE IS 500' WIDE.
  2. REFER TO THE INNER PORTION OF THE APPROACH SURFACE DRAWING FOR CLOSE IN OBSTRUCTIONS.
  3. THERE ARE NO KNOWN HEIGHT RESTRICTIONS.

RUNWAY END-ELEVATIONS		
RUNWAY	EXISTING	ULTIMATE
15	72.5'	72.5'
33	93.3'	93.3'
8	88.9'	88.9'
26	99.5'	99.5'

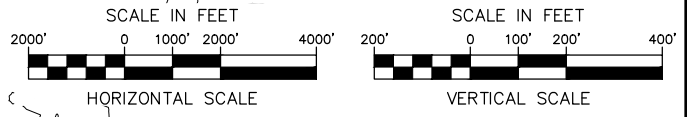

PART 77 SURFACE OBSTRUCTIONS								
ID #	DESCRIPTION	STATION OFFSET	ELEVATION	SURFACE PENETRATED	SURFACE ELEVATION	AMOUNT PENETRATION	DISPOSITION	STAGE TO CORRECT
1*	TERRAIN	43+33/13,956L	925'	CONICAL	350'	575'	TO REMAIN	-

\* GREATEST PENETRATION IN A LARGE AREA OF TERRAIN PENETRATION. REFER TO HATCHED AREA ON MAP.

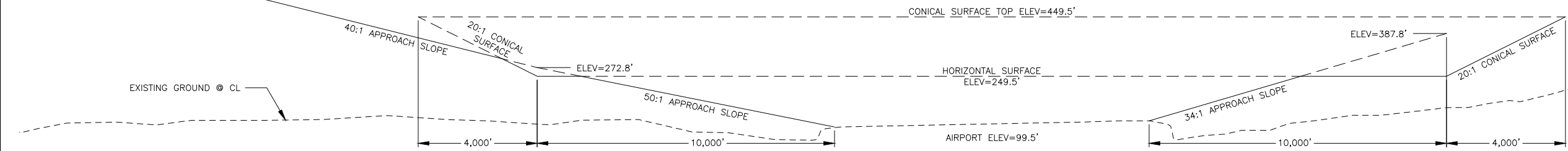

RUNWAY 15/33 PROFILE

R&M	09/07/18	AS-BUILT UPDATE
DOWL	08/28/15	AS-BUILT UPDATE
BY	DATE	REVISION
STATE OF ALASKA DEPARTMENT OF TRANSPORTATION AND PUBLIC FACILITIES SOUTHCOST REGION		
COLD BAY AIRPORT COLD BAY, ALASKA AIRPORT LAYOUT PLAN		DATE: 09/07/2018 SHEET: 8 OF 10
AIRPORT AIRSPACE 14 CFR, PART 77		



Date Plotted: 9/07/2018, 2:50 PM  
 Layout Name: (10) PRGP  
 File Name: Z:\Project\2316.01 DOT\_C Cold Bay Crosswind Design Services\Civil\CAD\VALP Update\CB-ALP.dwg  
 Designed By: CCW  
 Drawn By: BFO  
 Checked By: BRH

PROPERTY STATUS					
ID #	INTEREST	GRANTOR	GRANTEE	PARCEL SIZE (ACRES)	DATE ACQUIRED
1A	AVIGATION & HAZARD EASEMENT	STATE OF ALASKA, DOT&PF	STATE OF ALASKA, DNR	141.039	12/9/94
1B	FEE SIMPLE, SEC. 45, AK OMNIBUS ACT	U.S.A.	STATE OF ALASKA	30.669	6/1/66
1C	AVIGATION & HAZARD EASEMENT	STATE OF ALASKA, DOT&PF	ALEUTIANS EAST BOROUGH	12.630	
1D	AVIGATION & HAZARD EASEMENT	STATE OF ALASKA, DOT&PF	STATE OF ALASKA, DNR	69.446	12/9/94
1E	AVIGATION & HAZARD EASEMENT	STATE OF ALASKA, DOT&PF	STATE OF ALASKA, DNR	10.890	12/9/94
1F	AVIGATION & HAZARD EASEMENT	STATE OF ALASKA, DOT&PF	STATE OF ALASKA, DNR	2.332	12/9/94
1G	AVIGATION & HAZARD EASEMENT	STATE OF ALASKA, DOT&PF	STATE OF ALASKA, DNR	5.909	12/9/94
1H	FEE SIMPLE, SEC. 45, AK OMNIBUS ACT	U.S.A.	STATE OF ALASKA	11.562	6/1/66
1I	AVIGATION & HAZARD EASEMENT	STATE OF ALASKA, DOT&PF	STATE OF ALASKA, DNR	58.457	12/9/94
1J	FEE SIMPLE, SEC. 45, AK OMNIBUS ACT	U.S.A.	STATE OF ALASKA	10.519	6/1/66
1K	FEE SIMPLE, SEC. 45, AK OMNIBUS ACT	U.S.A.	STATE OF ALASKA	1826.174	6/1/66
1L	FEE SIMPLE, SEC. 45, AK OMNIBUS ACT	U.S.A.	STATE OF ALASKA	0.215	6/1/66
1M	AVIGATION & HAZARD EASEMENT	STATE OF ALASKA, DOT&PF	STATE OF ALASKA, DNR	2.318	10/5/95
1N	FEE SIMPLE, SEC. 45, AK OMNIBUS ACT	U.S.A.	STATE OF ALASKA	2.877	6/1/66
1O	FEE SIMPLE, SEC. 45, AK OMNIBUS ACT	U.S.A.	STATE OF ALASKA	0.969	6/1/66
1P	AVIGATION & HAZARD EASEMENT	STATE OF ALASKA, DOT&PF	STATE OF ALASKA, DNR	4.566	9/4/79
1Q	NONE	STATE OF ALASKA, DOT&PF	ALEUTIANS EAST BOROUGH	1.615	
1R	NONE	STATE OF ALASKA, DOT&PF	ALEUTIANS EAST BOROUGH	2.186	
1S	NONE	STATE OF ALASKA, DOT&PF	ALEUTIANS EAST BOROUGH	2.256	6/20/03
1T	AVIGATION & HAZARD EASEMENT	STATE OF ALASKA, DOT&PF	STATE OF ALASKA, DNR	1.938	9/4/79
1U	AVIGATION & HAZARD EASEMENT	STATE OF ALASKA, DOT&PF	STATE OF ALASKA, DNR	4.216	9/4/79
1V	AVIGATION & HAZARD EASEMENT	STATE OF ALASKA, DOT&PF	STATE OF ALASKA, DNR	8.913	9/4/79
1W	AVIGATION & HAZARD EASEMENT	STATE OF ALASKA, DOT&PF	STATE OF ALASKA, DNR	28.463	9/4/79
1X	AVIGATION & HAZARD EASEMENT	STATE OF ALASKA, DOT&PF	STATE OF ALASKA, DNR	26.957	9/4/79
1Y	AVIGATION & HAZARD EASEMENT	STATE OF ALASKA, DOT&PF	STATE OF ALASKA, DNR	26.834	9/4/79
1Z	AVIGATION & HAZARD EASEMENT	STATE OF ALASKA, DOT&PF	STATE OF ALASKA, DNR	16.206	9/4/79
1AA	FEE SIMPLE, SEC. 45, AK OMNIBUS ACT	U.S.A.	STATE OF ALASKA	3.185	6/1/66
1AB	FEE SIMPLE, SEC. 45, AK OMNIBUS ACT	U.S.A.	STATE OF ALASKA	1.300	6/1/66
1AC	FEE SIMPLE, SEC. 45, AK OMNIBUS ACT	U.S.A.	STATE OF ALASKA	33.136	6/1/66
1AD	FEE SIMPLE, SEC. 45, AK OMNIBUS ACT	U.S.A.	STATE OF ALASKA	21.074	6/1/66
1AE	FEE SIMPLE, SEC. 45, AK OMNIBUS ACT	U.S.A.	STATE OF ALASKA	16.594	6/1/66
1AF	FEE SIMPLE, SEC. 45, AK OMNIBUS ACT	U.S.A.	STATE OF ALASKA	0.571	6/1/66
2	AVIGATION & HAZARD EASEMENT	STATE OF ALASKA, DNR	STATE OF ALASKA, DOT&PF	123.673	8/3/93
3	INTERAGENCY LAND MANAGEMENT ASSIGNMENT	STATE OF ALASKA, DNR	STATE OF ALASKA, DOT&PF	13.964	3/17/05
4	TO BE ACQUIRED	STATE OF ALASKA, DOT&PF	STATE OF ALASKA, DNR	22.434	

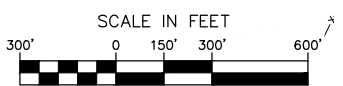
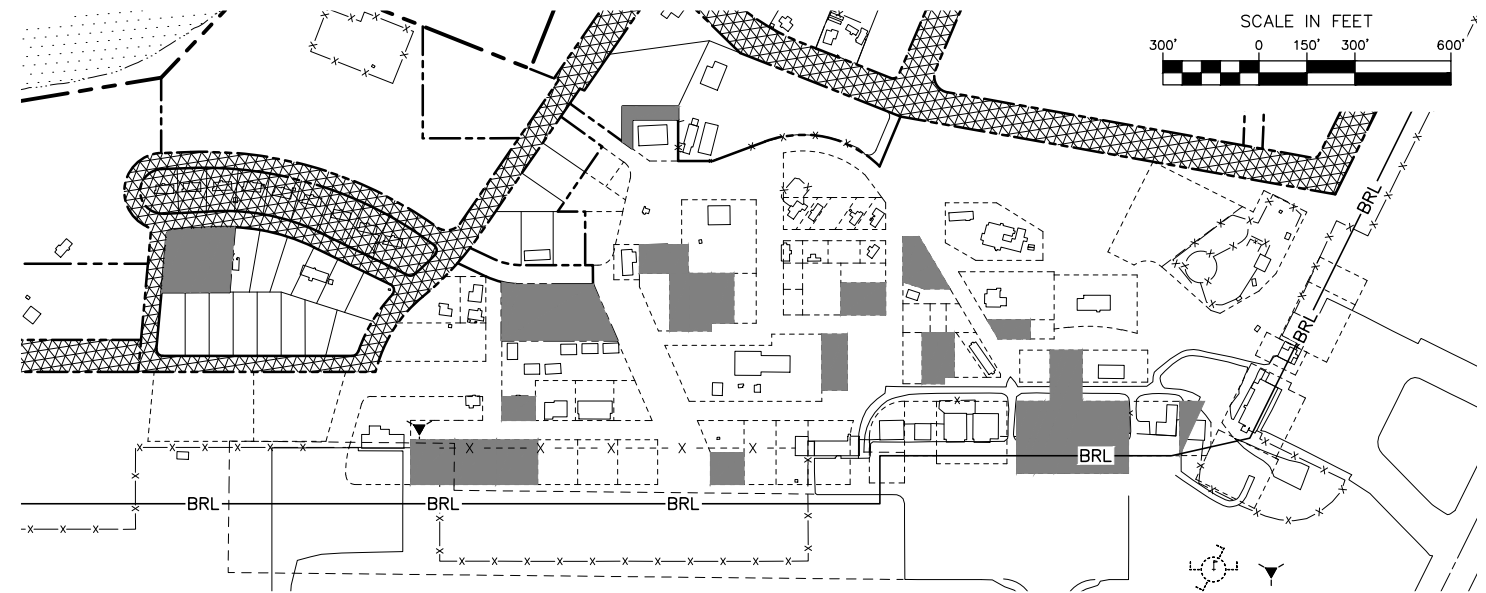

**SURVEY NOTES**

1. THE INFORMATION PROVIDED IS BASED ON THE DOT & PF AIRPORT PROPERTY PLAN DATED 05/01/2010, AND INCLUDES DEED RESERVATIONS BASED ON THE OMNIBUS ACT DATED 06/01/1966 AND THE DOT&PF COLD BAY AIRPORT LAND OCCUPANCY DATED 06/24/2009.

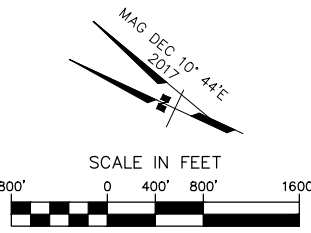
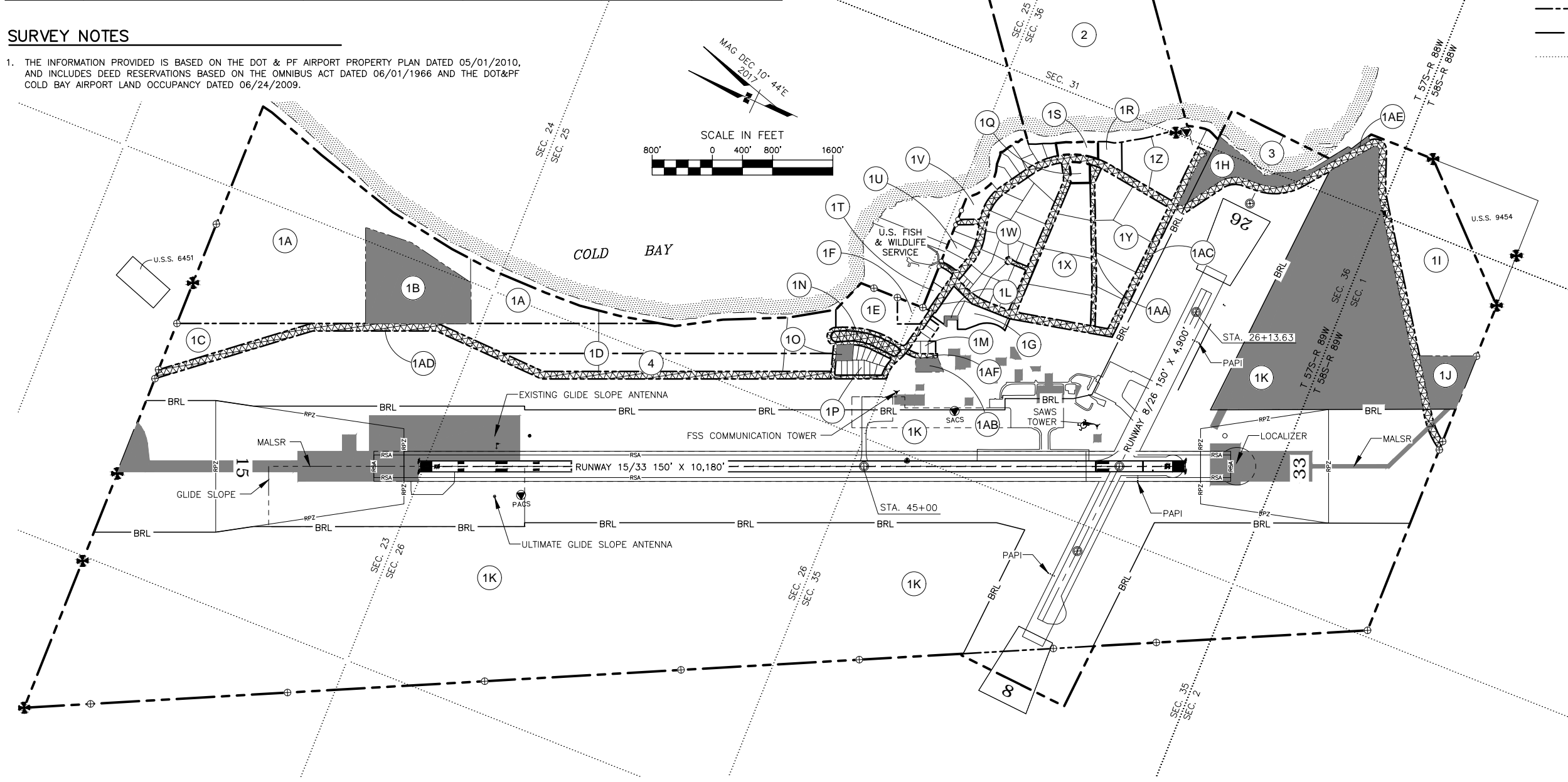

- MONUMENT LEGEND**
- EXISTING AIRPORT BOUNDARY
  - ULTIMATE AIRPORT BOUNDARY
  - EXISTING TRACT LINES
  - ULTIMATE TRACT LINES
  - SECTION LINES
  - ⊕ RECOVERED BLM MONUMENT
  - ⊕ RECOVERED GOVERNMENT CONTROL STATION
  - ⊕ RECOVERED PRIMARY CENTERLINE MONUMENT
  - ⊕ RECOVERED PRIMARY CORNER
  - RECOVERED SECONDARY CORNER

- PROPERTY LEGEND**
- DEED RESERVATIONS
  - ▨ ROAD RIGHT-OF-WAY

R&M	09/07/18	AS-BUILT UPDATE
DOWL	05/23/16	PROPERTY BOUNDARY UPDATE
DOWL	08/28/15	AS-BUILT UPDATE
BY	DATE	REVISION

**STATE OF ALASKA**  
**DEPARTMENT OF TRANSPORTATION**  
**AND PUBLIC FACILITIES**  
**SOUTHCOST REGION**

**COLD BAY AIRPORT**  
 COLD BAY, ALASKA  
 AIRPORT LAYOUT PLAN  
 AIRPORT PROPERTY MAP

DATE: 09/07/2018  
 SHEET: 9 OF 10



Date Plotted: 9/07/2018, 2:51 PM  
 Layout Name: (11) LAND USE  
 File Name: Z:\Project\2316.01 DOT\_C Cold Bay Crowwind Design Services\Civil\ACAD\VALP Update\CB-ALP.dwg  
 Designed By: CCW  
 Drawn By: BFO  
 Checked By: BRH

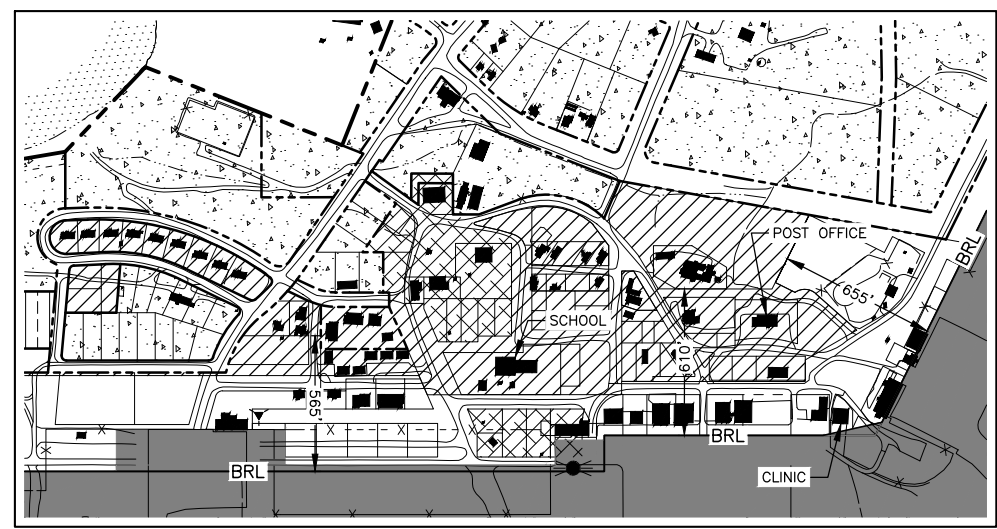





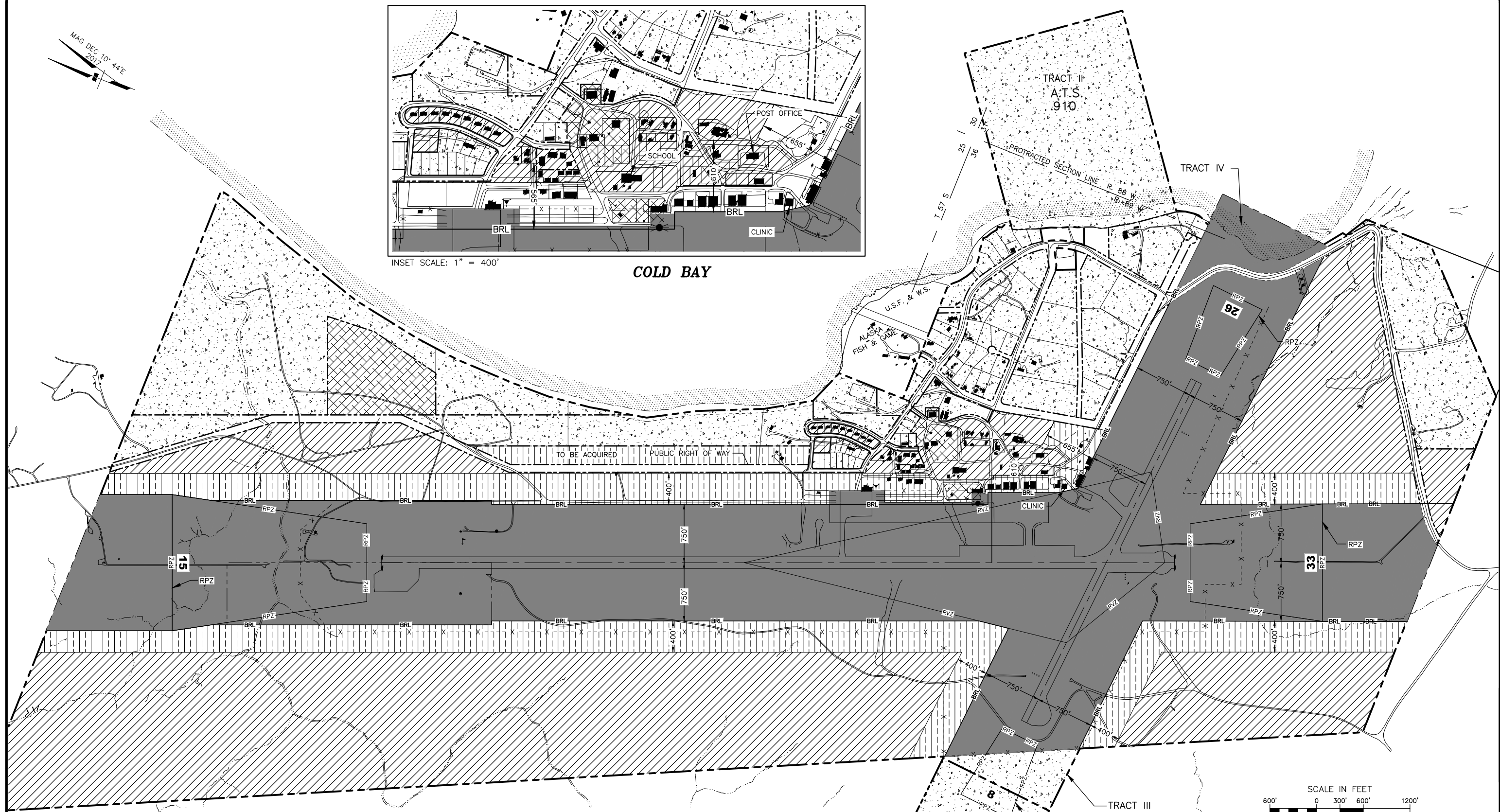

INSET SCALE: 1" = 400'

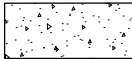
**COLD BAY**



**PROPERTY LEGEND**

- |  |                          |  |                           |   |                            |
|--|--------------------------|--|---------------------------|---|----------------------------|
|   | AVIATION REVENUE AREA    |  | AVIGATION HAZARD EASEMENT |  | NO DOT&PF INTEREST         |
|   | REVENUE SUPPORT AREA     |  | MAINTENANCE RESERVE       |  | EXISTING PROPERTY BOUNDARY |
|  | AIRCRAFT OPERATIONS AREA |  |                           |  | FUTURE AVIGATION EASEMENT  |

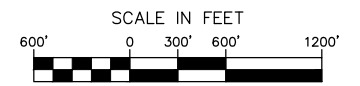

BY	DATE	REVISION
R&M	09/07/18	AS-BUILT UPDATE
DOWL	08/28/15	AS-BUILT UPDATE

**STATE OF ALASKA**  
**DEPARTMENT OF TRANSPORTATION**  
**AND PUBLIC FACILITIES**  
**SOUTHCOST REGION**

**COLD BAY AIRPORT**  
 COLD BAY, ALASKA  
 AIRPORT LAYOUT PLAN

LAND USE PLAN

DATE:	09/07/2018
SHEET:	10
	OF 10