

Date Plotted: 1/29/2013, 8:26 AM  
 Layout Name: W:\Projects\False Pass\ALP\2012 ALP Final Drawings\ALP-KFP.dwg  
 File Name:

Designed By: BT  
 Drawn By: RAR  
 Checked By: ACH

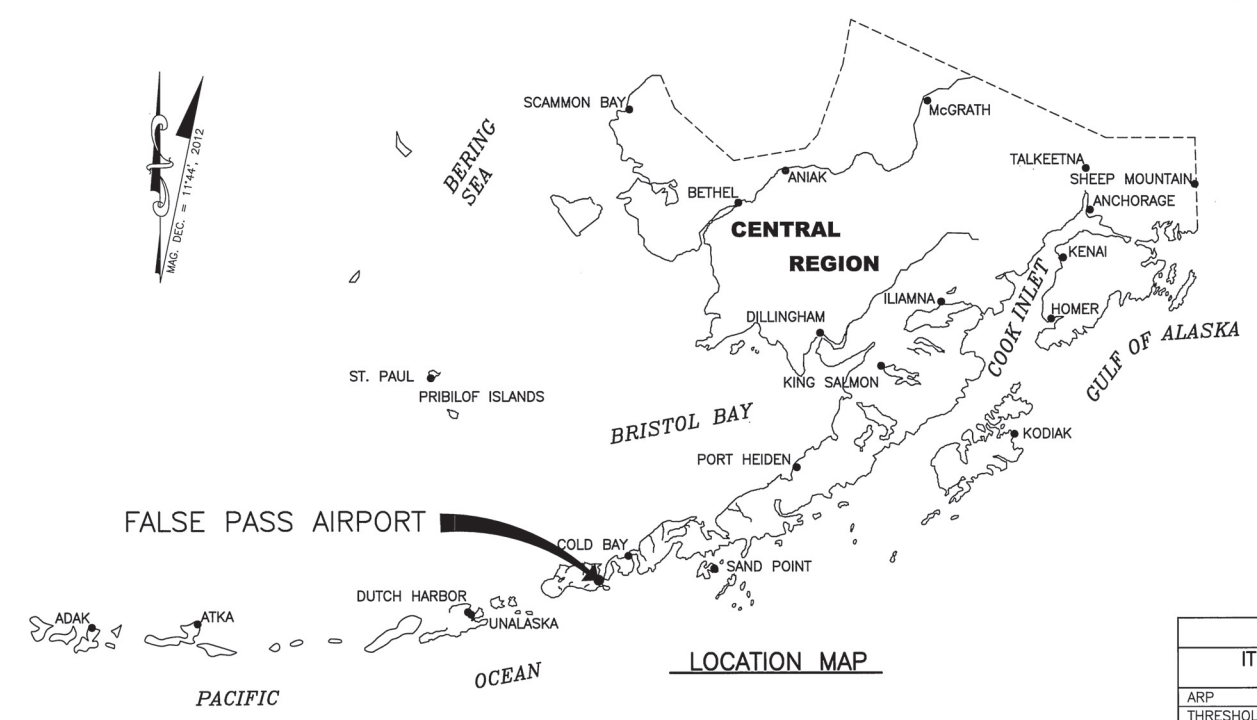

LEGEND		
ITEM	EXISTING	ULTIMATE
AIRPORT REFERENCE POINT (A.R.P.)		
ANTENNA		
BLUFF		
BUILDINGS		
BUILDING RESTRICTION LINE		
CULVERT		
FENCE		
PAPI		
PROPERTY LINE		
REIL		
ROADWAYS		
ROTATING BEACON		
SHORELINE		
SURVEY MONUMENT		
THRESHOLD MARKERS/LIGHTS		
TOPOGRAPHIC CONTOURS		
TREE (LARGE SINGLE)		
TREELINE		
VASI		
WIND CONE		
WIND CONE AND SEGMENTED CIRCLE		

AIRPORT DATA TABLE		
ITEM	EXISTING	ULTIMATE
ICAO IDENTIFIER	PAKF	PAKF
NATIONAL AIRPORT IDENTIFIER	KFP	KFP
FAA SITE NUMBER	50221.5*A	50221.5*A
AIRPORT ELEVATION NAVD88	18.7	21.7
AIRPORT REFERENCE CODE	A I	A I
MEAN MAX. TEMPERATURE, HOTTEST MONTH	57° F AUGUST	57° F AUGUST
AIRPORT AND TERMINAL NAVIGATION AIDS	NONE	ROTATING BEACON
TAXIWAY LIGHTING/MARKING	NONE/NONE	MI/NONE
OBSTRUCTION SURVEY SOURCE & TYPE	NONE	NVG
MAGNETIC DECLINATION, YEAR, RATE OF CHANGE	11'44"E, 2012,	-0'11" (W)/YEAR

GEOGRAPHIC COORDINATES TABLE				
ITEM	EXISTING LATITUDE	EXISTING LONGITUDE	ULTIMATE LATITUDE	ULTIMATE LONGITUDE
ARP	54°50'52.15"	163°24'25.48"	54°50'48.13"	163°24'21.30"
THRESHOLD RW 14	54°51'01.33"	163°24'34.65"	54°51'01.33"	163°24'34.65"
THRESHOLD RW 32	54°50'43.02"	163°24'16.14"	54°50'34.94"	163°24'07.96"

RUNWAY 14/32 DATA TABLE		
ITEM	EXISTING	ULTIMATE
RUNWAY TYPE UTILITY OR OTHER THAN UTILITY	UTILITY	OTHER THAN UTILITY
FAR PART 77 APPROACH CATEGORY (V, NPI, P)	V / V	V / V
APPROACH SURFACES	20:1 / 20:1	20:1 / 20:1
VISIBILITY MINIMUM	≥ 1 SM	≥ 1 SM
RUNWAY SURFACE	GRAVEL	GRAVEL
PAVEMENT STRENGTH SW,DW,DTW,DDTW x1000lbs	N/A	N/A
AIRCRAFT APPROACH CATEGORY	A	A
AIRPLANE DESIGN GROUP	I	I
TRUE BEARING	N28° 47' 41"W	N29° 06' 50"W
EFFECTIVE GRADE	0.46 %	0.12 %
TOUCHDOWN ELEVATION NAVD88	18.7 / 18.7	21.7 / 21.2
RUNWAY DIMENSIONS	60 X 2150	60 X 3100
RUNWAY SAFETY AREA (RSA) DIMENSIONS	120 X 2630	120 X 3580
LENGTH BEYOND R/W END	240 / 240	240 / 240
RUNWAY PROTECTION ZONE (RPZ) DIMENSIONS	250 X 450 X 1000	500 X 700 X 1000
RUNWAY OBJECT FREE AREA (OFA) DIMENSIONS	250 X 2630	400 X 3580
LENGTH BEYOND R/W END OR STOPWAY	240/240	240/240
RUNWAY OBSTACLE FREE ZONE (OFZ) DIMENSIONS	250 X 2550	400 X 3500
RUNWAY LIGHTING	NONE	M.I.
RUNWAY MARKING TYPE	NONE	NONE
RUNWAY VISUAL APPROACH AIDS	REIL	REIL

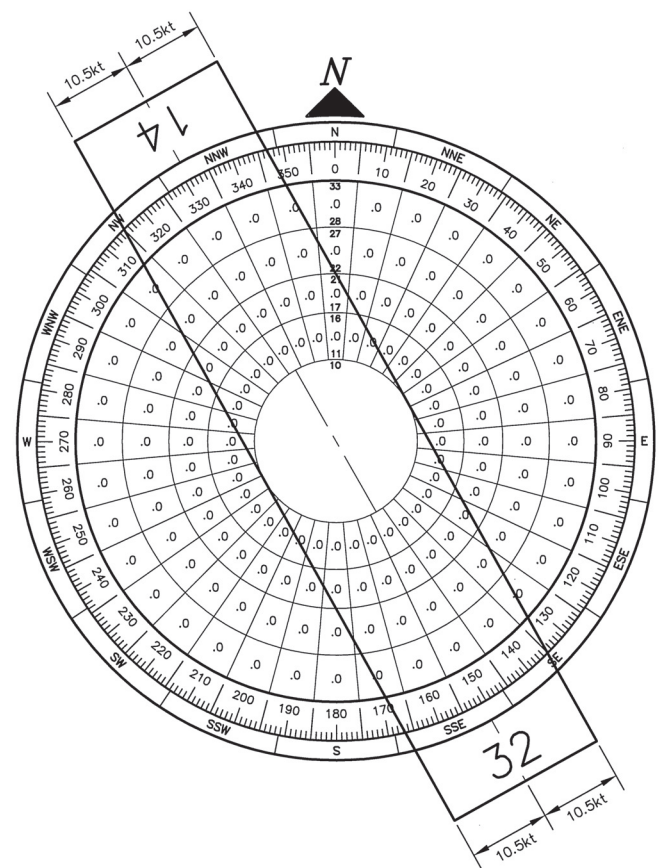

WIND DATA TABLE				
RUNWAY	10.5 kt	13 kt	16 kt	20 kt
14/32				

\* WIND DATA NOT AVAILABLE.

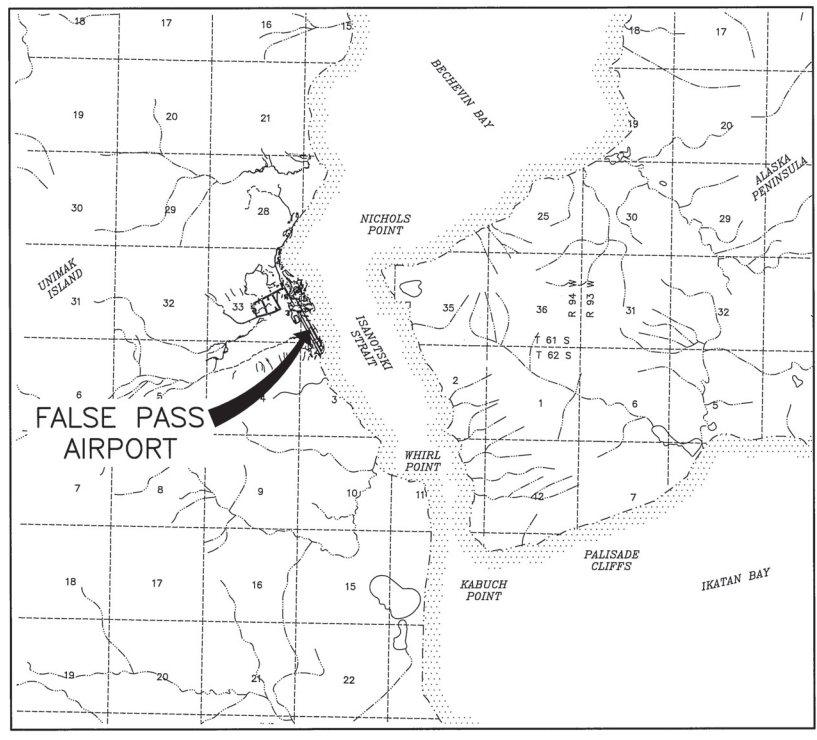

**VICINITY MAP**  
 1 SM .5 SM 0 1 SM 2 SM  
 SEC. 33, 34, T 61 S, R 94 W,  
 SEC. 3, T 62 S, R 94 W,  
 SEWARD MERIDIAN  
 U.S.G.S. FALSE PASS (D-5), ALASKA



**NOTES:**

1. DUE TO CHANGES IN THE MAGNETIC DECLINATION, RUNWAY NUMBERS CHANGED FROM 13-31 TO 14-32.

DRAWING INDEX	
SHT #	TITLE
1	DATA
2	EXISTING LAYOUT
3	ULTIMATE LAYOUT
4	EXISTING INNER PORTION OF THE APPROACH SURFACE - RUNWAY 14
5	EXISTING INNER PORTION OF THE APPROACH SURFACE - RUNWAY 32
6	ULTIMATE INNER PORTION OF THE APPROACH SURFACE - RUNWAY 14
7	ULTIMATE INNER PORTION OF THE APPROACH SURFACE - RUNWAY 32
8	AIRPORT AIRSPACE, 14 CFR, PART 77
9	AIRPORT PROPERTY MAP

BY: _____ DATE: _____ APPROVED: _____ DATE: 2/6/2013 KENNETH M. MORTON, P.E. PRECONSTRUCTION ENGINEER RECOMMENDED: _____ DATE: 2/6/2013 HARVEY M. DOUTHIT, P.E. DESIGN SECTION CHIEF	<b>STATE OF ALASKA</b> <b>DEPARTMENT OF TRANSPORTATION</b> <b>AND PUBLIC FACILITIES</b> <b>CENTRAL REGION</b> <b>FALSE PASS AIRPORT</b> FALSE PASS, ALASKA AIRPORT LAYOUT PLAN DATE: 1/29/2013 SHEET: 1 OF 9
--	--

AIRPORT LAYOUT PLAN CONDITIONAL APPROVAL SUBJECT TO ALP APPROVAL LETTER DATED 2/11/13  
 FAA AIRSPACE REVIEW NUMBER: 2011-AAL-156-N/A  
 DATE: 2/11/13  
 FAA, AIRPORTS DIVISION ALASKAN REGION, AAL-621

Date Plotted: 1/30/2013 9:46 AM  
 User: E:\Users\j...  
 File Name: W:\Projects\False Pass\ALP\2012 ALP\Final Drawings\ALP-KFP.dwg

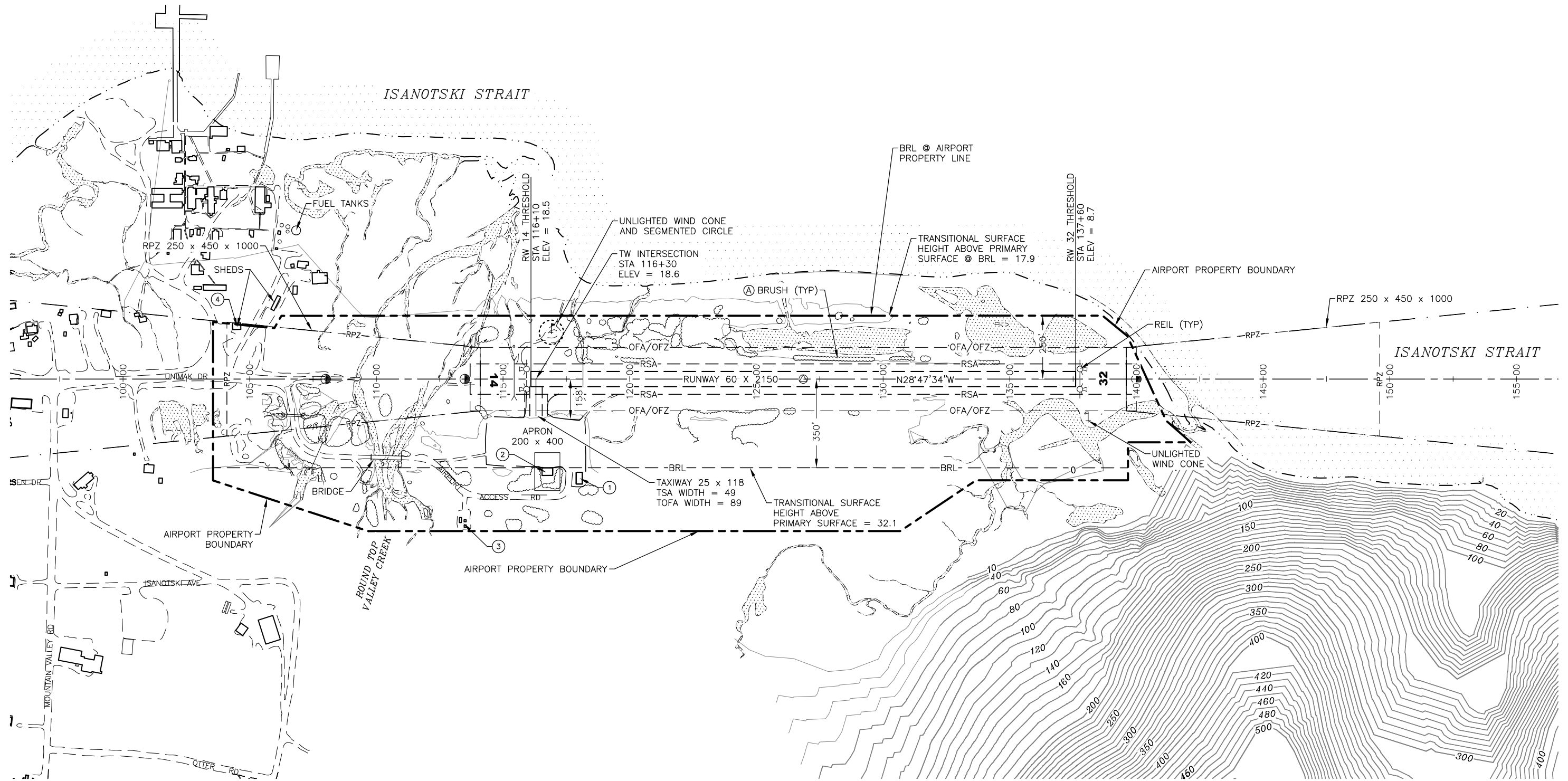

BUILDING DATA TABLE				
ID #	DESCRIPTION	STATION/OFFSET	TOP ELEV (MSL)	OBSTRUCT MARKING
①	SRE BUILDING	117+99/368' RT	43.7	NONE
②	HANGAR	116+73/350' RT	42.3	NONE
③	AWOS	112+86/478' RT	61.1	NONE
④	SHED	104+50/215' LT	UNKNOWN	NONE

OFZ PENETRATIONS		
ID #	DESCRIPTION	DISPOSITION
Ⓐ	BRUSH	REMOVE

NOTE: BRUSH ALONG BOTH SIDES OF THE RUNWAY.

**NOTES:**

- AIRPORT DOES NOT HAVE A ROTATING BEACON.
- ULTIMATE PROJECT TO RELOCATE EXISTING HANGAR TO NEW LEASE LOT AND REMOVE THE EXISTING SRE BUILDING.

BY	DATE	REVISION

**STATE OF ALASKA**  
**DEPARTMENT OF TRANSPORTATION**  
**AND PUBLIC FACILITIES**  
**CENTRAL REGION**

**FALSE PASS AIRPORT**  
 FALSE PASS, ALASKA  
 AIRPORT LAYOUT PLAN

EXISTING LAYOUT

DATE: 1/29/2013	SHEET: 2 OF 9
-----------------	---------------

Date Plotted: 1/30/2013 9:47 AM  
 Layout Name: Ultimate Layout  
 File Name: W:\Projects\False Pass\2012 ALP\Final Drawings\ALP-KFP.dwg  
 Designed By: BT  
 Drawn By: BAR  
 Checked By: ACH

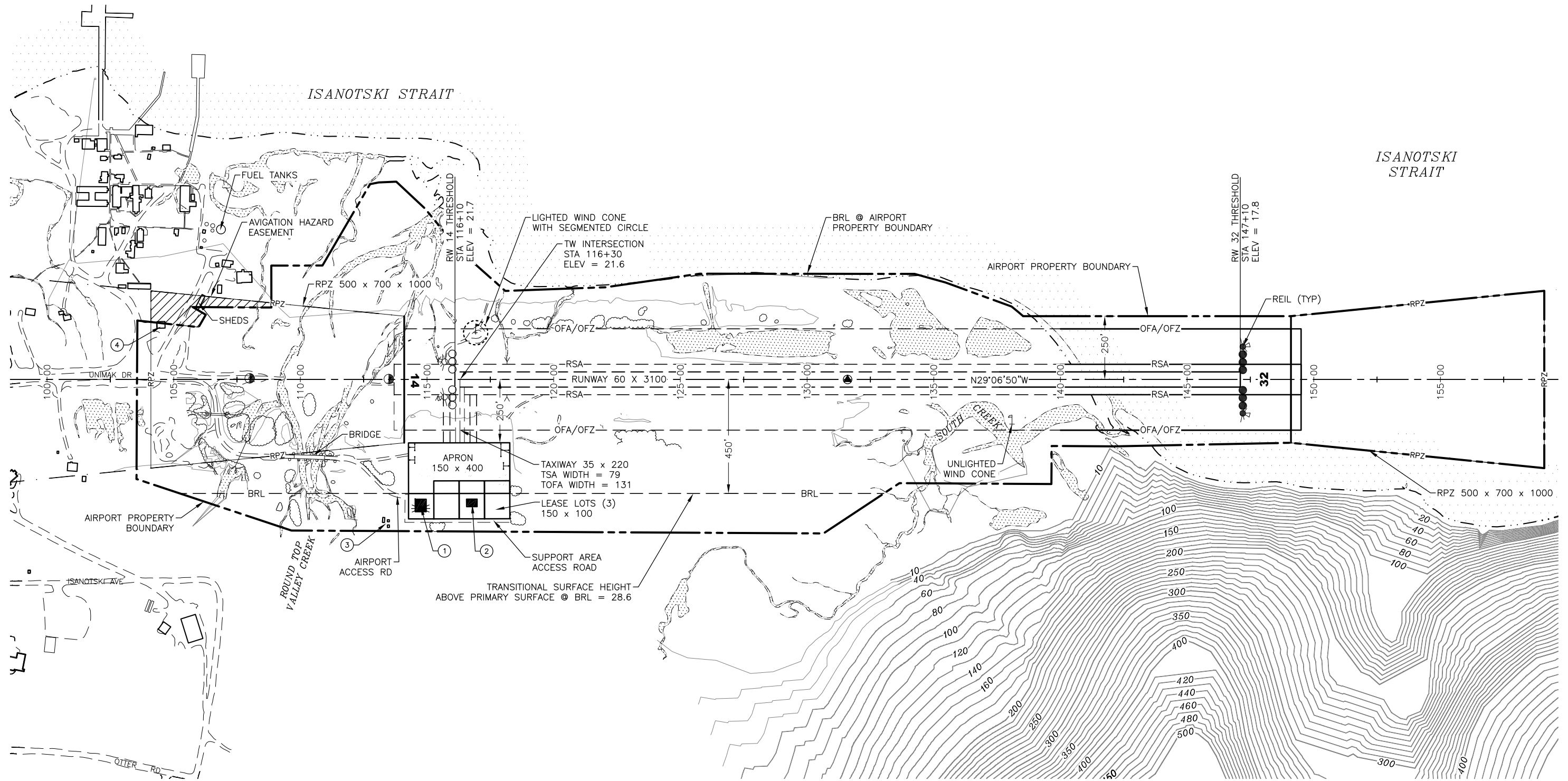

BUILDING DATA TABLE				
ID #	DESCRIPTION	STATION/OFFSET	TOP ELEV (MSL)	OBSTRUCT MARKING
①	SRE BUILDING WITH ROTATING BEACON	114+75/472' RT	60.8*	NONE
②	HANGAR	TBD	42.7*	NONE
③	AWOS	112+86/478' RT	61.1	NONE
④	SHED	104+50/215' LT	UNKNOWN	NONE

\* ESTIMATED ELEVATION

NOTES:  
 1. NO ROFZ OBJECT PENETRATIONS.

BY	DATE	REVISION

**STATE OF ALASKA**  
**DEPARTMENT OF TRANSPORTATION**  
**AND PUBLIC FACILITIES**  
**CENTRAL REGION**

**FALSE PASS AIRPORT**  
 FALSE PASS, ALASKA  
 AIRPORT LAYOUT PLAN  
 ULTIMATE LAYOUT

DATE: 1/29/2013  
 SHEET: 3 OF 9

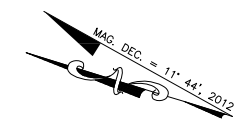

Date Plotted: 1/30/2013 9:48 AM  
 Designated By: BT  
 Drawn By: RAR  
 Layout Name: False Pass - RW 14  
 Checked By: ACH  
 File Name: W:\Projects\False Pass\ALP\Final Drawings\ALP-RFP.dwg

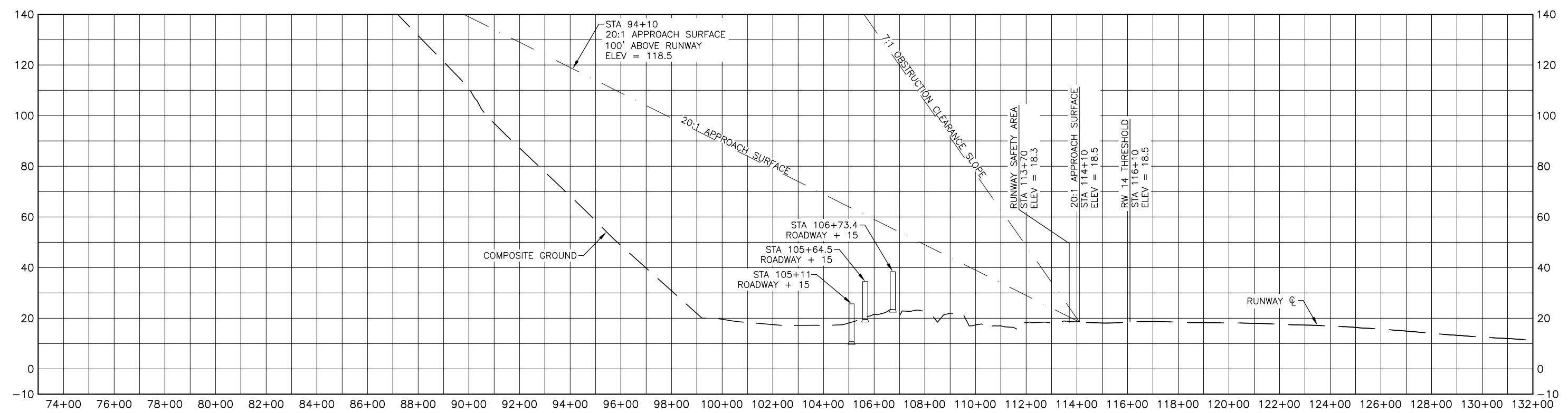
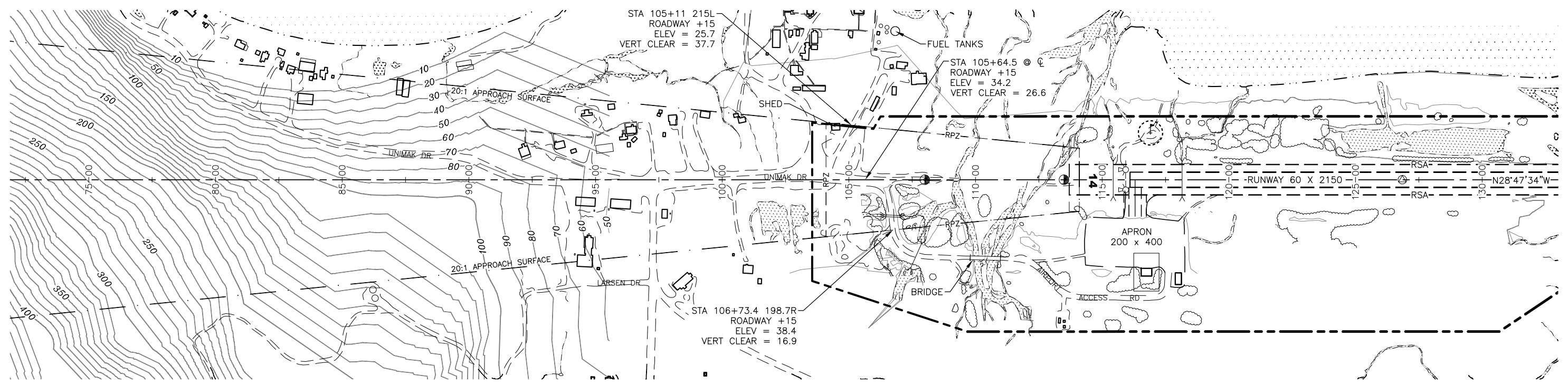

**PART 77 SURFACE OBSTRUCTIONS TABLE (INNER PORTION RW 14)**

ID #	DESCRIPTION	STATION/OFFSET	ELEVATION	SURFACE PENETRATED	SURFACE ELEVATION	AMOUNT PENETRATION	DISPOSITION	STAGE TO CORRECT
①	NONE							

- NOTES:
- THE CONTROLLING OBSTRUCTION FOR THE APPROACH TO RUNWAY 14 IS TERRAIN AT STA 65+50 611R, ELEVATION 700'. THE OBSTRUCTION CLEARANCE SLOPE IS 7:1.
  - THERE ARE NO OBJECT PENETRATIONS IN THE RUNWAY APPROACH END SITING SURFACE OF RUNWAY 14, AS DEFINED IN FAA AC 150/5300-13A, TABLE 3-2, ROW 2.

- NOTE:
- REFER TO THE AIRPORT AIRSPACE DRAWING FOR PENETRATIONS OF THE OUTER APPROACH SURFACE.

BY	DATE	REVISION

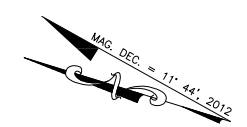

200 100 0' 200 400  
 HORIZONTAL TO VERTICAL RATIO 1:10

**STATE OF ALASKA**  
**DEPARTMENT OF TRANSPORTATION**  
**AND PUBLIC FACILITIES**  
**CENTRAL REGION**

**FALSE PASS AIRPORT**  
 FALSE PASS, ALASKA  
 AIRPORT LAYOUT PLAN

EXISTING INNER PORTION OF  
 THE APPROACH - RUNWAY 14

DATE: 1/29/2013  
 SHEET: 4 OF 9

Date Plotted: 1/30/2013 9:49 AM  
 Design By: BT  
 Drawn By: RAR  
 Layout Name: False Pass RW 32  
 File Name: W:\Projects\False Pass\ALP\2012 ALP\Final Drawings\ALP-RFP.dwg  
 Checked By: ACH

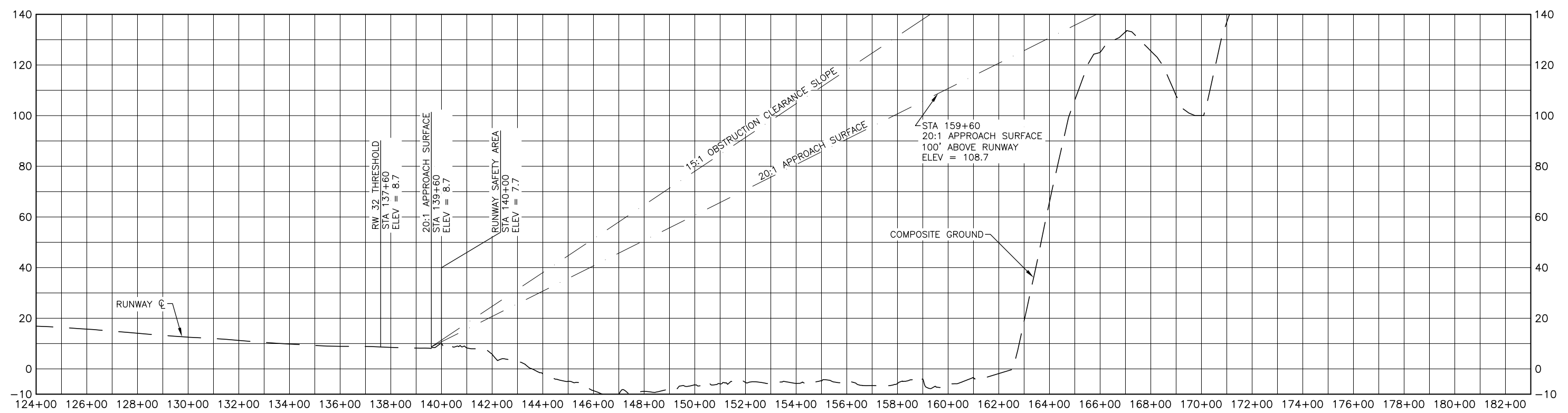
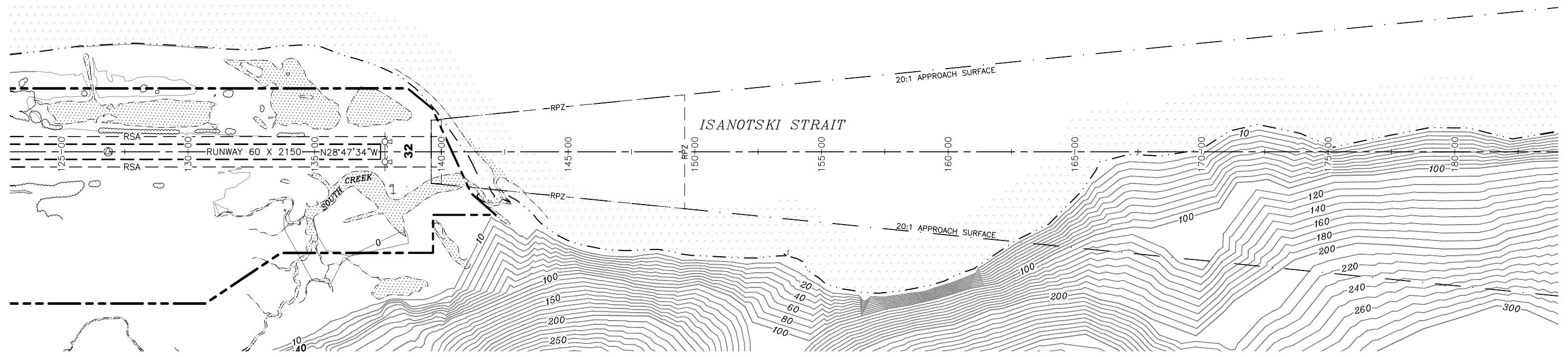

ID #	DESCRIPTION	STATION/OFFSET	ELEVATION	SURFACE PENETRATED	SURFACE ELEVATION	AMOUNT PENETRATION	DISPOSITION	STAGE TO CORRECT
①	NONE							

NOTES:

- THE CONTROLLING OBSTRUCTION FOR THE APPROACH TO RUNWAY 32 IS TERRAIN AT STA 181+56 544R, ELEVATION 272.9'. THE OBSTRUCTION CLEARANCE SLOPE IS 15:1.
- THERE ARE NO OBJECT PENETRATIONS IN THE RUNWAY APPROACH END SITING SURFACE OF RUNWAY 14, AS DEFINED IN FAA AC 150/5300-13A, TABLE 3-2, ROW 2.

NOTE:

- REFER TO THE AIRPORT AIRSPACE DRAWING FOR PENETRATIONS OF THE OUTER APPROACH SURFACE.

BY	DATE	REVISION

200 100 0' 200 400  
 HORIZONTAL TO VERTICAL RATIO 1:10

MAG. DEC. = 11° 44' 2012

**STATE OF ALASKA**  
**DEPARTMENT OF TRANSPORTATION**  
**AND PUBLIC FACILITIES**  
**CENTRAL REGION**

**FALSE PASS AIRPORT**  
 FALSE PASS, ALASKA  
 AIRPORT LAYOUT PLAN

EXISTING INNER PORTION OF  
 THE APPROACH - RUNWAY 32

DATE: 1/29/2013

SHEET: 5 OF 9

Date Plotted: 1/30/2013 9:50 AM  
 User Name: U:\Projects\False Pass\ALP\2012 ALP\Final Drawings\ALP-KFP.dwg  
 File Name:  
 Designed By: BT  
 Drawn By: RAR  
 Checked By: ACH

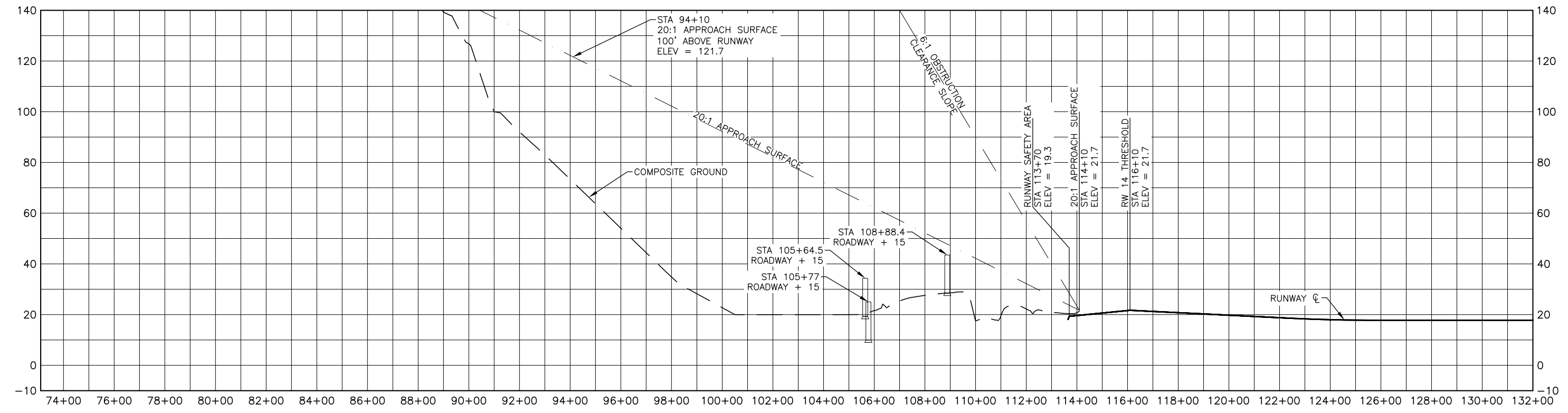
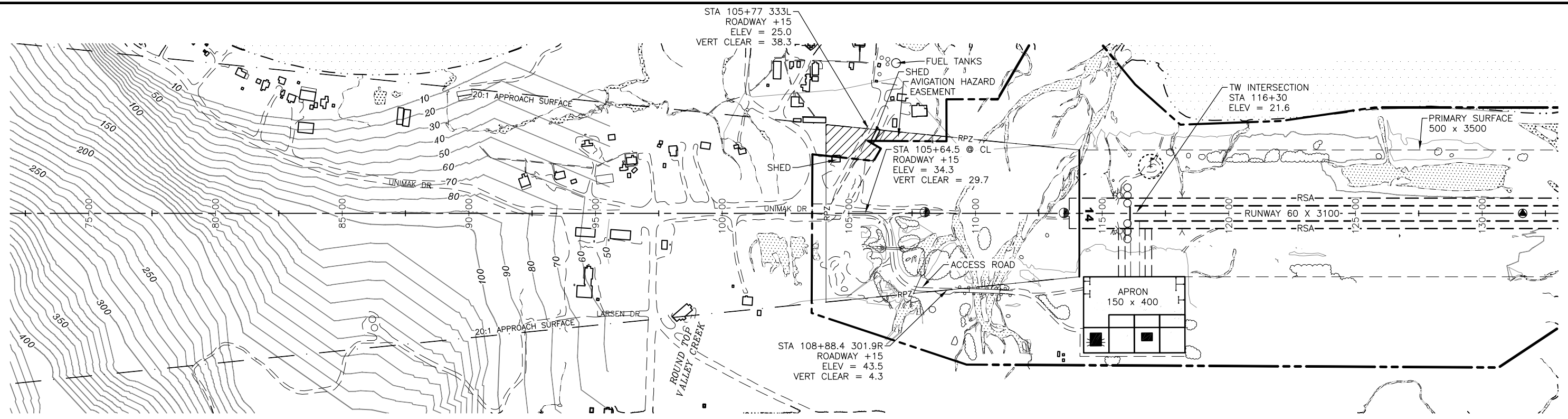

ID #	DESCRIPTION	STATION/OFFSET	ELEVATION	SURFACE PENETRATED	SURFACE ELEVATION	AMOUNT PENETRATION	DISPOSITION	STAGE TO CORRECT
①	NONE							

NOTES:

- THE CONTROLLING OBSTRUCTION FOR THE APPROACH TO RUNWAY 14 IS TERRAIN AT STA 64+10, 750R, ELEVATION 757.8'. THE ULTIMATE OBSTRUCTION CLEARANCE SLOPE IS ESTABLISHED AS 6:1 PER FAA AC 150/5200-35, SECTION 4, DATA ELEMENT NUMBER 57.
- THERE ARE NO OBJECT PENETRATIONS IN THE RUNWAY APPROACH END SITING SURFACE OF RUNWAY 14, AS DEFINED IN FAA AC 150/5300-13A, TABLE 3-2, ROW 2.

NOTE:

- REFER TO THE AIRPORT AIRSPACE DRAWING FOR PENETRATIONS OF THE OUTER APPROACH SURFACE.

BY	DATE	REVISION

200 100 0' 200 400  
 HORIZONTAL TO VERTICAL RATIO 1:10

MAG. DEC. = 11° 44' 2012

STATE OF ALASKA  
 DEPARTMENT OF TRANSPORTATION  
 AND PUBLIC FACILITIES  
 CENTRAL REGION

**FALSE PASS AIRPORT**  
 FALSE PASS, ALASKA  
 AIRPORT LAYOUT PLAN

ULTIMATE INNER PORTION OF  
 THE APPROACH - RUNWAY 14

DATE: 1/29/2013	SHEET: 6 OF 9
-----------------	---------------

Date Plotted: 1/30/2013 9:51 AM  
 User: W:\Projects\False Pass\ALP\2012 ALP\Final Drawings\ALP-KFP.dwg  
 File Name: W:\Projects\False Pass\ALP\2012 ALP\Final Drawings\ALP-KFP.dwg  
 Designated By: BT  
 Drawn By: RAR  
 Checked By: ACH

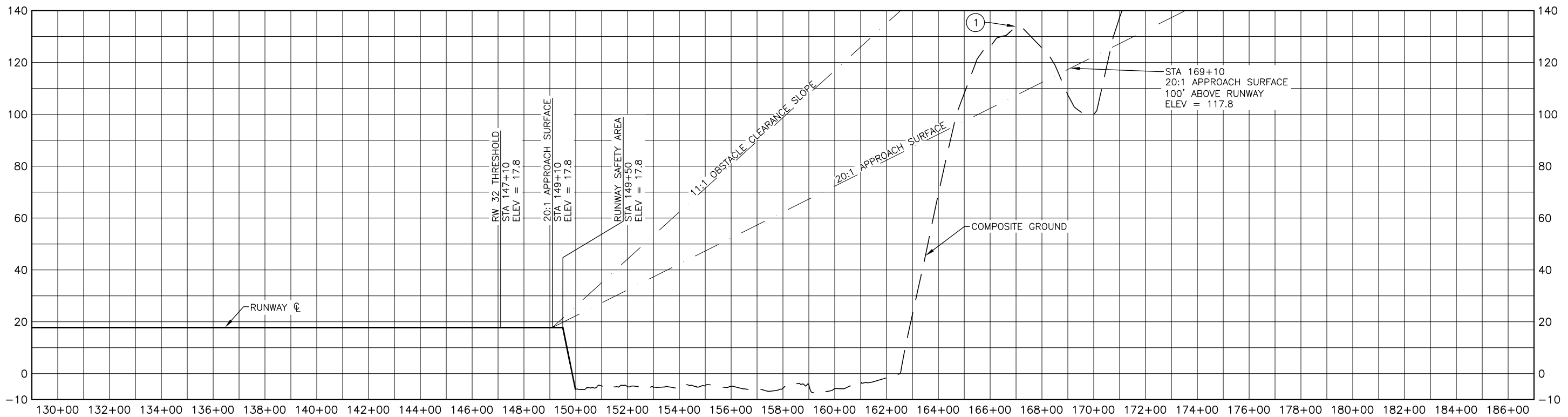
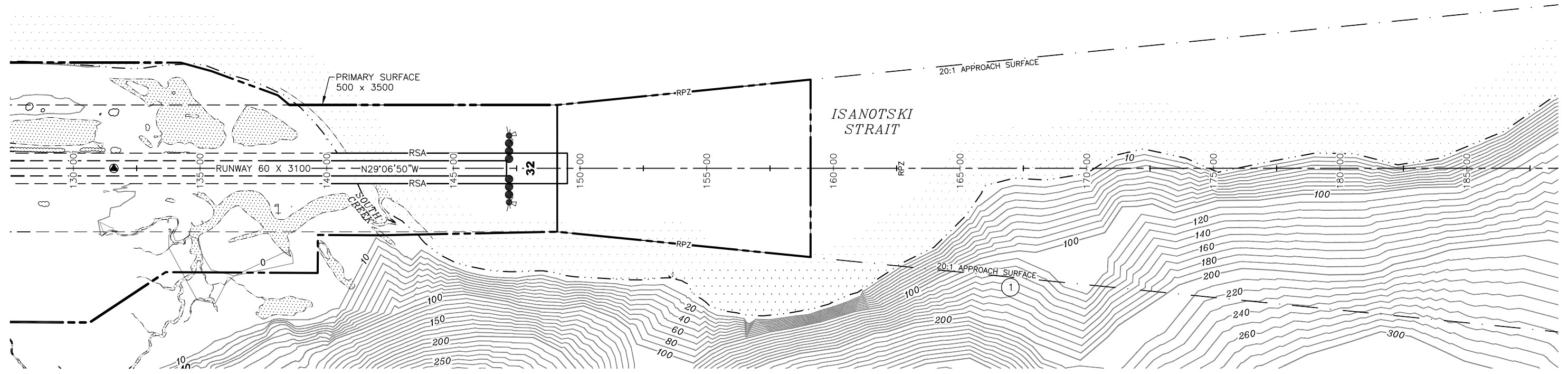

ID #	DESCRIPTION	STATION/OFFSET	ELEVATION	SURFACE PENETRATED	SURFACE ELEVATION	AMOUNT PENETRATION	DISPOSITION	STAGE TO CORRECT
①	TERRAIN	167+00/469R	133.9	APPROACH	107.3	26.6	TO REMAIN	N/A

NOTES:

- THE CONTROLLING OBSTRUCTION FOR THE EXISTING APPROACH TO RUNWAY 32 IS TERRAIN AT STA 175+25, 511.5R, ELEVATION 222.2'. THE ULTIMATE OBSTRUCTION CLEARANCE SLOPE IS ESTABLISHED AS 11:1 PER FAA AC 150/5200-35, SECTION 4, DATA ELEMENT NUMBER 57.
- THERE ARE NO OBJECT PENETRATIONS IN THE ULTIMATE RUNWAY APPROACH END SITING SURFACE OF RUNWAY 32, AS DEFINED IN FAA AC 150/5300-13A, TABLE 3-2, ROW 2.

NOTE:

- REFER TO THE AIRPORT AIRSPACE DRAWING FOR PENETRATIONS OF THE OUTER APPROACH SURFACE.

BY	DATE	REVISION

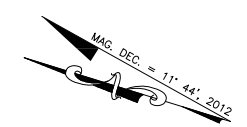

200 100 0' 200 400  
 HORIZONTAL TO VERTICAL RATIO 1:10

**STATE OF ALASKA**  
**DEPARTMENT OF TRANSPORTATION**  
**AND PUBLIC FACILITIES**  
**CENTRAL REGION**

**FALSE PASS AIRPORT**  
 FALSE PASS, ALASKA  
 AIRPORT LAYOUT PLAN

ULTIMATE INNER PORTION OF  
 THE APPROACH - RUNWAY 32

DATE:  
 1/29/2013  
 SHEET:  
 7 OF 9

PART 77 SURFACE OBSTRUCTIONS TABLE (OUTER PORTION RW 14/32)								
ID #	DESCRIPTION	STATION/OFFSET	ELEVATION	SURFACE PENETRATED	SURFACE ELEVATION	AMOUNT PENETRATION	DISPOSITION	STAGE TO CORRECT
2	HIGHEST TERRAIN POINT*	55+85/ 1794 RT	1300	APPROACH/HORIZONTAL/CONICAL	226.4	1073.6	TO REMAIN	N/A
3	HIGHEST TERRAIN POINT*	49+96/ 6302 RT	1480	CONICAL	371.3	1108.7	TO REMAIN	N/A
4	HIGHEST TERRAIN POINT*	149+21/ 8996 LT	1380	CONICAL	371.5	1008.5	TO REMAIN	N/A
5	HIGHEST TERRAIN POINT*	147+15/ 7117 RT	1300	HORIZONTAL/CONICAL/TRANSITIONAL	277.5	1022.5	TO REMAIN	N/A
6	HIGHEST TERRAIN POINT*	182+40/ 583 RT	275.1	APPROACH	184.3	90.8	TO REMAIN	N/A
7	HIGHEST TERRAIN POINT*	226+45/ 1127 RT	500	CONICAL	312.5	187.5	TO REMAIN	N/A

\* HIGHEST FEATURE IN A LARGE AREA OF TERRAIN PENETRATION. REFER TO HATCHED AREAS ON MAP.

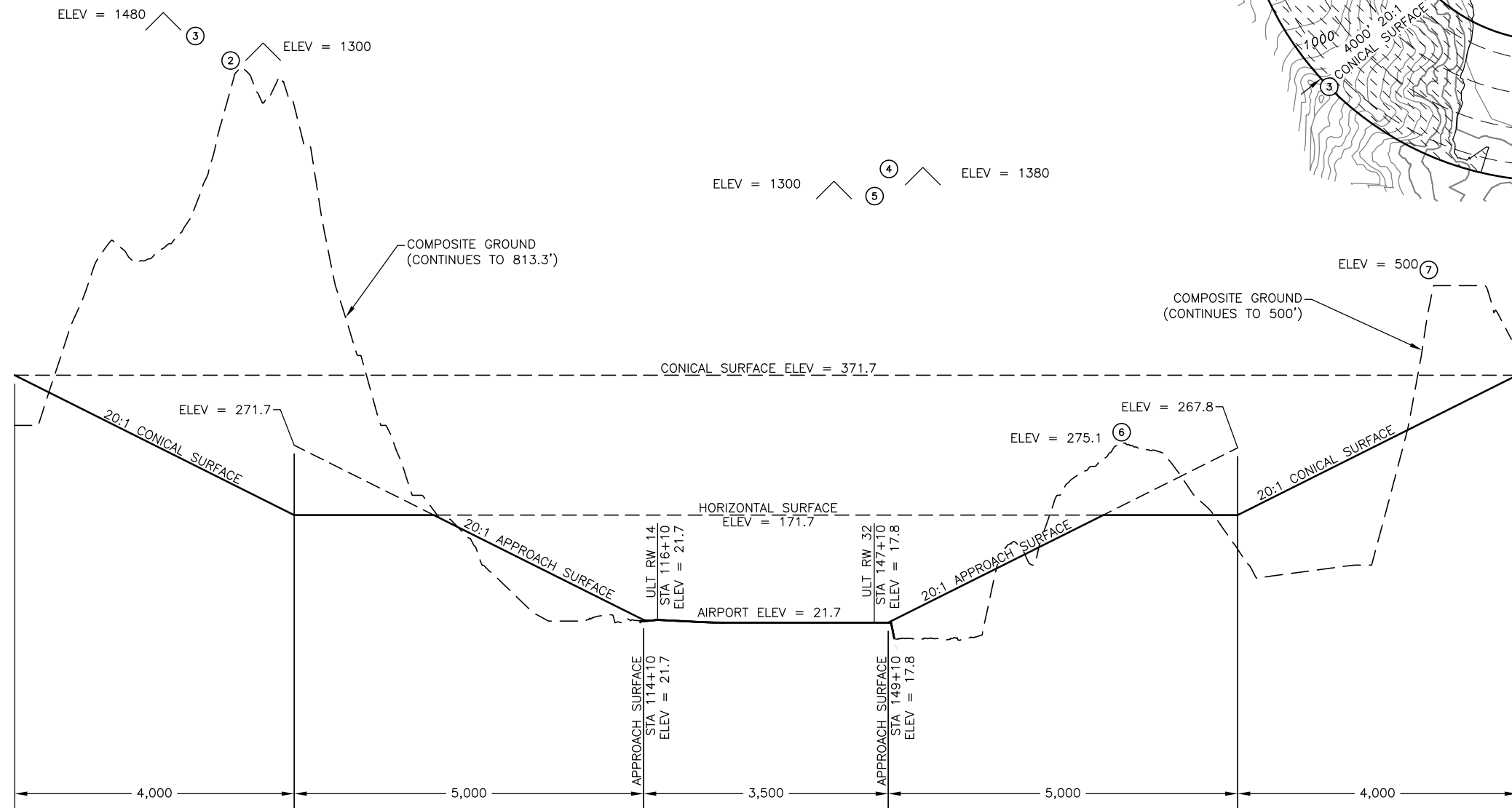
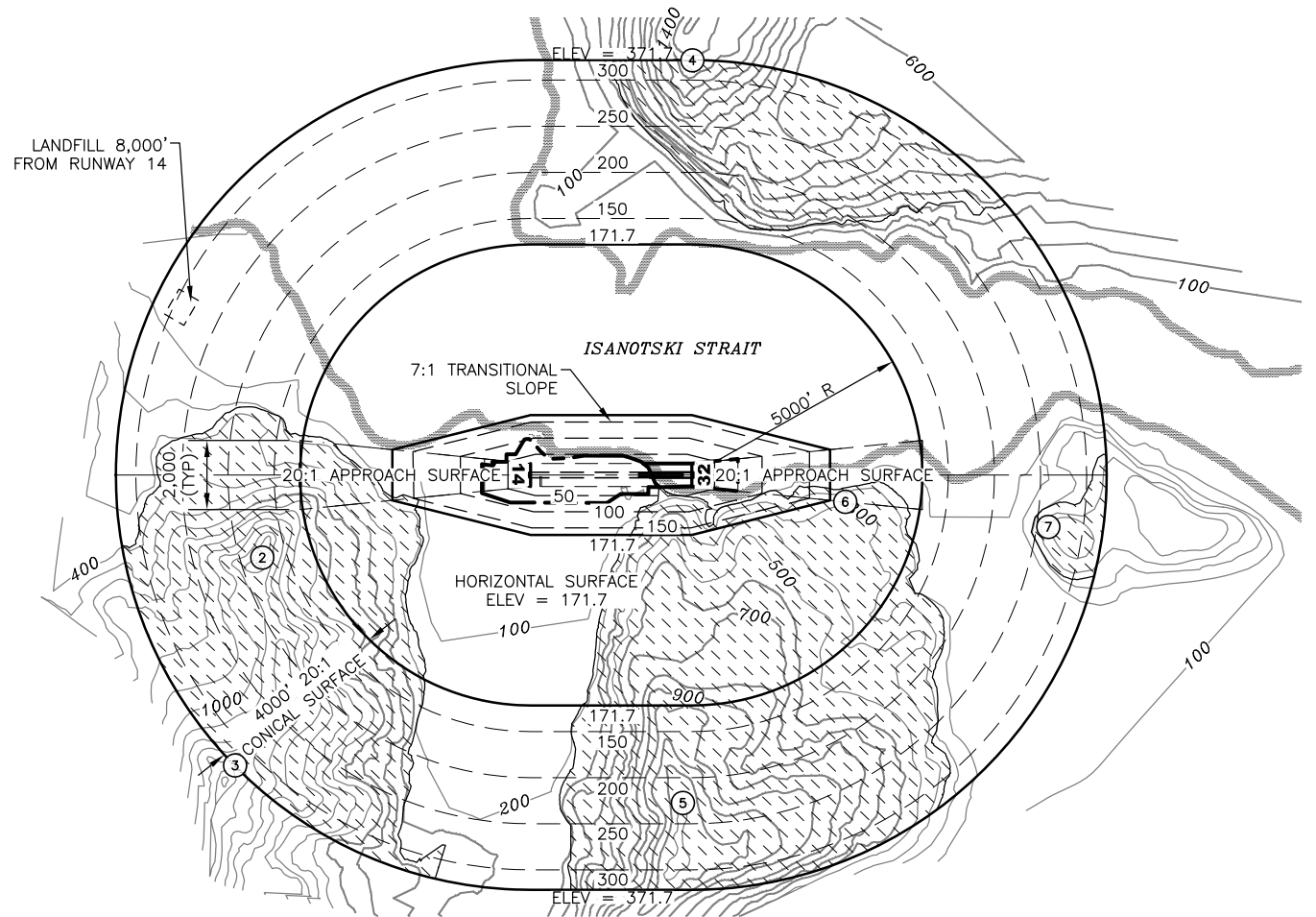
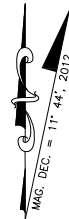

**RUNWAY PROFILE**



**NOTES:**

- AIRPORT ELEVATION IS 21.7'.
- APPROACH SURFACES ARE 20:1 BEGINNING AT 200' FROM THE THRESHOLDS.
- BASEMAP DATA FROM USGS QUAD FALSE PASS (D-5). TOPO CONTOURS SHOWN IN FEET.
- WIDTH OF PRIMARY SURFACE IS 500'.
- REFER TO THE INNER PORTION OF THE APPROACH SURFACE DRAWINGS FOR CLOSE IN OBSTRUCTIONS.
- THERE ARE NO KNOWN HEIGHT RESTRICTIONS.
- PART 77 SURFACES BASED ON ULTIMATE AIRPORT LAYOUT.

**LEGEND**

- FAR PART 77 SURFACE PENETRATIONS

**STATE OF ALASKA  
DEPARTMENT OF TRANSPORTATION  
AND PUBLIC FACILITIES  
CENTRAL REGION**

**FALSE PASS AIRPORT**  
FALSE PASS, ALASKA  
AIRPORT LAYOUT PLAN  
  
AIRPORT AIRSPACE, 14 CFR  
PART 77

DATE:  
1/29/2013  
SHEET:  
8  
OF  
9

BY	DATE	REVISION

Date Plotted: 1/30/2013, 9:51 AM  
 Layout Name: Part 77  
 File Name: W:\Projects\False Pass\ALP\2012 ALP\Final Drawings\ALP-KFP.dwg

Designed By: BT  
 Drawn By: BAR  
 Checked By: ACH



Date Plotted: 1/30/2013 9:52 AM  
 Layout Name: False Pass Airport Map  
 File Name: W:\Projects\False Pass\ALP\2012 ALP\Final Drawings\ALP-KFP.dwg  
 Designed By: BT  
 Drawn By: RAR  
 Checked By: ACH

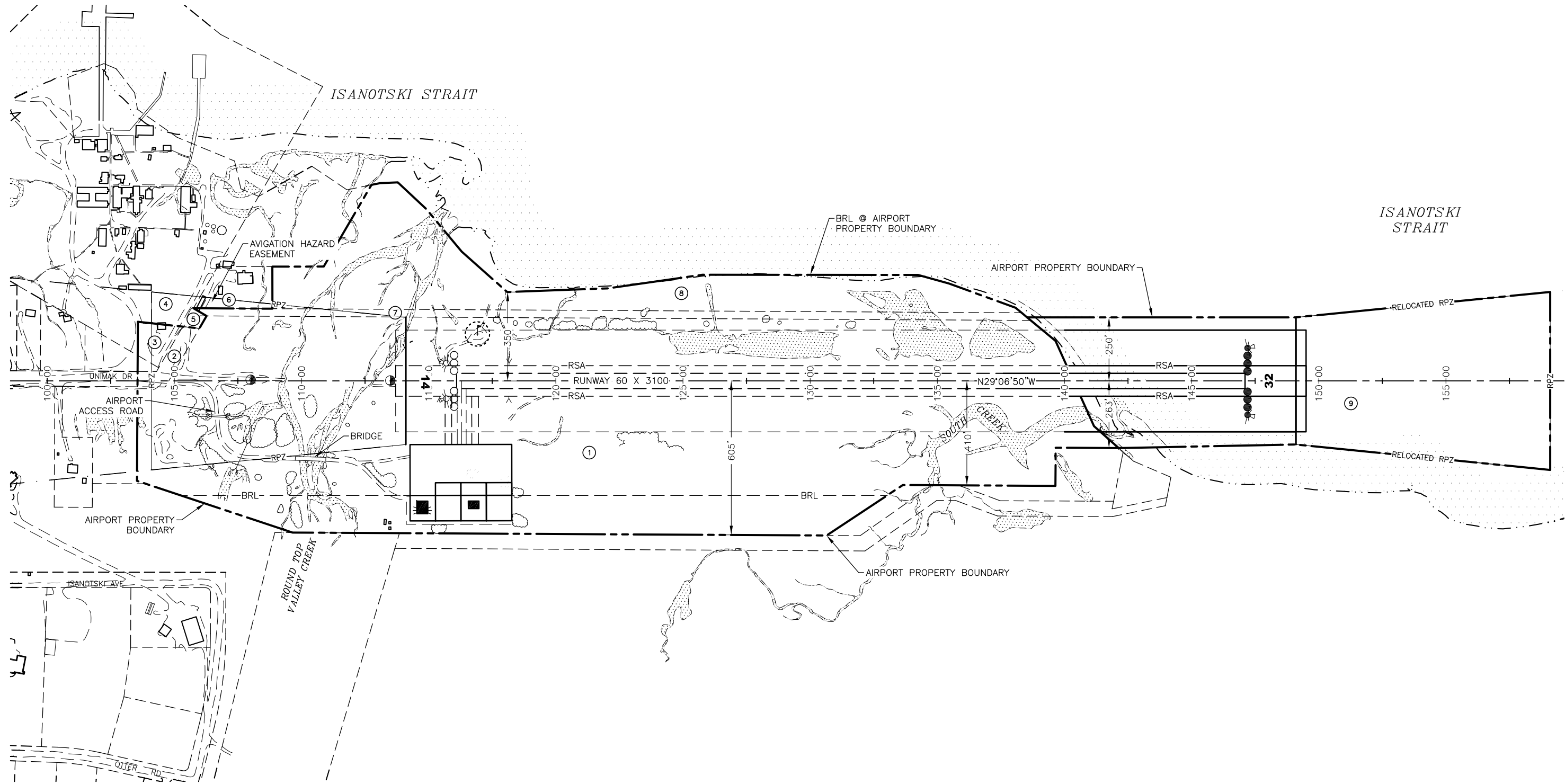

PROPERTY STATUS							
ID #	INTEREST	GRANTOR	GRANTEE	PARCEL SIZE	DATE ACQUIRED	RECORDED DOC NO.	ACQUIRED AIP NO.
1	DEED TO SURFACE ESTATE TO BE ACQUIRED UNDER SEC. 14(c)(4) OF THE ALASKA NATIVE CLAIMS SETTLEMENT ACT.	ISANOTSKI CORP.	STATE OF ALASKA, DOT/PF	65.45± ac	3/28/88	BK 27 PG 0774	3-02-0097-01
2	AVIGATION HAZARD EASEMENT	STATE OF ALASKA, DEPT. OF COMMUNITY & REGIONAL AFFAIRS	STATE OF ALASKA, DOT/PF	0.52± ac	4/28/1988	BK 74 PG 0858	3-02-0097-01
3	AVIGATION HAZARD EASEMENT	PETER PAN SEAFOODS, INC.	STATE OF ALASKA, DOT/PF	0.47± ac	5/2/1988	BK 27 PG 0903	3-02-0097-01
4	AVIGATION HAZARD EASEMENT	CITY OF FALSE PASS	STATE OF ALASKA, DOT/PF	0.45± ac	TO BE ACQUIRED		
5	AVIGATION HAZARD EASEMENT	STATE OF ALASKA, DEPT. OF COMMUNITY & REGIONAL AFFAIRS	STATE OF ALASKA, DOT/PF	0.10± ac	TO BE ACQUIRED		
6	AVIGATION HAZARD EASEMENT	SIRI E. GOULETTE	STATE OF ALASKA, DOT/PF	0.22 ac	TO BE ACQUIRED		
7	FEE - SURFACE ESTATE	CITY OF FALSE PASS	STATE OF ALASKA, DOT/PF	2.24 ac	TO BE ACQUIRED		
8	FEE - SURFACE ESTATE	ISANOTSKI CORP.	STATE OF ALASKA, DOT/PF	11.40 ac	TO BE ACQUIRED		
9	ILMA	STATE OF ALASKA	STATE OF ALASKA, DOT/PF	23.95 ac	TO BE ACQUIRED		

MAG. DEC. = 11° 44' 2012

200 100 0' 200 400

**STATE OF ALASKA**  
**DEPARTMENT OF TRANSPORTATION**  
**AND PUBLIC FACILITIES**  
**CENTRAL REGION**

**FALSE PASS AIRPORT**  
 FALSE PASS, ALASKA  
 AIRPORT LAYOUT PLAN  
 PROPERTY MAP

BY	DATE	REVISION

DATE: 1/29/2013  
 SHEET: 9 OF 9