

LOCATION MAP
NO SCALE

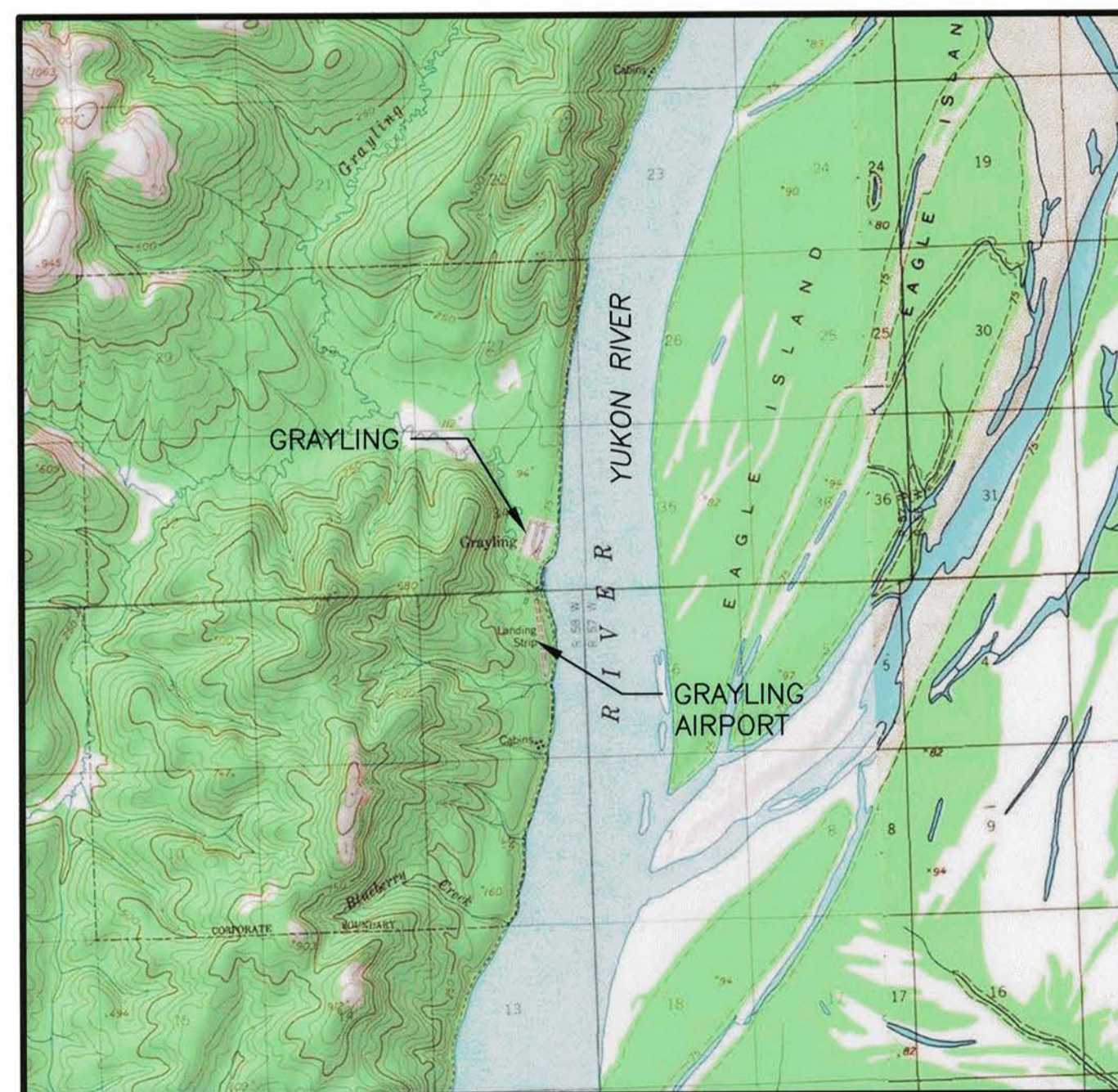

VICINITY MAP
T32N, R57W & R32W, SEC. 1
USGS HOLY CROSS D-3 QUAD
1" = 1 MILE

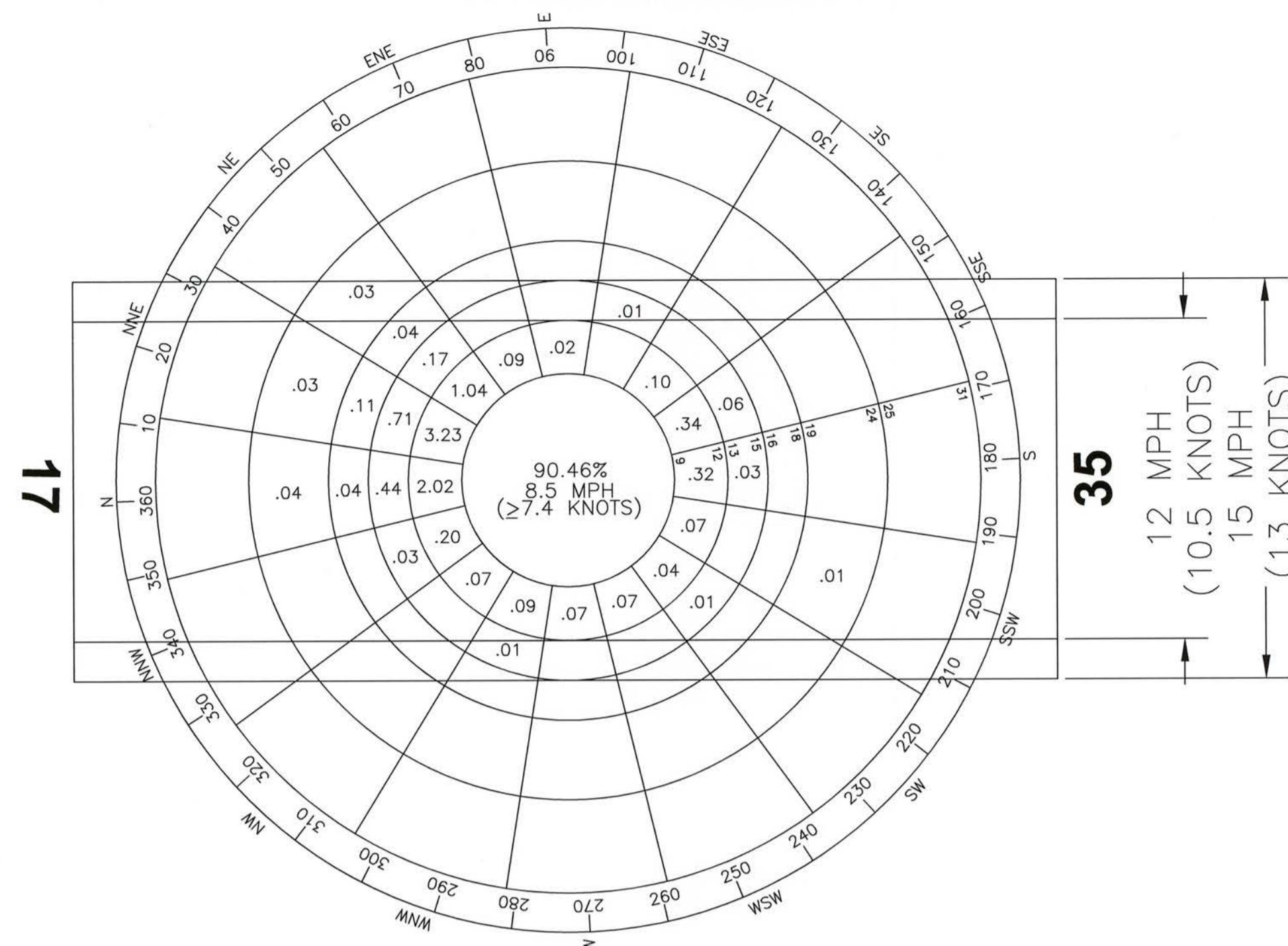

WIND ROSE

WIND DATA		
RUNWAY	12 MPH (10.5 KNOT)	15 MPH (13 KNOT)
17-35	99.93%	99.99%

SOURCE: UNIVERSITY OF ALASKA FAIRBANKS, WATER AND ENVIRONMENTAL RESEARCH CENTER
PERIOD: NOV 20, 1999 - NOV 9, 2000

AIRPORT DATA		
ITEM	EXISTING	ULTIMATE
ICAO IDENTIFIER		N/A
NATIONAL AIRPORT IDENTIFIER		KGX
FAA SITE NUMBER		50280.69*A
AIRPORT ELEVATION NAVD88		137.5'
AIRPORT REFERENCE CODE		B-II
MEAN MAX. TEMPERATURE, HOTTEST MONTH *		66.7°F IN JULY
AIRPORT AND TERMINAL NAVIGATION AIDS	ROTATING BEACON	BEACON, GPS
TAXIWAY LIGHTING/MARKING		MITL
RAMP LIGHTING		NONE
OBSTRUCTION SURVEY SOURCE & TYPE	R&M CONSULTANTS, INC. 2010/ VERTICALLY GUIDED AIRPORT AIRSPACE ANALYSIS SURVEY	
MAGNETIC DECLINATION, YEAR, RATE OF CHANGE **	15°04'E, JANUARY 2010 0°16'W/YEAR	
DATA FROM (*) THE WESTERN REGIONAL CLIMATE CENTER (**) NATIONAL GEOPHYSICAL DATA CENTER		

AIRPORT SURVEY CONTROL			
MONUMENT	LATITUDE	LONGITUDE	ELEVATION
PACS "KGX A"	N 62°53'30.06"	W 160°04'06.19"	141.6'
SACS "KGX B"	N 62°53'53.37"	W 160°04'04.16"	87.4'
SACS "KGX C"	N 62°53'09.70"	W 160°04'07.52"	146.0'

*VALUES OBTAINED FROM NGS DATA SHEET

RUNWAY DATA - RW 17/35		
ITEM	EXISTING	ULTIMATE
APPROACH SLOPE / OCS*	20:1 / 20:1	SAME
VISIBILITY MINIMUM	≥ 1 MILE	SAME
RUNWAY SURFACE	GRAVEL	SAME
PAVEMENT STRENGTH	N/A	N/A
RUNWAY DESIGN CODE (RDC)	B-II-VIS	B-II-4000
RUNWAY REFERENCE CODE (RRC)	B/II/VIS	B/II/4000
RUNWAY DIMENSIONS	4000' X 75'	SAME
MEAN GEODETIC BEARING	S02°33'40"W	SAME
EFFECTIVE GRADE	0.01%	SAME
RUNWAY SAFETY AREA (RSA) DIMENSIONS	4600' X 150'	SAME
LENGTH BEYOND R/W END	300'	SAME
RUNWAY PROTECTION ZONE (RPZ) DIMENSIONS	1700' X 1000' X 1510'	SAME
RUNWAY OBJECT FREE AREA (OFA) DIMENSIONS	4600' X 500'	SAME
LENGTH BEYOND R/W END	300'	SAME
RUNWAY OBSTACLE FREE ZONE (OFZ) DIMENSIONS	4400' X 400'	SAME
RUNWAY LIGHTING TYPE	MIRL	SAME
RUNWAY MARKING TYPE	NONE	NONE
RUNWAY VISUAL APPROACH AIDS	NONE	PAPI, REIL, GPS
TOUCHDOWN ELEVATION NAVD88 RW 17	137.5'	SAME
TOUCHDOWN ELEVATION NAVD88 RW 35	123.3'	SAME

* FROM FAA AC 150/5300-13A

GEOGRAPHIC COORDINATES				
ITEM	EXISTING* LATITUDE	EXISTING* LONGITUDE	ULTIMATE* LATITUDE	ULTIMATE* LONGITUDE
AIRPORT REFERENCE POINT	N62°53'31.51"	W160°03'59.03"	SAME	SAME
THRESHOLD 17	N62°53'51.18"	W160°03'57.10"	SAME	SAME
THRESHOLD 35	N62°53'11.84"	W160°04'00.96"	SAME	SAME

*NAD83

LEGEND		
ITEM	EXISTING	ULTIMATE
AIRPORT REFERENCE POINT		⊙
ANTENNA/TOWER	▲	△
BUILDING	▭	▭
BUILDING RESTRICTION LINE	BRL	BRL
PAPI	****	****
PROPERTY LINE	---	---
REIL	⊠	⊠
ROADWAYS	—	—
ROTATING BEACON	⊙	⊙
SURVEY MONUMENT	⊙	⊙
THRESHOLD LIGHTS	⊙	⊙
TOPOGRAPHIC CONTOURS	100'	100'
WINDCONE WITH SEGMENTED CIRCLE	⊙	⊙
OPEN WATER	▨	▨

SHEET INDEX	
TITLE	NO.
AIRPORT DATA SHEET	1
AIRPORT LAYOUT DRAWING	2
INNER PORTION OF THE APPROACH SURFACE	3
TERMINAL AREA PLAN	4
AIRPORT AIRSPACE PLAN	4
AIRPORT AIRSPACE PROFILE	5

Plotted 4/8/2015 9:52 AM by Matt Majoras
Z:\project\1605.08_DOT_N_Aeronautical_2009_Grayling_Airport\Civil\ACAD\1605.08-TITLE.dwg

DESIGN NBS/MIM	BY DATE REVISIONS
	MIM 4/7/2015 AS-BUILT <i>Rz</i>
DRAWN MIM	
CHECKED EJJ	

STATE OF ALASKA
DEPARTMENT OF TRANSPORTATION AND PUBLIC FACILITIES
NORTHERN REGION

APPROVED
Albert M. L. Beck
ALBERT M. L. BECK, P.E. DATE 4/27/15
AIRPORT DESIGN GROUP CHIEF

AIRPORT LAYOUT PLAN APPROVED
BY LETTER DATED: 5/22/15
AS-BUILT
PJ Jettles
AIRPORTS DIVISION,
ALASKAN REGION, AAL-601
AIRSPACE REVIEW # N/A

PLANS DEVELOPED BY: **R&M CONSULTANTS, INC.**

GRAYLING AIRPORT
AIRPORT LAYOUT PLAN
AIRPORT DATA SHEET

SHEET
1 OF 5

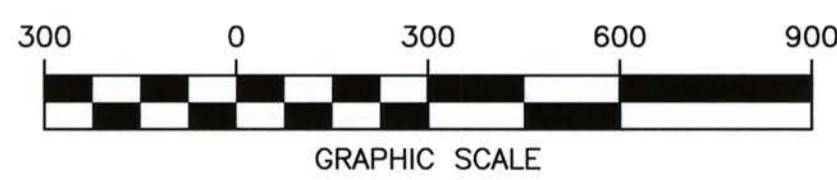
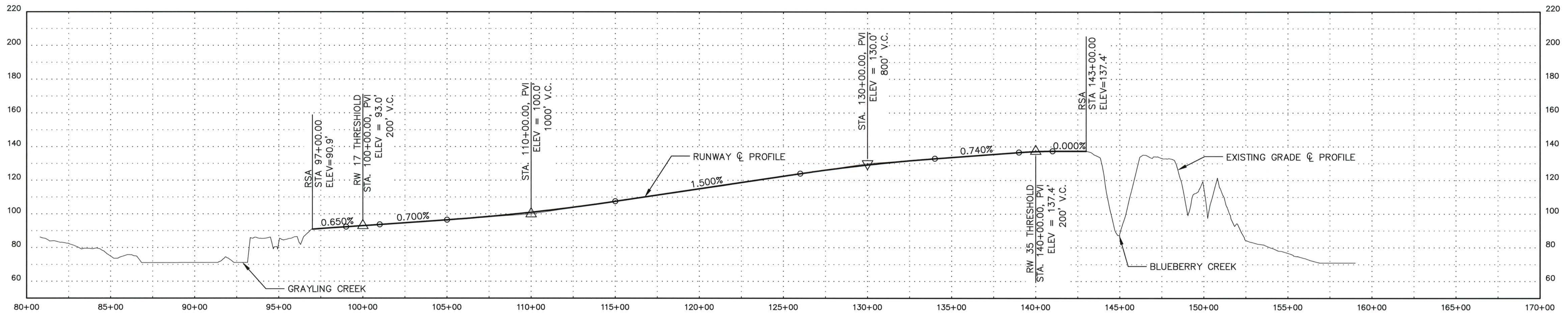
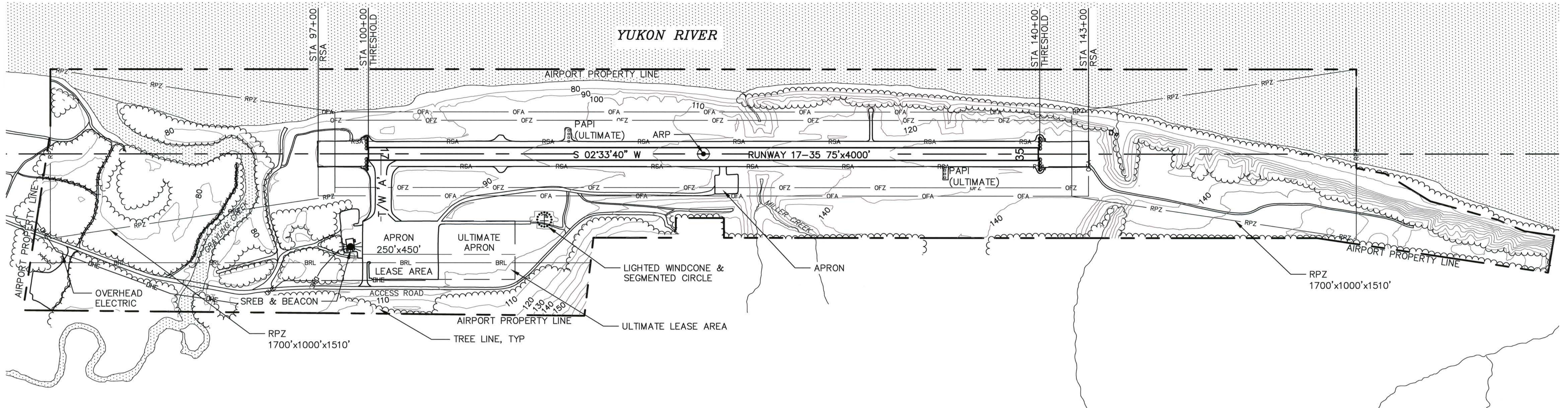

Plotted 4/8/2015 9:52 AM by Matt Majors
Z:\project\1605.08_DOT_N Aeronautical 2009 Grayling Airport\Civil\ACAD\1605.08-LAYOUT.dwg

DESIGN NBS/MIM	BY MIM	DATE 4/7/2015	REVISIONS AS-BUILT
DRAWN MIM			
CHECKED EJG			

STATE OF ALASKA
DEPARTMENT OF TRANSPORTATION AND PUBLIC FACILITIES
NORTHERN REGION

APPROVED: *Albert M. L. Beck* DATE: 4/27/15
ALBERT M. L. BECK, P.E. AIRPORT DESIGN GROUP CHIEF

AIRPORT LAYOUT PLAN APPROVED
BY LETTER DATED: _____

AIRPORTS DIVISION,
ALASKAN REGION, AAL-601
AIRSPACE REVIEW # _____

PLANS DEVELOPED BY: **R&M CONSULTANTS, INC.**

GRAYLING AIRPORT
AIRPORT LAYOUT PLAN
AIRPORT LAYOUT DRAWING

SHEET
2
OF
5

Plotted 4/8/2015 9:53 AM by Matt Majoros
Z:\project\1605.08_DOT_N_Aeronautical_2009_Grayling_Airport\Civil\ACAD\1605.08-TERMINAL.dwg

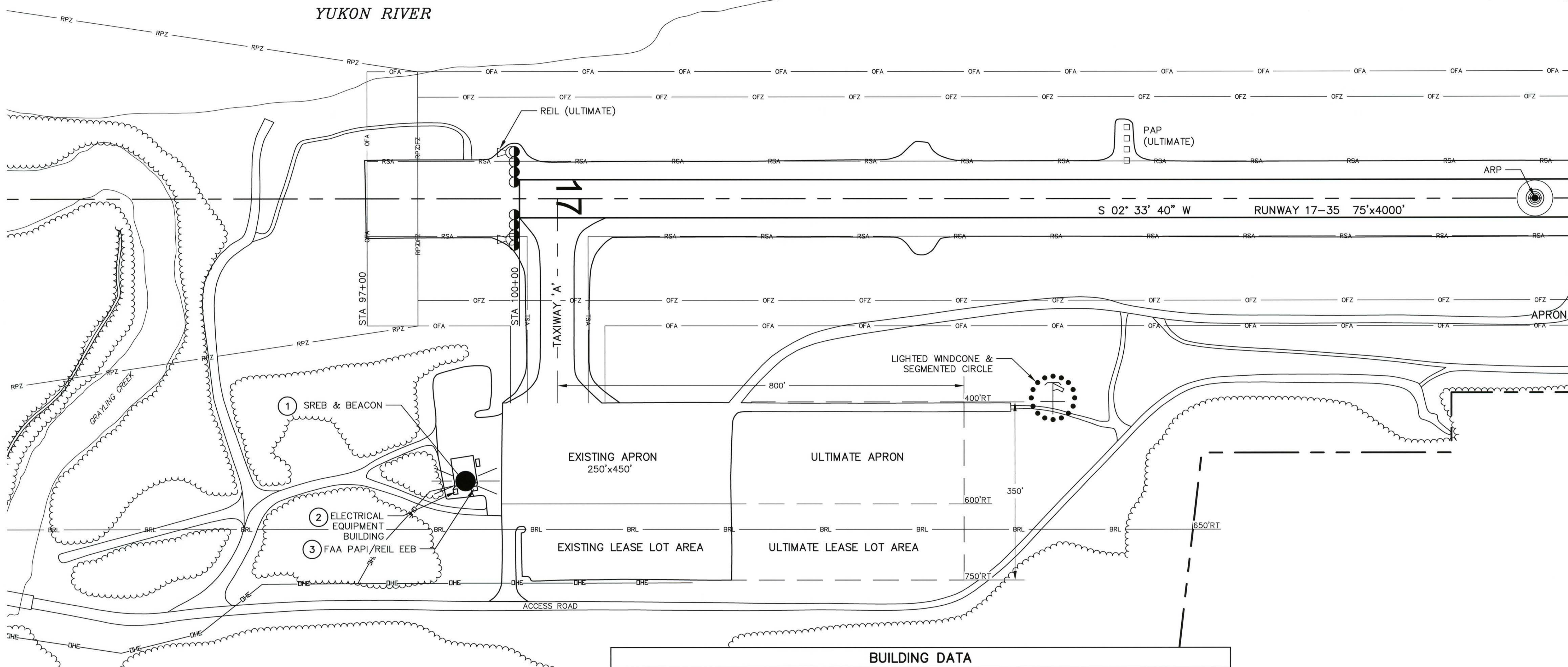

BUILDING DATA						
BUILDING NUMBER	DESCRIPTION	STATION	OFFSET	TOP ELEV	OBSTRUCTION MARKING	REMARKS
1	SREB & ROTATING BEACON	98+94	560'LT	116' (BEACON)	NO	NO OBSTRUCTION
2	ELECTRICAL EQUIPMENT ENCLOSURE	98+74	576'RT	101.4'	NO	NO OBSTRUCTION
3	FAA PAPI/REIL EEB	99+10	570'RT	100.4'	NO	NO OBSTRUCTION

TAXIWAY DATA						
TAXIWAY	LENGTH (FEET)	WIDTH (FEET)	SAFETY AREA WIDTH (FEET)	OBJECT FREE AREA WIDTH (FEET)	AIRPLANE DESIGNATION GROUP	INTERSECTION WITH RUNWAY CENTERLINE
TAXIWAY 'A'	400	65	120	186	II	100+75

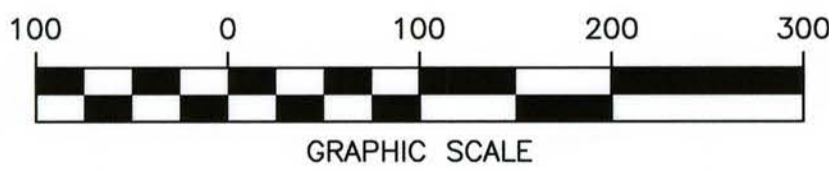

DESIGN	BY	DATE	REVISIONS
NBS/MIM	MIM	4/7/2015	AS-BUILT <i>pe</i>
DRAWN	MIM		
CHECKED	EJG		

STATE OF ALASKA
DEPARTMENT OF TRANSPORTATION AND PUBLIC FACILITIES
NORTHERN REGION

APPROVED
Albert M. L. Beck
ALBERT M. L. BECK, P.E.

DATE *4/27/15*
AIRPORT DESIGN GROUP CHIEF

AIRPORT LAYOUT PLAN APPROVED
BY LETTER DATED: _____

AIRPORTS DIVISION,
ALASKAN REGION, AAL-601
AIRSPACE REVIEW # _____

PLANS DEVELOPED BY: **R&M CONSULTANTS, INC.**

GRAYLING AIRPORT
AIRPORT LAYOUT PLAN
TERMINAL AREA PLAN

SHEET
3
OF
5

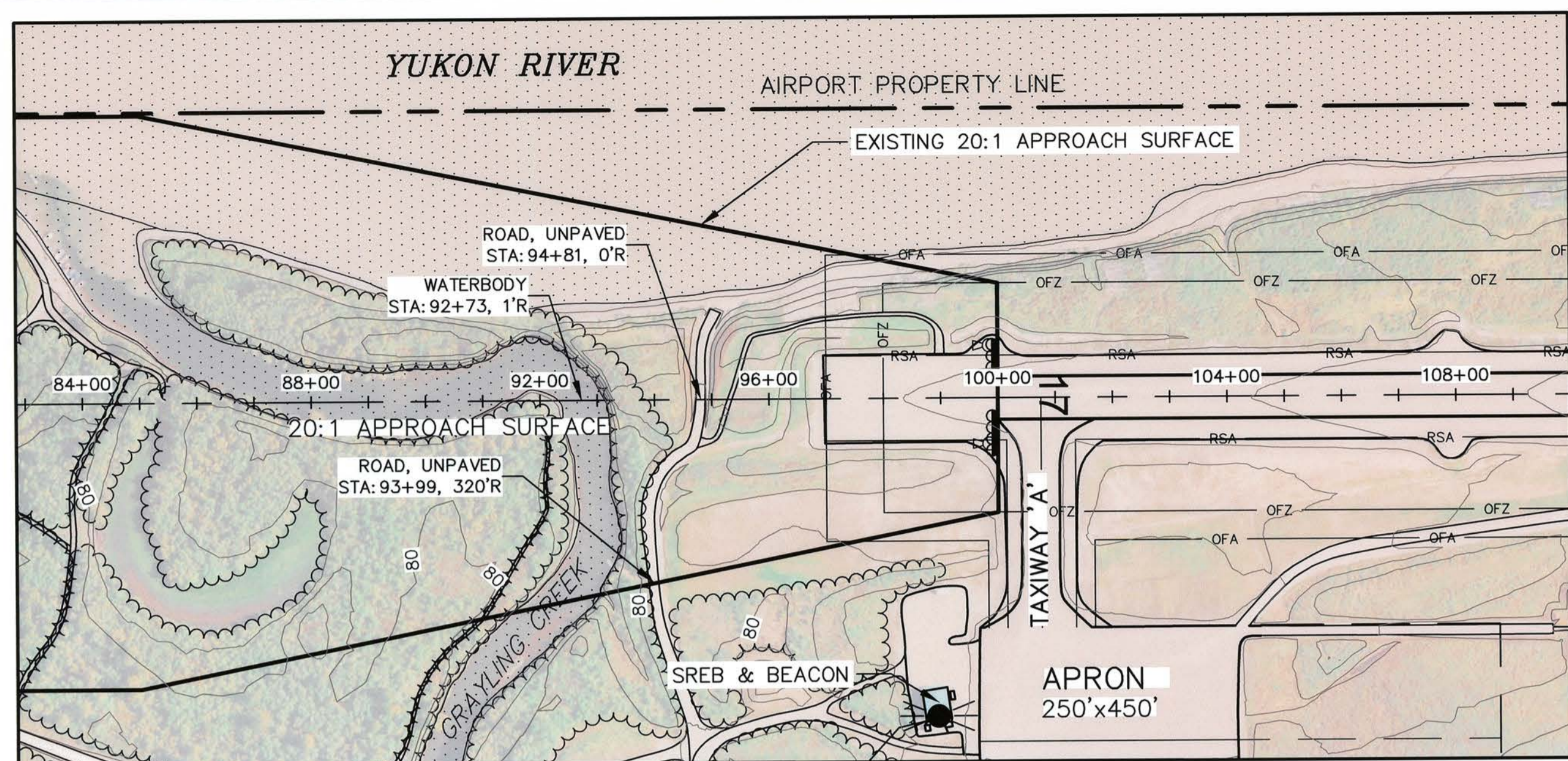

RW 17-35
S02°33'41"W (TRUE)
4000'x75'

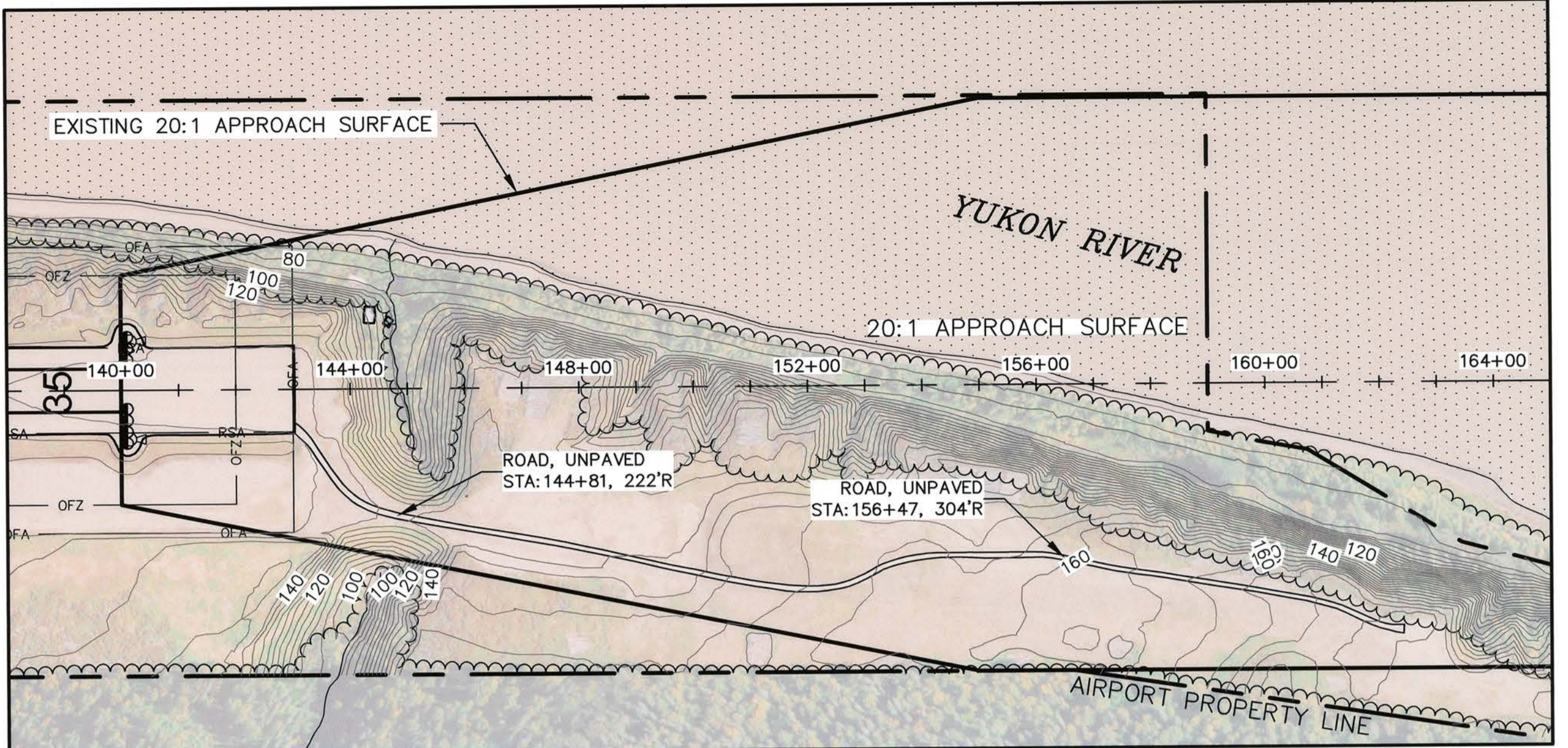

RUNWAY 17

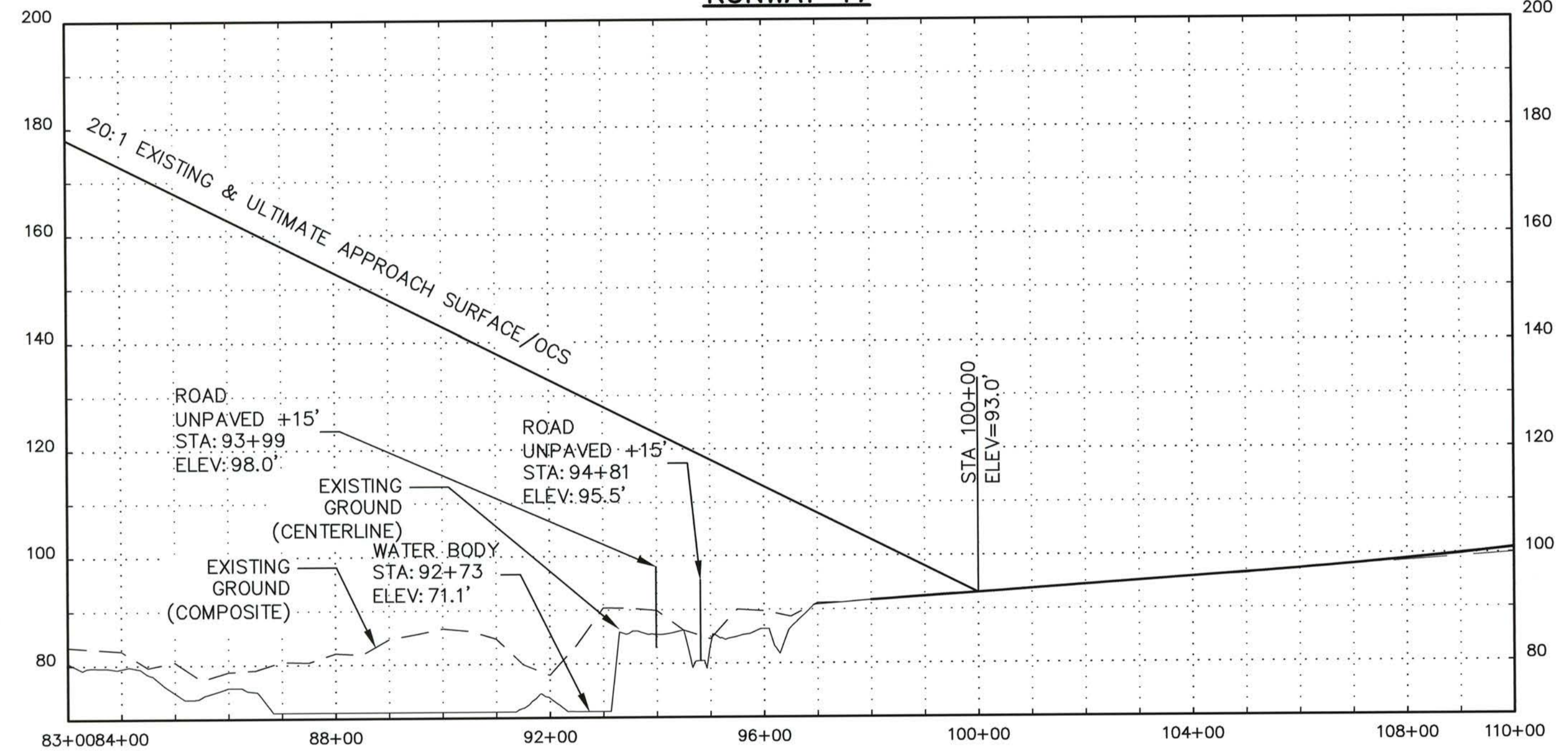

RUNWAY 35

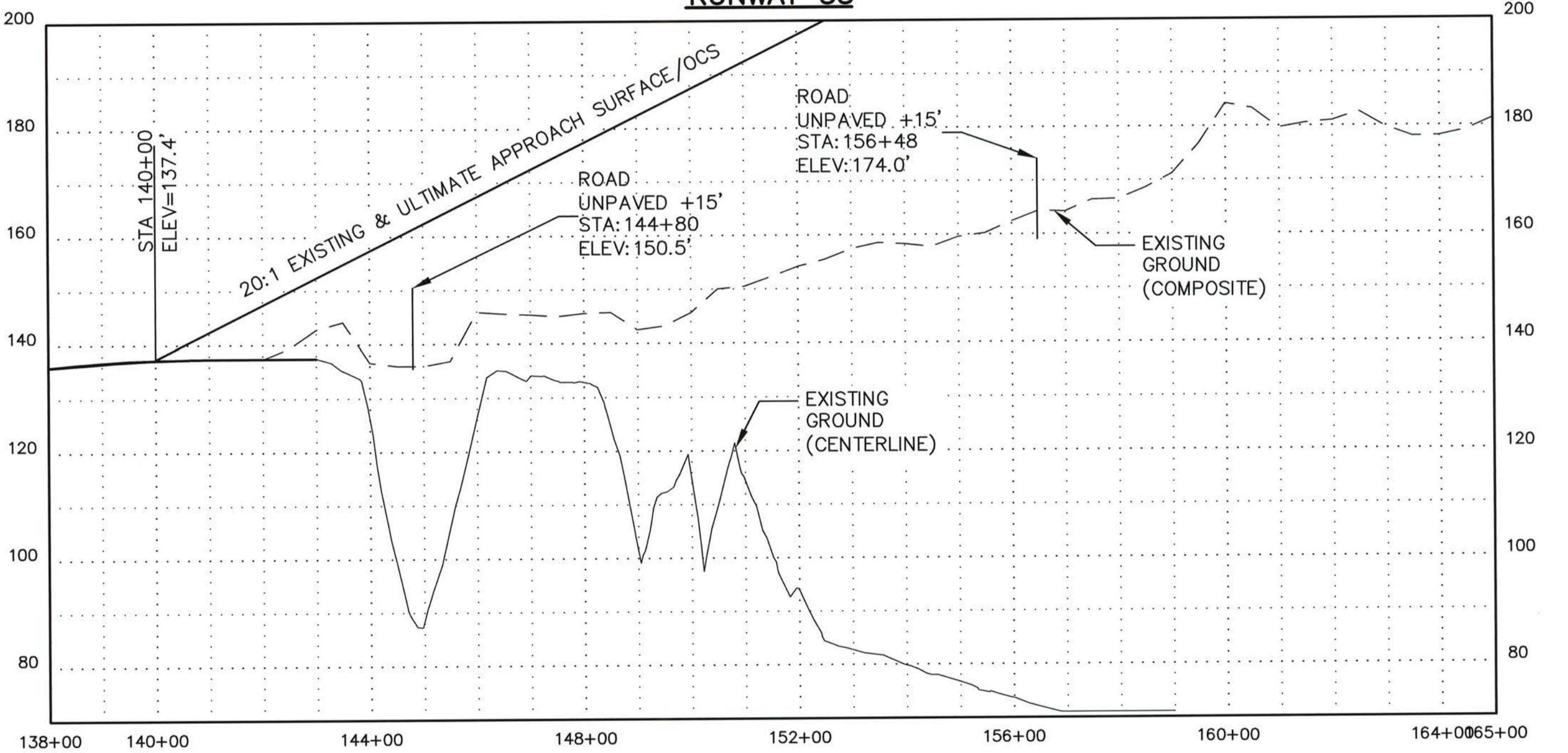

- NOTES:**
1. THE HIGHEST THRESHOLD SITING CRITERIA FOR RW 17-35 IS FOR VISUAL (EXISTING) AND NON-PRECISION (ULTIMATE) APPROACH BY LARGE AIRCRAFT WITH INSTRUMENT MINIMUMS \geq STATUTE MILE WITH A 20:1 OBSTRUCTION CLEARANCE SURFACE. REFERENCE FAA AC 150/5300-13A, TABLE 3-2, ROW 3.
 2. THERE ARE NO THRESHOLD SITING SURFACE OBJECT PENETRATIONS FOR RUNWAY 17 OR RUNWAY 35.

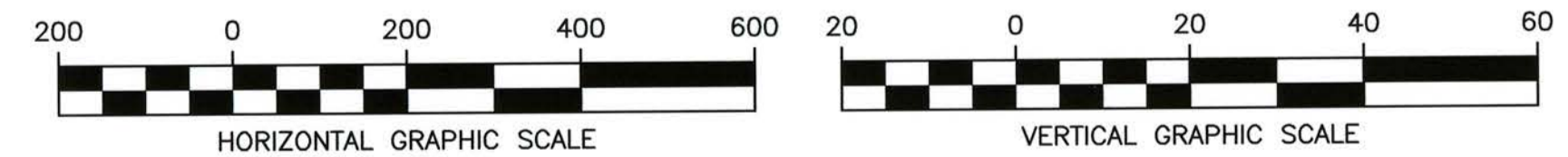

Plotted 4/8/2015 9:54 AM by Matt Majoros Z:\project\1605.08_DOT_N_Aeronautical\2009 Grayling Airport\Civil\ACAD\1605.08-INNER-APPROACH.dwg

DESIGN <u>NBS/MIM</u>	BY	DATE	REVISIONS
DRAWN <u>MIM</u>	MIM	4/7/2015	AS-BUILT <i>MIM</i>
CHECKED <u>EJG</u>			

STATE OF ALASKA
DEPARTMENT OF TRANSPORTATION AND PUBLIC FACILITIES
NORTHERN REGION

APPROVED
Albert M. L. Beck
ALBERT M. L. BECK, P.E.

DATE 4/27/15
AIRPORT DESIGN GROUP CHIEF

AIRPORT LAYOUT PLAN APPROVED
BY LETTER DATED: _____

AIRPORTS DIVISION,
ALASKAN REGION, AAL-601
AIRSPACE REVIEW #

PLANS DEVELOPED BY: **R&M CONSULTANTS, INC.**

GRAYLING AIRPORT
AIRPORT LAYOUT PLAN
INNER PORTION OF THE APPROACH SURFACE

SHEET
4
OF
5

MAG DEC 1504E JANUARY 2010

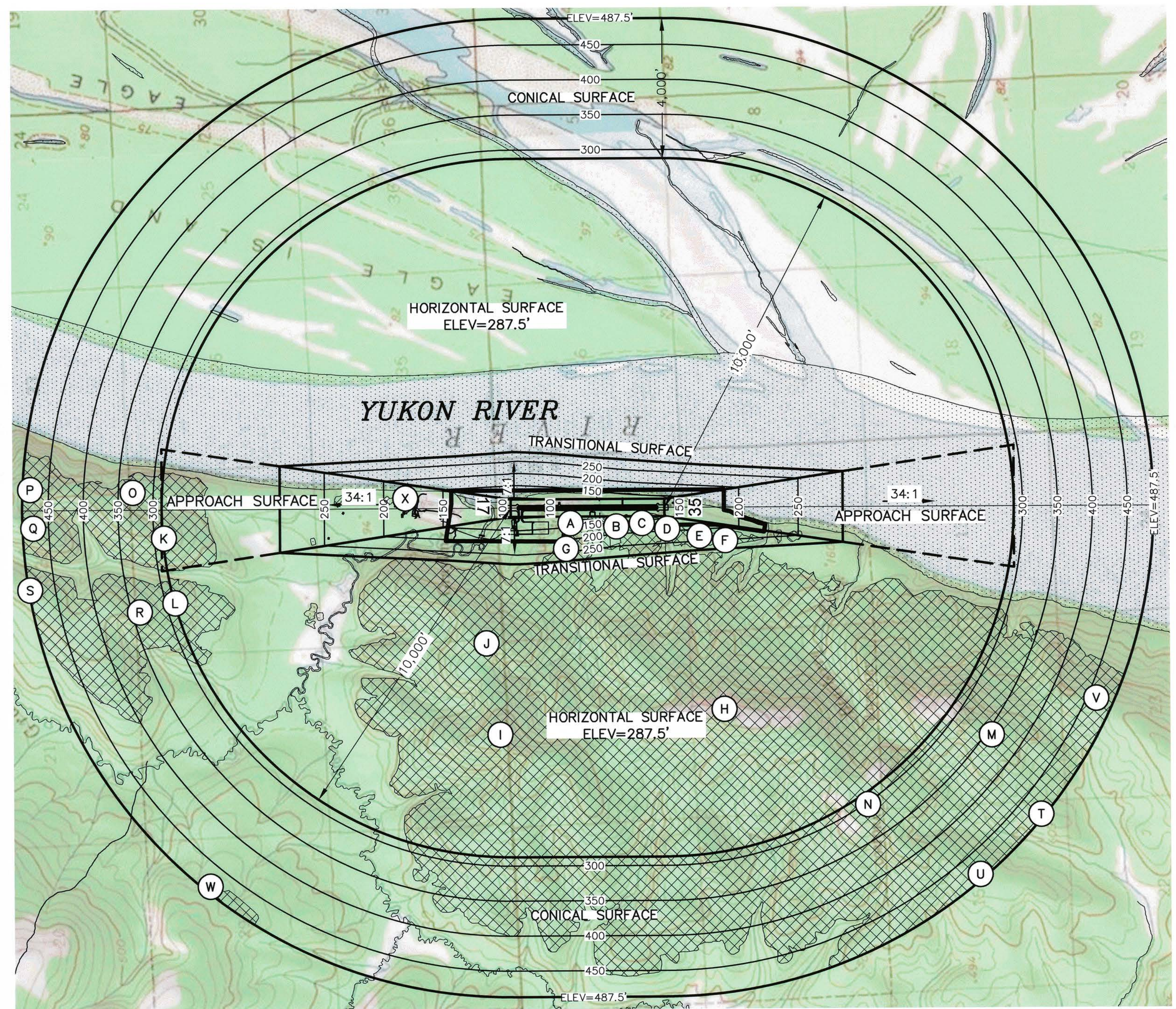

PART 77 SURFACE OBSTRUCTION DATA							
ID	DESCRIPTION	STATION OFFSET	ELEVATION (FT)	SURFACE PENETRATED	SURFACE ELEVATION (FT)	AMOUNT PENETRATED (FT)	DISPOSITION
A	TERRAIN/TREES	STA 115+05, 441' RT	207	TRANSITIONAL	136	71	REMOVE
B	BUSH	STA 128+15, 540' RT	149	TRANSITIONAL	141	8	REMOVE
E	TREE	STA 151+97, 820' RT	264	TRANSITIONAL	228	36	REMOVE
F	TREE	STA 159+31, 951' RT	281	TRANSITIONAL	253	28	REMOVE
G	TERRAIN/TREES	STA 113+75, 1172' RT	363	TRANSITIONAL	236	127	TO REMAIN
H	TERRAIN/TREES	STA 158+86, 5774' RT	1051	HORIZONTAL	288	763	TO REMAIN
I	TERRAIN/TREES	STA 94+65, 6483' RT	959	HORIZONTAL	288	671	TO REMAIN
J	TERRAIN/TREES	STA 90+83, 3866' RT	753	HORIZONTAL	288	465	TO REMAIN
K	TERRAIN/TREES	STA -01+42, 817' RT	500	APPROACH	288	212	TO REMAIN
L	TERRAIN/TREES	STA 01+76, 2671' RT	363	HORIZONTAL	288	75	TO REMAIN
M	TERRAIN/TREES	STA 235+33, 6544' RT	926	CONICAL	358	568	TO REMAIN
N	TERRAIN/TREES	STA 199+78, 8530' RT	928	CONICAL	303	625	TO REMAIN
O	TERRAIN/TREES	STA -10+28, 504' LT	564	CONICAL	349	215	TO REMAIN
P	TERRAIN/TREES	STA -39+69, 601' LT	701	CONICAL	476	225	TO REMAIN
Q	TERRAIN/TREES	STA -38+87, 511' RT	710	CONICAL	473	237	TO REMAIN
R	TERRAIN/TREES	STA -08+41, 2923' RT	501	CONICAL	340	161	TO REMAIN
S	TERRAIN/TREES	STA -39+81, 2282' RT	613	CONICAL	486	127	TO REMAIN
T	TERRAIN/TREES	STA 249+39, 8827' RT	702	CONICAL	483	219	TO REMAIN
U	TERRAIN/TREES	STA 231+91, 10545' RT	751	CONICAL	480	271	TO REMAIN
V	TERRAIN/TREES	STA 265+31, 5507' RT	780	CONICAL	463	317	TO REMAIN
W	TERRAIN/TREES	STA 11+42, 10786' RT	490	CONICAL	483	7	TO REMAIN
X	TANK	STA 67+78, 295' LT	227	APPROACH	182	45	TO REMAIN

NOTES:

- DESIGNATED AIRPORT ELEVATION IS 137.5 FT.
- ALL ELEVATIONS AND CONTOURS ARE IN FEET. PART 77 CONTOUR ELEVATIONS BASED ON NAVD 88.
- BASE MAP DATA FROM USGS HOLY CROSS (D-3) QUADRANGLE.
- PRIMARY SURFACE WIDTH OF RUNWAY 17-35 IS 500'.

LEGEND:

- TERRAIN/TREE OBSTRUCTIONS
- OBSTRUCTION TAG ID

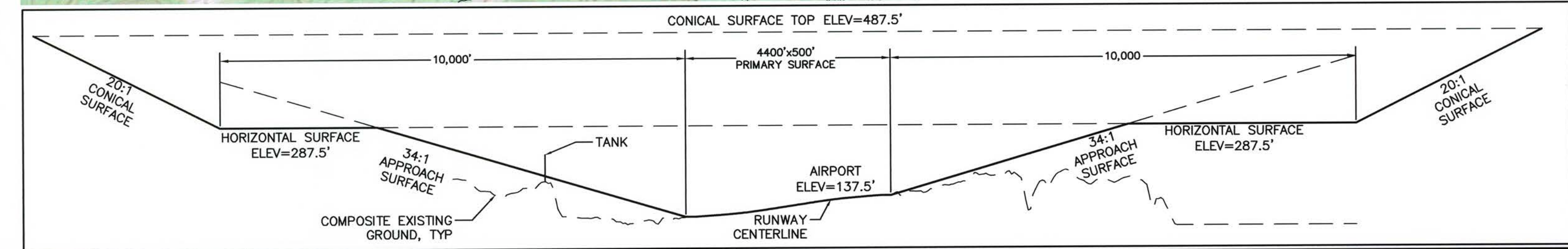
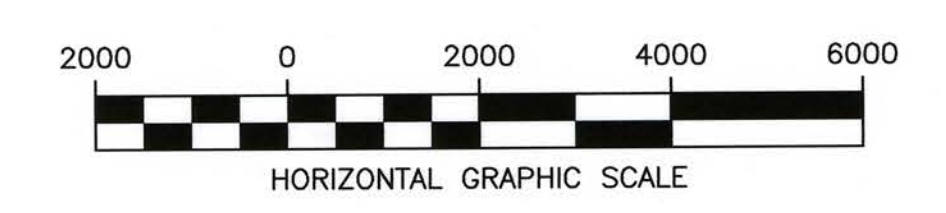

Plotted 4/8/2015 9:54 AM by Matt McJorjas Z:\project\1605.08-DOT-N-Aeronautical-2009-Grayling-Airport\Civil\ACAD\1605.08-KGX-AIRSPACE.dwg

DESIGN NBS/MIM	BY MIM	DATE 4/7/2015	REVISIONS AS-BUILT
DRAWN MIM			
CHECKED EJJ			

STATE OF ALASKA
DEPARTMENT OF TRANSPORTATION AND PUBLIC FACILITIES
NORTHERN REGION

APPROVED DATE 4/27/15
ALBERT M. L. BECK, P.E. AIRPORT DESIGN GROUP CHIEF

AIRPORT LAYOUT PLAN APPROVED BY LETTER DATED: _____

AIRPORTS DIVISION,
ALASKAN REGION, AAL-601
AIRSPACE REVIEW # _____

PLANS DEVELOPED BY: **R&M CONSULTANTS, INC.**

GRAYLING AIRPORT
AIRPORT LAYOUT PLAN
AIRPORT AIRSPACE PLAN

SHEET 5 OF 5