

**WIND DATA**  
 NO WIND DATA IS AVAILABLE FOR HOLY CROSS. PILOT REPORTS INDICATE THAT THE EXISTING RUNWAY IS ALIGNED WITH PREVAILING WINDS.

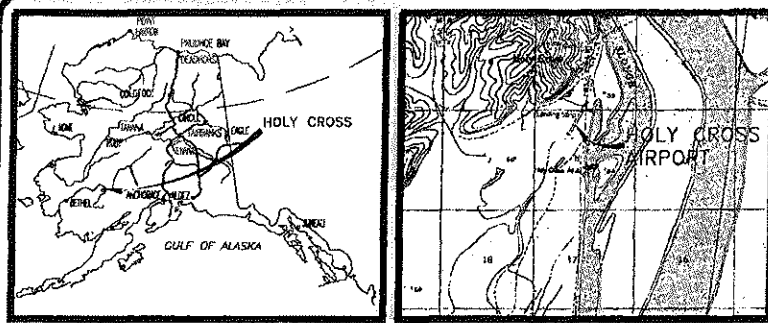

LOCATION MAP

VICINITY MAP

NO SCALE

SEC. 5 & 8, T 24 N,  
R 87 W, 5M

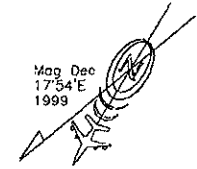
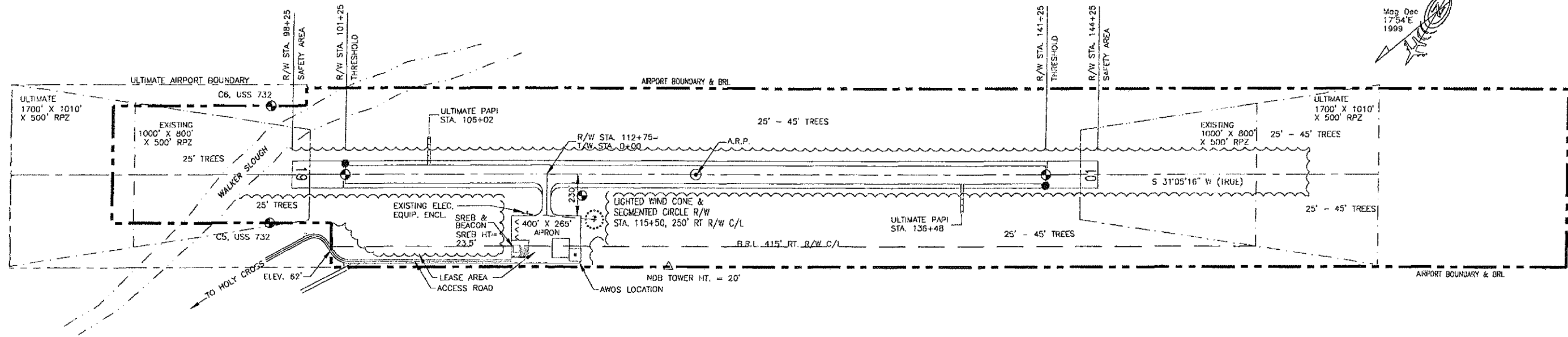

**NOTES:**  
 THE GEODETIC COORDINATES WERE DERIVED BY CONTROLLED GPS WORK DONE BY LCMF, INC. ON AUGUST OF 1998.  
 45' IRULS PENETRATE THRESHOLD SURFACE AT APPROACH 01.  
 25' TREES PENETRATE THRESHOLD SURFACE AT APPROACH 19.  
 25' TO 45' TREES PENETRATE 01Z LEFT AND RIGHT OF RUNWAY CENTERLINE.

AIRPORT DATA		
	EXISTING	ULTIMATE
AIRPORT ELEVATION (MSL)	69'	SAME
AIRPORT REFERENCE CODE	B-II	B-II
MEAN DAILY MAX. TEMP. HOTTEST MONTH (JULY)	68°F	SAME
TAXIWAY LIGHTING	MITL	SAME
RAMP LIGHTING	NONE	SAME
NAVIGATION AIDS	GPS, NDB, BEACON, AWOS	SAME
COMMUNICATION AIDS	NONE	SAME
AIRPORT REFERENCE POINT (ARP)	LAT. 62°11'17.87"N LONG. 159°46'29.82"W	
THRESHOLD R/W 1	LAT. 62°11'01.00"N LONG. 159°46'51.58"W	
THRESHOLD R/W 19	LAT. 62°11'34.73"N LONG. 159°46'08.06"W	

RUNWAY DATA		
	EXISTING	ULTIMATE
% WIND COVERAGE	NO DATA	SAME
RUNWAY SURFACE TYPE	GRAVEL	SAME
PAVEMENT STRENGTH	N/A	SAME
APPROACH SURFACES	20:1	34:1
APPROACH VISIBILITY MINIMUM	>1 MILE	SAME
RUNWAY LIGHTING	MIRL	SAME
RUNWAY MARKING	NONE	SAME
VISUAL APPROACH AIDS	NONE	PAPI
R/W DIMENSIONS	4000' x 100'	SAME
R/W SAFETY AREA	4600' x 150'	SAME
R/W OBJECT FREE AREA (ROFA)	4600' x 500'	SAME
R/W OBSTACLE FREE ZONE (OZF)	4400' x 400'	SAME
T/W WIDTH	50'	SAME
T/W SAFETY AREA WIDTH	50'	120'
T/W OFA	131'	SAME

LEGEND		
	EXISTING	ULTIMATE
PROPERTY LINE	---	---
BUILDING RESTRICTION LINE (B.R.L.) DEVELOPMENT	---	---
WIND CONE & SEGMENTED CIRCLE	(Symbol)	(Symbol)
WIND CONE ONLY	(Symbol)	(Symbol)
BUILDING	(Symbol)	(Symbol)
ROADWAY	(Symbol)	(Symbol)
FENCING	(Symbol)	(Symbol)
AIRPORT REFERENCE POINT	(Symbol)	(Symbol)
ROTATING BEACON	(Symbol)	(Symbol)
ANTENNA/TOWER	(Symbol)	(Symbol)
VASI	(Symbol)	(Symbol)
PAV	(Symbol)	(Symbol)
SHORELINE/WATERLINE	(Symbol)	(Symbol)
TREELINE	(Symbol)	(Symbol)
THRESHOLD	(Symbol)	(Symbol)
OVERHEAD POWER	(Symbol)	(Symbol)
PRIMARY MONUMENT	(Symbol)	(Symbol)
SECONDARY MONUMENT	(Symbol)	(Symbol)

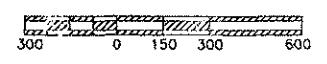

NONSTANDARD CONDITIONS			
ITEM	STANDARD	EXISTING	ULTIMATE
TREES IN OFA	500'	280'	>500'
TREES IN APPROACH SURFACE	500'	250'	500'

DESIGN WK	
DRAWN CAT	
CHECKED PIM	

CAT	DATE	AS-BUILT	REVISIONS
	3/31/99	AS-BUILT	

STATE OF ALASKA  
 DEPARTMENT OF TRANSPORTATION AND PUBLIC FACILITIES  
 NORTHERN REGION  
 APPROVED: *Patricia D. Miller*  
 PATRICIA D. MILLER, P.E. DATE: 6/27/01  
 DESIGN GROUP CHIEF

AIRPORT LAYOUT PLAN APPROVED  
 BY LETTER DATED: 7/9/01  
*[Signature]*  
 AIRPORTS DIVISION,  
 ALASKAN REGION, AAL-610  
 AIRSPACE REVIEW #00AAL-090NRA

THIS ALP SUPERSEDES ALP DATED 3/15/83 AND LAST FAA APPROVED 1/6/87 AND FROM THE AS-BUILTS DATED 4-29-85 AND 5-8-85.

HOLY CROSS AIRPORT  
 AIRPORT LAYOUT PLAN

SHEET  
 1 OF 3

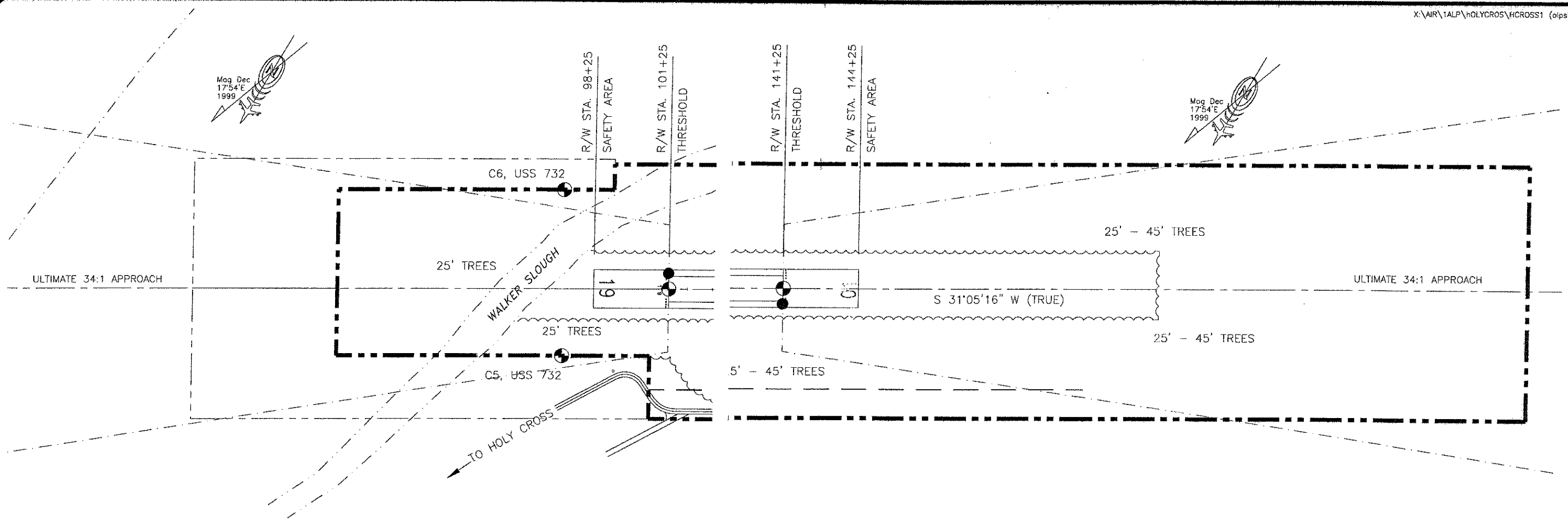

RUNWAY 19 INNER APPROACH PLAN

RUNWAY 01 INNER APPROACH PLAN

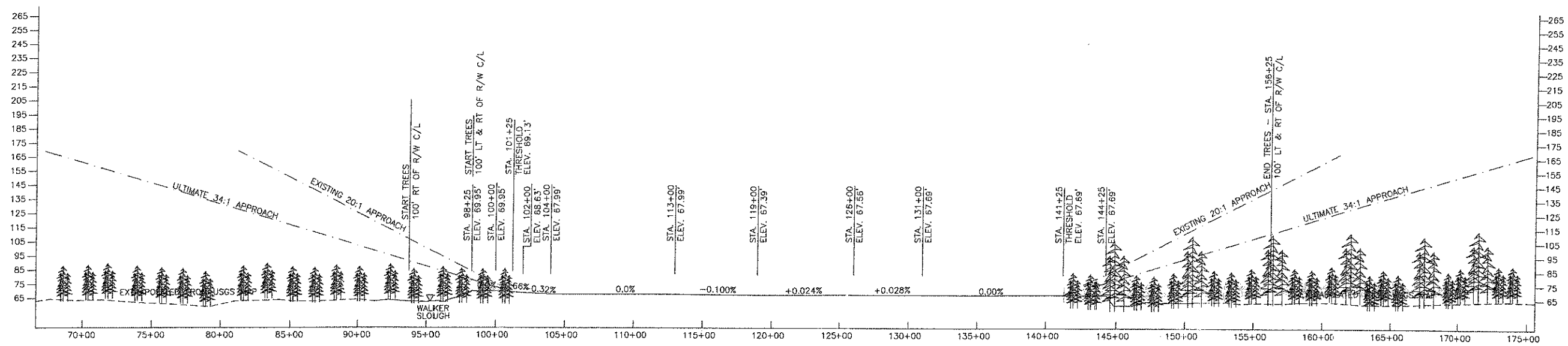

RUNWAY 19-1 PROFILE

DESIGN	
DRAWN	
CHECKED	
BY	DATE
	REVISIONS

STATE OF ALASKA  
 DEPARTMENT OF TRANSPORTATION AND PUBLIC FACILITIES  
 NORTHERN REGION - DESIGN AND ENGINEERING SERVICES

APPROVED: *Patricia D. Miller* DATE: 6/12/01  
 PATRICIA D. MILLER, P.E. DESIGN GROUP CHIEF

AIRPORT LAYOUT PLAN APPROVED  
 BY: *[Signature]* DATED: 7/9/01  
 AIRPORTS DIVISION, FAA  
 ALASKAN REGION, AAL-610  
 AIRSPACE REVIEW #00AAL-090MRA

HOLY CROSS AIRPORT  
 INNER PORTION OF THE APPROACH  
 SURFACE PLAN & PROFILE