

LOCATION MAP  
NO SCALE

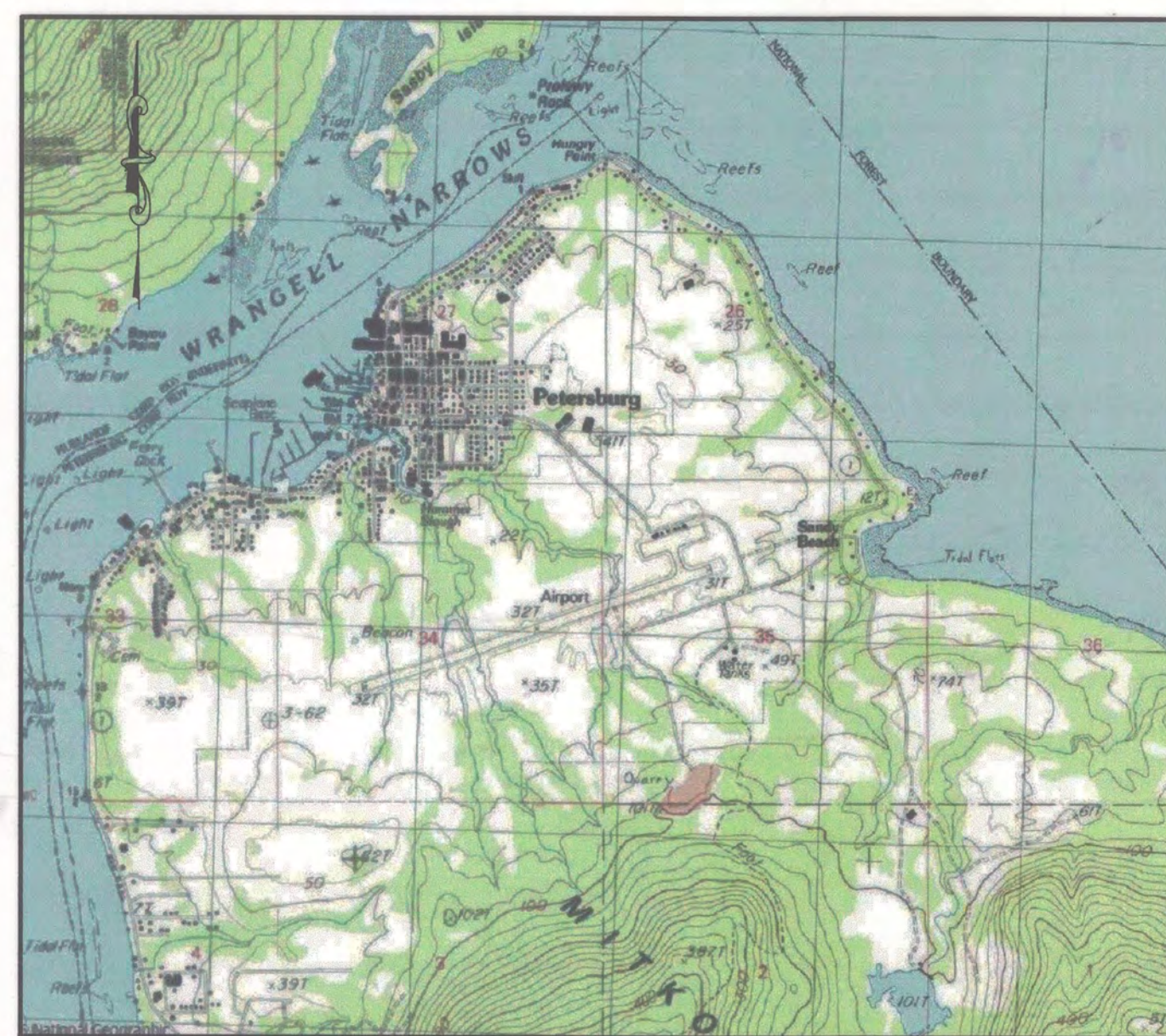

VICINITY MAP  
T58S, R79E, SEC. 34 & 35  
USGS PETERSBURG D-3  
1" = 1 MILE

SHEET INDEX	
TITLE	NO.
TITLE SHEET	1
EXISTING AIRPORT LAYOUT DRAWING	2
ULTIMATE AIRPORT LAYOUT DRAWING	3
AIRPORT AIRSPACE (PART 77) DRAWING	4
INNER PORTION OF THE APPROACH SURFACE DRAWING - RUNWAY 5	5
INNER PORTION OF THE APPROACH SURFACE DRAWING - RUNWAY 23	6
TERMINAL AREA PLAN	7
LAND USE DRAWING	8
AIRPORT PROPERTY MAP	9

NOTES:

- ALL COORDINATES AND ELEVATIONS LISTED ARE CERTIFIED TO FAA 1A ACCURACY.

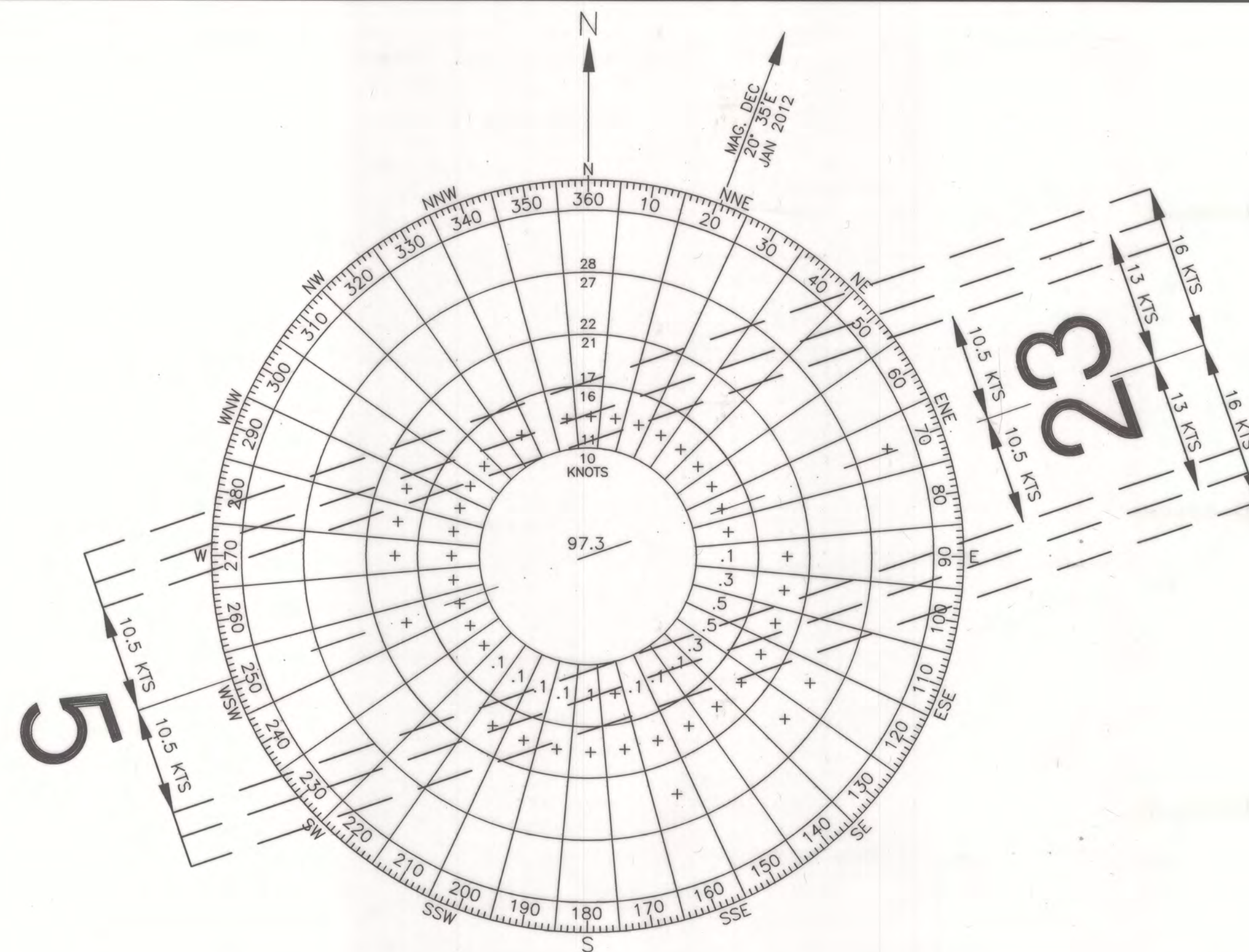

HELIPORT DATA TABLE		
ITEM	EXISTING	ULTIMATE
DESIGN AIRCRAFT	-	LIGHT TURBINE
MAX. GROSS WEIGHT	-	5000 LB
MAX. ROTOR DIAMETER	-	50'
MAX. LENGTH	-	50'
FINAL APPROACH AND TAKEOFF AREA (FATO)	-	75' X 75'
SAFETY AREA	-	105' X 105'
PROTECTION ZONE	-	75' X 105' X 280'

WIND DATA TABLE				
RUNWAY	10.5 kt	13 kt	16 kt	20 kt
5-23	98.83%	99.57%	99.94%	-

SOURCE: NATIONAL OCEANIC & ATMOSPHERIC ADMINISTRATION NATIONAL CLIMATIC DATA CENTER FOR 70366 PETERSBURG, AK PERIOD: 1993 - 2002

AIRPORT DATA TABLE		
ITEM	EXISTING	ULTIMATE
ICAO IDENTIFIER		PAPG
NATIONAL AIRPORT IDENTIFIER		PSG
FAA SITE NUMBER		50590.2*A
AIRPORT ELEVATION NAVD88	113.2'	113.2'
AIRPORT REFERENCE CODE	C - III	C - III
MEAN MAX. TEMPERATURE, HOTTEST MONTH *	63.6°F IN JULY	
AIRPORT AND TERMINAL NAVIGATION AIDS	ROTATING BEACON, VOR/DME, NDB, LDA/DME-D, AWOS, GPS	
TAXIWAY LIGHTING/MARKING	MITL	
RAMP LIGHTING	EDGE & FLOODLIGHTING	
OBSTRUCTION SURVEY SOURCE & TYPE	R&M CONSULTANTS, INC. 2010/ VERTICALLY GUIDED AIRPORT AIRSPACE ANALYSIS SURVEY	
MAGNETIC DECLINATION, YEAR, RATE OF CHANGE **	20°35'E, JANUARY 2012 0°18'W/YEAR	

DATA FROM (\*) THE WESTERN REGIONAL CLIMATE CENTER (\*\*) NATIONAL GEOPHYSICAL DATA CENTER

MODIFICATION TO STANDARDS/ NON STANDARD CONDITIONS			
DESCRIPTION	STANDARD	EXISTING	ULTIMATE
RUNWAY SAFETY AREA LENGTH	8000'	7200'	7200'

RUNWAY DATA TABLE				
ITEM	RW 5-23			
	EXISTING		ULTIMATE	
	5	23	5	23
RUNWAY TYPE UTILITY OR OTHER THAN UTILITY	OTHER THAN UTILITY		SAME	
FAR PART 77 APPROACH CATEGORY (V, NPI, P)	NPI		SAME	
APPROACH SURFACES	20:1		34:1	
VISIBILITY MINIMUM	> 2 MILE		≥ 1 MILE	
RUNWAY SURFACE	ASPHALT		SAME	
PAVEMENT STRENGTH SW, DW, DTW, DDTW X 1000LBS	75 SW, 160 DW		SAME	
AIRCRAFT APPROACH CATEGORY	C		SAME	
AIRPLANE DESIGN GROUP	III		SAME	
RUNWAY DIMENSIONS	6400' X 150'		SAME	
TRUE BEARING	S70°08'44"W		SAME	
EFFECTIVE GRADE	0.07%		SAME	
RUNWAY SAFETY AREA (RSA) DIMENSIONS	7200' X 500'		SAME	
LENGTH BEYOND R/W ENDS	600'		SAME	
RUNWAY PROTECTION ZONE (RPZ) DIMENSIONS	1700' X 500' X 1010'		SAME	
RUNWAY OBJECT FREE AREA (ROFA) DIMENSIONS	8400' X 800'		SAME	
LENGTH BEYOND R/W ENDS OR STOPWAYS	1000'		SAME	
RUNWAY OBSTACLE FREE ZONE (OFZ) DIMENSIONS	6800' X 400'		SAME	
RUNWAY LIGHTING TYPE	HIRL		SAME	
RUNWAY MARKING TYPE	NPI		P	
RUNWAY VISUAL APPROACH AIDS	PAPI, REIL	PAPI, MALS, GPS	PAPI, MALS, GPS	SAME
TOUCHDOWN ELEVATION NAVD88	113.2'	108.5'		SAME

GEOGRAPHIC COORDINATES TABLE				
ITEM	EXISTING* LATITUDE	EXISTING* LONGITUDE	ULTIMATE* LATITUDE	ULTIMATE* LONGITUDE
AIRPORT REFERENCE POINT	56°48'05.30"N	132°56'46.44"W	SAME	SAME
THRESHOLD 5	56°47'54.90"N	132°57'40.69"W	SAME	SAME
THRESHOLD 23	56°48'15.69"N	132°55'52.17"W	SAME	SAME

\*NAD83

AIRPORT SURVEY CONTROL			
MONUMENT	LATITUDE	LONGITUDE	ELEVATION
PSG D (PACS)	56°48'12.30"N	132°56'03.95"W	100.3'
PSG E (SACS)	56°48'03.94"N	132°56'47.64"W	104.2'
PSG F (SACS)	56°47'55.34"N	132°57'32.67"W	109.3'

LEGEND		
ITEM	EXISTING	ULTIMATE
AIRPORT REFERENCE POINT		
ANTENNA/TOWER		
BUILDING		
BUILDING RESTRICTION LINE		
FENCE		
FLOOD LIGHT		
LEASE LOT		
PAPI		
PROPERTY LINE		
REIL		
ROADWAYS		
ROTATING BEACON		
RUNWAY/TAXIWAY CENTERLINE		
SHORELINE		
SURVEY MONUMENT		
THRESHOLD LIGHTS		
TOPOGRAPHIC CONTOURS		
TREE (LARGE SINGLE)		
TREELINE		
WINDCONE		
WINDCONE WITH SEGMENTED CIRCLE		

Z:\project\1627.01\_DOT\_SE Aeronautical 2008 Petersburg Airport\Civil\ACAD\1627.01-Title Sheet.dwg

PLANNED: NBS  
DRAWN: SA/MM  
CHECKED: EUG

STATE OF ALASKA  
DEPARTMENT OF TRANSPORTATION  
AND PUBLIC FACILITIES  
SOUTHEAST REGION PLANNING

PREVIOUS REVISION DATE: MARCH 22, 2005  
APPROVED:   
DATE: 9/11/13  
VERNE SKAGERBERG, TRANSPORTATION PLANNER, FOR  
ANDY HUGHES, CHIEF OF PLANNING

FAA AIRSPACE REVIEW NO: 2012-AAL-218-NRA  
FAA APPROVAL DATE: 10/9/2012  
BY:   
FAA AIRPORT DIVISION, ALASKA REGION, AAL-600  
SUBJECT TO CONDITIONS IN LETTER DATED: 10/9/2012  
PREVIOUS ALP FAA APPROVAL DATE: AUGUST 24, 2006

PETERSBURG JAMES A. JOHNSON AIRPORT  
TITLE SHEET

SHEET  
1 OF 9



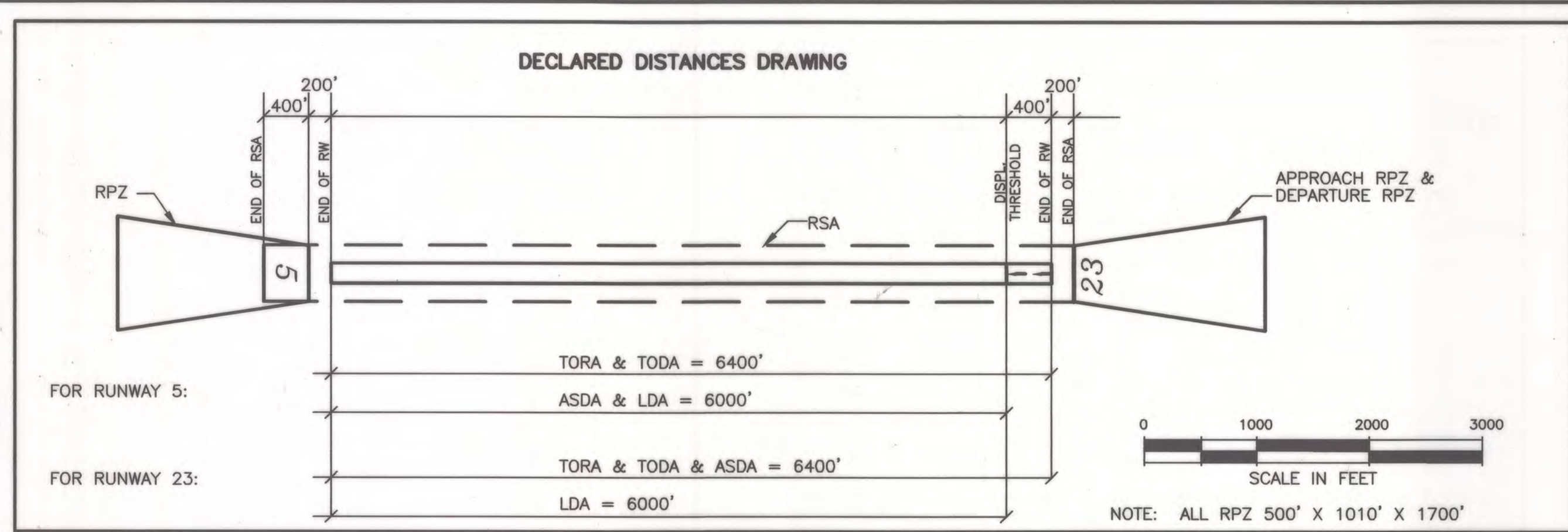

**GENERAL NOTES:**

1. NO THRESHOLD SITING SURFACE PENETRATIONS.
2. NO OFZ OBJECT PENETRATIONS.

#### TAXIWAY DATA TABLE

TAXIWAY DESIGNATION	LENGTH (FEET)	WIDTH (FEET)	SAFETY AREA WIDTH (FEET)	OBJECT FREE AREA WIDTH (FEET)
TAXIWAY A	425	94	118	186

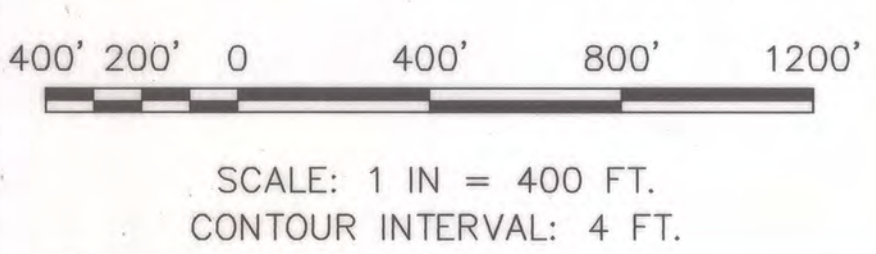
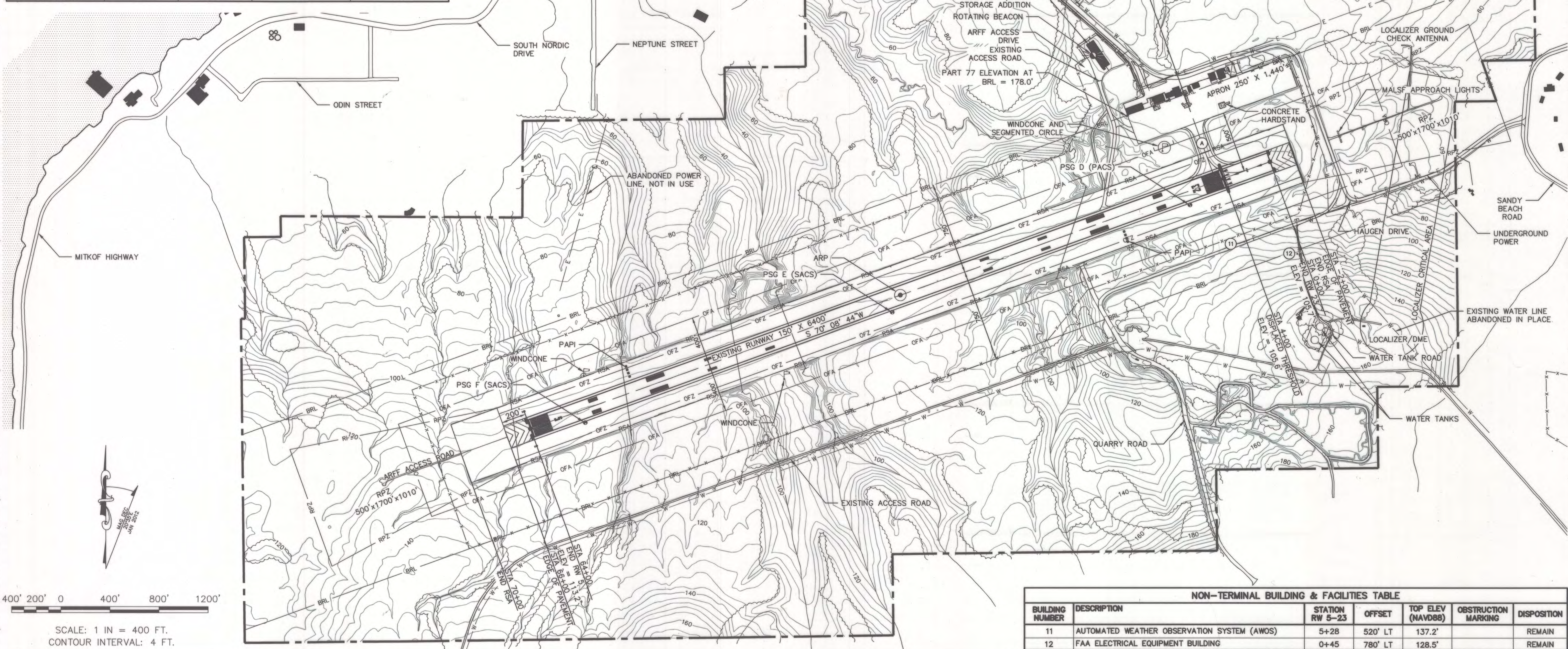

#### NON-TERMINAL BUILDING & FACILITIES TABLE

BUILDING NUMBER	DESCRIPTION	STATION RW 5-23	OFFSET	TOP ELEV (NAVD88)	OBSTRUCTION MARKING	DISPOSITION
11	AUTOMATED WEATHER OBSERVATION SYSTEM (AWOS)	5+28	520' LT	137.2'		REMAIN
12	FAA ELECTRICAL EQUIPMENT BUILDING	0+45	780' LT	128.5'		REMAIN

PLANNED: NBS  
DRAWN: SA/MM  
CHECKED: E/JG

STATE OF ALASKA  
DEPARTMENT OF TRANSPORTATION  
AND PUBLIC FACILITIES  
SOUTHEAST REGION PLANNING

PREVIOUS REVISION DATE: MARCH 22, 2005  
APPROVED:   
DATE: 9/11/13  
VERNE SKAGERBERG, TRANSPORTATION PLANNER, FOR  
ANDY HUGHES, CHIEF OF PLANNING

FAA AIRSPACE REVIEW NO: 2012-AAL-218-NRA  
FAA APPROVAL DATE: 10/9/2013  
BY:   
FAA AIRPORT DIVISION, ALASKA REGION, AAL-600  
SUBJECT TO CONDITIONS IN LETTER DATED: 10/9/2013  
PREVIOUS ALP FAA APPROVAL DATE: AUGUST 24, 2006

PETERSBURG JAMES A. JOHNSON AIRPORT  
EXISTING AIRPORT LAYOUT DRAWING

SHEET  
2 OF 9

Z:\project\1627.01 DOT\_SE Aeronautical 2009 Petersburg Airport\Civil\ACAD\1627.01-Layout Plan.dwg



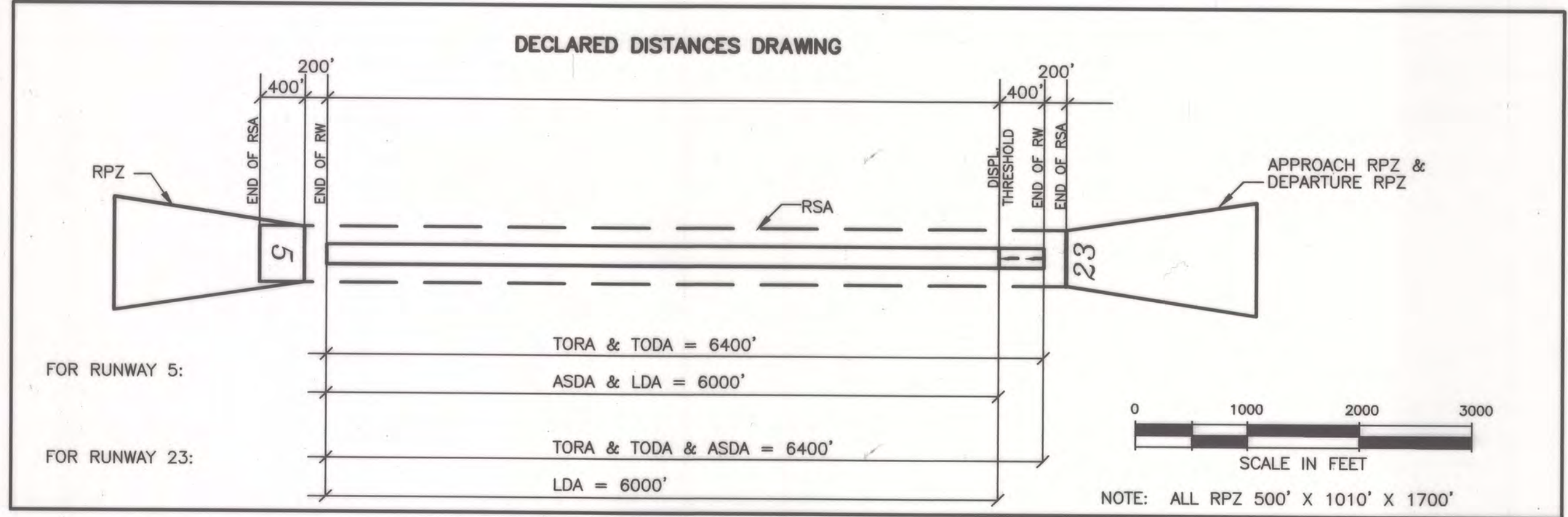

### TAXIWAY DATA TABLE

TAXIWAY DESIGNATION	LENGTH (FEET)	WIDTH (FEET)	SAFETY AREA WIDTH (FEET)	OBJECT FREE AREA WIDTH (FEET)
TAXIWAY A	425	94	118	186
TAXIWAY B	6345	75	118	186
TAXIWAY C	440	75	118	186
TAXIWAY D	500	35	79	131
TAXIWAY E	335	75	118	186
TAXIWAY F	335	75	118	186
TAXIWAY G	475	75	118	186
TAXIWAY H	335	75	118	186

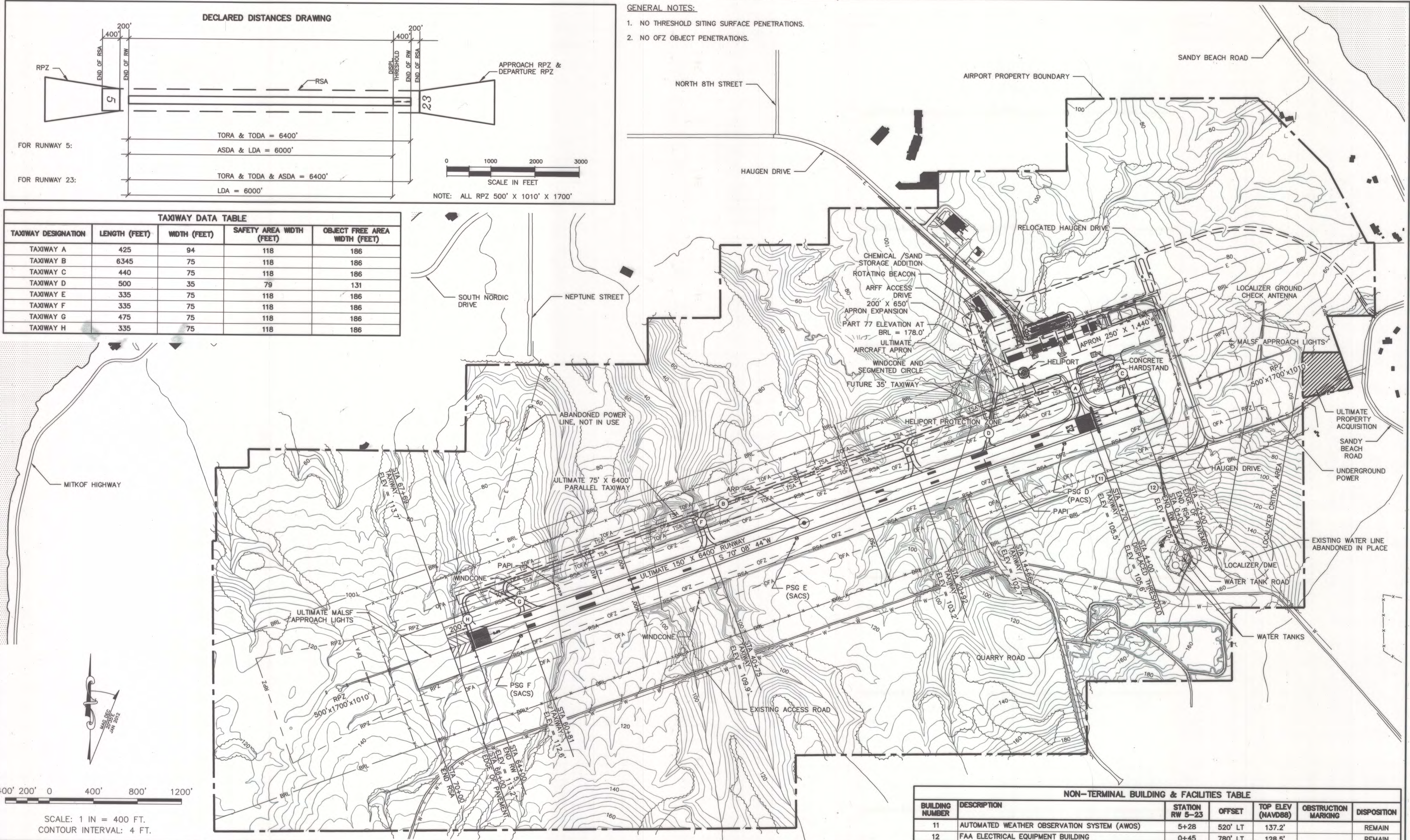

### NON-TERMINAL BUILDING & FACILITIES TABLE

BUILDING NUMBER	DESCRIPTION	STATION RW 5-23	OFFSET	TOP ELEV (NAVD88)	OBSTRUCTION MARKING	DISPOSITION
11	AUTOMATED WEATHER OBSERVATION SYSTEM (AWOS)	5+28	520' LT	137.2'		REMAIN
12	FAA ELECTRICAL EQUIPMENT BUILDING	0+45	780' LT	128.5'		REMAIN

Z:\project\1627.01 DOT\_SE Aeronautical 2009 Petersburg Airport Civil\ACAD\1627.01-Layout\_Plan.dwg

PLANNED: NBS  
DRAWN: SA/MM  
CHECKED: EJG

STATE OF ALASKA  
DEPARTMENT OF TRANSPORTATION  
AND PUBLIC FACILITIES  
SOUTHEAST REGION PLANNING

PREVIOUS REVISION DATE: MARCH 22, 2005  
APPROVED:   
DATE: 9/11/13  
VERNE SKAGERBERG, TRANSPORTATION PLANNER, FOR  
ANDY HUGHES, CHIEF OF PLANNING

FAA AIRSPACE REVIEW NO: 2012-AAL-218-NRA  
FAA APPROVAL DATE: 10/9/2013  
BY:   
FAA AIRPORT DIVISION, ALASKA REGION, AAL-600  
SUBJECT TO CONDITIONS IN LETTER DATED: 10/9/2013  
PREVIOUS ALP FAA APPROVAL DATE: AUGUST 24, 2006

PETERSBURG JAMES A. JOHNSON AIRPORT  
ULTIMATE AIRPORT LAYOUT DRAWING

SHEET  
3 OF 9

SCALE: 1 IN = 400 FT.  
CONTOUR INTERVAL: 4 FT.



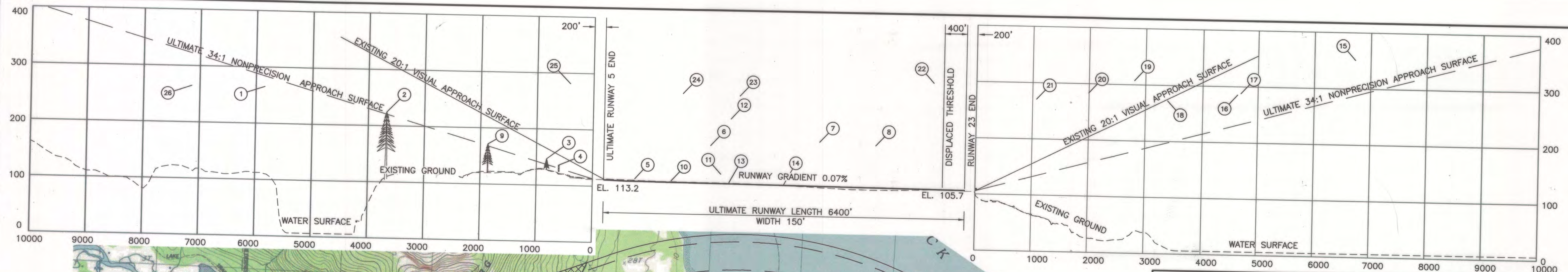

**GENERAL NOTES:**  
 1. REFER TO THE INNER PORTION OF THE APPROACH SURFACE DRAWINGS FOR CLOSE IN OBSTRUCTIONS.

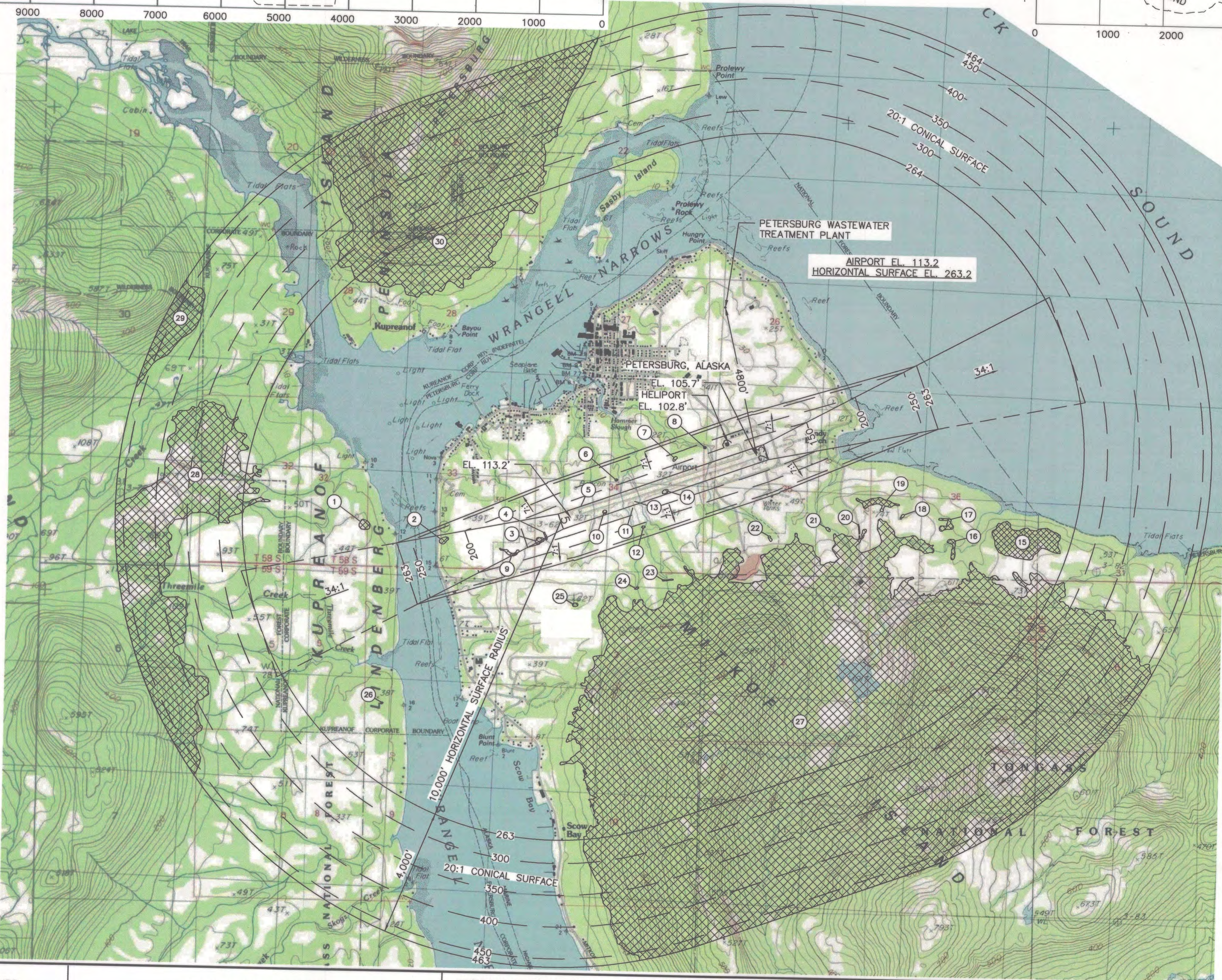

OBSTRUCTION TABLE								
ITEM NO.	DESCRIPTION	STATION/OFFSET RW 5-23	ELEVATION (NAVD88)	SURFACE PENETRATED	SURFACE ELEVATION	AMOUNT PENETRATED	DISPOSITION	STAGE TO CORRECT
1	TREE	124+45/1886' RT	265.6'	HORIZONTAL	263.2'	2.4'	REMOVE	N/A
2	TREES	102+73/626' RT	224.7'	APPROACH	222.0'	2.7'	REMOVE	N/A
3	TREES	74+17/351' RT	147.2'	APPROACH	142.9'	4.3'	REMOVE	N/A
4	FENCE	71+98/284' LT	136.6'	APPROACH	130.9'	5.7'	RELOCATE	N/A
5	WINDSOCK	58+46/255' RT	115.1'	TRANSITIONAL	113.3'	1.8'	REMAIN	N/A
6	TREE	45+07/668' RT	176.6'	TRANSITIONAL	170.7'	5.9'	REMOVE	N/A
7	TREES	25+71/717' RT	186.3'	TRANSITIONAL	176.9'	9.4'	REMOVE	N/A
8	TREE	15+72/746' RT	181.8'	TRANSITIONAL	178.4'	3.4'	REMOVE	N/A
9	TREES/BUSHES	84+66/419' LT	171.3'	APPROACH	166.1'	5.2'	REMOVE	N/A
10	SIGN	51+99/143' LT	112.7'	PRIMARY	111.8'	0.9'	REMAIN	N/A
11	WINDSOCK	43+21/319' LT	126.1'	TRANSITIONAL	120.6'	5.5'	REMAIN	N/A
12	TREE	41+75/1000' LT	226.7'	TRANSITIONAL	216.3'	10.4'	REMOVE	N/A
13	SIGN	41+99/144' LT	111.5'	PRIMARY	110.6'	0.9'	REMAIN	N/A
14	SIGN	32+00/143' LT	109.9'	PRIMARY	109.5'	0.4'	REMAIN	N/A
15	TREES/GROUND	-69+29/5268' LT	351.4'	HORIZONTAL	263.2'	88.2'	REMAIN	N/A
16	TREES	-48+40/4678' LT	285.5'	HORIZONTAL	263.2'	22.3'	REMAIN	N/A
17	TREES	-48+97/3960' LT	288.0'	HORIZONTAL	263.2'	24.8'	REMAIN	N/A
18	TREES	-35+97/3295' LT	272.7'	HORIZONTAL	263.2'	9.5'	REMAIN	N/A
19	TREES	-30+03/2584' LT	307.6'	HORIZONTAL	263.2'	44.4'	REMAIN	N/A
20	UTILITY POLES	-21+96/3229' LT	283.5'	HORIZONTAL	263.2'	20.3'	REMAIN	N/A
21	TREE	-12+70/2907' LT	270.7'	HORIZONTAL	263.2'	7.5'	REMAIN	N/A
22	TREES	5+57/2615' LT	295.3'	HORIZONTAL	263.2'	32.1'	REMAIN	N/A
23	TREES	40+02/2822' LT	265.5'	HORIZONTAL	263.2'	2.3'	REMAIN	N/A
24	TREES	50+09/2747' LT	268.2'	HORIZONTAL	263.2'	5.0'	REMAIN	N/A
25	TREES	70+16/2614' LT	281.7'	HORIZONTAL	263.2'	18.5'	REMAIN	N/A
26	TREE	137+45/3586' LT	264.8'	HORIZONTAL	263.2'	1.6'	REMAIN	N/A
27	TREES/GROUND	9+91/8497' LT	1121.3'	HORIZONTAL/CONICAL	362.6'	758.7'	REMAIN	N/A
28	TREES/GROUND	190+29/3102' RT	1016.1'	CONICAL	434.7'	581.4'	REMAIN	N/A
29	TREES/GROUND	162+23/9858' RT	1085.9'	CONICAL	449.0'	636.9'	REMAIN	N/A
30	TREES/GROUND	66+53/11543' RT	1716.1'	HORIZONTAL/CONICAL	410.1'	1306.0'	REMAIN	N/A

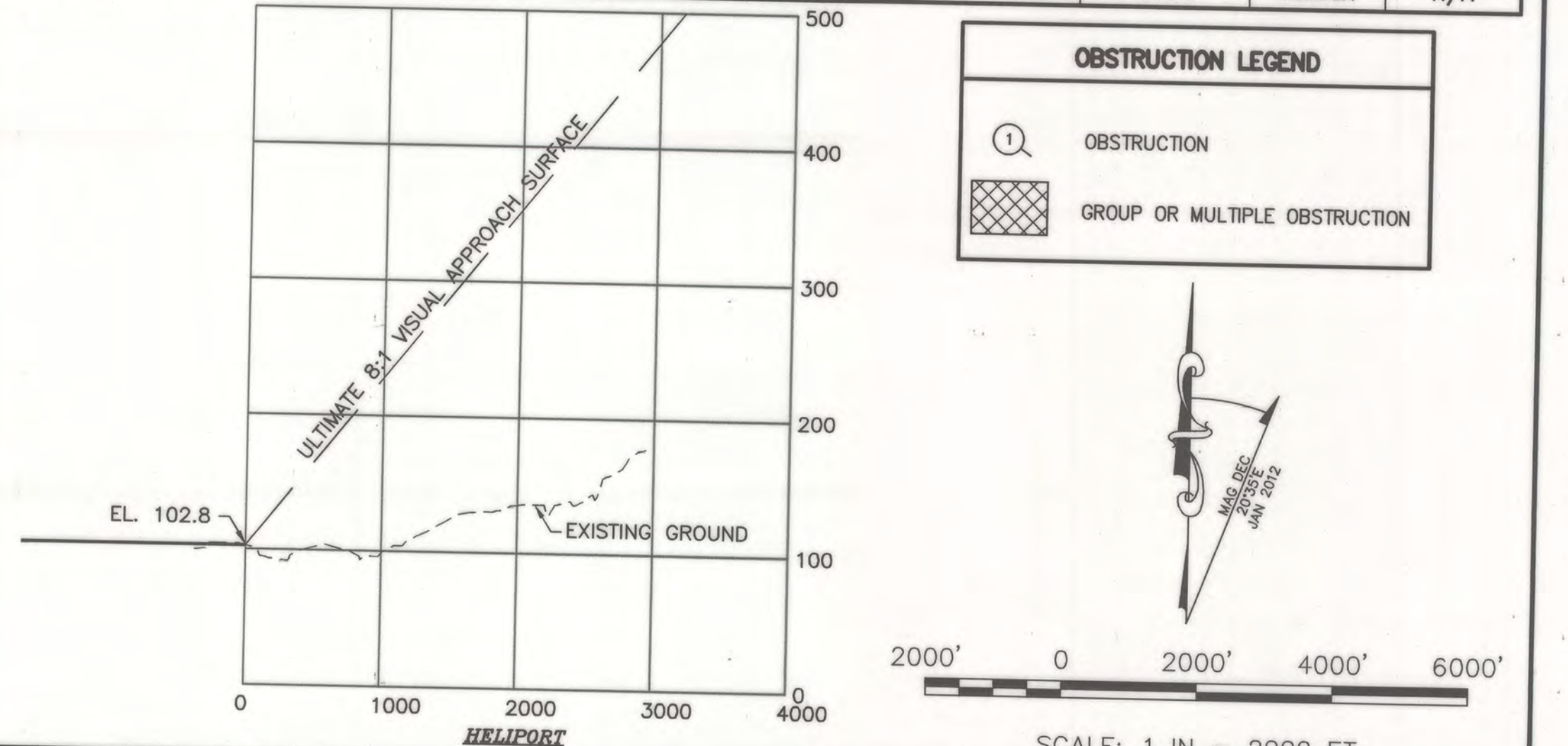

Z:\project\1627.01 DOT\_SE Aeronautical 2009 Petersburg Airport\Civil\ACAD\1627.01-Part 77.dwg

PLANNED: NBS  
 DRAWN: SA/MM  
 CHECKED: EJC

STATE OF ALASKA  
 DEPARTMENT OF TRANSPORTATION  
 AND PUBLIC FACILITIES  
 SOUTHEAST REGION PLANNING

PREVIOUS REVISION DATE: MARCH 22, 2005  
 APPROVED: *[Signature]* DATE: 9/11/13  
 VERNE SKAGERBERG, TRANSPORTATION PLANNER, FOR  
 ANDY HUGHES, CHIEF OF PLANNING

FAA AIRSPACE REVIEW NO: 2012-AAL-218-NRA  
 FAA APPROVAL DATE: 10/9/2013  
 BY: *[Signature]*  
 FAA AIRPORT DIVISION, ALASKA REGION, AAL-600  
 SUBJECT TO CONDITIONS IN LETTER DATED: 10/9/2013  
 PREVIOUS ALP FAA APPROVAL DATE: AUGUST 24, 2006

PETERSBURG JAMES A. JOHNSON AIRPORT  
 AIRPORT AIRSPACE  
 (PART 77) DRAWING

SHEET  
 4 OF 9

SCALE: 1 IN = 2000 FT.



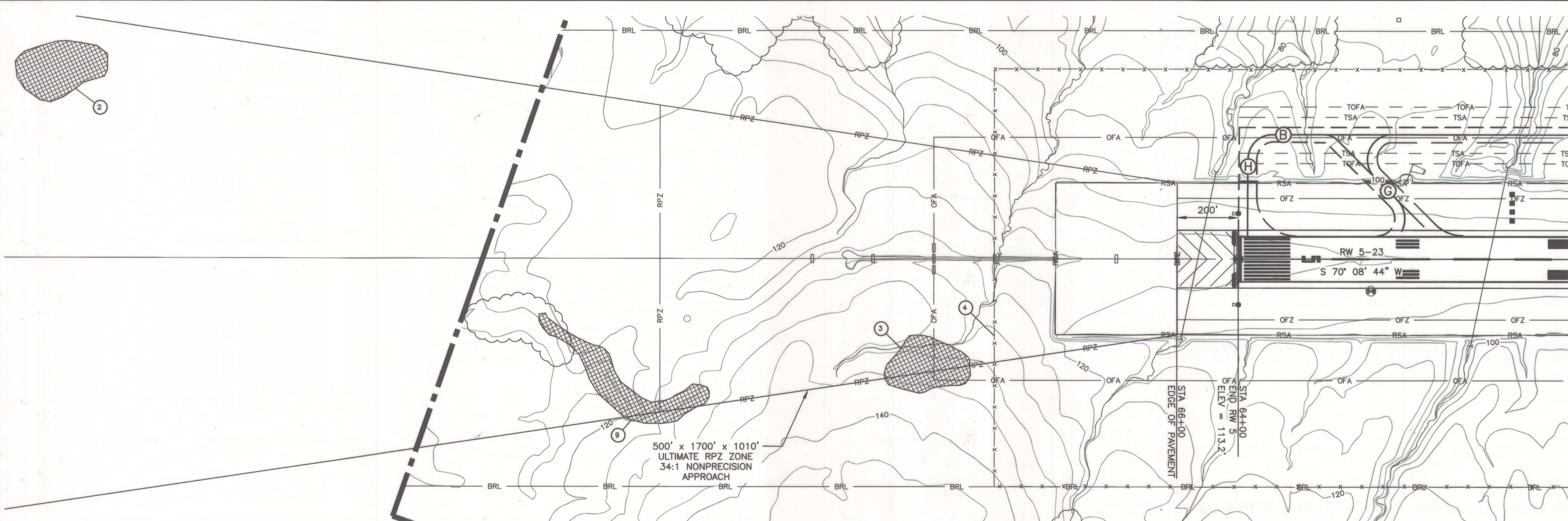

- GENERAL NOTES:**
1. THERE ARE CONTROLLING OBSTRUCTIONS FOR RUNWAY 5. THEREFORE THE CONTROLLING OBSTRUCTION CLEARANCE SLOPE IS ESTABLISHED AS 22:1 PER FAA AC 150/5200-35, SECTION 4, DATA ELEMENT NUMBER 57.
  2. THERE ARE OBJECT PENETRATIONS IN THE RUNWAY APPROACH END SITING SURFACES OF RUNWAY 5, AS DEFINED IN FAA AC 150/5300-13, CHG 15, APPENDIX 2, TABLE A2-1, LINE 3.

RPZ TABLE	
R/W 5 RPZ DIMENSIONS (INNER WIDTH X LENGTH X OUTER WIDTH)	500' X 1700' X 1010'

OBSTRUCTION TABLE									
ITEM NO.	DESCRIPTION	STATION/OFFSET RW 5-23	ELEVATION (NAVD88)	SURFACE PENETRATED	SURFACE ELEVATION	AMOUNT PENETRATED	DISPOSITION	STAGE TO CORRECT	
2	TREES	102+73/626' RT	224.7'	APPROACH	222.0'	2.7'	REMOVE	N/A	
3	TREES	74+17/351' RT	147.2'	APPROACH	142.9'	4.3'	REMOVE	N/A	
4	FENCE	71+98/284' LT	136.6'	APPROACH	130.9'	5.7'	RELOCATE	N/A	
9	TREES/BUSHES	84+66/419' LT	171.3'	APPROACH	166.1'	5.2'	REMOVE	N/A	

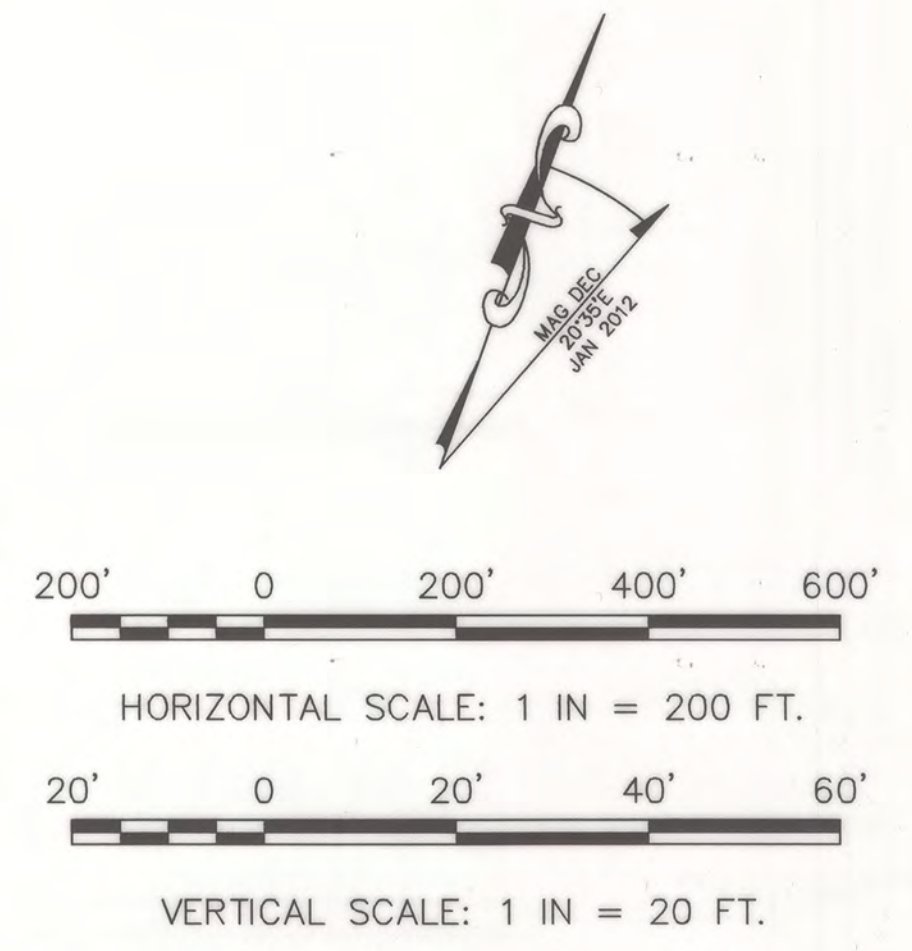
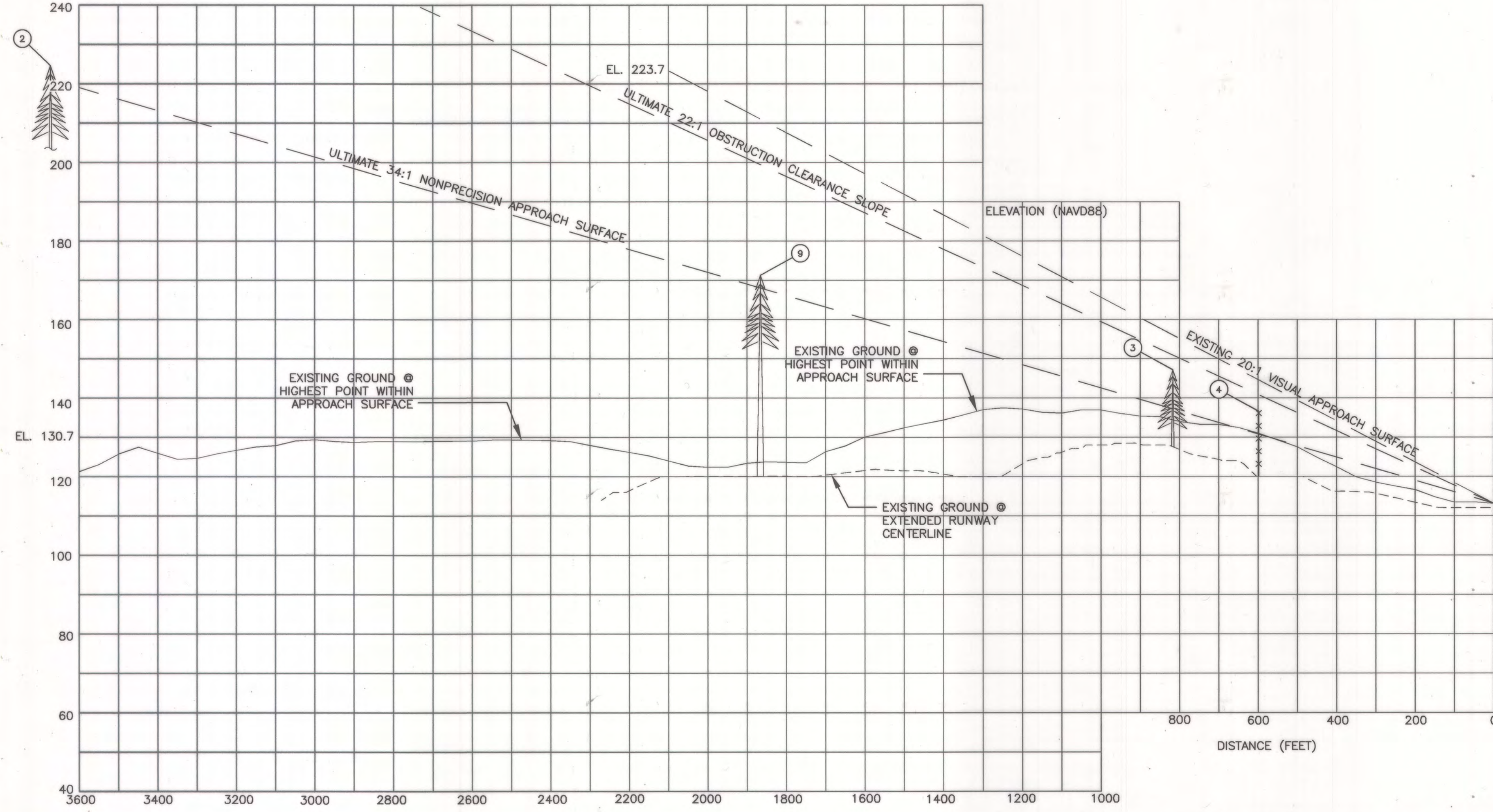

Z:\project\1627\_01\_DOT\_SE\_Aeronautical\2009 Petersburg Airport\Civil\ACAD\1627\_01-Inner Approach.dwg

PLANNED: NBS  
 DRAWN: SA/MM  
 CHECKED: E/JG

STATE OF ALASKA  
 DEPARTMENT OF TRANSPORTATION  
 AND PUBLIC FACILITIES  
 SOUTHEAST REGION PLANNING

PREVIOUS REVISION DATE: MARCH 22, 2005  
 APPROVED: *[Signature]* DATE: 9/11/13  
 VERNER SKAGERBERG, TRANSPORTATION PLANNER, FOR  
 ANDY HUGHES, CHIEF OF PLANNING

FAA AIRSPACE REVIEW NO: 2012-AAL-218-NRA  
 FAA APPROVAL DATE: 10/9/2013  
 BY: *[Signature]*  
 FAA AIRPORT DIVISION, ALASKA REGION, AAL-600  
 SUBJECT TO CONDITIONS IN LETTER DATED: 10/9/2013  
 PREVIOUS ALP FAA APPROVAL DATE: AUGUST 24, 2006

PETERSBURG JAMES A. JOHNSON AIRPORT  
 INNER PORTION OF THE APPROACH  
 SURFACE DRAWING - RUNWAY 5

SHEET  
 5 OF 9



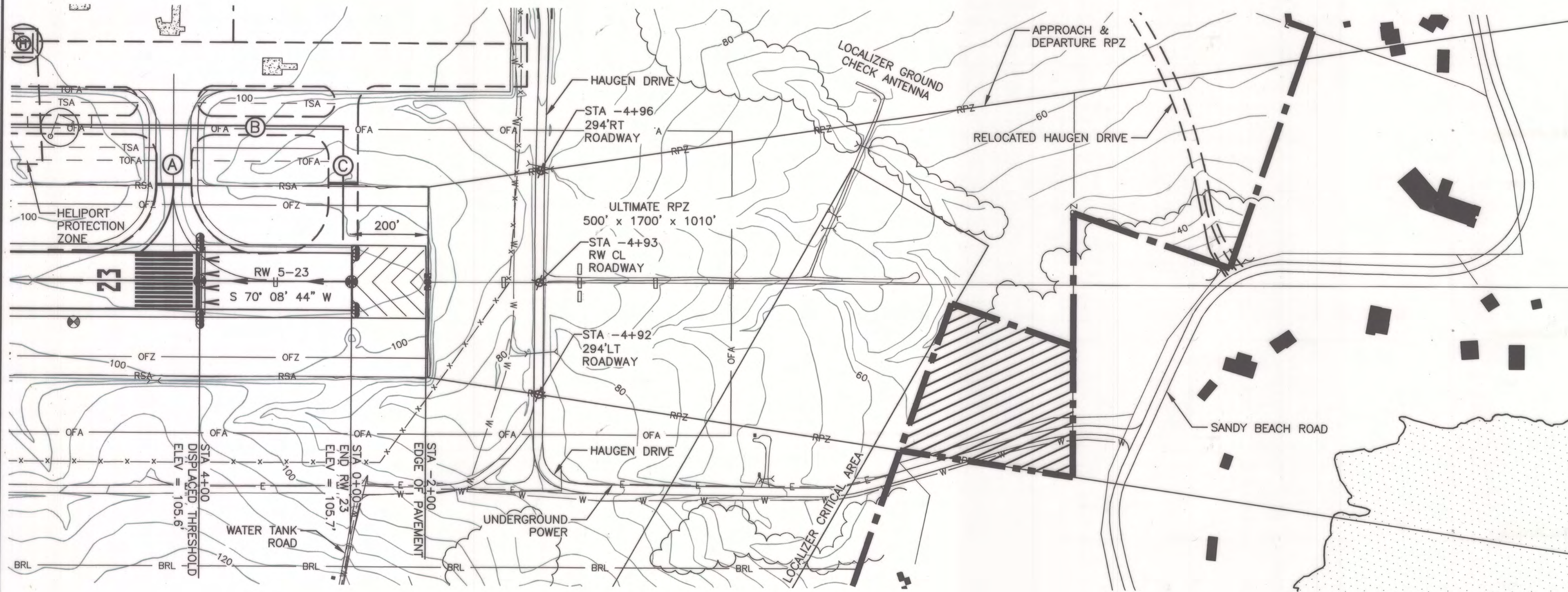

**GENERAL NOTES:**

1. THERE ARE NO CONTROLLING OBSTRUCTIONS FOR RUNWAY 23. THEREFORE THE CONTROLLING OBSTRUCTION CLEARANCE SLOPE IS ESTABLISHED AS 50:1 PER FAA AC 150/5200-35, SECTION 4, DATA ELEMENT NUMBER 57.
2. THERE ARE NO THRESHOLD SITING SURFACE OBJECT PENETRATIONS FOR RUNWAY 23 AS DEFINED IN FAA AC 150/5300-13, CHG 15, APPENDIX 2, TABLE A2-1 LINE 3.

RPZ TABLE	
R/W 23 APPROACH RPZ DIMENSIONS (INNER WIDTH X LENGTH X OUTER WIDTH)	500' X 1700' X 1010'
R/W 23 DEPARTURE RPZ DIMENSIONS (INNER WIDTH X LENGTH X OUTER WIDTH)	500' X 1700' X 1010'

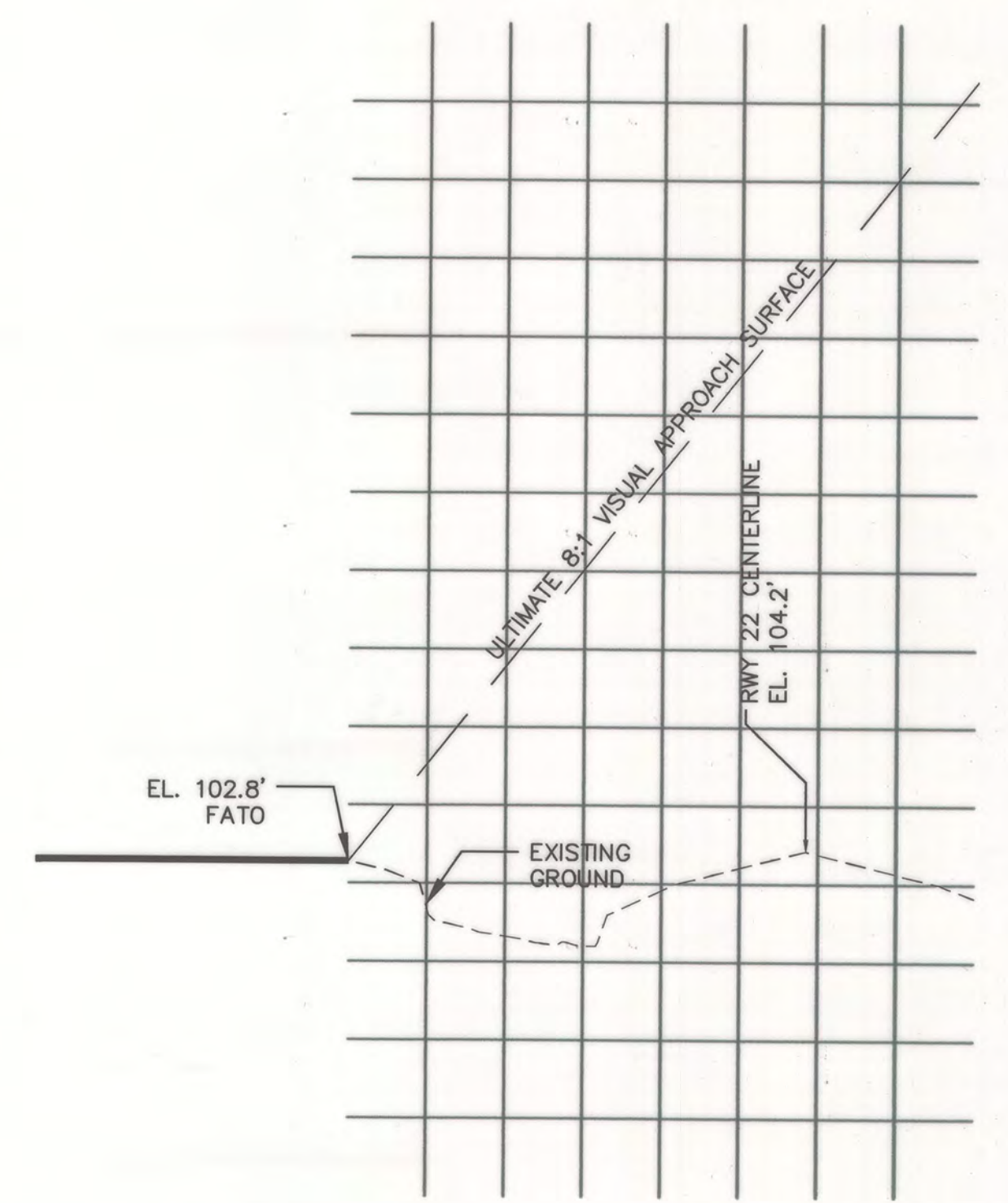
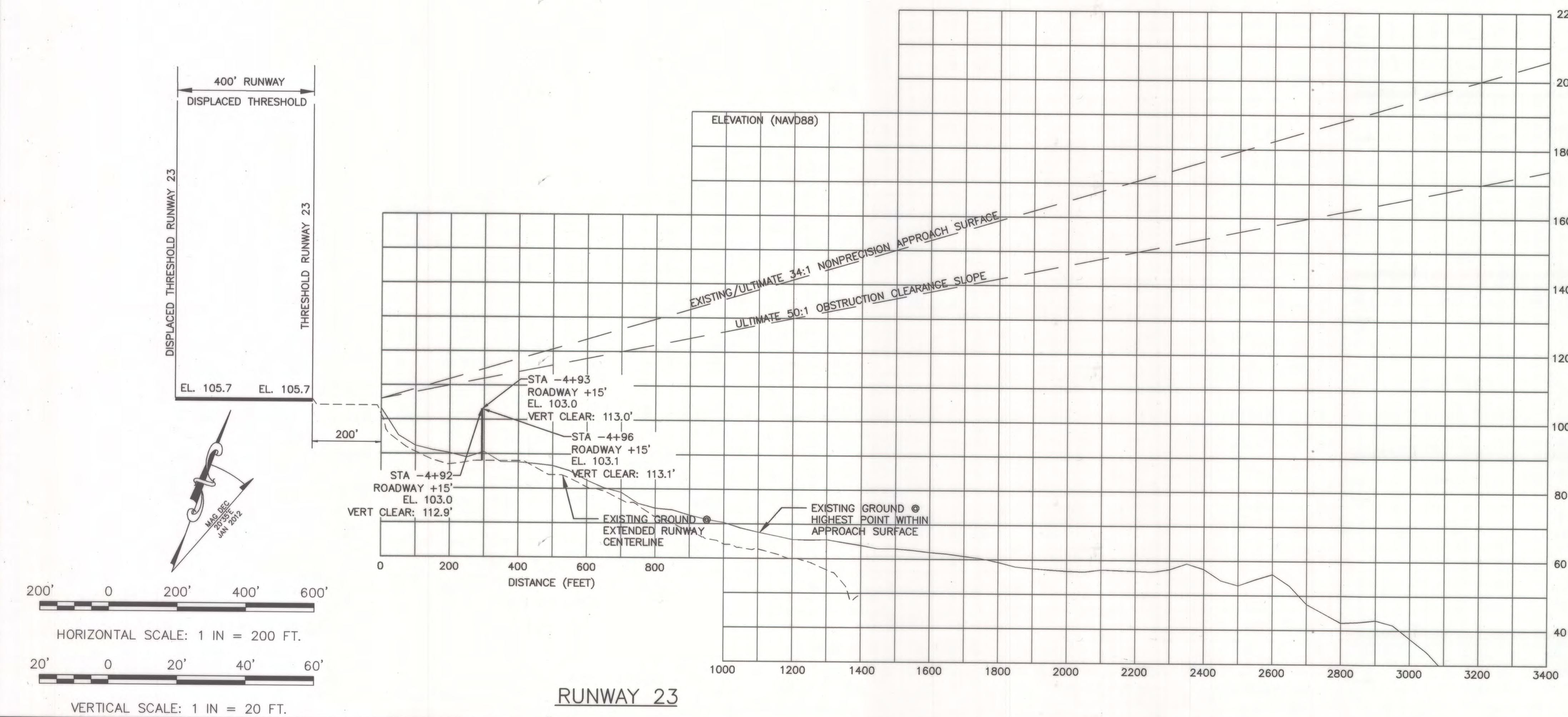

Z:\project\1627.01\_DOT\_SE\_Aeronautical\2009 Petersburg Airport\Civil\ACAD\1627.01-Inner Approach.dwg

PLANNED: NBS  
DRAWN: SA/MM  
CHECKED: EJG

STATE OF ALASKA  
DEPARTMENT OF TRANSPORTATION  
AND PUBLIC FACILITIES  
SOUTHEAST REGION PLANNING

PREVIOUS REVISION DATE: MARCH 22, 2005  
APPROVED: *[Signature]* DATE: 8/14/13  
VERNE SKAGERBERG, TRANSPORTATION PLANNER, FOR  
ANDY HUGHES, CHIEF OF PLANNING

FAA AIRSPACE REVIEW NO: 2012-AAL-218-NRA  
FAA APPROVAL DATE: 10/9/2013  
BY: *[Signature]*  
FAA AIRPORT DIVISION, ALASKA REGION, AAL-600  
SUBJECT TO CONDITIONS IN LETTER DATED: 10/9/2013  
PREVIOUS ALP FAA APPROVAL DATE: AUGUST 24, 2006

PETERSBURG JAMES A. JOHNSON AIRPORT  
INNER PORTION OF THE APPROACH  
SURFACE DRAWING - RUNWAY 23

SHEET 6 OF 9



Z:\project\1627.01 DOT\_SE Aeronautical 2009 Petersburg Airport Civil\ACAD\1627.01-Terminal Plan.dwg

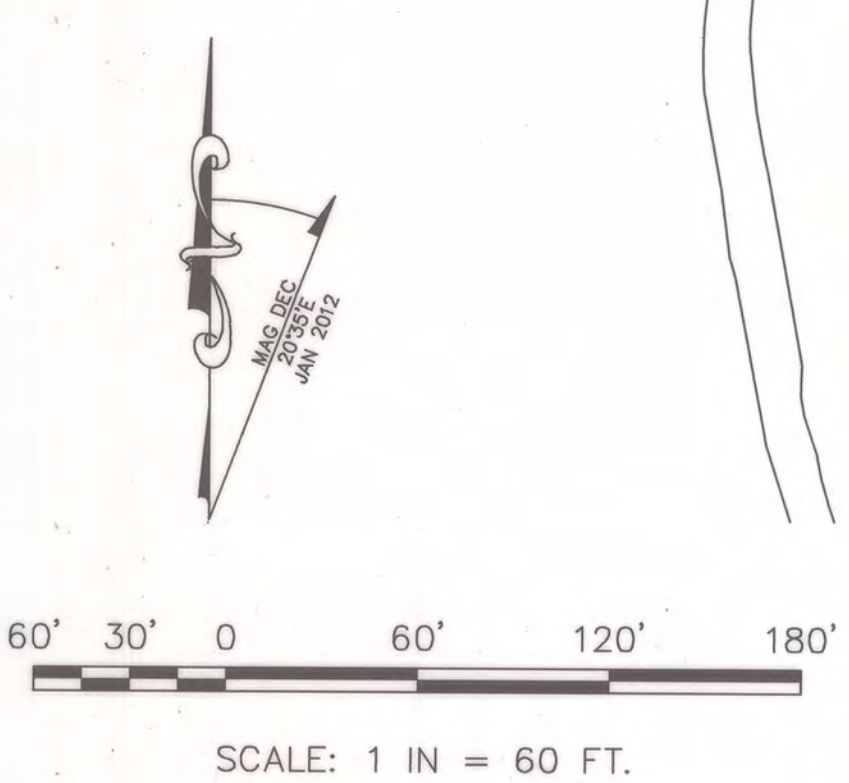
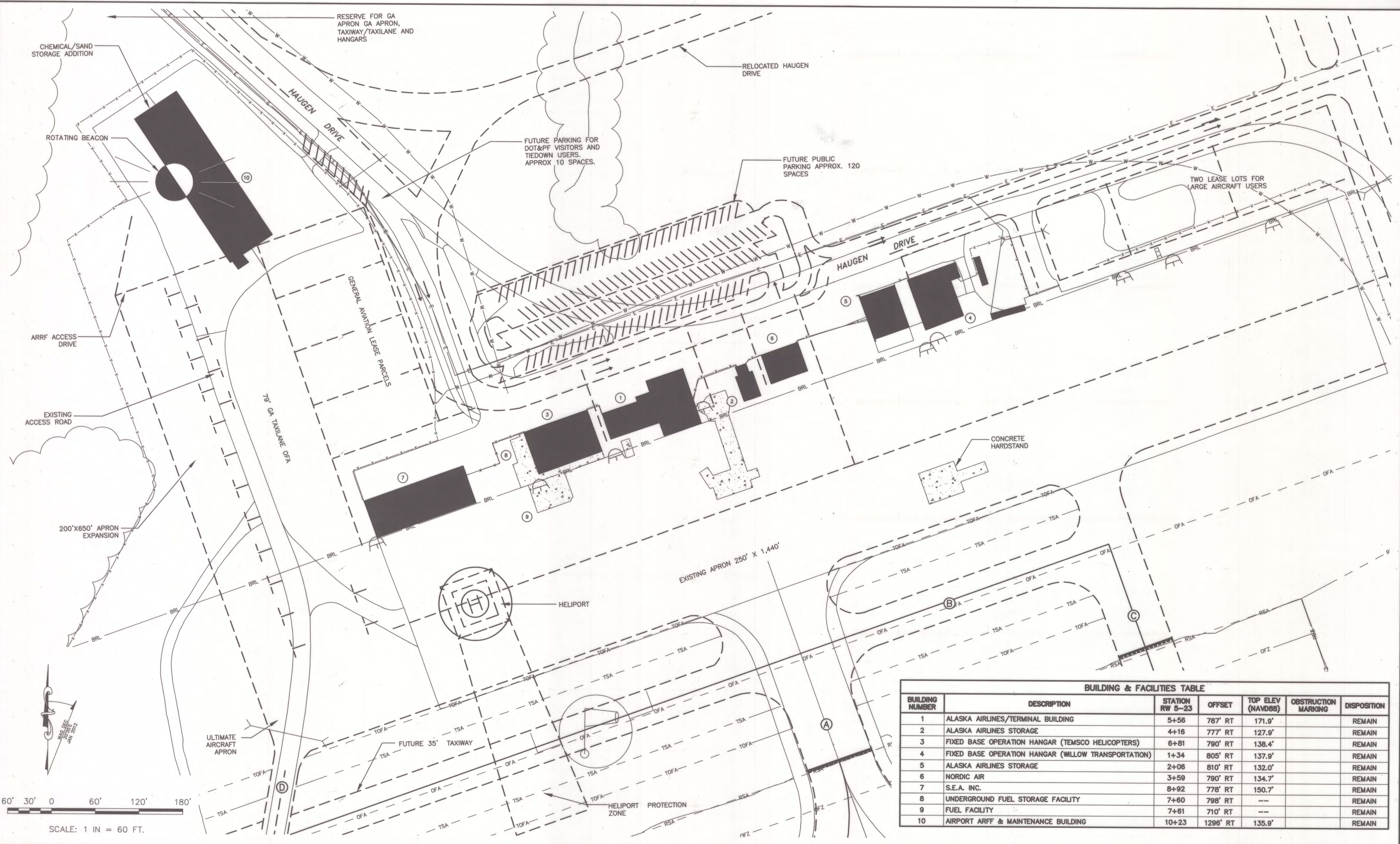

BUILDING & FACILITIES TABLE						
BUILDING NUMBER	DESCRIPTION	STATION RW 5-23	OFFSET	TOP ELEV (NAVD88)	OBSTRUCTION MARKING	DISPOSITION
1	ALASKA AIRLINES/TERMINAL BUILDING	5+56	787' RT	171.9'		REMAIN
2	ALASKA AIRLINES STORAGE	4+16	777' RT	127.9'		REMAIN
3	FIXED BASE OPERATION HANGAR (TEMSCO HELICOPTERS)	6+81	790' RT	138.4'		REMAIN
4	FIXED BASE OPERATION HANGAR (WILLOW TRANSPORTATION)	1+34	805' RT	137.9'		REMAIN
5	ALASKA AIRLINES STORAGE	2+06	810' RT	132.0'		REMAIN
6	NORDIC AIR	3+59	790' RT	134.7'		REMAIN
7	S.E.A. INC.	8+92	778' RT	150.7'		REMAIN
8	UNDERGROUND FUEL STORAGE FACILITY	7+60	798' RT	---		REMAIN
9	FUEL FACILITY	7+61	710' RT	---		REMAIN
10	AIRPORT ARRF & MAINTENANCE BUILDING	10+23	1296' RT	135.9'		REMAIN

PLANNED: NBS  
 DRAWN: SA/MM  
 CHECKED: EJG

STATE OF ALASKA  
 DEPARTMENT OF TRANSPORTATION  
 AND PUBLIC FACILITIES  
 SOUTHEAST REGION PLANNING

PREVIOUS REVISION DATE: MARCH 22, 2005  
 APPROVED: *[Signature]* DATE: 9/11/13  
 VERNE SKAGERBERG, TRANSPORTATION PLANNER, FOR  
 ANDY HUGHES, CHIEF OF PLANNING





FAA AIRSPACE REVIEW NO: 2012-AAL-218-NRA  
 FAA APPROVAL DATE: 10/17/2013  
 BY: *[Signature]*  
 FAA AIRPORT DIVISION, ALASKA REGION, AAL-600  
 SUBJECT TO CONDITIONS IN LETTER DATED: 10/9/2013  
 PREVIOUS ALP FAA APPROVAL DATE: AUGUST 24, 2006

PETERSBURG JAMES A. JOHNSON AIRPORT  
 TERMINAL AREA PLAN

SHEET  
 7 OF 9

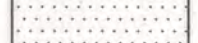
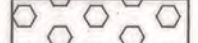
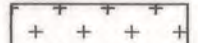

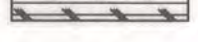
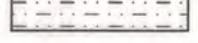
**AIRPORT LAND USE LEGEND**

- AVIATION**
-  AVIATION USE
-  COMMERCIAL AVIATION
-  GENERAL AVIATION
- NON-AVIATION**
-  NON-AVIATION
-  AIRPORT SUPPORT
-  TERMINAL AREA
-  AIRPORT RESERVE

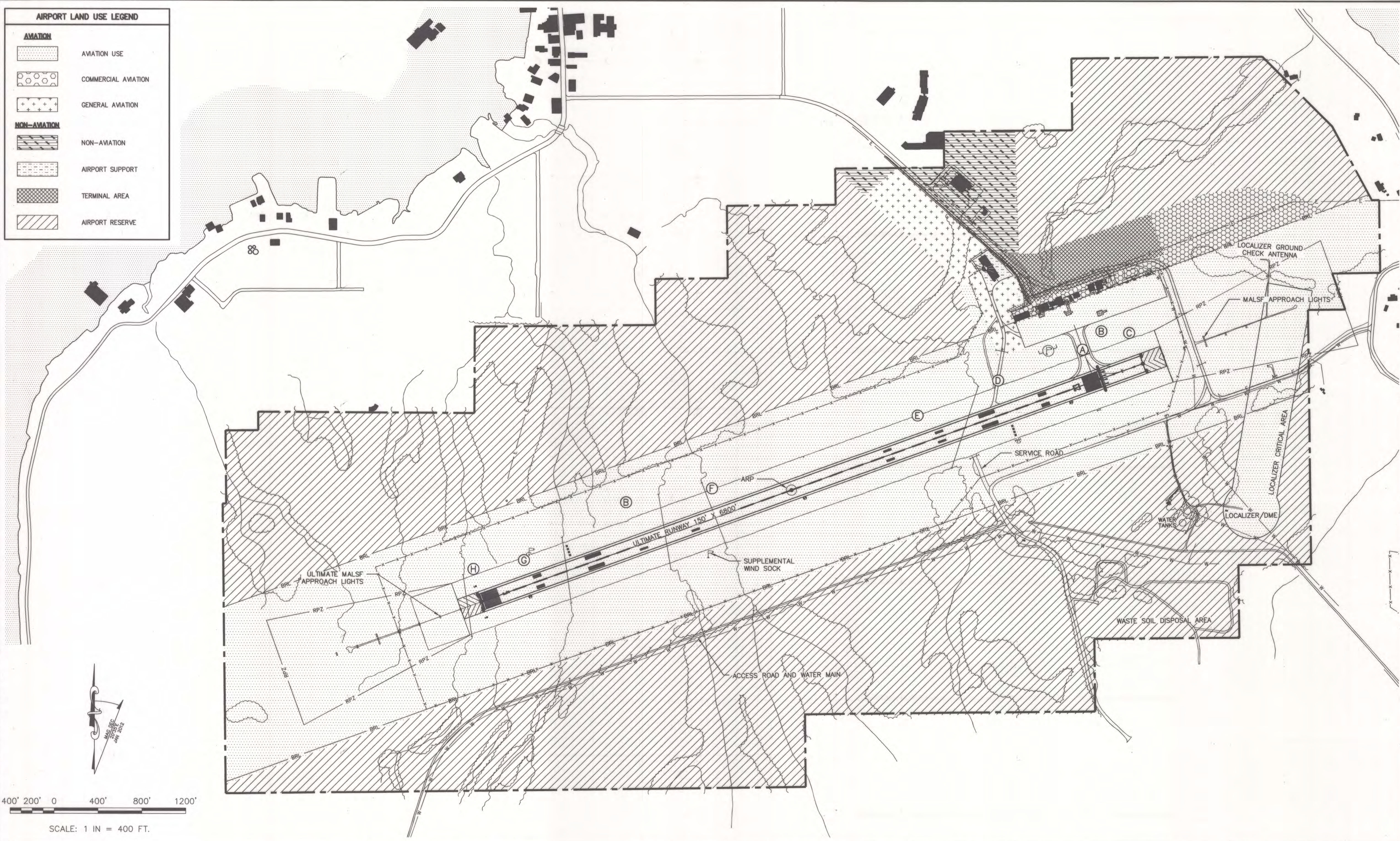

400' 200' 0 400' 800' 1200'  
 SCALE: 1 IN = 400 FT.

Z:\project\1627.01 DOT\_SE Aeronautical 2009 Petersburg Airport\Civil\ACAD\1627.01-Landuse.dwg

PLANNED: NBS  
 DRAWN: SA/MM  
 CHECKED: EUG

STATE OF ALASKA  
 DEPARTMENT OF TRANSPORTATION  
 AND PUBLIC FACILITIES  
 SOUTHEAST REGION PLANNING

PREVIOUS REVISION DATE: MARCH 22, 2005  
 APPROVED:  DATE: 9/11/13  
 VERNE SKAGERBERG, TRANSPORTATION PLANNER, FOR  
 ANDY HUGHES, CHIEF OF PLANNING

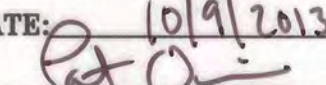
FAA AIRSPACE REVIEW NO: 2012-AAL-218-NRA  
 FAA APPROVAL DATE: 10/9/2013  
 BY:   
 SUBJECT TO CONDITIONS IN LETTER DATED: 10/9/2013  
 PREVIOUS ALP FAA APPROVAL DATE: AUGUST 24, 2006

PETERSBURG JAMES A. JOHNSON AIRPORT  
 LAND USE DRAWING

SHEET 8 OF 9



**AIRPORT PROPERTY LEGEND**

PARCEL	AREA	GRANTOR	GRANTEE	INTEREST/ COMMENTS	RECORDING DATA
TRACT I	574.11 ACRES	ALASKA DIVISION OF LANDS	STATE OF ALASKA	ILMT GRANTED 8/7/1967 ADL 34074, ADA 10523	
TRACT II	109.58 ACRES	CITY OF PETERSBURG	STATE OF ALASKA	QUIT CLAIM DEED 05/12/1967, ADA 10524 10/2/1967, ADA 10524	DEED BOOK 11 PAGE 37-39 PAGE 180-182
TRACT III	1.77 ACRES	CITY OF PETERSBURG	STATE OF ALASKA	QUIT CLAIM DEED 10/2/1967, ADA 10563 ORIG 50' RIGHT OF WAY	DEED BOOK 11 PAGE 176-179
TRACT III PARCEL 5D	2.36 ACRES	CITY OF PETERSBURG	STATE OF ALASKA	R/W EASEMENT 07/05/1973 WIDEN R/W TO 100'	BOOK 1 PAGE 78-80
NOTE: RESOLUTION NO. 380-R, DATED 7/2/1973, BY CITY OF PETERSBURG, DECLARING ALL STREETS WITHIN CITY BOUNDARY THAT FORM ALIGNMENT FOR PROJECT NO. S-0937(12) BE A PART OF ALASKA ROUTE S-937. ADDITIONAL ACQUISITION ALASKA HIGHWAY PROJECT S-0937(12) SEE PERMANENT DOCUMENTS FILE PETERSBURG AIRPORT ACCESS					
TRACT IV	338.81 ACRES	ALASKA DIVISION OF LANDS	STATE OF ALASKA	ADL 34074, 1/15/1968 ADA 10564, (II)	BOOK 11 PAGE 101-102
TRACT IV	338.81 ACRES	ALASKA DIVISION OF LANDS	STATE OF ALASKA	AMENDED ILMT, GRANTED BY ADL 34074, 6/21/1972 ADA 10564, (II)	BOOK 11 PAGE 103
TRACT V	24.74 ACRES	RPM HOLDINGS	STATE OF ALASKA	LOT 3, USS 284 PLAT 2009-6 P.R.D.	2009-000403-0
TRACT VIA	2.13 ACRES	CITY OF PETERSBURG	STATE OF ALASKA	LOT 13A, SEC. 35 PLAT 2008-15, P.R.D. WARRANTY DEED FEE SIMPLE	2008-000884-0
TRACT VIB	3.39 ACRES	CITY OF PETERSBURG	STATE OF ALASKA	TO BE ACQUIRED	

LEGEND	
	EXISTING AIRPORT BOUNDARY
	ULTIMATE AIRPORT BOUNDARY
	BRL BUILDING RESTRICTION LINE
	LAND TO BE ACQUIRED

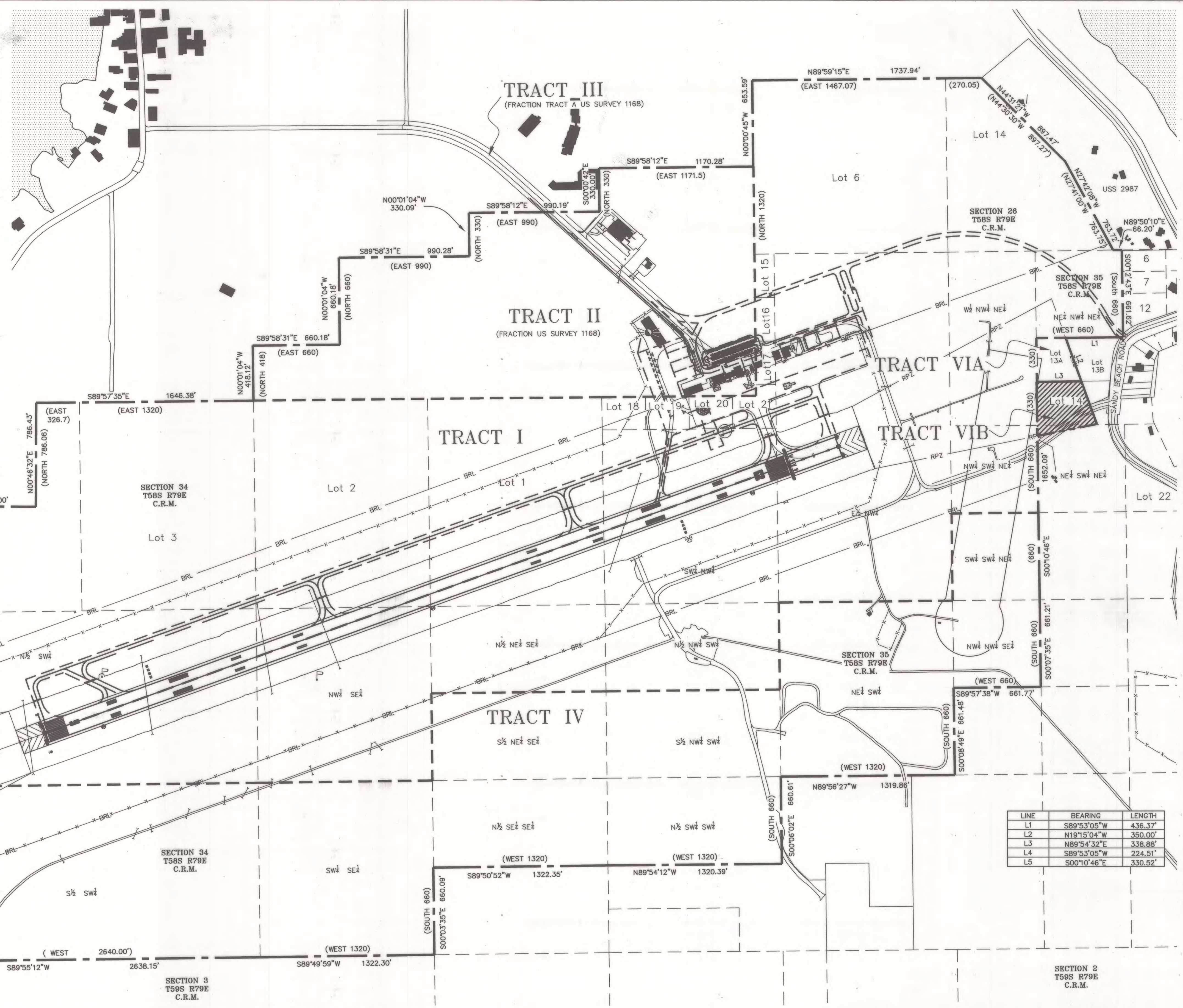

LINE	BEARING	LENGTH
L1	S89°53'05"W	436.37'
L2	N19°15'04"W	350.00'
L3	N89°54'32"E	338.88'
L4	S89°53'05"W	224.51'
L5	S00°10'46"E	330.52'

Z:\project\1627.01 DOT\_SE Aeronautical 2009 Petersburg Airport\Civil\ACAD\1627.01-Property Plan.dwg

PLANNED: NBS  
DRAWN: SA/MM  
CHECKED: E/JG

STATE OF ALASKA  
DEPARTMENT OF TRANSPORTATION  
AND PUBLIC FACILITIES  
SOUTHEAST REGION PLANNING

PREVIOUS REVISION DATE: MARCH 22, 2005  
APPROVED:   
DATE: 9/11/13  
VERNE SKAGERBERG, TRANSPORTATION PLANNER, FOR  
ANDY HUGHES, CHIEF OF PLANNING

FAA AIRSPACE REVIEW NO: 2012-AAL-218-NRA  
FAA APPROVAL DATE: 10/9/2013  
BY:   
FAA AIRPORT DIVISION, ALASKA REGION, AAL-600  
SUBJECT TO CONDITIONS IN LETTER DATED: 10/9/2013  
PREVIOUS ALP FAA APPROVAL DATE: AUGUST 24, 2006

PETERSBURG JAMES A. JOHNSON AIRPORT  
AIRPORT PROPERTY MAP

SHEET  
9 OF 9